

Operation and maintenance manual for **Chain Hoist PREMIUM PRO**

Installation - Operation - Maintenance



Chain Hoist
PREMIUM PRO 1t

IMPORTANT - READ BEFORE USE!















PLANETA-Hebetechnik GmbH • Resser Str. 17 & 23 • D-44653 Herne
Tel. +49 2325 9580-0 • Fax +49 2325 77077 • info@planeta-herne.de • www.planeta-hebetechnik.de

© Reprint, also in extracts, only with written permission of PLANETA-Hebetechnik GmbH
01-02-09-0000-0115-00-BA-EN-PLA

Index

SAFETY	4
1. Generally	5
2. Important Notes	6
3. Special safety	6
4. Installation instructions before connecting	7
5. Operation	7
6. Maintenance and inspection	7
7. Overload safety device	8
8. Specifications	9
9. Spare parts for Chain Hoist PREMIUM PRO 0,25t – 5t	10
10. Spare Parts List for Chain Hoist PREMIUM PRO 0,25t – 5t	11
11. Spare parts for Chain Hoist PREMIUM PRO 10t	15
12. Spare Parts List for Chain Hoist PREMIUM PRO 10t	16
13. Annual safety inspections	17
CE-DECLARATION OF CONFORMITY	

SAFETY

				
<p>1. Read before use!</p>	<p>2. Do not overload</p>	<p>3. Do not work under a load!</p>	<p>4. Never pull the chain from the side!</p>	<p>5. Never work with a damaged hoist!</p>
				
<p>6. Never lift human with this hoist!</p>	<p>7. Never throw the hoist</p>	<p>8. Do not wrap the load chain around the load</p>	<p>9. NEVER extend the Hand lever with a pipe!</p>	<p>10. Never work up to the end of chain</p>
				
<p>11. Never attach the load on the tip of the hook!</p>	<p>12. Never work with a twisted or broken chain!</p>	<p>13. Never work without a safety latch!</p>	<p>14. Never remove the warning notice</p>	

1. Generally

Chain hoists are for lifting of loads only.

The hoists can be attached to a trolley of any type as a travelling hoist.

Five prominent features:

- Safety in operation with minimum maintenance.
- High efficiency and low hand force.
- Light weight and easy handling.
- Fine appearance with small size
- Durability in service.

Intellectual property

Hoist models, drawings and engineering are of our exclusive property. It is expressly forbidden to copy, use or hand over to third parties such information without a specific written permission.

Warranty

PLANETA warrants to the original user its hoists to be free of defects in material and workmanship for a period of one year from the date of purchase. PLANETA will repair, without cost, any product found to be defective, including parts and labor charges, or at its option, will replace such products or refund the purchase price less a reasonable allowance for depreciation, in exchange for the product.

If any product proves defective within its original one year warranty period, it should be returned to any authorized PLANETA dealer, transportation prepaid with proof of purchase or hoist data sheet / test certificate.

This warranty does not apply to products which PLANETA has determined to have been misused or abused, improperly maintained by the purchaser; or where the malfunction or defect can be attributed to the use of no genuine PLANETA parts.

PLANETA makes no other warranty, and all implied warranties including any warranty of merchantability or fitness for a particular purpose are limited to the duration of the expressed warranty period as set forth above. PLANETA's maximum liability is limited to the purchase price of the product and in no event shall PLANETA be liable for any consequential, indirect, incidental, or special damages of any nature arising from the sale or use of the product, whether based on contract, tort, or otherwise.

2. Important Notes

- Read instruction and make it available to operators on the device before use.
- Operator must be instructed properly with the device. Never leave the device under load unattended!
- Never exceed lifting capacity indicated on the name plate. Do not draw any pull and lifting chains over angles.
- Do not transport persons or loads with the product over areas where persons could be.
- Device must be checked once a year by a technical expert, in case of harder operating conditions more often. Ask your retailer or us. The enterpriser is liable in case of damages and has to provide test certificates.
- Check the device regarding damages, unfastened screws or twists before using it to eliminate failures.
- Repair works on hoisting devices shall only be carried out by the manufacturer or an instructed repair shop by using original spare parts.
- Check load carrying constructions, load securing devices, mountings, cross beams etc. regarding load carrying capacity and condition of the required loads by a technical expert.
- Non-observance of the instruction, improper use, and corrosion by insufficient protection or product alterations without authority result in expiry of the warranty.
- Risk of corrosion in case of continuous contact with unfavourable atmospheric conditions as for example high humidity or harmful environmental influences atmospheres with acid vapours, corrosive gases or high dust concentration cause early wear. This effectuates no claim under warranty.
- Further information or spare part lists will kindly be provided by us or your specialist dealer.

3. Special safety

- Read before use.
- Do not overload
- Do not work under a load
- Never pull the chain from the side
- Never work with a damaged hoist
- Never lift persons with this hoist
- Never throw the hoist
- Do not wrap the load chain around the load
- Never work up to the end of chain
- Never attach the load on the tip of the hook.
- Never work with a twisted or broken chain
- Never work without a safety latch
- Never remove the warning notice

4. Installation instructions before connecting

A. Before first use

- Chain hoists with travelling trolley underlie the accident prevention regulation (UVV) (Federal cooperative society regulations of Germany - BGV - D9). Before the first initiation a quality inspection by a technical expert for cranes has to be carried out. Please contact PLANETA for it. We will kindly advise you!
- Never use the hoist below -20 degrees Celsius or above + 60 degrees Celsius.

B. Installation and testing prior to each use

- Hang hoist with the clamp into the load carrying system and turn once.
- Hand chain and load chain must hang free and be without breaks or twists.
- Chain block: Pull through hand chain one time completely without load.
- Inspection of load brake: Lift up lightly the load and hold it. If load is safe, go on lifting. When lowering, the load shall not slide after hand chain shutdown or stop of the lever.
- If everything is performed properly, operation can be started.
- Important for devices of multiple lines: Lower block shall not be snapped through the chain loop. This can be recognised by a twisted chain. Each second chain link is in one row not steadily in alignment. If the welded seams of the chain links are not in same direction the lower block must be struck back through the chain loop.
- The last chain link must be fastened on the hoist body.

5. Operation

- Brake closes independently when hanging on the minimal load (appr. 10% of nominal load).
- Chain block is only suitable for vertical lifting and lowering.
- To move the load the hand chain is pulled up or down.

6. Maintenance and inspection

Chains and Hooks

- The chains and clamps have to be inspected continuously! Clean chain before inspection. Lubricate load chain from time to time! Never lubricate or grease the brake!
- Retracted chain shall not click under load.
- Check chain for tension! The internal length (**t**) of a worn chain link, smallest diameter of wire (**D**) and length of 11 chain links (**a**) are measured by a slide gauge where the chain must be tightened firmly.
- Dimensions: If the deviations of measurement exceed the values (**a**) in the following table substitute chain immediately. Measure of diameter (**D**) shall not be under-run and the pitch (**t**) of the single link not be exceeded.

7. Overload safety device

All spur gear chain blocks PREMIUM PRO have a standard adjustable overload safety device from 500kg or above. This protects the device by prohibiting lifting more than the preset friction connection in the hand wheel permits. The overload protection is set at the factory. By fastening or loosening the press nut pos. 49, the pressure on the friction disc is increased or lowered. If the desired value is reached, the nut pos. 49 is secured by bending one or two teeth of the tooth wheel pos. 50 into the corresponding gap in the nut. The overload protection is set at the factory. By fastening or loosening the press nut pos. 49, the pressure on the friction disc is increased or lowered. If the desired value is reached, the nut pos. 49 is secured by bending one or two teeth of the tooth wheel pos. 50 into the corresponding gap in the nut.

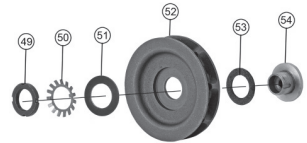
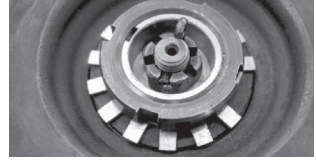

Capacity	Max. measurement of		Min. chain link diameter (D)
	1 chain link (t)	11 chain links (a)	
0,25t	12,6mm	134,9mm	3,6mm
0,5t	15,8mm	170,0mm	4,5mm
1t	18,9mm	210,9mm	5,4mm
1,5t	25,2mm	271,9mm	7,2mm
2t	25,2mm	271,9mm	7,2mm
3t	31,5mm	352,5mm	9,0mm
5t	31,5mm	352,5mm	9,0mm
10t	31,5mm	352,5mm	9,0mm
20t	31,5mm	352,5mm	9,0mm

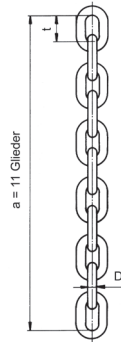

Capacity	Clamp mouth opening "G" normal - max.
0,25t	25-28mm
0,5t	26-29mm
1t	32-35mm
1,5t	38-42mm
2t	38-42mm
3t	43-47mm
5t	48-53mm
10t	60-66mm
20t	84-92mm

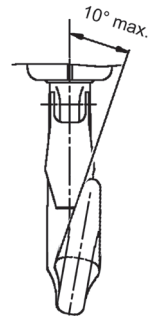
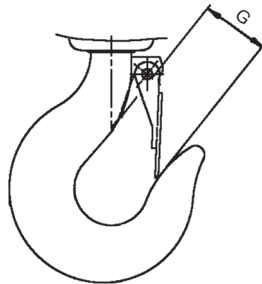

8. Specifications

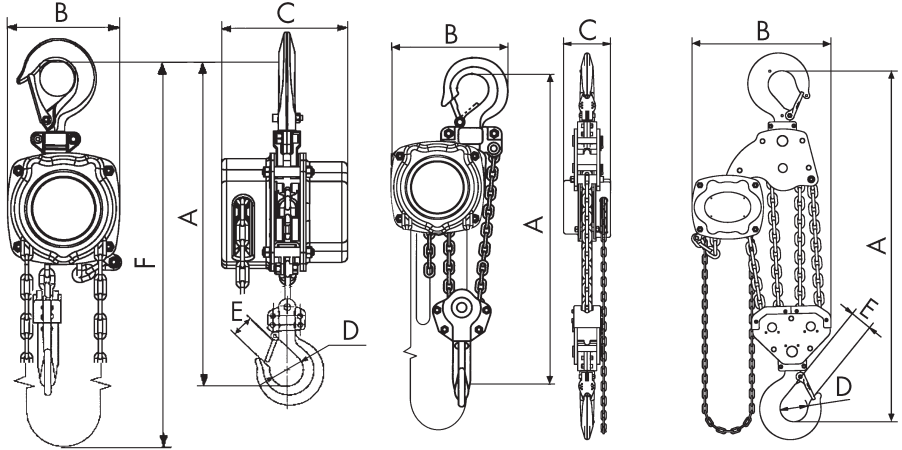

Chain Hoist PREMIUM PRO 0,25 - 3t

Chain Hoist PREMIUM PRO 5t

Chain Hoist PREMIUM PRO 10t

TYPE	PREMIUM PRO...	0,25	0,5	1	1,5	2	3	5	10	20	30
Capacity	t	0,25	0,5	1	1,5	2	3	5	10	20	30
Standard lift	m	3	3	3	3	3	3	3	3	3	3
Min. headroom (A)	mm	259	309	373	460	460	553	630	900	1033	1320
Hand chain force	daN	22	24	30,5	36	36	37	39	39,5	40,5	47 x 2
Hand chain operation length	m	2,5	2,5	2,5	2,5	2,5	2,5	2,5	2,5	2,5	2,5
Number of chain falls		1	1	1	1	1	1	2	4	8	12
Chain size	mm	4 x 12	5 x 15	6 x 18	8 x 24	8 x 24	10 x 30	10 x 30	10 x 30	10 x 30	9 x 27
B (Dimensions)	mm	95	114	152	190	190	240	240	391	955	690
C	mm	99,4	110	139	150	150	158	158	166	169	435
D	mm	30	33	40	52	52	62	72	85	110	106
E	mm	22	22	28	33	33	37	44	60	70	80
F	mm	2,5	2,5	2,5	2,5	2,5	2,5	2,5	2,5	2,5	2,5
Weight with 3m lift	kg	4,2	5,7	10,8	16,8	17,1	26,2	40	62	160	350
Weight for 1m additional lift	kg	0,35	0,55	0,78	1,4	1,4	2,2	4,4	8,8	17,6	21,6

Subject to technical changes!

9. Spare parts for Chain Hoist PREMIUM PRO 0,25t – 5t

Chain Hoist PREMIUM PRO 0,25 - 3t

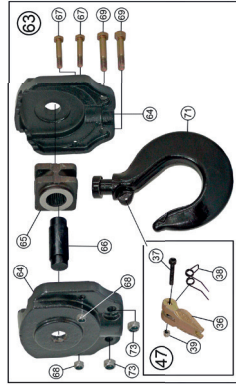
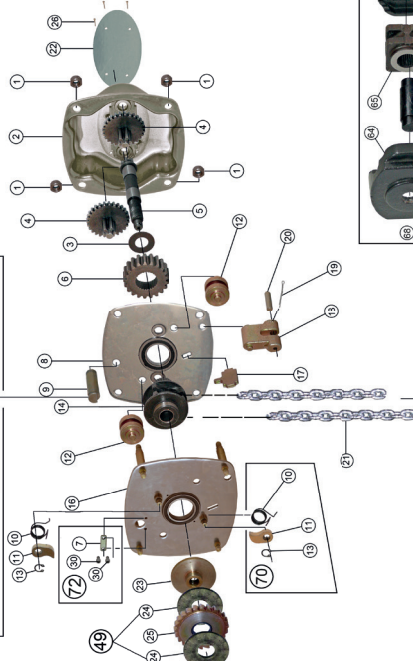
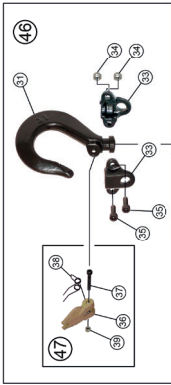

Chain Hoist PREMIUM PRO 5t

Chain Hoist PREMIUM PRO 5t

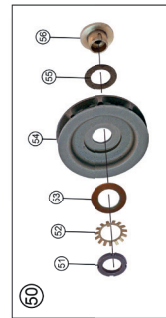
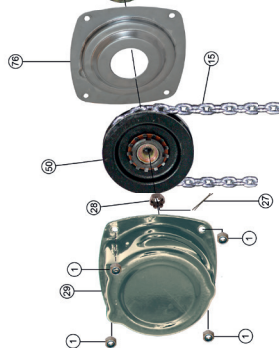
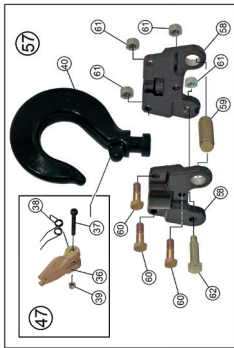

10. Spare Parts List for Chain Hoist PREMIUM PRO 0,25t – 5t

Component parts PREMIUM PRO 0,25t Component parts PREMIUM PRO 0,5t

Item	Qty.	Description	Part-No.	
1	8	Locking nut	Z0200101	Piece
2	1	Gear box cap	Z0200102	Piece
3	1	Washer	Z0200103	Piece
4	2	Gear wheel	Z0200104	Piece
5	1	Driving shaft	Z0200105	Piece
6	1	Center gear wheel	Z0200106	Piece
8	1	Right side plate	Z0200108	Piece
9	1	Top hook pin	Z0200109	Piece
12	2	Chain guide roller	Z0200112	Piece
14	1	Load Chain sprocket	Z0200114	Piece
15	5	Hand chain	Z0200115	m
16	1	Left side plate	Z0200116	Piece
17	1	Chain stripper	Z0200117	Piece
18	1	Chain suspension	Z0200118	Piece
19	1	Split pin	Z0200119	Piece
20	1	Pin	Z0200120	Piece
21	3	Load chain	Z0200121	m
22	1	Name plate	Z0200122	Piece
23	1	Brake seat	Z0200123	Piece
25	1	Ratchet disk	Z0200125	Piece
26	4	Name plate rivet	Z0200126	Piece
27	1	Split pin	Z0200127	Piece
28	1	Castle nut	Z0200128	Piece
29	1	Hand wheel cover	Z0200129	Piece
76	1	Dust protection cover	Z0200176	Piece

Item	Qty.	Description	Part-No.	
1	8	Locking nut	Z0200201	Piece
2	1	Gear box cap	Z0200202	Piece
3	1	Washer	Z0200203	Piece
4	2	Gear wheel	Z0200204	Piece
5	1	Driving shaft	Z0200205	Piece
6	1	Center gear wheel	Z0200206	Piece
8	1	Right side plate	Z0200208	Piece
9	1	Top hook pin	Z0200209	Piece
12	2	Chain guide roller	Z0200212	Piece
14	1	Load Chain sprocket	Z0200214	Piece
15	5	Hand chain	Z0200215	m
16	1	Left side plate	Z0200216	Piece
17	1	Chain stripper	Z0200217	Piece
18	1	Chain suspension	Z0200218	Piece
19	1	Split pin	Z0200219	Piece
20	1	Pin	Z0200220	Piece
21	3	Load chain	Z0200221	m
22	1	Name plate	Z0200222	Piece
23	1	Brake seat	Z0200223	Piece
25	1	Ratchet disk	Z0200225	Piece
26	4	Name plate rivet	Z0200226	Piece
27	1	Split pin	Z0200227	Piece
28	1	Castle nut	Z0200228	Piece
29	1	Hand wheel cover	Z0200229	Piece
76	1	Dust protection cover	Z0200276	Piece

Not listed items are only available in the module!

Complete parts PREMIUM PRO 0,25t

Item	Qty.	Description	Part-No.	
46	1	Top load hook assembly, <i>Item 31, 33 (2x), 34 (2x), 35 (2x), 47</i>	Z0200146	Set
47	1	Safety latch assembly, <i>Item 36, 37, 38, 39</i>	Z0200147	Set
48	1	Load hook assembly, <i>Item 32, 41 (2x), 42, 43, 44 (2x), 45 (2x), 47</i>	Z0200148	Set
49	1	Friction plates assembly, <i>Item 24 (2x)</i>	Z0200149	Set
50	1	Overload protection assembly, <i>Item 51, 52, 53, 54, 55, 56</i>	Z0200150	Set
70	1	Ratchet Pawl assembly, <i>Item 10 (2x), 11 (2x), 13 (2x)</i>	Z0200170	Set
72	1	Locking set assembly, <i>Item 7, 30 (2x)</i>	Z0200172	Set

Complete parts PREMIUM PRO 0,5t

Item	Qty.	Description	Part-No.	
46	1	Top load hook assembly, <i>Item 31, 33 (2x), 34 (2x), 35 (2x), 47</i>	Z0200246	Set
47	1	Safety latch assembly, <i>Item 36, 37, 38, 39</i>	Z0200247	Set
48	1	Load hook assembly, <i>Item 32, 41 (2x), 42, 43, 44 (2x), 45 (2x), 47</i>	Z0200248	Set
49	1	Friction plates assembly, <i>Item 24 (2x)</i>	Z0200249	Set
50	1	Overload protection assembly, <i>Item 51, 52, 53, 54, 55, 56</i>	Z0200250	Set
70	1	Ratchet Pawl assembly, <i>Item 10 (2x), 11 (2x), 13 (2x)</i>	Z0200270	Set
72	1	Locking set assembly, <i>Item 7, 30 (2x)</i>	Z0200272	Set

Component parts PREMIUM PRO 1 t

Item	Qty.	Description	Part-No.	
1	8	Locking nut	Z0200301	Piece
2	1	Gear box cap	Z0200302	Piece
3	1	Washer	Z0200303	Piece
4	2	Gear wheel	Z0200304	Piece
5	1	Driving shaft	Z0200305	Piece
6	1	Center gear wheel	Z0200306	Piece
8	1	Right side plate	Z0200308	Piece
9	1	Top hook pin	Z0200309	Piece
12	2	Chain guide roller	Z0200312	Piece
14	1	Load Chain sprocket	Z0200314	Piece
15	5	Hand chain	Z0200315	m
16	1	Left side plate	Z0200316	Piece
17	1	Chain stripper	Z0200317	Piece
18	1	Chain suspension	Z0200318	Piece
19	1	Split pin	Z0200319	Piece
20	1	Pin	Z0200320	Piece
21	3	Load chain	Z0200321	m
22	1	Name plate	Z0200322	Piece
23	1	Brake seat	Z0200323	Piece
25	1	Ratchet disk	Z0200325	Piece
26	4	Name plate rivet	Z0200326	Piece
27	1	Split pin	Z0200327	Piece
28	1	Castle nut	Z0200328	Piece
29	1	Hand wheel cover	Z0200329	Piece
76	1	Dust protection cover	Z0200376	Piece

Component parts PREMIUM PRO 1,5t

Item	Qty.	Description	Part-No.	
1	8	Locking nut	Z0200401	Piece
2	1	Gear box cap	Z0200402	Piece
3	1	Washer	Z0200403	Piece
4	2	Gear wheel	Z0200404	Piece
5	1	Driving shaft	Z0200405	Piece
6	1	Center gear wheel	Z0200406	Piece
8	1	Right side plate	Z0200408	Piece
9	1	Top hook pin	Z0200409	Piece
12	2	Chain guide roller	Z0200412	Piece
14	1	Load Chain sprocket	Z0200414	Piece
15	5	Hand chain	Z0200415	m
16	1	Left side plate	Z0200416	Piece
17	1	Chain stripper	Z0200417	Piece
18	1	Chain suspension	Z0200418	Piece
19	1	Split pin	Z0200419	Piece
20	1	Pin	Z0200420	Piece
21	3	Load chain	Z0200421	m
22	1	Name plate	Z0200422	Piece
23	1	Brake seat	Z0200423	Piece
25	1	Ratchet disk	Z0200425	Piece
26	4	Name plate rivet	Z0200426	Piece
27	1	Split pin	Z0200427	Piece
28	1	Castle nut	Z0200428	Piece
29	1	Hand wheel cover	Z0200429	Piece
76	1	Dust protection cover	Z0200476	Piece

Not listed items are only available in the module!

Complete parts PREMIUM PRO 1 t

Item	Qty.	Description	Part-No.	
46	1	Top load hook assembly, <i>Item 31, 33 (2x), 34 (2x), 35 (2x), 47</i>	Z0200346	Set
47	1	Safety latch assembly, <i>Item 36, 37, 38, 39</i>	Z0200347	Set
48	1	Load hook assembly, <i>Item 32, 41 (2x), 42, 43, 44 (2x), 45 (2x), 47</i>	Z0200348	Set
49	1	Friction plates assembly, <i>Item 24 (2x)</i>	Z0200349	Set
50	1	Overload protection assembly, <i>Item 51, 52, 53, 54, 55, 56</i>	Z0200350	Set
70	1	Ratchet Pawl assembly, <i>Item 10 (2x), 11 (2x), 13 (2x)</i>	Z0200370	Set
72	1	Locking set assembly, <i>Item 7, 30 (2x)</i>	Z0200372	Set

Complete parts PREMIUM PRO 1,5t

Item	Qty.	Description	Part-No.	
46	1	Top load hook assembly, <i>Item 31, 33 (2x), 34 (2x), 35 (2x), 47</i>	Z0200446	Set
47	1	Safety latch assembly, <i>Item 36, 37, 38, 39</i>	Z0200447	Set
48	1	Load hook assembly, <i>Item 32, 41 (2x), 42, 43, 44 (2x), 45 (2x), 47</i>	Z0200448	Set
49	1	Friction plates assembly, <i>Item 24 (2x)</i>	Z0200449	Set
50	1	Overload protection assembly, <i>Item 51, 52, 53, 54, 55, 56</i>	Z0200450	Set
70	1	Ratchet Pawl assembly, <i>Item 10 (2x), 11 (2x), 13 (2x)</i>	Z0200470	Set
72	1	Locking set assembly, <i>Item 7, 30 (2x)</i>	Z0200472	Set

Component parts PREMIUM PRO 2t

Item	Qty.	Description	Part-No.	
1	8	Locking nut	Z0200501	Piece
2	1	Gear box cap	Z0200502	Piece
3	1	Washer	Z0200503	Piece
4	2	Gear wheel	Z0200504	Piece
5	1	Driving shaft	Z0200505	Piece
6	1	Center gear wheel	Z0200506	Piece
8	1	Right side plate	Z0200508	Piece
9	1	Top hook pin	Z0200509	Piece
12	2	Chain guide roller	Z0200512	Piece
14	1	Load Chain sprocket	Z0200514	Piece
15	5	Hand chain	Z0200515	m
16	1	Left side plate	Z0200516	Piece
17	1	Chain stripper	Z0200517	Piece
18	1	Chain suspension	Z0200518	Piece
19	1	Split pin	Z0200519	Piece
20	1	Pin	Z0200520	Piece
21	3	Load chain	Z0200521	m
22	1	Name plate	Z0200522	Piece
23	1	Brake seat	Z0200523	Piece
25	1	Ratchet disk	Z0200525	Piece
26	4	Name plate rivet	Z0200526	Piece
27	1	Split pin	Z0200527	Piece
28	1	Castle nut	Z0200528	Piece
29	1	Hand wheel cover	Z0200529	Piece
76	1	Dust protection cover	Z0200576	Piece

Component parts PREMIUM PRO 3t

Item	Qty.	Description	Part-No.	
1	8	Locking nut	Z0200601	Piece
2	1	Gear box cap	Z0200602	Piece
3	1	Washer	Z0200603	Piece
4	2	Gear wheel	Z0200604	Piece
5	1	Driving shaft	Z0200605	Piece
6	1	Center gear wheel	Z0200606	Piece
8	1	Right side plate	Z0200608	Piece
9	1	Top hook pin	Z0200609	Piece
12	2	Chain guide roller	Z0200612	Piece
14	1	Load Chain sprocket	Z0200614	Piece
15	5	Hand chain	Z0200615	m
16	1	Left side plate	Z0200616	Piece
17	1	Chain stripper	Z0200617	Piece
18	1	Chain suspension	Z0200618	Piece
19	1	Split pin	Z0200619	Piece
20	1	Pin	Z0200620	Piece
21	3	Load chain	Z0200621	m
22	1	Name plate	Z0200622	Piece
23	1	Brake seat	Z0200623	Piece
25	1	Ratchet disk	Z0200625	Piece
26	4	Name plate rivet	Z0200626	Piece
27	1	Split pin	Z0200627	Piece
28	1	Castle nut	Z0200628	Piece
29	1	Hand wheel cover	Z0200629	Piece
76	1	Dust protection cover	Z0200676	Piece

Not listed items are only available in the module!

Complete parts PREMIUM PRO 2t

Item	Qty.	Description	Part-No.	
46	1	Top load hook assembly, <i>Item 31, 33 (2x), 34 (2x), 35 (2x), 47</i>	Z0200546	Set
47	1	Safety latch assembly, <i>Item 36, 37, 38, 39</i>	Z0200547	Set
48	1	Load hook assembly, <i>Item 32, 41 (2x), 42, 43, 44 (2x), 45 (2x), 47</i>	Z0200548	Set
49	1	Friction plates assembly, <i>Item 24 (2x)</i>	Z0200549	Set
50	1	Overload protection assembly, <i>Item 51, 52, 53, 54, 55, 56</i>	Z0200550	Set
70	1	Ratchet Pawl assembly, <i>Item 10 (2x), 11 (2x), 13 (2x)</i>	Z0200570	Set
72	1	Locking set assembly, <i>Item 7, 30 (2x)</i>	Z0200572	Set

Complete parts PREMIUM PRO 3t

Item	Qty.	Description	Part-No.	
46	1	Top load hook assembly, <i>Item 31, 33 (2x), 34 (2x), 35 (2x), 47</i>	Z0200646	Set
47	1	Safety latch assembly, <i>Item 36, 37, 38, 39</i>	Z0200647	Set
48	1	Load hook assembly, <i>Item 32, 41 (2x), 42, 43, 44 (2x), 45 (2x), 47</i>	Z0200648	Set
49	1	Friction plates assembly, <i>Item 24 (2x)</i>	Z0200649	Set
50	1	Overload protection assembly, <i>Item 51, 52, 53, 54, 55, 56</i>	Z0200650	Set
70	1	Ratchet Pawl assembly, <i>Item 10 (2x), 11 (2x), 13 (2x)</i>	Z0200670	Set
72	1	Locking set assembly, <i>Item 7, 30 (2x)</i>	Z0200672	Set

Component parts PREMIUM PRO 5t

Item	Qty.	Description	Part-No.	
1	8	Locking nut	Z0200701	Piece
2	1	Gear box cap	Z0200702	Piece
3	1	Washer	Z0200703	Piece
4	2	Gear wheel	Z0200704	Piece
5	1	Driving shaft	Z0200705	Piece
6	1	Center gear wheel	Z0200706	Piece
8	1	Right side plate	Z0200708	Piece
9	1	Top hook pin	Z0200709	Piece
12	2	Chain guide roller	Z0200712	Piece
14	1	Load Chain sprocket	Z0200714	Piece
15	5	Hand chain	Z0200715	m
16	1	Left side plate	Z0200716	Piece
17	1	Chain stripper	Z0200717	Piece
18	1	Chain suspension	Z0200718	Piece
19	1	Split pin	Z0200719	Piece
20	1	Pin	Z0200720	Piece
21	3	Load chain	Z0200721	m
22	1	Name plate	Z0200722	Piece
23	1	Brake seat	Z0200723	Piece
25	1	Ratchet disk	Z0200725	Piece
26	4	Name plate rivet	Z0200726	Piece
27	1	Split pin	Z0200727	Piece
28	1	Castle nut	Z0200728	Piece
29	1	Hand wheel cover	Z0200729	Piece
76	1	Dust protection cover	Z0200776	Piece

Not listed items are only available in the module!

Complete parts PREMIUM PRO 5t

Item	Qty.	Description	Part-No.	
47	1	Safety latch assembly, <i>Item 36, 37, 38, 39</i>	Z0200747	Set
49	1	Friction plates assembly, <i>Item 24 (2x)</i>	Z0200749	Set
50	1	Overload protection assembly, <i>Item 51, 52, 53, 54, 55, 56</i>	Z0200750	Set
57	1	Top load hook assembly, <i>Item 40, 47, 58 (2x), 59, 60 (3x), 61 (4x), 62</i>	Z0200757	Set
63	1	Load hook assembly, <i>Item 47, 64 (2x), 65, 66, 67 (2x), 68 (2x), 69 (2x), 71, 73 (2x)</i>	Z0200763	Set
70	1	Ratchet Pawl assembly, <i>Item 10 (2x), 11 (2x), 13 (2x)</i>	Z0200770	Set
72	1	Locking set assembly, <i>Item 7, 30 (2x)</i>	Z0200772	Set

11. Spare parts for Chain Hoist PREMIUM PRO 10t

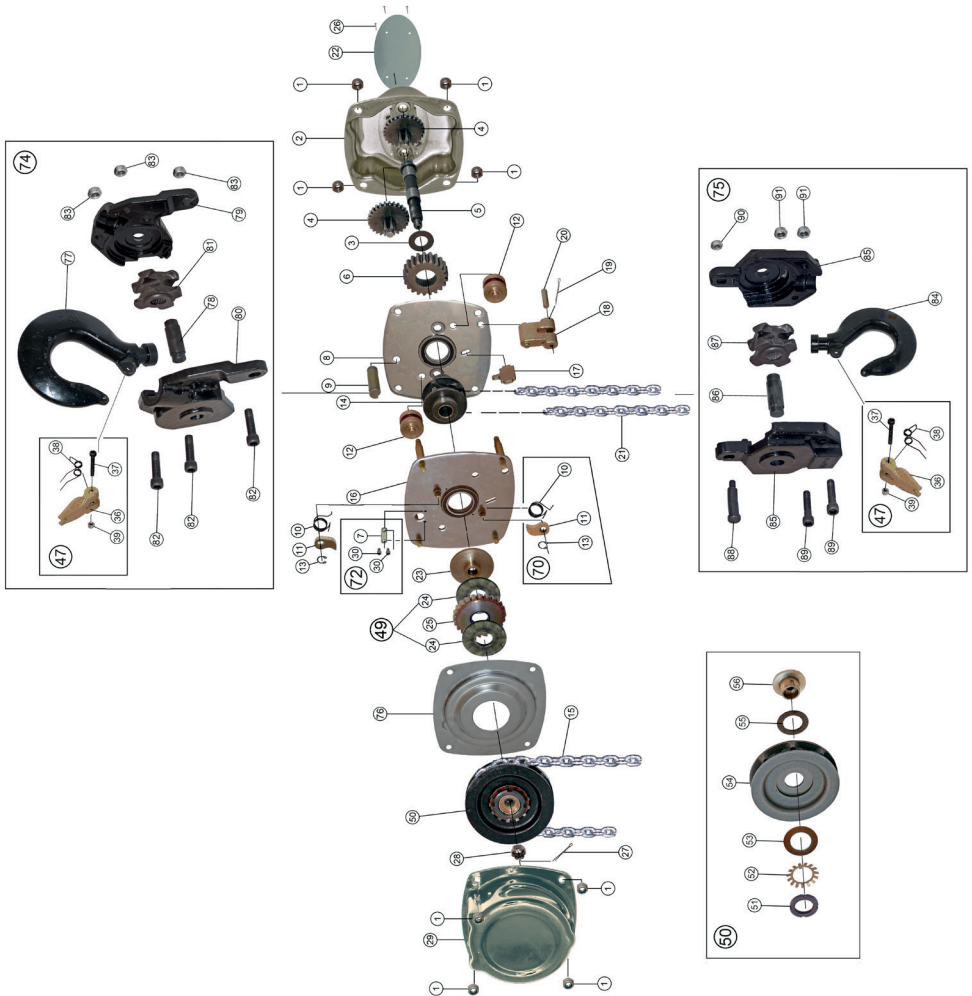

12. Spare Parts List for Chain PREMIUM PRO 10t

Component parts PREMIUM PRO 10t

Item	Qty.	Description	Part-No.	
1	8	Locking nut	Z0200801	Piece
2	1	Gear box cap	Z0200802	Piece
3	1	Washer	Z0200803	Piece
4	2	Gear wheel	Z0200804	Piece
5	1	Driving shaft	Z0200805	Piece
6	1	Center gear wheel	Z0200806	Piece
8	1	Right side plate	Z0200808	Piece
9	1	Top hook pin	Z0200809	Piece
12	2	Chain guide roller	Z0200812	Piece
14	1	Load Chain sprocket	Z0200814	Piece
15	5	Hand chain	Z0200815	m
16	1	Left side plate	Z0200816	Piece
17	1	Chain stripper	Z0200817	Piece
18	1	Chain suspension	Z0200818	Piece
19	1	Split pin	Z0200819	Piece
20	1	Pin	Z0200820	Piece
21	3	Load chain	Z0200821	m
22	1	Name plate	Z0200822	Piece
23	1	Brake seat	Z0200823	Piece
25	1	Ratchet disk	Z0200825	Piece
26	4	Name plate rivet	Z0200826	Piece
27	1	Split pin	Z0200827	Piece
28	1	Castle nut	Z0200828	Piece
29	1	Hand wheel cover	Z0200829	Piece
76	1	Dust protection cover	Z0200876	Piece

Not listed items are only available in the module!

Complete parts PREMIUM PRO 10t

Item	Qty.	Description	Part-No.	
47	1	Safety latch assembly, <i>Item 36, 37, 38, 39</i>	Z0200847	Set
49	1	Friction plates assembly, <i>Item 24 (2x)</i>	Z0200849	Set
50	1	Overload protection assembly, <i>Item 51, 52, 53, 54, 55, 56</i>	Z0200850	Set
70	1	Ratchet Pawl assembly, <i>Item 10 (2x), 11 (2x), 13 (2x)</i>	Z0200870	Set
72	1	Locking set assembly, <i>Item 7, 30 (2x)</i>	Z0200872	Set
74	1	Top load hook assembly, <i>Item 47, 77, 78, 79, 80, 81, 82 (3x), 83 (3x)</i>	Z0200874	Set
75	1	Load hook assembly, <i>Item 47, 84, 85 (2x), 86, 87, 88, 89 (2x), 90, 91 (2x)</i>	Z0200875	Set



CE-Declaration of Conformity
in the sense of 2006/42/EC Guidelines, Appendix II A, 2004/108/EG,
Appendix I and 2006/95/EG, Appendix III

We herewith declare that the

PLANETA-Hebetechnik GmbH, Resser Straße 17, 44653 Herne

that the partly completed machinery

Chain Hoist

in payload range

Modellreihe PREMIUM PRO

250 kg – 30.000 kg

which was developed for lifting and lowering of loads, in the standard version, including load capacity control and meets the basic requirements for the following EC directives, as applicable for the delivered scope:

EG-Maschine-Directive 2006/42/EG

Authorized for the compilation of the relevant technical documentation

Dipl.-Ing. Matthias B. Klawitter, CE-Koordinator,

PLANETA-Hebetechnik GmbH, Resser Straße 17, 44653 Herne

Herne, 02.09.2014

PLANETA-Hebetechnik GmbH



Dipl.-Ing. Paul H. Klawitter
(General Manager)

For the completion, installation and commissioning according to the operating instructions is responsible

Location

Date

Person in charge

Company

Your responsible supplier