

RIGGING ACCESSORIES



BLACK ROUNDSLING - 1M TO 12M CIRC. 0.5M TO 6M EFFECTIVE WORKING LENGTH. WWL=2T

- » Manufactured in Britain
- » 2000kg (2.0t) SWL Round Slings coming with a black cover
- » Suitable to suspend chain hoists / chain motors to and from truss structures for theatrical, stage engineering and production rigging applications
- » Round Slings are available in 1, 2, 3, 4, 5, 6, 7, 8, 9, 10, 11 and 12 metre Circumference
- » 0.5, 1.0, 1.5, 2.0, 2.5, 3.0, 3.5, 4.0, 4.5, 5.0, 5.5, 6.0 metre EWL Effective Working Length
- » Safety Factor 7:1
- » Inspection hole with velcro cover on the round sling
- » Manufactured to BS / EN1492-2:2000 +A1:2008 with UK certificate of conformity supplied

LENGTH	REF CODE:
1m Circ, 0.5m EWL	RS-1M
2m Circ, 1.0m EWL	RS-2M
3m Circ, 1.5m EWL	RS-3M
4m Circ, 2.0m EWL	RS-4M
5m Circ, 2.5m EWL	RS-5M
6m Circ, 3.0m EWL	RS-6M
7m Circ, 3.5m EWL	RS-7M
8m Circ, 4.0m EWL	RS-8M
9m Circ, 4.5m EWL	RS-9M
10m Circ, 5.0m EWL	RS-10M
11m Circ, 5.5m EWL	RS-11M
12m Circ, 6.0m EWL	RS-12M

SOFT STEEL - 1M TO 12M CIRC. 0.5M TO 6M EFFECTIVE WORKING LENGTH. WWL=2T

- » A range of British manufactured 2000kg (2.0t) SWL Soft Steels come with a black cover with steel wire rope inside
- » Suitable to suspend chain hoists / chain motors to and from truss structures for theatrical and production rigging applications
- » Safety Factor 5:1
- » Steel wire rope construction 24 x 2mm 7 x 19
- » Inspection hole with velcro cover
- » Manufactured EN1492-2, EN13411 & EN13411-3 (where applicable)

LENGTH	REF CODE:
1m Circ, 0.5m EWL	SS-1M
2m Circ, 1.0m EWL	SS-2M
3m Circ, 1.5m EWL	SS-3M
4m Circ, 2.0m EWL	SS-4M
5m Circ, 2.5m EWL	SS-5M
6m Circ, 3.0m EWL	SS-6M
8m Circ, 4.0m EWL	SS-8M
10m Circ, 5.0m EWL	SS-10M
12m Circ, 6.0m EWL	SS-12M



RIGGING ACCESSORIES



GREEN PIN SAFETY BOW SHACKLES WITH BOLT AND SAFETY NUT

- » Material: Forged Bow and Pin High Tensile Steel, Grade 6 - Quenched and Tempered
- » Working Load Limit permanently shown on every shackle
- » Safety Factor: Industry leading 6 to 1 MBL
- » Standard: EN 13889 and meets the performance requirement of US Federal Specification RR-C-271F Type IVA, Class 2, Grade A
- » Meets the performance requirements of EN 13889:2003
- » Temperature range -40 ° C upto +200 ° C
- » Supplied with proof load certificate, material certificate available on request

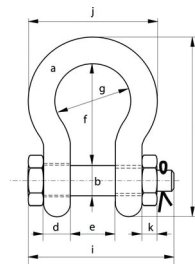

SIZE	PRODUCT CODE:
2.0t	S2.0-B-BN
3.25t	S3.25-B-BN
4.75t	S4.75-B-BN
6.5t	S6.5-B-BN

GREEN PIN STANDARD BOW SHACKLES WITH SCREW COLLAR PIN

- » Material: Forged Bow and Pin High Tensile Steel, Grade 6 - Quenched and Tempered
- » Working Load Limit permanently shown on every shackle
- » Safety Factor: Industry leading 6 to 1 MBL
- » Standard: EN 13889 and meets the performance requirement of US Federal Specification RR-C-271F Type IVA, Class 2, Grade A
- » Meets the performance requirements of EN 13889:2003
- » Temperature range -40 ° C upto +200 ° C
- » Supplied with proof load certificate, material certificate available on request

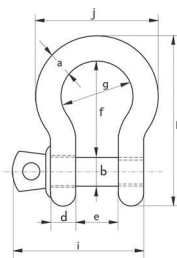

SIZE	PRODUCT CODE:
2.0t	S2.0-B-SP
3.25t	S3.25-B-SP
4.75t	S4.75-B-SP
6.5t	S6.5-B-SP

THEATRE SHACKLE - BOW SHACKLE WITH SCREW PIN - BLACK PAINTED THEATRICAL

- » Material: Forged Bow and Pin High Tensile Steel, Grade 6 - Quenched and Tempered
- » Working Load Limit permanently shown on every shackle
- » Finish: Flat black (RAL 9021) baked on power coat finish
- » Safety Factor: Industry leading 6 to 1 MBL
- » Standard: EN 13889 and meets the performance requirement of US Federal Specification RR-C-271F Type IVA, Class 2, Grade A
- » Meets the performance requirements of EN 13889:2003
- » Temperature range -40 ° C upto +200 ° C
- » Supplied with proof load certificate, material certificate available on request

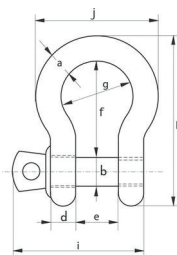

SIZE	PRODUCT CODE:
2.0t	SB2.0-B-SP
3.25t	SB3.25-B-SP
4.75t	SB4.75-B-SP
6.5t	SB6.5-B-SP

COMPANY CONTACT DETAILS

LTM - Lift Turn Move Ltd
Unit 2 Stadium Court
Wirral International Business Park
Plantation Road, Bromborough
Wirral, UK CH62 3QG

SALES AND GENERAL CONTACTS

Tel: +44 (0)151 649 0467
Fax: +44 (0)151 649 0099
Email: sales@LiftTurnMove.co.uk
Email: accounts@LiftTurnMove.co.uk
Website: www.liftturnmove.co.uk

OPENING HOURS

Mon-Thur: 8:30 - 5:00
Friday: 8:30 - 2:30

The office is often open outside these times.

DELIVERIES

We use various methods of delivery and can deliver more or less whenever you need.

To stay up to date with the latest events at LTM please follow us on Facebook, Twitter and LinkedIn



liftturnmove



@LiftTurnMove



@Lift Turn Move Ltd