

USB3.0 (USB-A or USB-C) to
Dual HDMI Adapter Supports
4K@30Hz+1080P@60Hz for
Windows and Mac OS

USER MANUAL

Follow us on Youtube
and Facebook



www.orei.com

Table of Contents

Safety Instructions	04	Driver Installation	11
Introduction	05	Display Mode Setting	17
Features	06	Support Resolution	18
Package Contents	06	Specifications	19
Operation Controls and Functions	07	Troubleshooting Common Issues	21
System Requirements	08	Connection Diagram	22
Resolutions	08		

Thank you for purchasing this product

For optimum performance and safety, please read these instructions carefully before connecting, operating or adjusting this product. Please keep this manual for future reference.

Surge protection device recommended

This product contains sensitive electrical components that may be damaged by electrical spikes, surges, electric shock, lightning strikes, etc. Use of surge protection systems is highly recommended in order to protect and extend the life of your equipment.

Please Activate your warranty by registering our product through the link below - <https://www.orei.com/pages/warranty-registration>

Technical Support

Need Help?

Our experienced Technical Support Team is here for you to answer your questions, give technical advice or help troubleshoot your project to get you installed on time and on budget. Call, email or chat with us now.

OREI Live Technical Support Hours

US team (US/Canada/Mexico): Monday-Friday, 9 a.m. - 6 p.m. Central Time

Support Email - info@orei.com | Support Number - 877-290-5530

Or

Chat Live on www.orei.com

Send us an instant message now. Our Technical Support Team will respond momentarily. Available during live support hours.

Safety Instructions

Before using this product, please carefully read the following safety instructions to ensure its proper use and keep this manual for future reference:

1. To prevent electric shock, do not attempt to open the product.
2. Only qualified personnel should perform any repairs or maintenance.
3. Always place the product on a stable, flat surface to prevent it from falling.
4. Do not expose the product to water, moisture, or high-humidity environments to avoid the risk of damage.
5. To prevent damage from direct sunlight or high temperatures, do not expose the product to such environments.
6. Do not place the product near heat sources like radiators, heat registers, stoves, or other heat-producing apparatus.
7. Do not place any objects on top of the product to avoid damage.
8. Use only the attachments and accessories specified by the manufacturer.
9. During lightning storms or prolonged periods of disuse, unplug the power supply to prevent damage.

Introduction

The USB 3.0 to HDMI Dual Display Adapter, which connects USB-A or USB-C to two HDMI displays. This adapter is designed to support Mirror/Extend/Rotate/Clamshell modes and can display up to 4K@30Hz and 1080p@60Hz. This adapter allows you to extend or duplicate your Laptop or computer screen to two displays adding accesibility and convenience to your setup. We have tested this product to meet all specifications and features. To ensure long-term enjoyment of this product, please read the following information before installation.

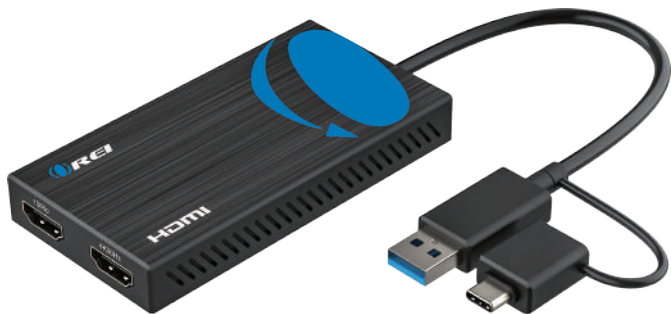

Features

1. Dual display output, supporting one display at 4K@30Hz and another at 1080p@60Hz.
2. Supports video decoding in multiple formats, including H.264, H.263, MP4, MP2, DivX, AVS, JPEG, and more.
3. Compatible with USB-C, USB-A, Thunderbolt 3/4, and USB 4 standard ports.
4. Allows you to extend your PC screen to multiple displays, supporting up to 8 displays on Windows and up to 6 displays on Mac OS.

Package Contents

USB 3.0 to HDMI Dual Display Adapter

User Manual

Operation controls and functions

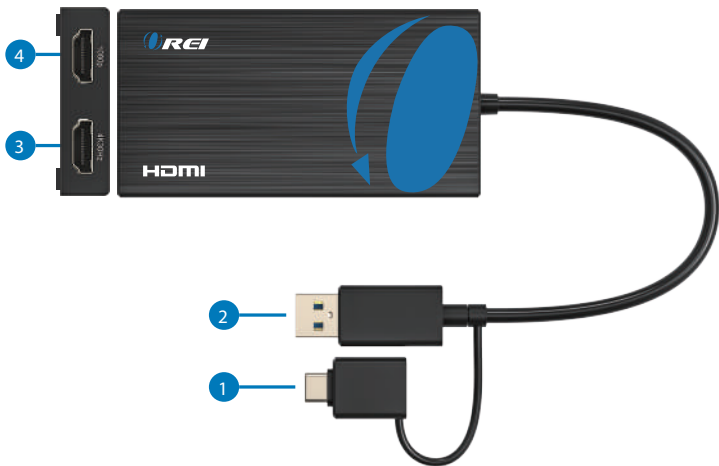

- 1 USB-C Male Adapter: Connect to the USB-C port of Laptop/Notebook with USB3.0 Data Output
- 2 USB3.0 Port: Connect to the USB 3.0 Data Port of the PC/ Laptop/ Notebook/USB 3.0 Hub
- 3 4K30Hz: Connect to HDMI Display to Output Resolution up to 4K@30Hz Max
- 4 1080p: Connect to HDMI Display to Output Resolution up to 1080p Max

System Requirements

To ensure proper installation and operation of this product, please ensure that your system meets the following requirements:

1. Windows 7/8/8.1/10 and above or Mac OS 10.10.x and above.
2. CPU Processor: Core i5 and above.
3. RAM: 4GB and above.
4. Monitor: Supports 4K resolution.

Resolutions

OS/Ports		1080p Port	4K Port
Windows	Mirror mode	1920x1080@60Hz	1920x1080@60Hz
	Extend mode	1920x1080@60Hz	3840x2160@30Hz
Mac OS	Mirror mode	1920x1080@60Hz	3840x2160@30Hz
	Extend mode	1920x1080@60Hz	3840x2160@30Hz

Driver Installation

Enter the website:

www.siliconmotion.com>Products>Graphics-Display-SoCs>

Downloads>Drivers, and download the correct driver zip file as follow:

The screenshot shows the SiliconMotion website's driver download page for the SM76x series. The page is titled "SM76x Driver Download" and features a navigation menu with "Windows", "macOS", and "Android" sections. Each section contains a table of driver versions, release dates, and download links. The Windows section lists a driver for Windows 11, 10, 8.1, 7, and 8.1. The macOS section lists three drivers, including a recommended one for macOS 10.13 Catalina and later, and two legacy drivers for older versions. The Android section lists a driver for Android 7.1 and above. A QR code and a "Download" button are also visible at the bottom of the page.

Windows				
OS Description	Version	Release Date	Release Notes	Download
Windows 11, Windows 10, Windows 7, Windows 8.1 Driver	V0.18.881	Jan 2, 2022	Release Notes	Download

macOS				
OS Description	Version	Release Date	Release Notes	Download
Recommended: Download Display application with OS. Support macOS 10 Ventura, 12 Monterey, 11 Big Sur and 10.12 Catalina including MacBook Air/Pro (M1/M2) & Intel processor	V0.14.894	Jan 5, 2023	Release Notes	Download
Legacy Display Driver for macOS 10.13 Catalina, 10.14 Mojave and 10.13 High Sierra	V0.2.16.0	Jan 3, 2021	Release Notes	Download
Legacy Display Driver for macOS 10.10, 10.11 and 10.12	V0.1.10.001	Dec 12, 2016	Release Notes	Download

Android				
OS Description	Version	Release Date	Release Notes	Download
Android 7.1 and above	V0.14.8.0	Jan 10, 2022	Release Notes	Download

Driver Installation

1. Unzip the driver file, and double click to open the “.exe” file, and then click “INSTALL”.



Note: If a security prompt pop-up appears, click “INSTALL”.

Driver Installation

2. After installation, click "REBOOT" to restart the computer.

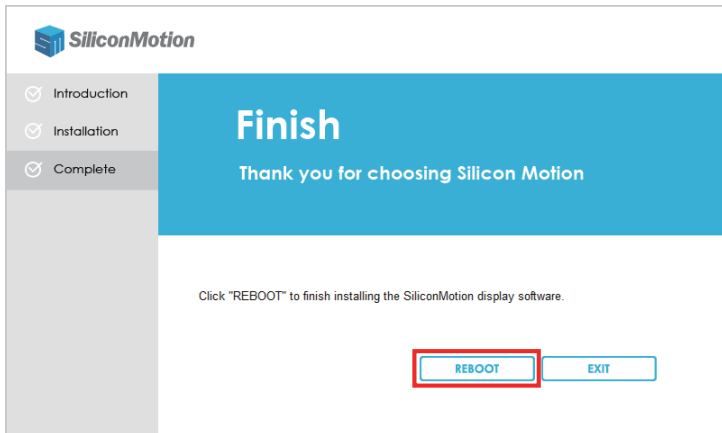

Display Mode Setting

For Windows

1. Right click the blank space on the desktop and select "Display settings".

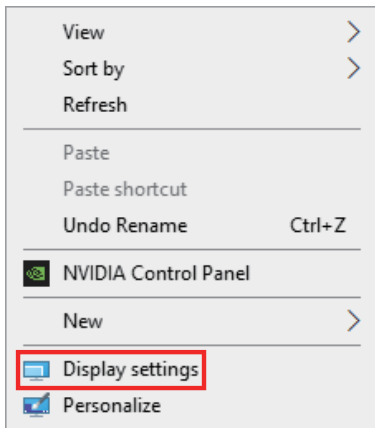

Display Mode Setting

2. At the “Display” area, click each of the display icons to set the needed resolution or other settings.

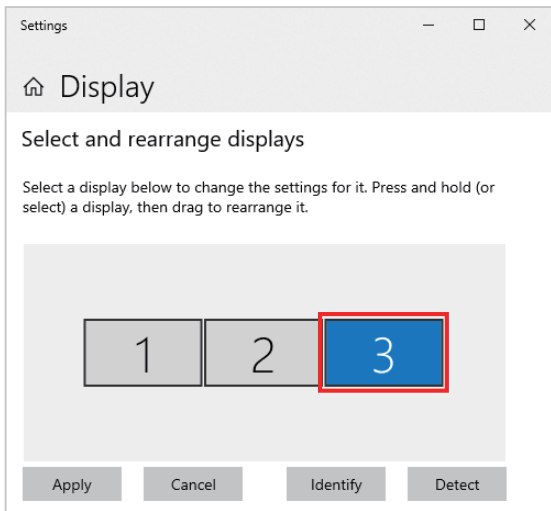

Display Mode Setting

3. Scroll down to “multi display settings” and select the desired mode in the drop-down list.

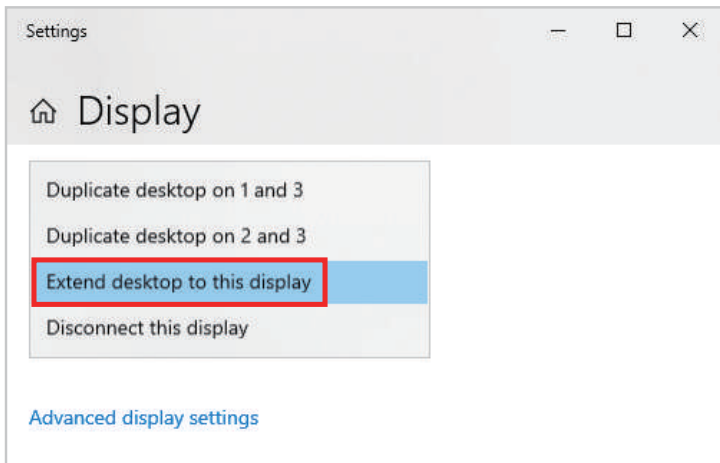

Display Mode Setting

For Mac OS

1. Left click the apple icon and select "System Preferences", and click "Displays".

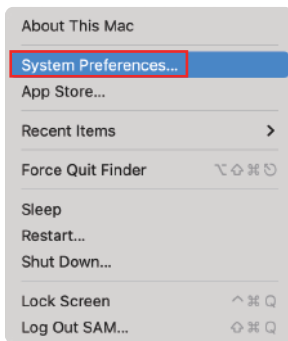

Display Mode Setting

2. At the "Display" area, click each of the display icons to set the location or change to mirror or extend mode.

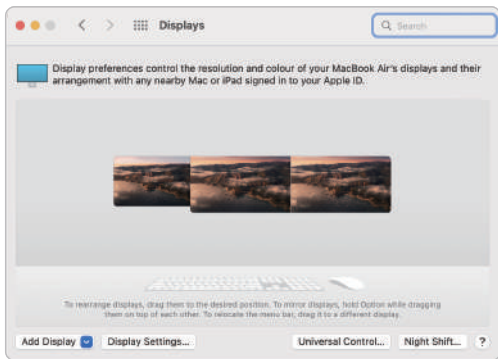

Display Mode Setting

3. Click “Display Setting”, and choose each connected display to set correct resolution and mode.

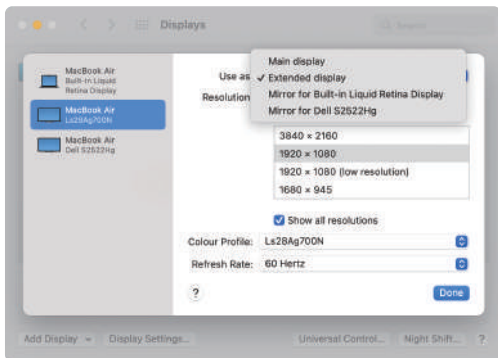

Note :

1. Please note that Mac-based devices do not support rotation mode, but M1/M2 Mac supports clamshell mode while Intel Mac does not.
2. To use this adapter, your USB-C™/USB3.0 equipped device must support USB 3.0 data transmission.
3. Please be aware that this adapter does not support playback of HDCP-protected content on sites like Netflix and Hulu.

Support Resolution

	1080p Port	4K Port
Windows	1920x1080@60Hz	3840x2160@30Hz
	1680x1050@60Hz	2560x1440@60Hz
	1600x1200@60Hz	1920x1080@60Hz
	1600x900@60Hz	1680x1050@60Hz
	1440x1050@60Hz	1600x1200@60Hz
	1440x900@60Hz	1600x900@60Hz
	1280x1024@60Hz	1440x1050@60Hz
	1280x800@60Hz	1440x900@60Hz
	1280x720@60Hz	1280x1024@60Hz
	1152x864@60Hz	1280x800@60Hz
	1024x768@60Hz	1280x720@60Hz
	800x600@60Hz	1152x864@60Hz
	720x480@60Hz	1024x768@60Hz
	640x480@60Hz	800x600@60Hz
	-	720x480@60Hz
-	640x480@60Hz	
Mac OS	1920x1080@60Hz	3840x2160@30Hz
	1920x1080@30Hz	2560x1440@60Hz
	1600x900@60Hz	1920x1080@60Hz
	1280x720@60Hz	1920x1080@30Hz
	-	1600x900@60Hz
	-	1280x720@60Hz

Specification

Input Ports	USB-C Male or USB 3.0 Male x 1
Output Ports	HDMI x 2
Data Transmission Rate (Max)	5Gbps
Data Transmission Standard	USB 3.0 (USB 3.1 GEN 1)
Compatible OS	Windows 7/8.1/10/11 and above Mac OS 10.10.x and above Android 7.1 and above (Android devices only support mirroring mode with resolutions up to 1080P)
Operating Temperature	0°C to 60°C
Storage Humidity	5% to 90% RH non-condensation
Power Supply	USB3.0 USB-C from PC or notebook
Power Consumption (Max)	5W
Unit Cert	FCC, CE, RoHS
Dimension (LxWxH)	3.94x 1.97x0.53in (100x50x13.5mm)
Net Weight	78g
Material	ABS
User Manual	English Version

Note: Specifications are subject to change without notice.

Troubleshooting Common Issues

Q: My USB 3.0 to HDMI Dual Display Adapter is not working.
What should I do?

A: First, please check the following:

1. Ensure that your device's USB port has a current output of 900mA or more. If not, try a different port.
2. Check if the correct drivers have been installed on your device.
3. Make sure that your HDMI cable and adapter are securely connected to your device.
4. Verify that your video source is compatible with the adapter.
5. Restart your device and see if this resolves the issue.

Q: My second display flickers when I use the adapter.
What could be causing this?

A: This may be caused due to loose fitting cables or incompatible video source or USB ports

1. Make sure the HDMI cable and adapter are securely connected.
2. Try using a different HDMI cable to see if this resolves the issue.
3. Check that your device is providing sufficient power to the adapter (900mA or more).
4. Verify that your video source is compatible with the adapter.
5. Try using a different USB 3.0 port or restarting your device.

Troubleshooting Common Issues

Q: The adapter is not displaying video on my second monitor.
How can I fix this?

A: Please check the following items:

1. Ensure that your HDMI cable and adapter are securely connected.
2. Verify that your video source is compatible with the adapter.
3. Check the driver version for the adapter, and make sure it is up-to-date.
4. Make sure your device is providing sufficient power to the adapter (900mA or more).
5. Try using a different USB 3.0 port or restart your device.

Connection Diagram

1. Mirror Mode

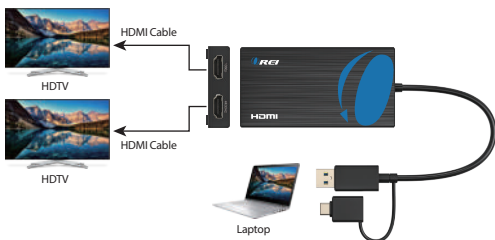

2. Extend Mode

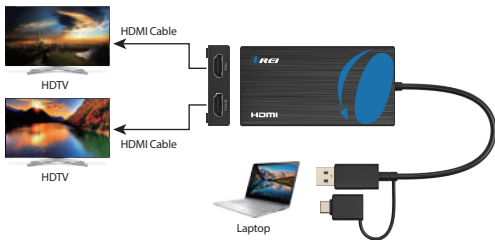

HDMI™
HIGH-DEFINITION MULTIMEDIA INTERFACE

The Adopted Trademarks HDMI, HDMI High-Definition Multimedia Interface, and the HDMI Logo are trademarks or registered trademarks of HDMI Licensing Administrator, Inc. in the United States and other countries.

All other trademarks, registered trademarks, or service marks are the property of their respective owners.



USB3.0 (USB-A or USB-C) to
Dual HDMI Adapter
Supports 4K@30Hz+1080P@60Hz
for Windows and Mac OS

www.orei.com

© 2023