

- ✓ 1 Fitting – 3 Tubing Sizes – SAVE TIME!
- ✓ Barbed Insert Combines with Compression Collar for Superior Retention Strength
- ✓ Ergonomic Collars Reduce Worker Fatigue
- ✓ Twist-Off Collar Makes Fittings Reusable

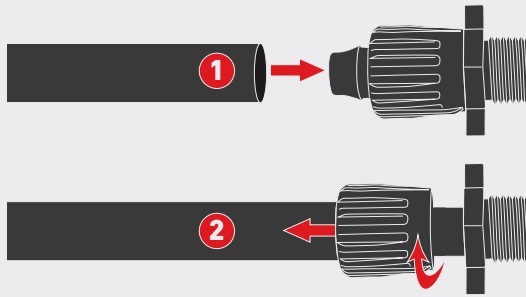

### INSTALLATION TIPS

Turn collar clock-wise until it bottoms out on the base of the fitting.

Push tubing onto barb until tubing is fully inserted.

Turn collar counter-clock wise until collar is hand-tight and tubing is securely in place.

<p><b>TL-C</b> Tri-Loc Coupling</p>	<p><b>TL-E</b> Tri-Loc Elbow</p>	<p><b>TL-T</b> Tri-Loc Tee</p>	<p><b>TL-M50</b> Tri-Loc 1/2" MPT Adapter</p>
<p><b>TL-M75</b> Tri-Loc 3/4" MPT Adapter</p>	<p><b>TL-FH75</b> Tri-Loc 3/4" FHT Adapter</p>	<p><b>TL-T-F50</b> Tri-Loc 1/2" FPT Tee</p>	<p><b>TL-T-M50</b> Tri-Loc 1/2" MPT Tee</p>
<p><b>TL-T-S50</b> Tri-Loc 1/2" Slip Tee</p>	<p><b>TL-CAP</b> Tri-Loc MHT Cap</p>	<p><b>TL-BV</b> Tri-Loc Ball Valve Coupling</p>	<p><b>TL-C-HDR</b> 20mm OD x 20mm OD Coupling</p>
<p><b>TL-M75-HDR</b> 20mm OD Hose x 3/4" MPT Adapter</p>	<p><b>TL-CAP-HDR</b> 20mm OD Hose x MHT Cap</p>	<p><b>TL-T-HDR</b> Tri-Loc reducing header tee connects 16, 17 and 18mm OD dripline and drip hose to Toro® T-EHD2057 hose with .805 ID. TL-T-HDR fitting also works with hose ID of .790 - .845" (20 - 21.5mm)</p>	