



Installation Manual and Operating Instructions

Contents

SAFEGUARDS CAUTIONS	----- 1
COMPONENTS NAME	----- 4
COMPONENTS LIST	----- 13
CONTROLLER	
Control Panel	----- 8
Operation	----- 6
INSTALLATION	
Installation	----- 9
Cautions	----- 12
OPERATION INSTRUCTION	
Operation function	----- 10
Maintenance	----- 13
CLEANING AND CARE	
Cleaning of Nozzle	----- 14
Cleaning of Filter	----- 13
Dismantling	----- 14
TROUBLE SHOOTING	
SPRCIFICATIONS	----- 16



- Thank you very much for selecting ,Please read the manual carefully prior to use.
- The pictures in the manual are for reference only.

1. SAFEGUARDS CAUTIONS

Please strictly follow the following cautions to prevent any malfunction. Failure to observe the following safeguard cautions may result in serious accidents. Please strictly observe the following content, for your safety. Please leave these instructions and warranty info with the product. If you have any question about our product please contact us.

	WARNING: Improper use of the product could lead to death or injury.
	CAUTION: Improper use of the product could lead to minor injury or property damage.
	Do not dismantle, repair or remodel the product. Only qualified service personnel should service this product.
	Never install the product in a place with high humidity or contact with water. Maintain ventilation inside the room for air to circulate.
	Do not plug or unplug the power plug with wet hands.
	Please make sure the supply water is clean, with sufficient water pressure.
	<ol style="list-style-type: none"> 1. Please use power socket with Min 1600W. 2. Please use power socket with AC 220-240V, 50-60HZ. 3. Ensure that power supply is grounded. 4. The remote control uses two Num.5 batteries or 9V rechargeable batteries. 5. Please use the accessories that come with this product to connect the water pipes.

Prolonged use may cause low-temperature burns
 Carer should set the seat temperature in "LOW" mode when children, the elderly and patients, people who cannot adjust the temperature by themselves are using the product.

Do not dismantle, repair or remodel the product. Only qualified service personnel should service this product.

1. SAFEGUARDS CAUTIONS

To ensure your safety, please read this page carefully before using the product.

Ensure that power supply is grounded. 	Do not plug or unplug the power plug with wet hands.
Do not connect to power before connecting the product with water. Please make sure the power socket to be 220-240V. 	Properly plug the power plug into the power socket.
When cleaning the plastic parts of the product, Do not use unsuitable detergents (toilet cleaner, apartment cleaner, decolorizer, benzene, paint thinner, scouring powder, abrasive cleaners, alcohol, etc.). 	Please regularly dust the surface of the power plug. Unplug before cleaning and only use a dry cloth.
The power outlet should be above 0.8m from the floor, and away from water. 	Please make sure the supply water is clean. Otherwise may cause skin irritation or corrode the internal of the product that lead to electroduction or fire.

1. SAFEGUARDS CAUTIONS

Do not roughly open and close the seat and toilet lid.

Do not stand or sit on the seat cover lid.

Do not curve, twist or damage the water supply hose.

It may cause the water leakage.

Keep the product away from flammable materials at all times to prevent a fire hazard.

Do not put your finger into the cover of dryer or nozzle. Do not block the outlet of warm air.

Avoid direct sunlight. Keep heater or warmer, etc. away from the E-bidet.

In case of thunder and lightning nearby, please disconnect the power plug from the plug seat.

In weather where freezing may occur, please take anti-freeze measures to prevent damage caused by freezing.

3

2. COMPONENTS NAME

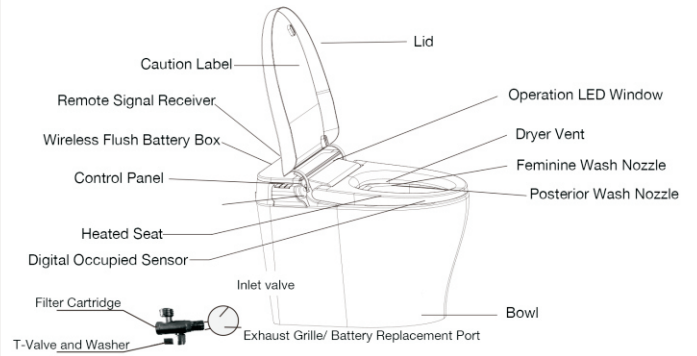

PRODUCT SIZE: 680x400x480mm
680x400x520mm



注意

1. 严禁踩踏本体及座盖
2. 请勿使用香蕉水、汽油、药品、清洁剂或杀虫剂擦拭本产品。
3. 长时间坐在智能座便器上，请把座温调至低温，避免灼伤。以下人群敬请注意：低温烫伤：幼儿，老人，患者，无法自助行为能力者以及服用含有安眠成分药物的人，醉酒的人，过度疲劳的人。
4. 在产品通电未供水时，请勿将产品倒置，以免造成加热管干烧故障

4

3. OPERATION INSTRUCTION

Adding detergent to the flush tank:

1). Press to open the top cover.



2). To open the container hold the lid and twist anti-clockwise.

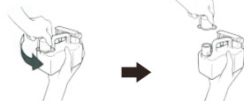

3). Add detergent into the container. (Use only non-corrosive detergents)



4). Align the container with the notch and put it back.



5). Put the lid back and twist clockwise.



6). Close the top cover.



Confirmation Before Using

- 1). Confirm that the water pipes and nozzles are not leaking. Wipe with paper towel after drying to check.
- 2). Check if the nozzle can work properly under various functions. Is drying, deodorization working properly. Check the spray strength, water temperature, wind temperature and seat temperature.



5

3. OPERATION INSTRUCTION

Operation button instruction:

- AUTO** Automatic Operation: Automatic spraying and then drying.
- Drying** Air outlet blowing dry with warm air
- Stop Button**: A short press would pause the current action. Press and hold to turn off the power.



Integrated Bluetooth chip

Twist clockwise for feminine wash, anti-clockwise for posterior wash. Press the center to flush when power is out.

Temperature Display:



Water temperature

Seat temperature

Display Confirmation

- Ensure the temperature display is on.
- If the water temperature is not on, use controller to adjust water temperature.
- If the seat temperature is not on, use controller to adjust seat temperature.



WARNING: Please make sure the power socket to be 220~240V.

6

3. OPERATION INSTRUCTION

Basic Operation

Lid can be opened manually



When body sensor detects human body in certain distance, the lid would open automatically. You can open the seat by kicking the base gently.



Functions will only work when seat sensor has been activated. A "click" sound will be heard.



When leaving the seat and body sensor can not detect human body, the lid and seat would close in 90 seconds automatically.



When leaving the seat, the toilet will flush in 5 seconds automatically.



The self cleaning function would let the product flush once every 72 hours when no operation is done.



About Seat Sensor

The seat sensor detects if there are people on the seat. Functions only work when seat sensor has been activated.



You can perform some functions by tapping the bottom of the bowl:

- To open the lid, tap once
- To open the seat, tap twice.
- To flush the toilet, tap three times



Foot Kick Sensor

7

3. OPERATION INSTRUCTION

Control Panel

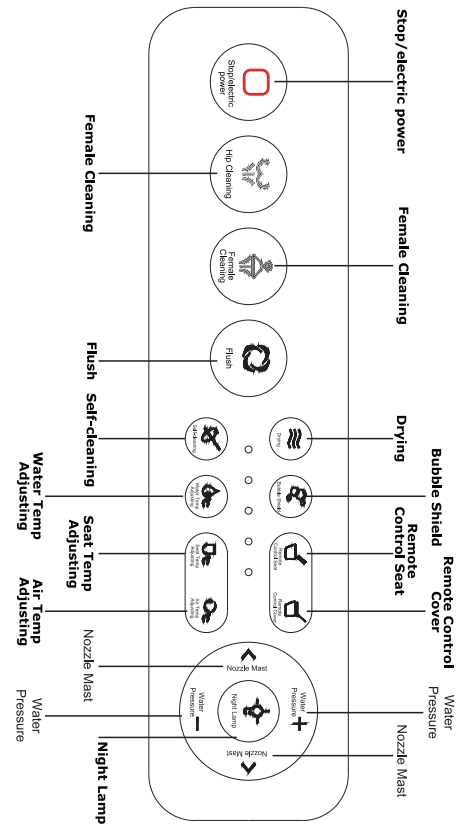

8

4. INSTALLATION

Environmental Check Up Before Installation

1). Installation should take place after the bathroom walls and the floor tiles has completed construction, and had reserved for the drainage pipe, water and circuit as shown in the figure. Pick the corresponding toilet according to the **toilet drain distance** (300mm,400mm); **inlet water pressure** range: 0.15mpa (dynamic) - 0.75mpa (static); **inlet water temperature**: 4-35 degrees Celsius.

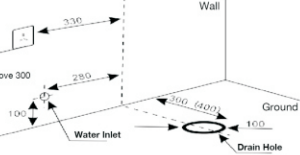

2). Install the **water inlet valve** on the wall 100mm high from the ground and about 280mm left from the center of the drain hole.

CAUTION: Please use the water inlet valve provided with the product.

Installation of Toilet Bowl

- Apply the glass glue evenly on the top and bottom of the flange ring and set it on the drain hole. Then align the pipe hole of the toilet base with the flange ring and gently place the toilet horizontally on the ground.
- Apply glass glue at the connection between the bottom of the toilet bowl and the floor.

Installation of Water Supply Hose

- Connect the filter cartridge with the T-valve.
- Install the T-valve to the water inlet.
- After the installation of the toilet bowl, connect the hose with the T-valve.



Before using the toilet for the first time, please make sure:

1). Power plugged into the socket

Insert the plug into a 220v socket, the indicator light of the earth leakage protector lights up.

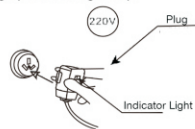

2). The water inlet valve is open

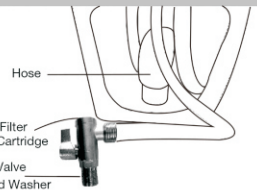

9

5. OPERATION FUNCTION

- Posterior Wash** When you sit down on the seat, press "Posterior Wash". Automatically, the nozzle comes out and sprays warm water to posterior. Press twice to activate oscillating mode.
- Feminine Wash** When you sit down on the seat, press "Feminine Wash". Automatically, the nozzle comes out and sprays warm water to feminine area. Press twice to activate oscillating mode.
- Dryer** Press "Dry", warm, dry air is gently directed to washed area for 3 minutes.
- Stop** Press this button to stop all operation. Shut down: with power ON, press "Power ON/OFF" button for more than 6 seconds will shut down the product. Starting: with power OFF, press "Power ON/OFF" button can restart the power supply
- Water Pressure** Press high, or low to adjust the pressure of the water spray to your desired comfort level from 1 to 3 pressure levels.
- Nozzle Position** Nozzle position is adjustable to the desired position by pressing up arrow (front) or down arrow (back) from 1 to 5 positions.
- Water Temperature** Press high, or low to adjust the temperature of the water temperature to your desired comfort level from 1 to 4 temperature levels.
- Seat Temperature** Press high, or low to adjust the temperature of the seat temperature to your desired comfort level from 1 to 4 temperature levels.
- Light** The light is for using the toilet during night time. Press the light button to turn on/off the light beneath the seat.
- Energy Save Mode** Press this button to enter power save mode. When the product is not in use, it lowers the temperature of sea at 25 degrees to control power consumption. When seated, the seat temperature would return to set temperature.

10

6. CAUTIONS

Earth leakage protection plug Confirmation

- 1) Check whether the working light is lit after plugging in, if it is not lit, please press the reset button to power on.
- 2) When the working light is on, press the test button to check whether the power can be disconnected. Then press the reset button again to check whether the power can be reconnected. If it does not work properly please stop using it.
- 3) Please do not use it as a power switch.
- 4) If there is a failure, it must be replaced by a professional.

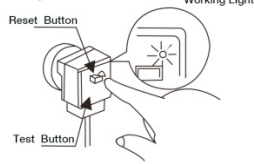

WARNING



11

6. CAUTIONS

Seat Sensor Is Available

If the seat is not occupied and Posterior or Feminine button is pressed, the function will not activate because seat sensor will detect that the seat is not in use. As long as the seat is not occupied, shower, bidet and warm air dry will not be activated. Incorrect sitting posture or if a child is using the seat, the sensor may not operate, at this time, please adjust seated posture according to seat sensor.

Tips For Power Saving

- When seat is not use keep lid closed.
- Ensure temperature is suitable.
- When not in use, use available power saving function as much as possible.
- Disconnect the product when the product is not going to be used for an extended period of time.

The Cover And Seat Closes Slowly

This product is equipped with a damper, can avoid the impact sound when closing the seat and seat cover.

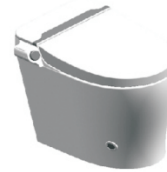

Water Comes Out From Nozzles

When the seat is occupied or the cleaning functions are activated, there may be water coming out from nozzles.



Such phenomenon is the design of the product and not a product fault.

12

7. MAINTENANCE

Packing Material List

NUM.	NAME	QUAN.	DESCRIPTION
1	Main Unit	1	
2	Water Supply Hose	3	Angle valve with filter, seal washer with water hose connected in e-bidet
3	Filter	1	
4	Remote Control	1	
5	Accessories	1	Mounting bolts, batteries, double sided glue
6	Flange Ring	1	
7	Manual	1	
8	Foot Kick Sensor	1	Installed on the bowl body

Cleaning and Care

Cleaning and care of seat, lid and protective cases

- Clean the nozzle under power on condition.
- Use a soft damp cloth to clean and always clean marks off as soon as possible to prevent stains from forming.
- It is very easy to remove E-bidet, and it is recommended that the eBidet is removed when cleaning behind seat and lid.
- Please ensure that eBidet is powered off when cleaning seat.

Cleaning and Care of Filter

If you feel that the spray strength of the nozzle or toilet flushing strength has weakened after using the toilet for a long time, please clean the screen as follows. (Cleaning frequency depends on local water quality)

1) Close the water valve and stop the water supply.

2) Remove the screen from the filter.

3) Rinse the dirt from the filter with a small brush and water.



4) Put the strainer back in and tighten the water supply hose.
5) Test after the cleaning.

- Close the water supply when cleaning the filter.
- Tighten the water supply hose to avoid water leakage.

13

7. MAINTENANCE

Take Off the E-Bidet

- 1) Unplug or turn off the power supply.
- 2) Turn off the water inlet valve clockwise to stop the water supply.
- 3) Unscrew the water supply pipe after bidet and note down the respective connection parts.
- 4) Grab the left and right sides of the bidet and lift it upward to separate the e-bidet from the ceramic.

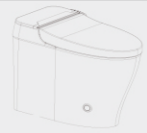

Anti-freezing measures

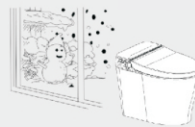

In cold weather, the machine can be damaged and leak due to water freezing. To prevent freezing, do not unplug to keep the machine in standby mode.

To prevent freezing, the control system will detect the room temperature. Automatic heating is performed when it falls below 5 degrees.

CAUTIONS

- 1) Please do not pull the power cord and water supply pipe.
- 2) Please be careful and gently place the e-bidet after removing it.
- 3) Do not place the e-bidet upside down.

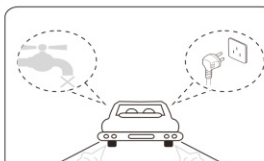

When the toilet is not used for a long time, please cut off the power and water supply.

Filter Cleaning Frequency

If the water quality is not good in the area where you live, please clean the filter regularly (once every 3-6 months) to avoid mineral clogging.

14

8. TROUBLE SHOOTING

Function /Parts	Symptoms	Probable causes	Recommended action
Whole	All functions are not working	Power is turned off	Confirm if power is turned on
		Not Plugged into socket	Insert the power plug securely
		Power Outage	Confirm after power is on
Prostrior wash / Feminine wash	Water does not spray out of nozzles	Water supply valve is off	Turn on the water supply valve
		Mesh of filter is blocked	Clean the filter
		Seat sensor not been activated	Adjust sitting position, posture etc
		Water outage	Confirm after water is back
	Weak pressure	spray strength is set to "LOW"	Set spray strength to "HIGH"
		Mesh of filter is blocked	Clean the filter
	Stopped while using	Set time is up (120s)	Use after a few moments
		Seat sensor deactivate	Adjust sitting position, posture etc
	Low temperature	water temperature is set to "LOW"	Set water temperature to "HIGH"
	Dryer	Low temperature	Air temperature is set to "LOW"
Stopped while using		Set time is up (120s)	Use after a few moments
		Seat sensor deactivate	Adjust sitting position, posture etc
Seat Heater	Low temperature	Seat temperature is set to "LOW"	Set seat temperature to "HIGH"
		Energy save is on	Turn off energy save mode
Alarm	Water temp flashing	Unplug or turn off the power, and then repower. If the fault persists, contact the manufacturer or local repair facility	
	Seat temp flashing		
	All light flashing	Unplug or turn off the power and check if the water is in outage	
	Water leakage	Turn off the water valve, check the water hose for leaks, contact the manufacturer or local repair facility	

15

9. SPECIFICATIONS

Rated voltage		AC 220V 50/60Hz
Rated power		1250W
Cabel length		1.5 m
Water pressure range		0.15 Mpa (flow) ~ 0.75 Mpa (hydrostatic)
Wash	Wash volume	Posterior wash volume 0.75L/min Max.
		Feminine wash volume 0.85L/min Max.
	Pressure	4 adjustment levels
	Temperature	Off (water temperature) Low (about 34°C) Mid (about 37°C) High (about 40°C) 4 adjustment levels
Power of heater		1600W
Safety device		Temp. sensor, Temp.fuse, High Temp.sensor switch
Seat	Power of heater	45W
	Damping cushion	The seat cover and seat ring slowly raise and lower
	Temperature	Off (water temperature) Low (about 34°C) Mid (about 37°C) High (about 40°C) 4 adjustment levels
Safety device		Temp.sensor, Temp. fuse
Dryer	Power of dryer	270W
	Temperature	Off (water temperature) Low (about 34°C) Mid (about 37°C) High (about 40°C) 4 adjustment levels
	Safety device	Fan blockage protection,Temp.sensor, Temp. fuse
Spray Type		Jet Siphon
Environment Temp.		0~50 Degrees Celsius

Implementation Standard: GB-4706.1-1998 GB4706.53-2002 GB/T6952-1999
 CAUTION: When the water pressure is lower than 0.2Mpa, it is recommended to install a booster pump, otherwise may affect the normal use.



16