

PARTS LIST:

- **2** Mounting Panel

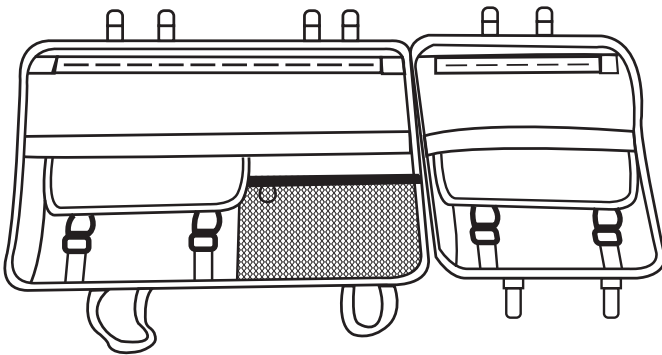

- **4** Storage Bags
- **1** Utility clip with carabiner

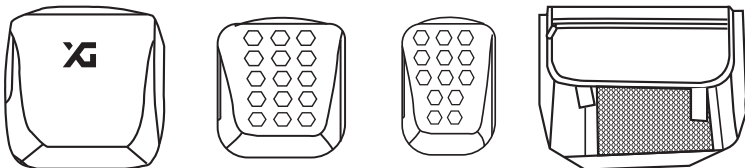

SCAN FOR INSTRUCTIONAL VIDEO:

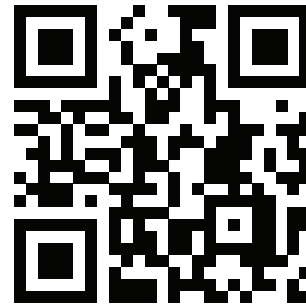

Scan the QR code with your smartphone and it will take you to the link below:

<https://qrgo.page.link/yYQYH>

INSTALLATION TIME & SKILL LEVEL:

No Tools required



15-20 minutes, Skill Level 01

WARNING!

XG Cargo Rail Station organizer is not intended for non automotive applications. Do not store more than 2lbs evenly distributed across all bags.

Damage may occur if bags are overloaded. Do not store sharp objects, hazardous materials or liquids in bags.

Do not use excessive force on track or clips. These are plastic and could be damaged with excessive force.

STEP 01:

Remove and inspect all components.
Remove bags from mounting panel.

TO DO THIS:

1 Pull bottom of bag away from Velcro:

2 Push bag upward off plastic track. Reverse to install bags.

This may take a time to master.

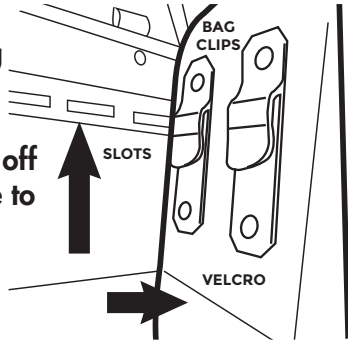

STEP 02:

Collapse each seat as shown.

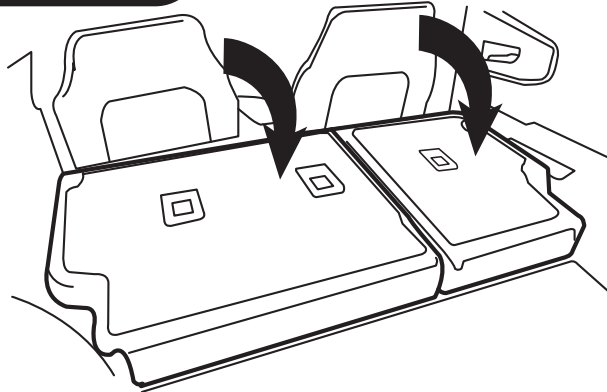

STEP 03:

Starting from driver's side, attach head rest clips to headrest posts as shown.

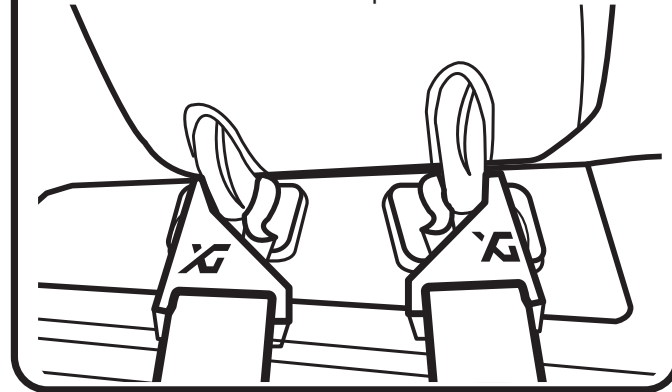

STEP 04:

Fold mounting panel (without bags) in half to expose quick release C Clip and strap on back. Pull the strap and engage C clip onto bar of child restraint 'A' at 3 locations. Tilt seats into upright position when completed

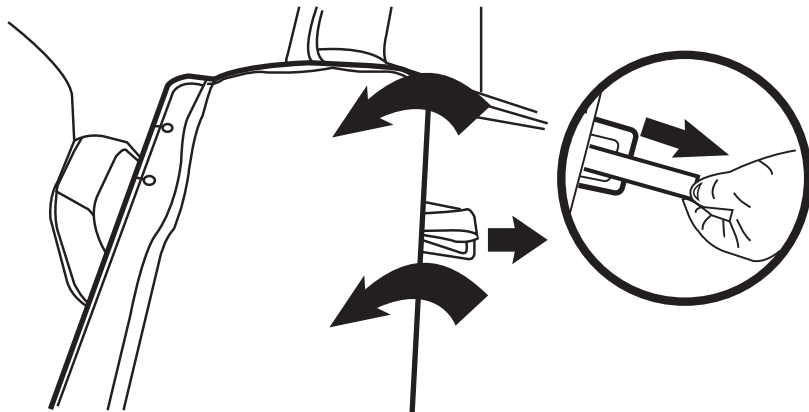

STEP 05:

Feed lower elastic straps with C clips around side of each seat and attach to front bars under each seat as shown.

Warning! Do not attach straps to any electrical or mechanical device that would affect the movement of the seat or safety thereof.

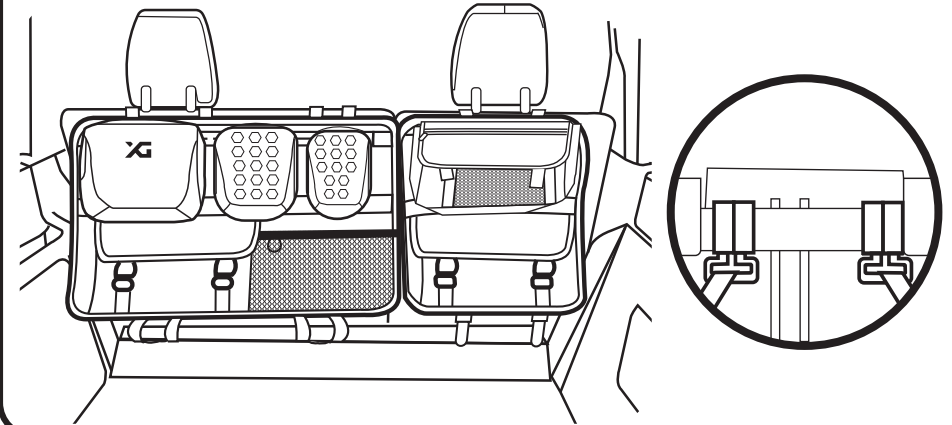

WARNING! Do Not Use Child Seats With this Product.