



www.xgcargo.com

Gama XG-304 USER MANUAL

Jeep Wrangler JKU

PARTS LIST:

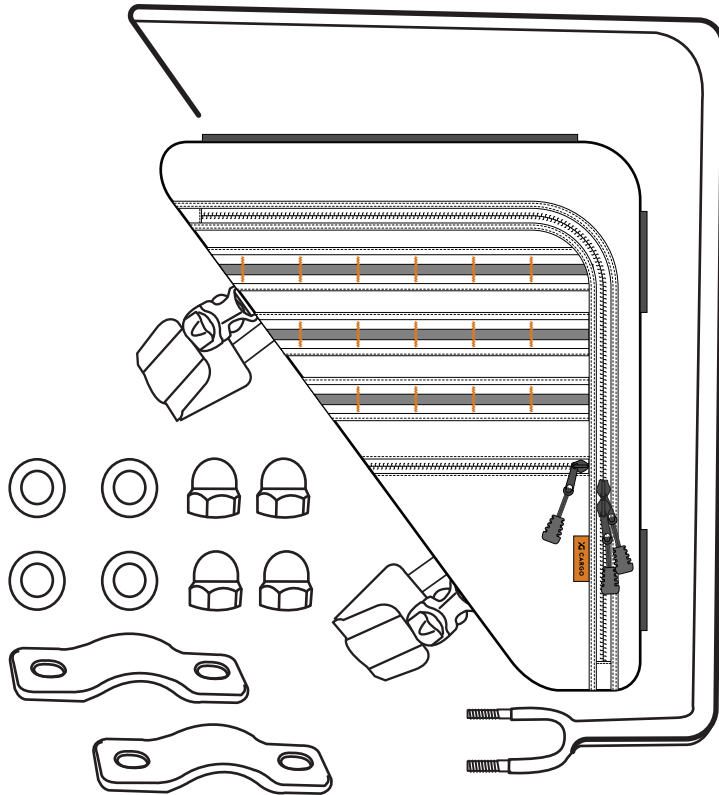

- 1 Gama Bag
- 1 Frame
- 4 Washers and screws
- 2 Clamps

SCAN FOR INSTRUCTIONAL VIDEO:

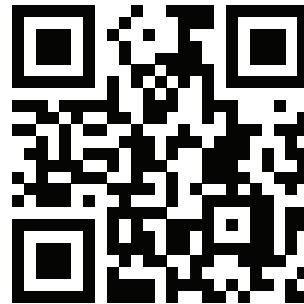

Scan the QR code with your smartphone and it will take you to the link below:

<https://qrgo.page.link/yYQYH>

TOOLS NEEDED:



14mm Wrench

INSTALLATION TIME & SKILL LEVEL:



5-10 minutes, Skill Level 01

WARNING!

Gama bags are not intended to store gear or objects that weigh more than 10 lbs. total per bag. Damage to bags and/or sport bar may occur if bags are overloaded. Be sure all straps are fastened properly and securely before operating vehicle. Please use caution when loading gear into bags.

Do not load sharp objects unless properly protected. Gama bags are water resistant and not water proof. XG warrants all products for workmanship only and cannot assume responsibility for product abuse by the end-user.

STEP 01:

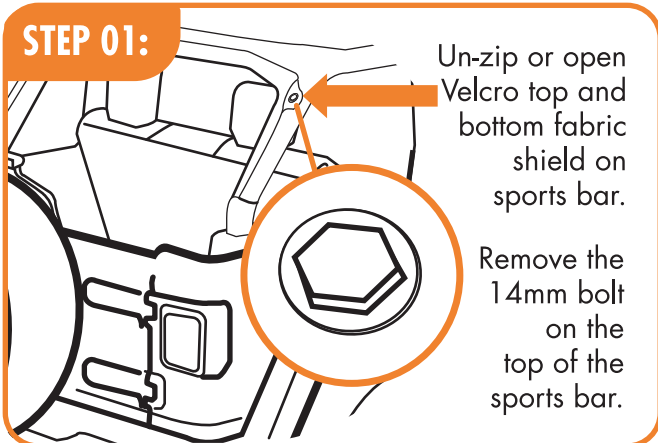

Un-zip or open
Velcro top and
bottom fabric
shield on
sports bar.

Remove the
14mm bolt
on the
top of the
sports bar.

STEP 02:

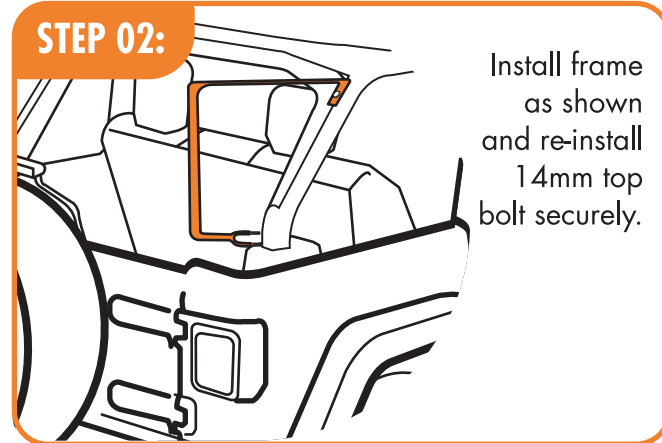

Install frame
as shown
and re-install
14mm top
bolt securely.

STEP 03:

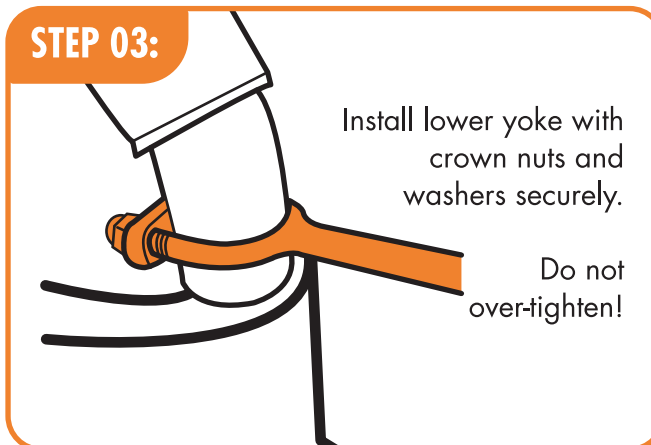

Install lower yoke with
crown nuts and
washers securely.

Do not
over-tighten!

STEP 04:

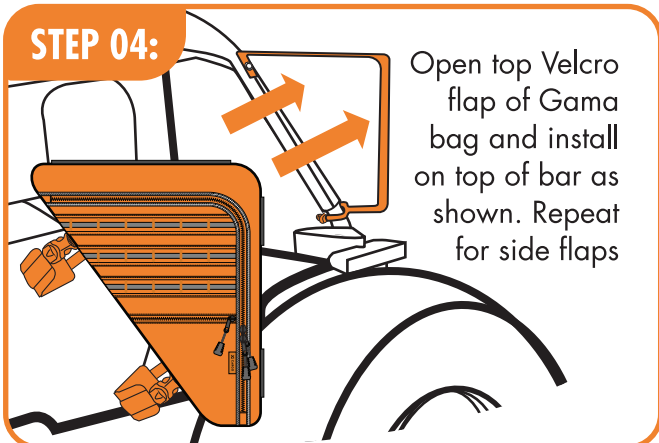

Open top Velcro
flap of Gama
bag and install
on top of bar as
shown. Repeat
for side flaps

STEP 05:

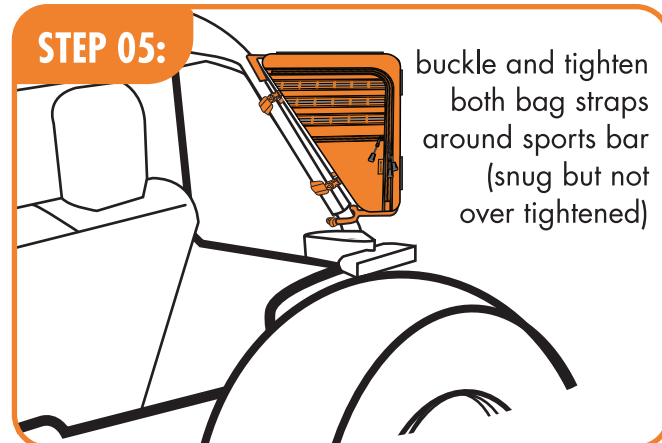

buckle and tighten
both bag straps
around sports bar
(snug but not
over tightened)