



EEZEE POWER



Opticube Driving Light Instructions

If you prefer to use a connector of your choice, you may cut the DT connector off. This does not affect the warranty. Please make sure you remember the cable positions before making the cut so that you know which cable has which function.

PARTS INCLUDED

- A. 1x Opticube led light
- B. 1x Universal led light mounting bracket
- C. 1x M8 stainless steel bolt
1x M8 spring washer
1x M8 washer
1x M8 nut
2x M6 Allen bolts
2x M6 spring washer

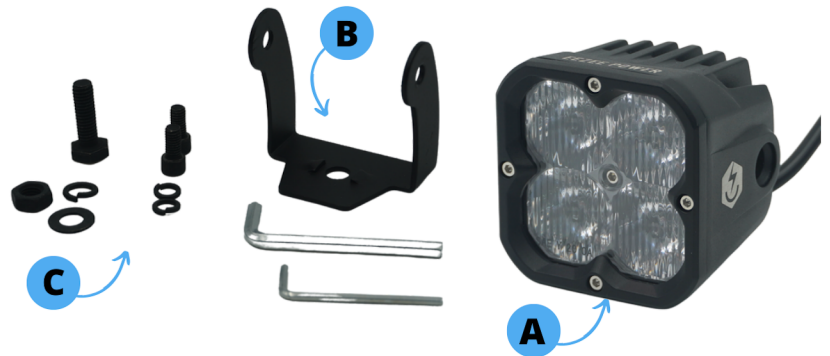

TOOLS REQUIRED

- Allen keys (included)
- Wrench 14 mm

PARTS REQUIRED

- 2 PIN DT Deutsch connector (male)

DT Connector

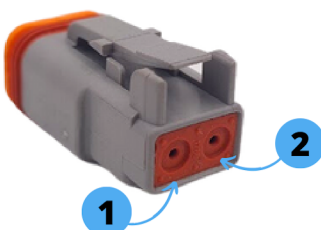

DT Connector wiring position

DT Cable Position	Cable Function	Cable Colour
1	Driving beam (9-36V DC +)	Red
2	Grounding (Negative -)	Black



EEZEE POWER

Disclaimer

All information in this guide has been prepared with great care. Although we make every effort to ensure that they are correct, errors may occur. Eezee Power cannot be held liable for errors, changes, outdated information and/or omissions.

This user guide aims to assist you in doing your own installations and is for information purposes only. Eezee Power will not be responsible for any damage caused by the failure to install the product according to these instructions.

If you do not understand the instructions and/or you do not feel confident enough to tackle the installation, you should have the product installed by a professional.

General guidelines

- Never connect this product to a source lower than 9 or higher than 36 Volts.
- Always use a relayed wiring harness. Never connect directly to the battery.
- Use lubrication on all stainless steel hardware to prevent locking.
- Do not open or modify the product without explicit Eezee Power consent.
- Check local regulations in order to legally install and use the product.
- The cooling element on the back heats up when the product is in operation, this is normal.
- Do not use a jet washer on the lamp. Do not use an automatic car wash with lamps installed on the car.

Product care information

- Wash the lamp regularly, just as you would care for your vehicle.
- Hand-wash with a mild soapy water or household glass cleaner to remove dirt, grime and insects.
- Never use dish soap, wax, abrasive cleaners, polishers or products made for normal paints.
- Use a soft wash mitt, cotton cloth or microfiber cleaning cloth. Never use terry cloth or paper towels.
- To enjoy the matte appearance for many years, you can buy a no-shine matte car wash soap.

Warranty

Our warranty only applies to manufacturing or design defects and does not cover misuse, modification, improper installation, accident damage, normal wear or finish failure caused by usage of wrong cleaning agents.

Please check the terms and conditions on our website for further details about the warranty procedures.