

STEP: 1 Assemble Rear Diffuser

Carefully place Fin 1 onto the Driver Side Main Panel and Fin 2 onto the Passenger Side Main Panel

(Match the number on the Fin to the number on the Main Panel)

Secure with Small Bolt and Small Nut

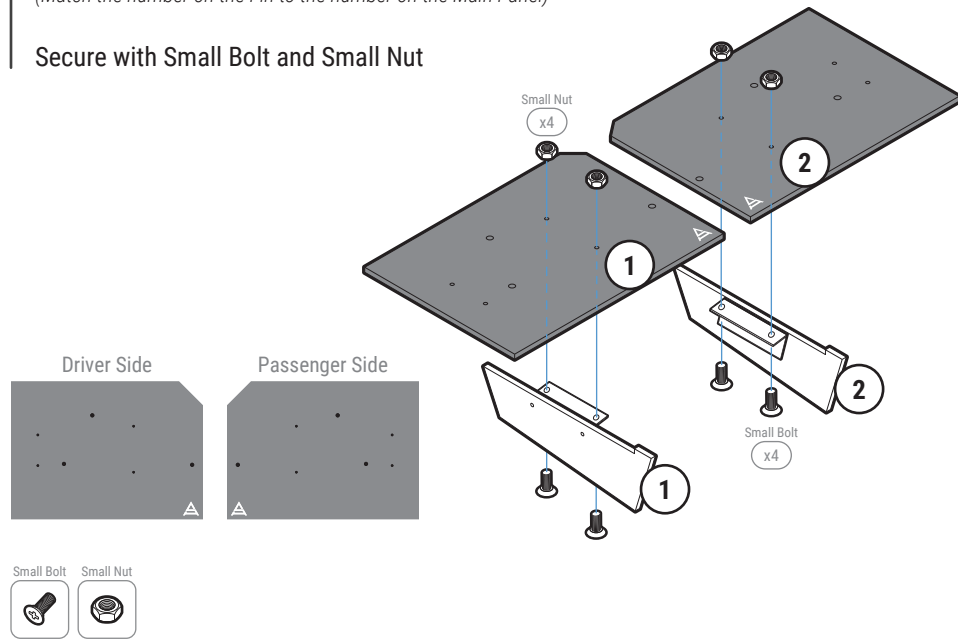

STEP: 2 Remove OEM Push Pins

Remove the two Push Pins located on the left and right side of the exhaust

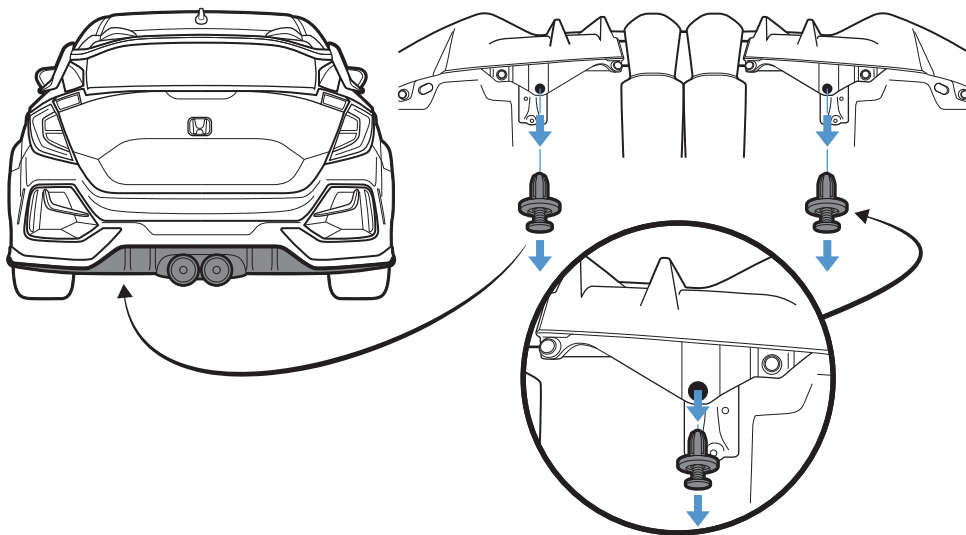

STEP: 3 Install Mounting Bracket

Use the OEM mounting holes from "STEP: 2" to align and mount the assembled Main Panels to the bumper by securing both Mounting Brackets HA-4 with provided M6 40mm Bolt, Finishing Washer, Washer and Nut

NOTE: Reach under or to the side of the bumper to place the Washer and Nut inside the bumper

Align the Main Panels as straight as possible

Position and mark where Mounting Bracket HA-3 and HA-5 will be mounted to the bumper

NOTE: Use the hole on top of HA-3 and HA-5 to mark the drill location

Pre-drill into the bumper

NOTE: Mounting Bracket may need to be removed before pre-drilling

Attach and secure Mounting Bracket HA-3 and HA-5 with provided M6 40mm Bolt, Finishing Washer, Washer and Nut

NOTE: Reach under or to the side of the bumper to place the Washer and Nut inside the bumper

Repeat to install both Main Panels

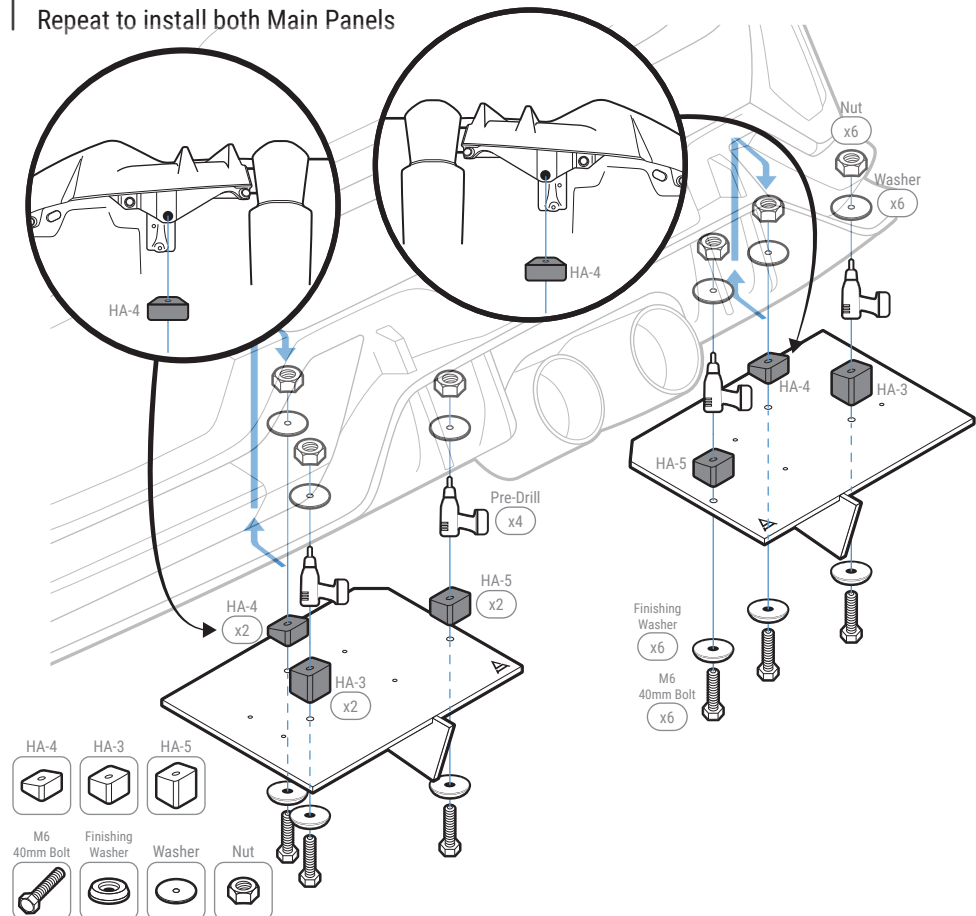

IMPORTANT: DO NOT over tighten or use power tools to mount the Mounting Brackets

STEP: 4 Mount the Rear Diffuser

Remove the Push Pins located on the left and right side of the bumper shown below

Attach Mounting Bracket HA-8 to the OEM Mounting Hole and secure with M6 25mm Bolt, Washer, and Nut

NOTE: Use the sides near the wheels to secure the Washer and Nut inside the bumper

Attach the Side Panel to the Main Panel with Small Bolt and Small Nut

NOTE: Do Not tighten Small Bolt on the Side Panel to the Main Panel
(you may need to remove the Side Panel to pre-drill)

Mark where the mounting hole is to the bumper

NOTE: Place Mounting Bracket HA-6 and HA-7 to its correct spot then use the hole on top to mark the drill location

Pre-drill into the bumper

NOTE: Side Panel may need to be removed before pre-drilling

Attach Mounting Bracket HA-6 and HA-7 to the Bumper and secure with M6 25mm Bolt, Washer, and Nut

NOTE: Use the sides near the wheels to secure the Washer and Nut inside the bumper

Install the Side Panels to the Main Panel and Bumper by securing Mounting Brackets HA-6, HA-7, and HA-8 to the Side Panel with provided M6 16mm Bolt, Finishing Washer, and Nut

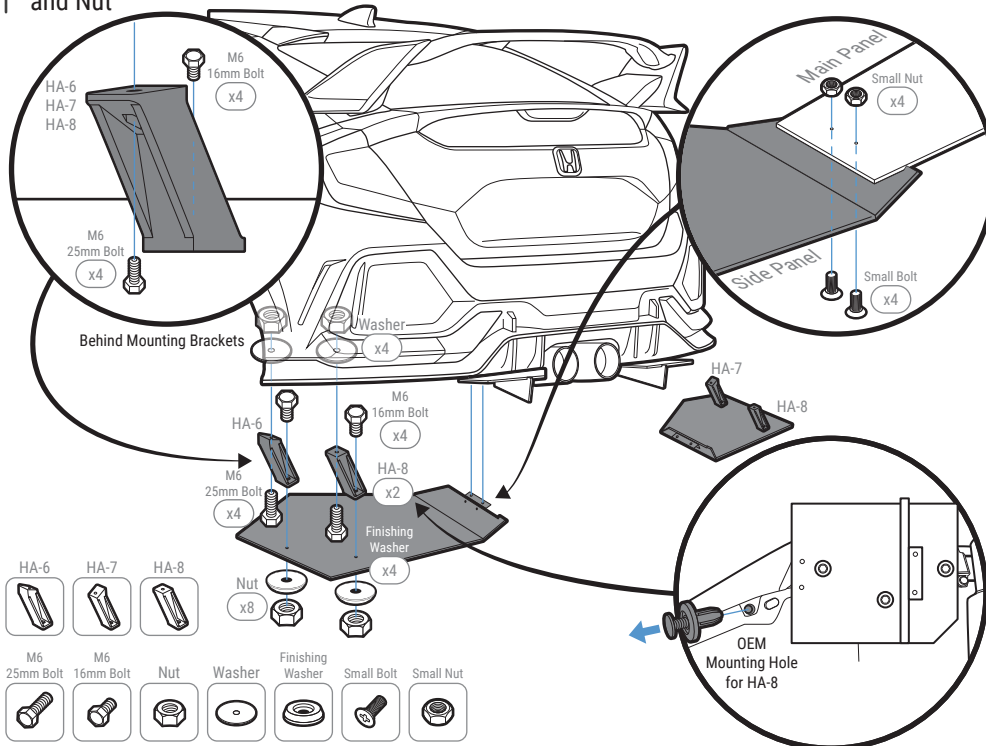

INSTALLATION GUIDE

2017-2021 Honda Civic Type-R

ACM Rear Diffuser

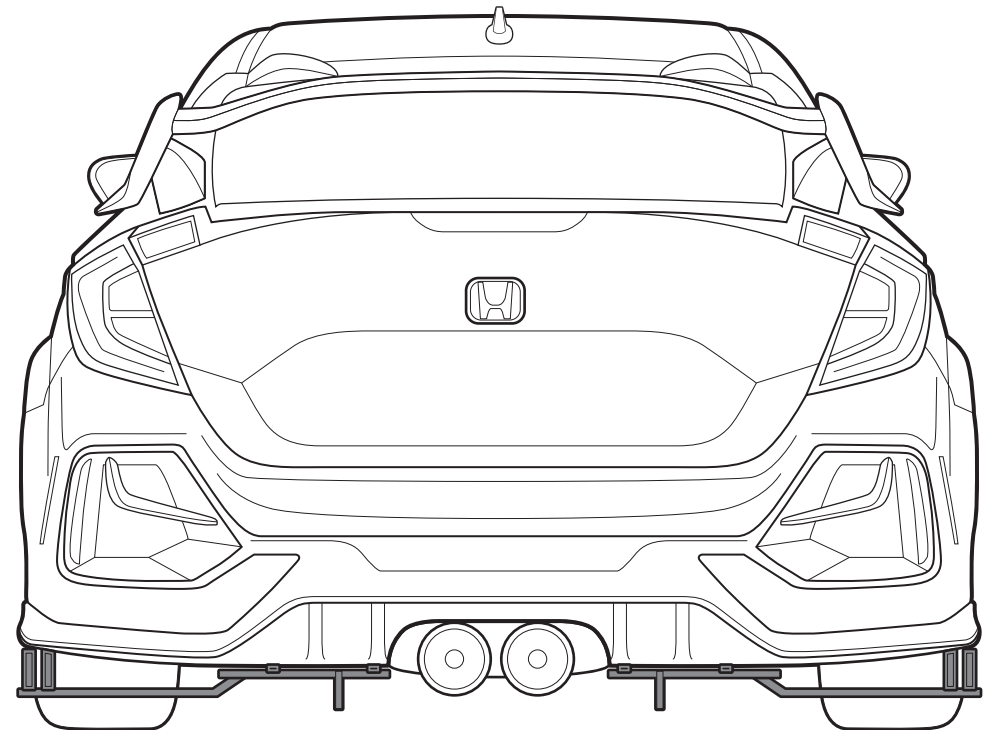

s-rda-hon-03-e1

www.streetaero.com

info@streetaero.com

