

## STEP: 1 Assemble Rear Diffuser

Assemble and secure Fin 1 and Fin 2 to the Main Panel with Black Bolt and Black Nut  
(Match the number on the Fin to the number on the Main Panel)

Secure Mounting Bracket FD-1 to the Main Panel with M6 16mm Bolt, Finishing Washer, and Nut

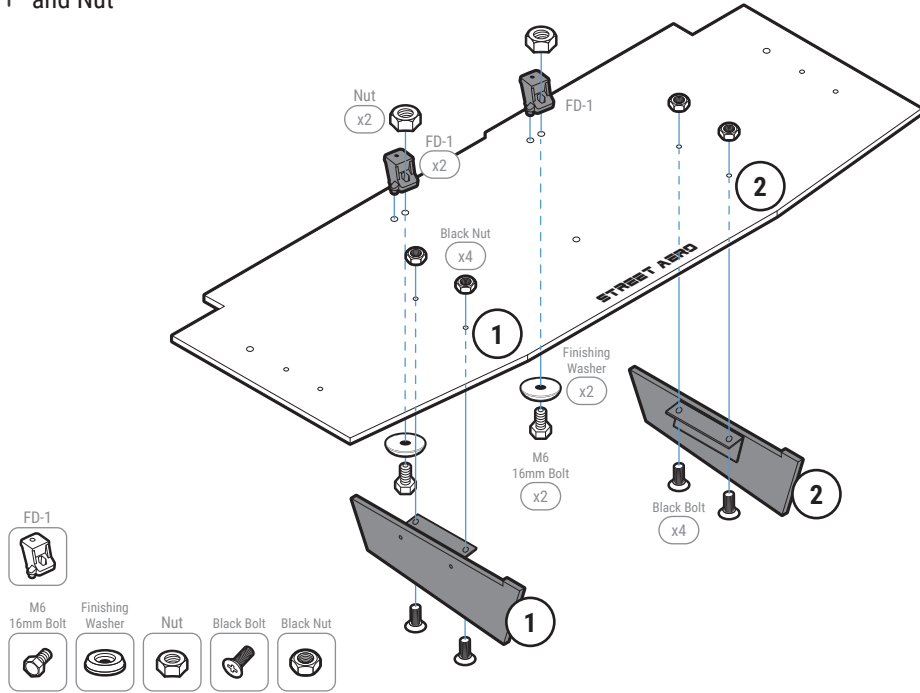

## STEP: 2 Remove Oem Bolts

Remove the two OEM Bolts located under the bumper

**NOTE:** (Mark where the OEM Bolts are located this is where the Main Panel will be mounted)

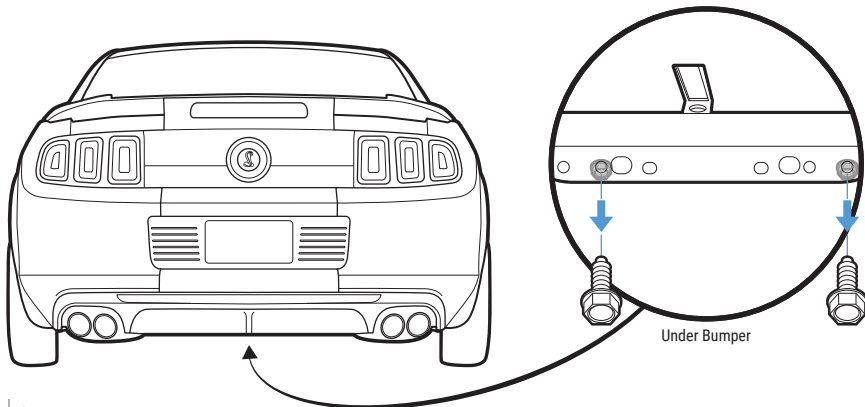

## STEP: 3 Install Main Panel

Use the OEM mounting holes from "STEP: 2" to mount the assembled Main Panel to the bumper by securing both Mounting Bracket FD-1 with M6 25mm Bolt

**NOTE:** Place M6 25mm Bolt behind Mounting Bracket FD-1

After aligning the Main Panel to the bumper mark and pre-drill with a 13/32" Bit where the Well Nut will be installed on the bumper

**NOTE:** Use the hole in the middle of the Main Panel to mark the drill location

**NOTE:** Main Panel may need to be removed before pre-drilling

Push the Well Nut firmly into the bumper at the designated mounting location

Mount the Main Panel to the bumper by securing Mounting Bracket FD-58 to the Well Nut with M6 25mm Bolt and Finishing Washer

Use the hole on the Main Panel to pre-drill the remaining mounting location with a 1/4" Bit on the left and right side of the bumper

Secure the left and right side of the Main Panel with M6 25mm Bolt, Finishing Washer, Washer, and Nut

**NOTE:** Reach behind the mounting location to secure the Washer and Nut inside the bumper

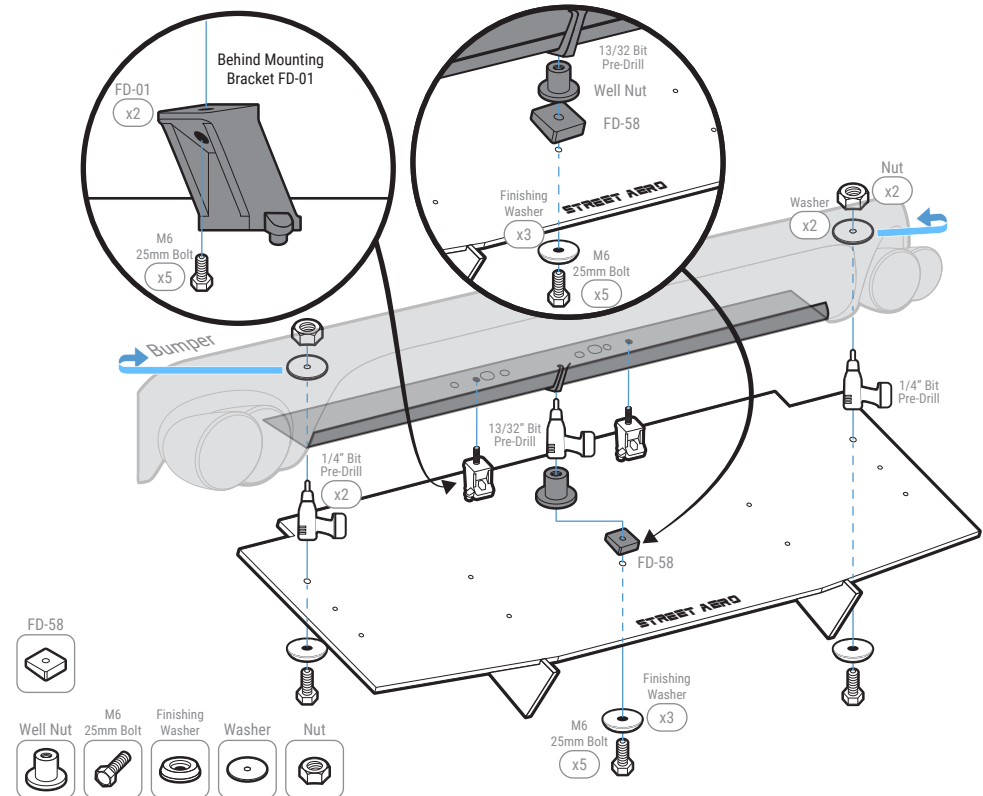

**STEP: 4** *Mount the Rear Diffuser*

Attach and secure Mounting Bracket FD-59 and FD-60 to the Side Panel with M6 16mm Bolt, Finishing Washer, and Nut

**NOTE:** Push the bolt all the way into the socket to prevent it from falling out

Attach the Side Panel to the Main Panel with Black Bolt and Black Nut

**NOTE:** Do Not tighten bolts on the Side Panel to the Main Panel  
*(you will need to remove the Side Panel to pre-drill)*

Mark and pre-drill where Mounting Bracket FD-59 and FD-60 would be mounted to the bumper with **1/4" Bit**

**NOTE:** Use the hole on top of Mounting Bracket FD-59 to mark the drill location  
*(Side Panel may need to be removed before pre-drilling)*

Install the Side Panel to the Main Panel and Bumper by securing Mounting Bracket FD-59 and FD-60 with provided M6 25mm Bolt, Washer, and Nut

**NOTE:** Use the sides near the wheels to secure the Washer and Nut inside the bumper

**NOTE:** Place the M6 25mm Bolt into the socket behind the Mounting Bracket

Repeat to install Passenger Side Panel to the Main Panel and Bumper

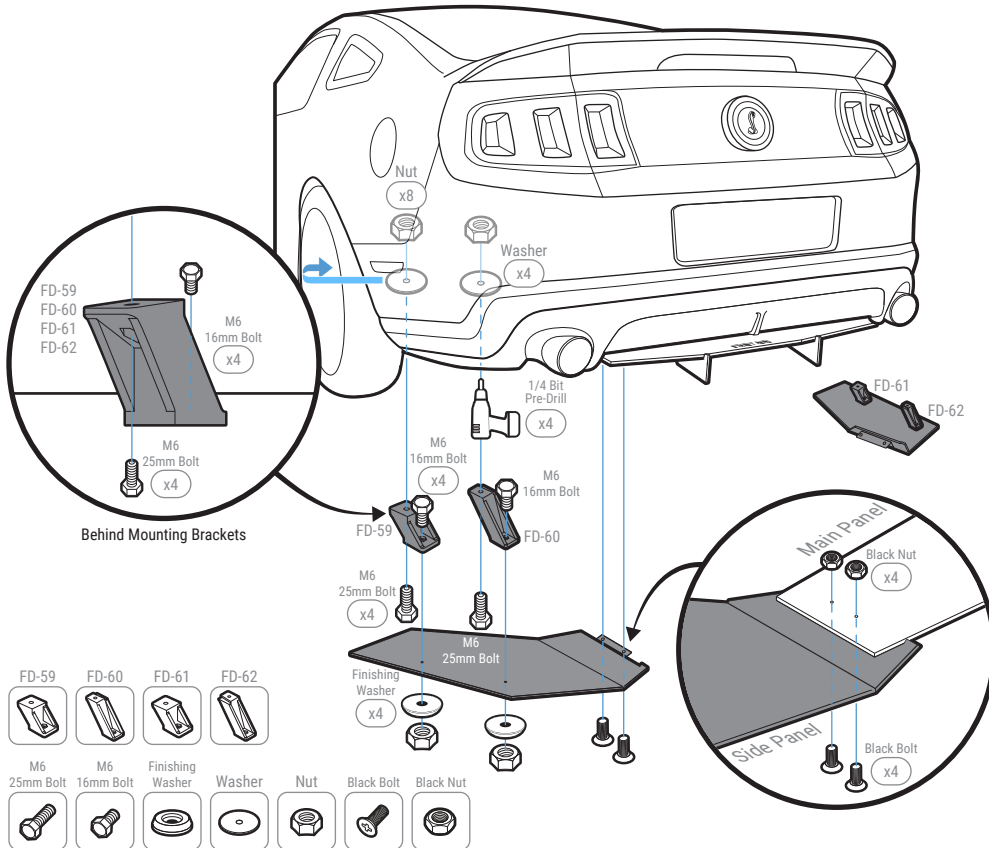

# INSTRUCTIONS

## 2013-2014 Ford Mustang Shelby GT500

### ACM Rear Diffuser

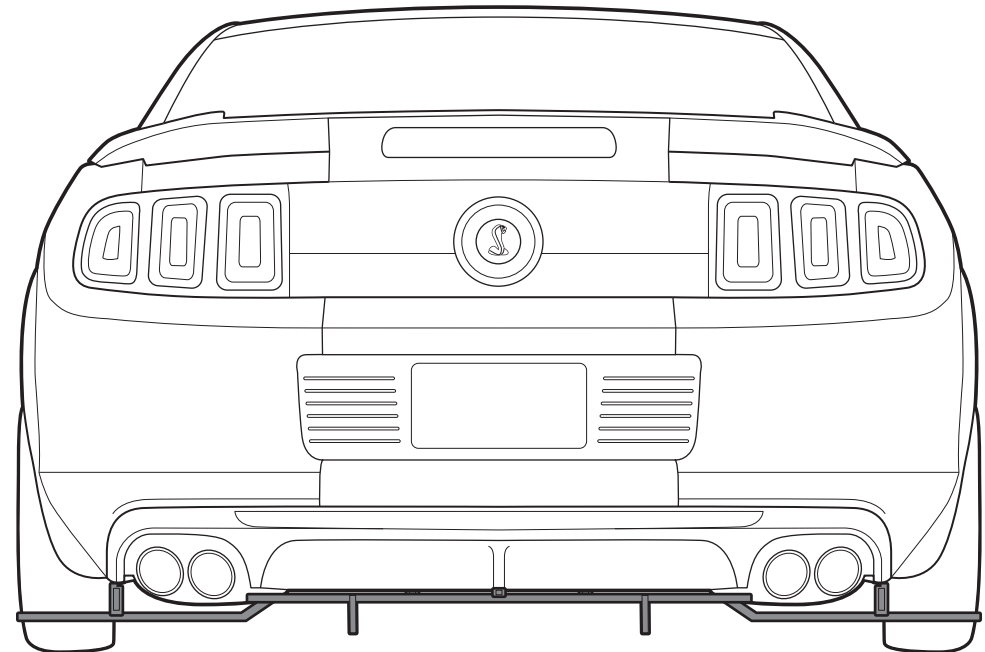

s-rda-frd-18-e1

www.streetaero.com

info@streetaero.com