

### STEP: 1 Assemble Rear Diffuser

Carefully place Fin 1 and Fin 2 onto the Main Panel  
*(Match the number on the Fin to the number on the Main Piece)*

Secure with Small Nut and Small Bolt

Attach and secure Mounting Bracket FD-9 to the Main Panel with provided M6 25mm Bolt, Finishing Washer, Washer, and Nut

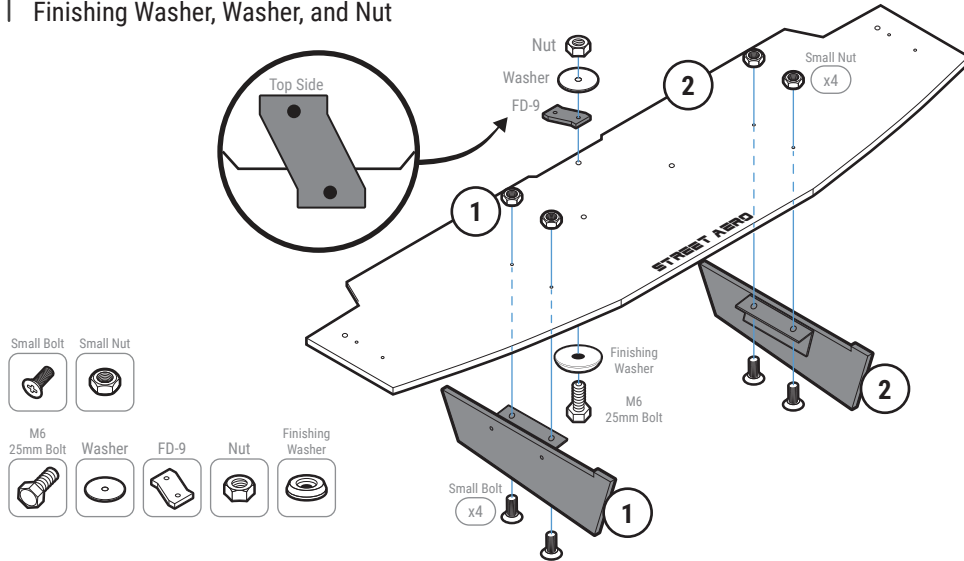

### STEP: 2 Remove OEM Bolts

Remove the two OEM Bolts located under the Bumper  
**NOTE:** (Mark where the OEM Bolts are located this is where the Main Panel will be mounted)

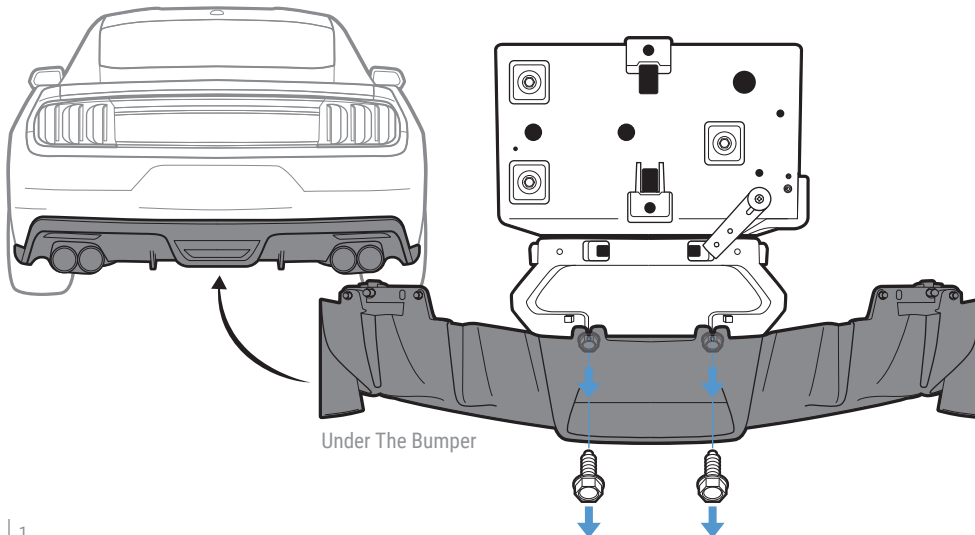

### STEP: 3 Install Mounting Bracket

Place Nut into Nut Assist FD-8

**NOTE:** Push the nut all the way into the socket to prevent it from falling out

Slide Nut Assist FD-8 into designated mounting socket  
*(shown in the diagram below)*

Mount the Main Panel by securing Mounting Bracket FD-9 to the designated mounting socket and OEM mounting holes with M6 25mm Bolt, Finishing Washer, and Nut

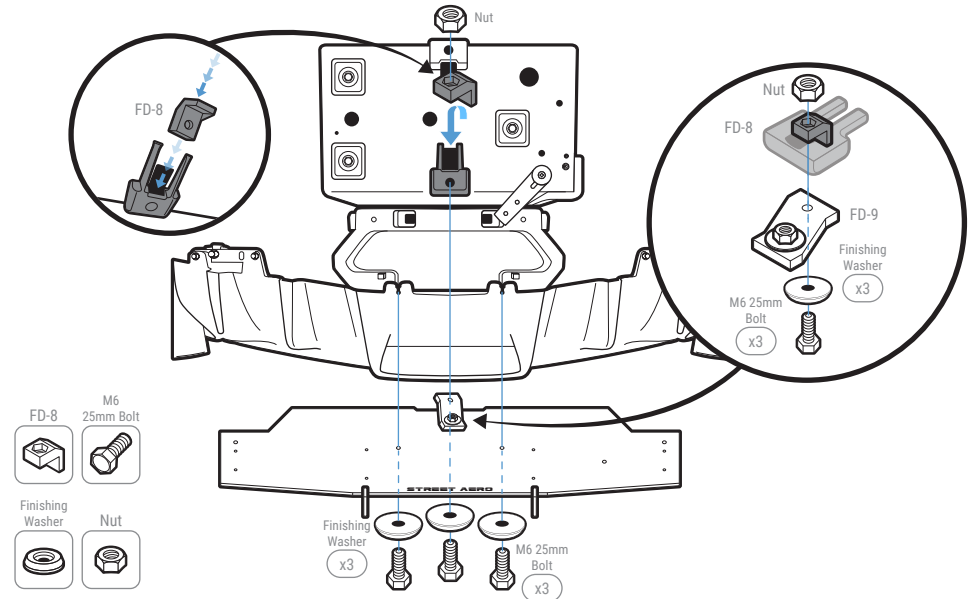

### STEP: 4 Mount Main Panel

Align the Main Panel to the bumper and Pre-Drill where the mounting holes are located

Secure the Main Panel to the bumper with provided M6 25mm Bolt, Finishing Washer, Mounting Bracket FD-53, Washer, and Nut

**NOTE:** Use the sides near the wheels or reach under the Diffuser if possible to place the Washer and Nut inside the bumper

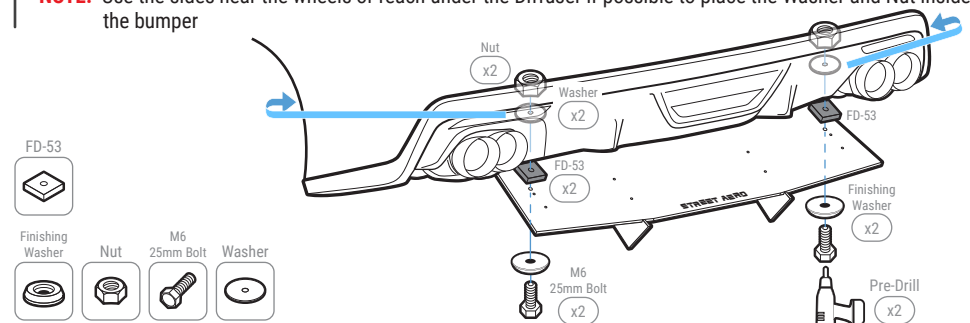

**!** IMPORTANT: DO NOT over tighten or use power tools to mount the Mounting Brackets

**STEP: 5** *Mount the Rear Diffuser*

Attach and secure Mounting Bracket FD-10 and FD-11 to the Side Panel with M6 16mm Bolt and Nut

**NOTE:** Push the Bolt all the way into the socket to prevent it from falling out

Attach the Side Panel to the Main Panel with Small Bolt and Small Nut

**NOTE:** Do Not tighten Small Bolt and Small Nut on the Side Panel to the Main Panel  
*(you will need to remove the Side Panel to pre-drill)*

Mark where the mounting hole is to the bumper

**NOTE:** Use the hole on top of FD-10 and FD-11 to mark the drill location

Pre-drill into the bumper

**NOTE:** Side Panel may need to be removed before pre-drilling

Install the Side Panel to the Main Panel and Bumper with provided M6 25mm Bolt, Washer, and Nut

**NOTE:** Use the sides near the wheels to secure the Washer and Nut inside the bumper

**NOTE:** Fully tighten the Small Bolt and Small Nut on the Side Panel to the Main Panel

Repeat to install Passenger Side Panel to the Main Panel and bumper

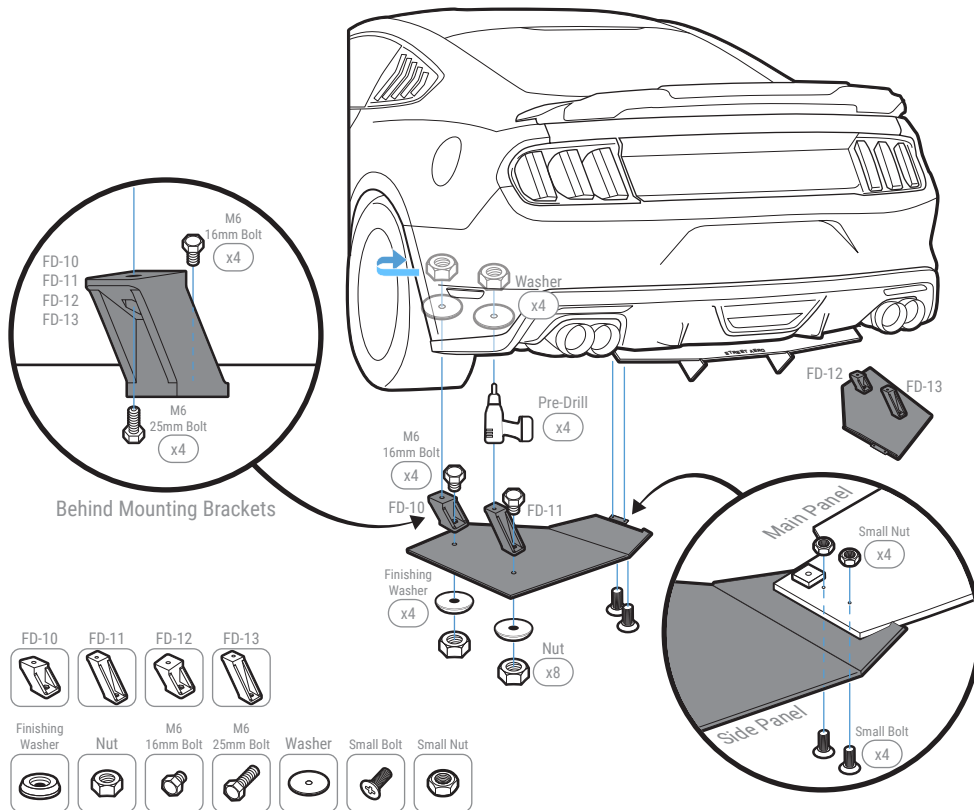

**INSTALLATION GUIDE**  
**2015-2017 Ford Mustang**  
**GT Premium**  
**ACM Rear Diffuser**

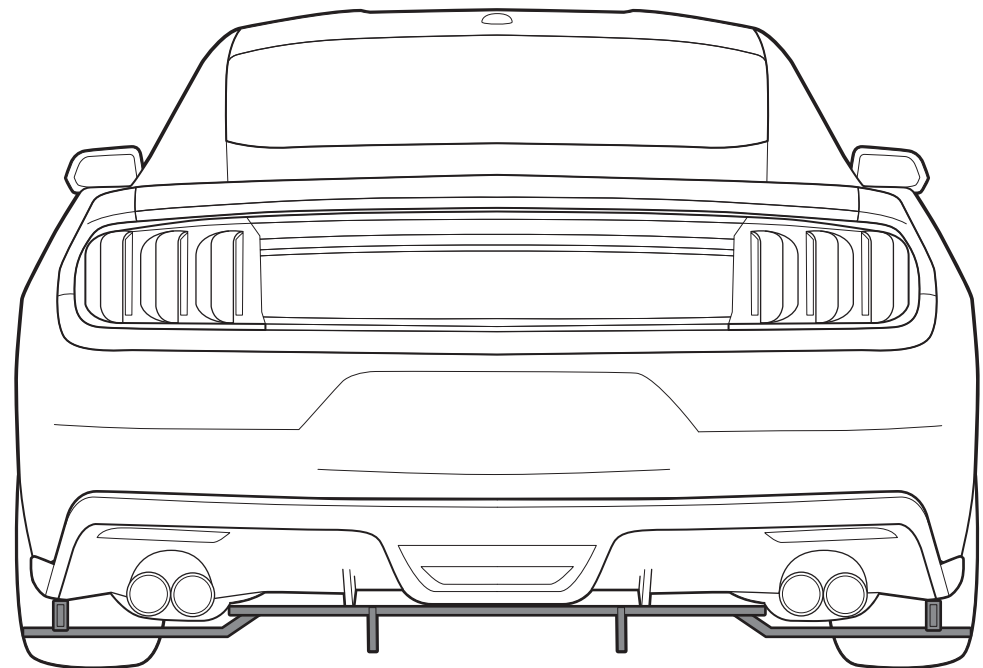

s-rda-frd-16-e1

www.streetaero.com

