

INSTALLATION GUIDE

NXG-100



nexxgarage

Ver. 1.0

UNPACK



INSTALL



CONFIGURE



CONNECT





INSTALLATION WARNING

WARNING

TO PREVENT SERIOUS INJURY FROM YOUR MOVING GARAGE DOORS OR GATES:

- DO NOT let children use [Nexx Garage](#) product and app without adult supervision.
- ONLY operate your [Nexx Garage](#) device when you are in clear view of your garage or gate, and you have verified that there are no objects are obstructing the operation of the door.
- ALWAYS wait for garage door or gate to be completely closed.
- NEVER operate the remote access feature of your [Nexx Garage](#) without ensuring that it is safe to do so.

Carefully read the instructions BEFORE beginning. Please make sure your garage door is closed before you start the installation. [Nexx Garage](#) and any door sensors are meant to be used with garage door openers that are equipped with photoelectric safety sensors (manufactured after 1993). These sensors are generally found at the bottom of your garage door and will help to avoid accidental closing of your garage door if an object or person is in the path of the door.



REQUIRED EQUIPMENT

BEFORE YOU START, YOU MUST HAVE...

Mobile Device



Garage Door Opener



Stepladder



Flathead Screwdriver

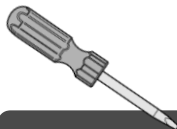



COMPATIBILITY VERIFICATION

If you haven't already verified and checked that your garage door opener is compatible with Nexx Garage, then please check our opener compatibility list on our website:

Compatible list: <http://nexxhome.com/support/openers>



If your opener is on neither list, then please perform this compatibility test as shown in this video:

<http://nexxhome.com/support/openertest>

If the compatibility test fails as demonstrated in the video, then we can provide a **FREE Nexx Garage Adapter** that will allow your garage door opener to work with Nexx Garage controller.

Please email support@nexxgarage.com indicating your garage door opener model and request a **FREE Nexx Garage Adapter** for your incompatible opener.



WHAT'S IN THE BOX



NXG-100



Door Sensor & Cable



Sensor Mounting
Brackets



Bolts/Nuts/Screws



Zip Ties



Compatibility Test Wire



WI-FI CONFIGURATION

Setup the device before installing it in your garage/gate opener:

- 1 Power the device by plugging it into the power outlet.
- 2 Get near to the router.
- 3 Install “Nexx Home” app from Apple Appstore or Google Playstore



nexxhome



WI-FI CONFIGURATION

- 4 Open Nexx Home app and create an account.
- 5 After creating your account, log in and tap "+"
- 6 Follow the configuration process to register your device.

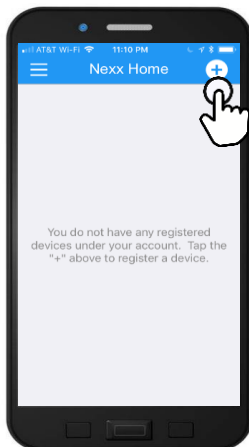



CONNECT TO OPENER

1 Locate the two exposed wires coming out of the Nexx Garage device.

2 Locate the 2 terminals on the back of your garage opener that your wall button wires connect to. Take out the existing wall button wires from the opener, twist together: one wire from Nexx Garage connecting cable and one wire from the wall button and terminate it back to the opener. Repeat for the other wire. It does not matter which wire goes to which terminal.

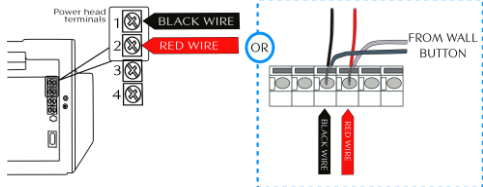



WIRED SENSOR INSTALLATION

- 1 The wired sensor has 2 parts. Both sensor parts must be mounted parallel to each other, and they must be 1/8 to 1/4 inch apart, not touching.

Proper Alignment

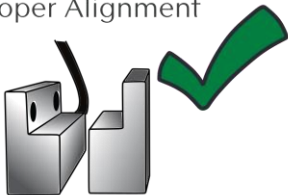

Incorrect Alignment

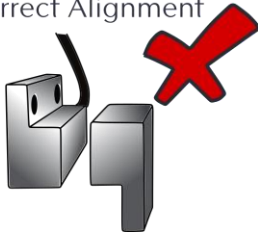

- 2 Mount the sensor part with a cable to the garage door frame adjacent to the garage door, just above the garage door. Mount the other sensor part on the center top of the garage door.



WIRED SENSOR INSTALLATION

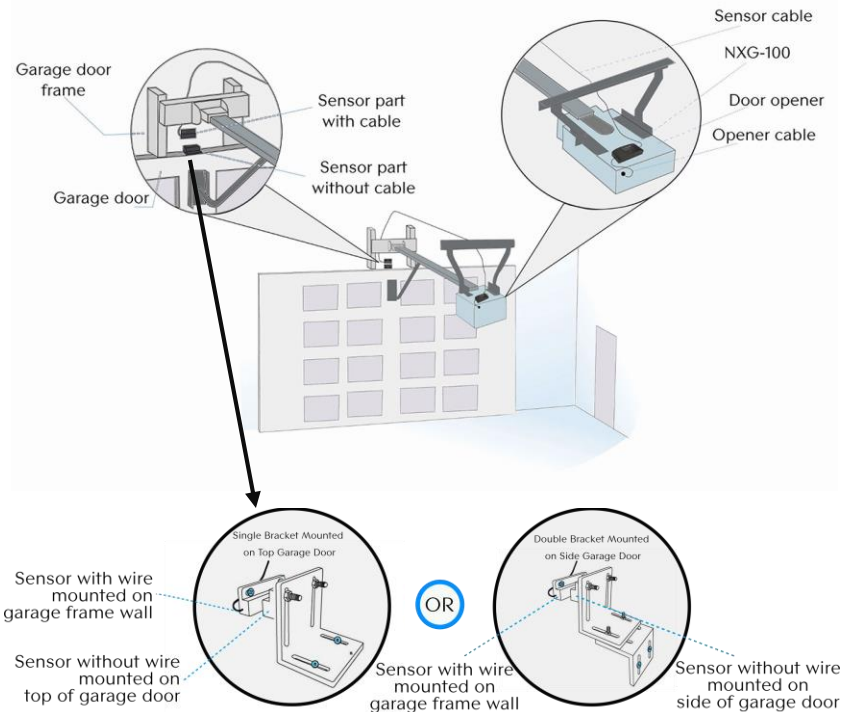



INSTALLATION COMPLETED!

Congratulations! You have successfully completed your Nexx Garage installation. You can now use the Nexx Home mobile app to activate your garage door. If you have any issues or questions, please email us at support@nexxhome.com.

Also visit <http://nexxhome.com/support> for FAQ, troubleshooting, and detailed installation instructions with examples and videos.

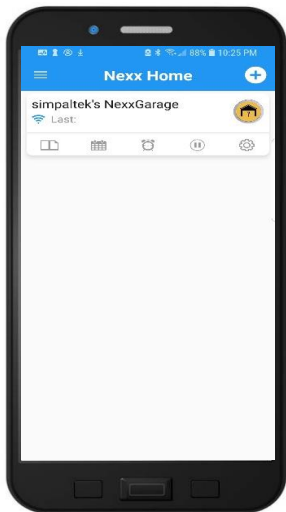

NEED HELP?

Need Help?

Go to: www.nexxhome.com/support

CUSTOMER SERVICE

Simpaltek LLC is the developer of smart home products such as our best-selling Nexx Garage Smart Wi-Fi Garage Controller. We take great pride in providing exceptional customer support for all of our products, whether they have been sold directly by us or through our authorized distributors or re-sellers. Technology products often require more product support after the purchase than any other type of products, and for this reason, we have made our customer product support a top priority in our company. We are here for you before, during, and after your purchase, so please be assured that should you ever need assistance, our customer support team will be there for you at support@nexxhome.com.

PRODUCT LIMITED WARRANTY

Simpaltek, LLC warrants to the first retail purchaser of this product that it is free from defects in materials and/or workmanship for a period of one (1) year following the original purchase date of the product, provided the product is used 1) in a home environment protected from the elements and 2) in compliance with the instructions regarding installation, operation, maintenance, and testing. This limited warranty does not cover 1) normal wear and tear 2) failures due to a) improper installation, operation, care, and maintenance b) misuse/unintended use c) abuse, negligence d) accidental damage e) unauthorized repairs or alteration f) use of improper voltage g) electrical outage short circuit 3) consumable parts such as batteries 4) acts of nature.

For products returned for warranty which are confirmed to be defective and are covered by this limited warranty, we will replace or repair the product at no extra cost to you. Products may be repaired or replaced by refurbished parts or units or by different models of similar functionality at our sole discretion. We will not cover any product installation costs, or any labor costs associated with other manufacturers' products or any repair or replacement or damage costs related to other products and services.

Any warranty claim must be accompanied by the first retail proof of purchase receipt showing the original first date of purchase, which is used to determine the warranty period.

We do not warrant that the operation of the product will be error-free or uninterrupted. Except to the extent set forth in this limited warranty, the product is provided on an "as is" basis, and all implied warranties, including but not limited to any implied warranties of merchantability and fitness for a particular purpose, are limited in duration to the applicable limited warranty period set forth, and no implied warranties will exist or apply after such period. No person or entity is authorized to assume for us any other liability in connection with the sale of this product.