



Google Home Setup

v15

Model NXG - 100

NEXX HOME GOOGLE HOME SETUP

Nexx Home integrated with Google Assistant Action allows you to control the opening and closing of your **Nexx Garage** as well as controlling your **Nexx Plug** by voice command.

Following steps describes Google Home setup.



- 1) Open the Google Home app on your phone.
- 2) Press mic button and you'll see a little compass icon appear, click on it to go to explore.

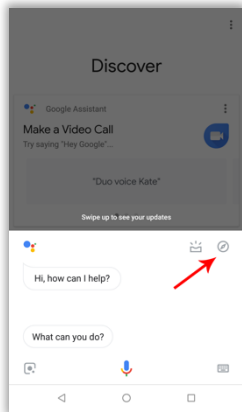

- 3) You'll land on explore section, where you can search actions.

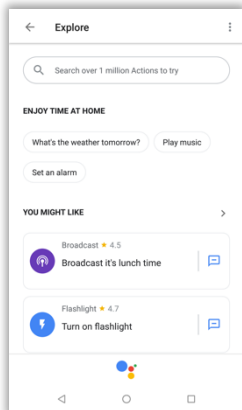

- 4) Search "Nexx Home" action using the search field and click on it.

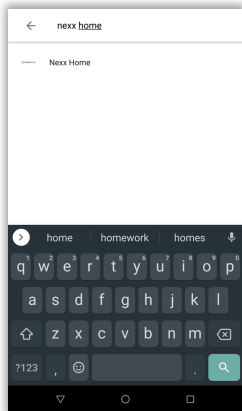

- 5) Press “LINK” button to start linking your Nexx Home account with Google Assistant.

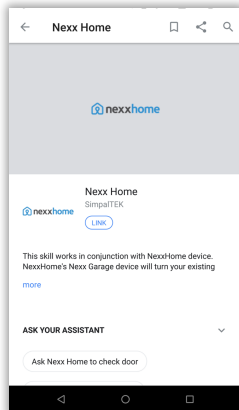

- 6) Provide your Nexx Home account credentials to link your account.

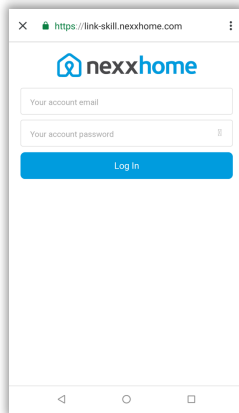

- 7) Once you've provided correct credentials, your account will be linked and you'll get success message. You'll see the "TRY IT" button.

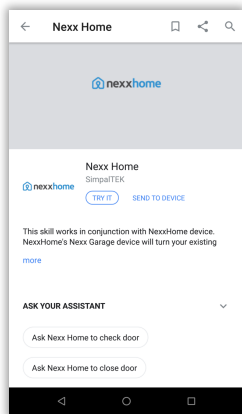

NEXX HOME SKILL SETUP COMPLETED

Nexx Garage Commands

- Hey Google, tell Nexx Home to check garage door
- Hey Google, tell Nexx Home to check door
- Hey Google, tell Nexx Home to check garage
- Hey Google, tell Nexx Home to open garage door
- Hey Google, tell Nexx Home to open door
- Hey Google, tell Nexx Home to open garage
- Hey Google, tell Nexx Home to close garage door
- Hey Google, tell Nexx Home to close door
- Hey Google, tell Nexx Home to close garage
- Hey Google, tell Nexx Home to open **Front Yard**
- Hey Google, tell Nexx Home to close **Front Yard**
- Hey Google, tell Nexx Home to check garage **Front Yard**

“Front Yard” is your assigned name to garage door in Nexx Home app. You can replace the name in above command with the name of your garage door.

Nexx Plug Commands

- Hey Google, tell Nexx Home to turn on
- Hey Google, tell Nexx Home to turn off
- Hey Google, tell Nexx Home to turn on the plug
- Hey Google, tell Nexx Home to turn off the plug
- Hey Google, tell Nexx Home to check plug
- Hey Google, tell Nexx Home to turn on **My Lamp**
- Hey Google, tell Nexx Home to check plug **My Lamp**

“My Lamp” is your assigned name to plug in Nexx Home app. You can replace the name in above command with the name of your plug.

Note: You can disable/enable pin code from Nexx Home app under your specific device “Settings”.