



INSTRUCTION MANUAL

LED Linear Light

L 8050 in single run- 4ft/8ft

Technical Parameter

Color: cool white(5000K), natural white(4000K), warm white (3000K)
 Power factor>0.95
 Beam angle: 110 Degree
 Saving energy: 50%
 Life span more than 50,000Hrs
 IP code: IP40
 Input Voltage: AC 100-277V 50/60Hz
 LED type: 2835 SMD LED
 Input Power: 36W/60W
 Reflector: Milky cover
 Standard warranty: 5years

Applications

- Hotels
- Conference/Meeting rooms
- Factories and offices
- Commercial purposes
- Residential/Institution buildings
- Schools, colleges, universities and hospitals
- Places which needs energy saving and high color rendering index lighting.

Dimensions(Unit:mm/inch)

Remark:The max current consumption of our driver to 0-10V dimmer is 2 mA each one

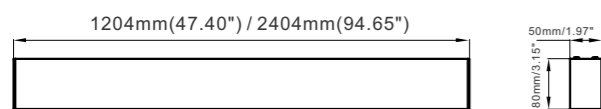

All dimension tolerance is ± 0.5 mm unless otherwise noted.

Electrical Connection

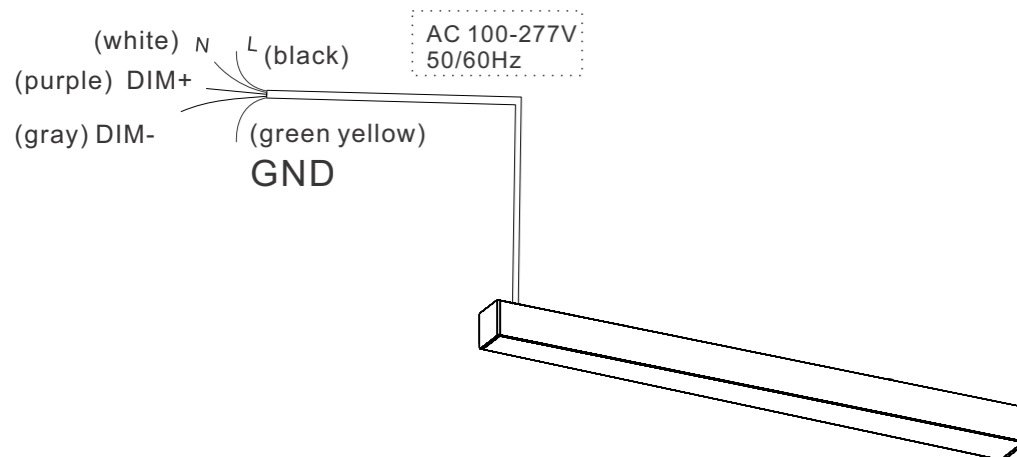

(Remark: The max current consumption of our driver to 0-10V dimmer is 2mA each one)

INSTRUCTION MANUAL

How to install

Suspendent installation

Step1:Accessories

1. 8050 lamp body	1pcs	2. square-head screw	4pcs	3. safety rope	2pcs
4. fixing head 3	4pcs	5. sewing machine	2pcs	6. suspendent rope	2pcs
7. fixing head 1	2pcs	8. 4X30PA screw	2pcs	9. fixing head 2	2pcs
10. rubber plug	2pcs	11. fixing head 3	4pcs	12. doubling clamp	4pcs
13. screw	2pcs				

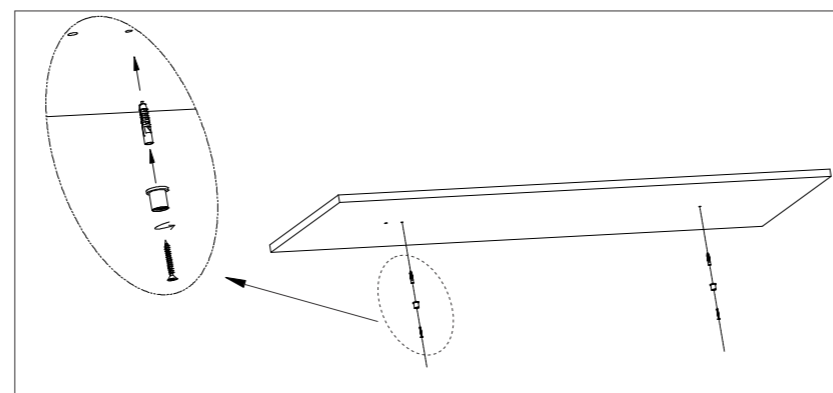
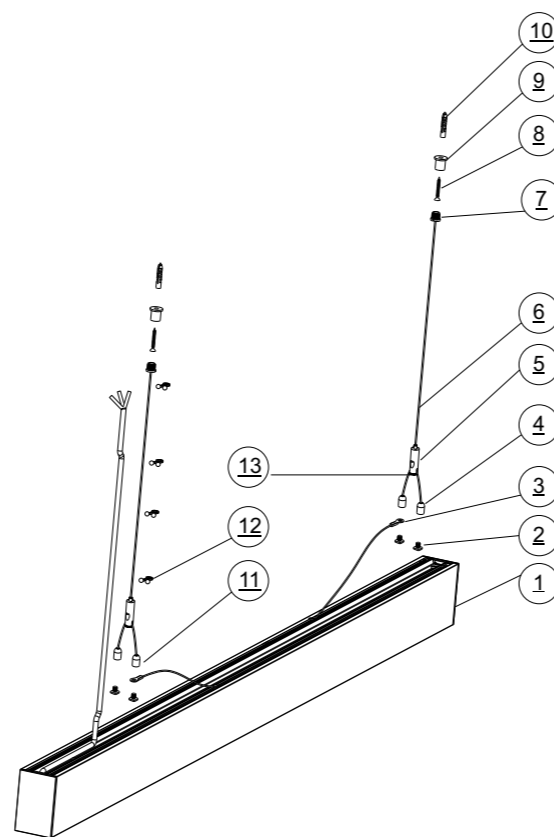

Step2:Drill hole in the ceiling, push the rubber plug into the ceiling, fix the fixing head 2 in the ceiling with 4X30PA screw.

INSTRUCTION MANUAL

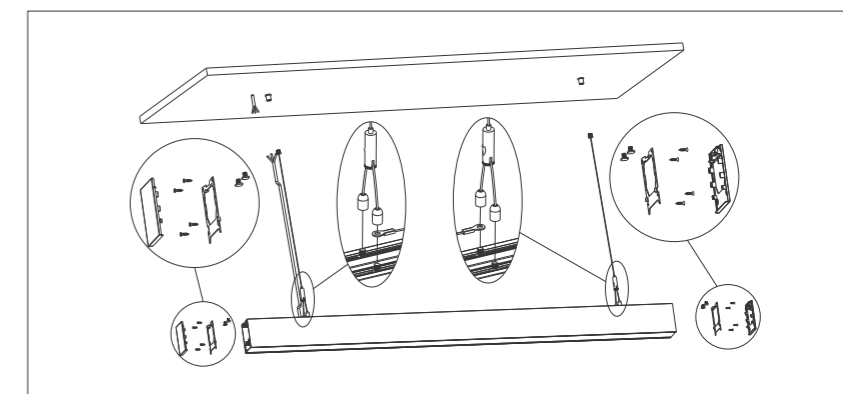

Step3:1. Dismantle the end cap, screws and fixing pieces of end cap on both ends of the lamp, then slide the square-head screw into the card slot of lamp, finally assemble the end cap, screws and fixing pieces of end cap back. If the square-head screw is already slid into the card slot of lamp, you can skip this step.

2. As shown on the diagram, put the safety rope onto the square-head screw, then tighten the fixing head 3 and square-head screw onto the lamp.

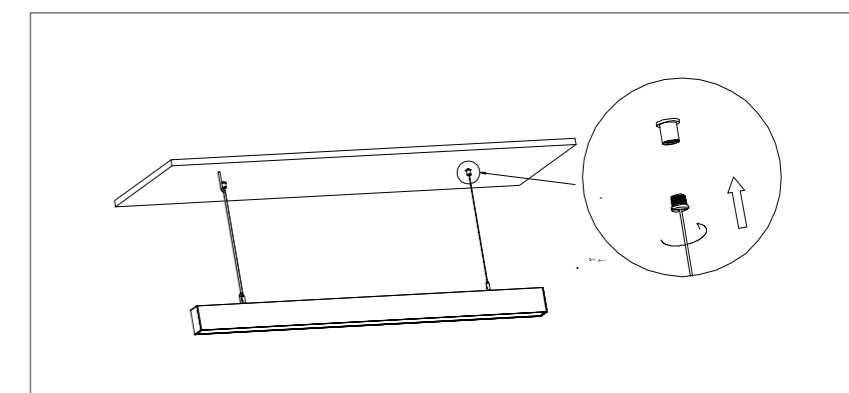

Step4:a. Suspendent method on the left: thread the power wire through 8-figure buckle fixed on the left, then install the whole set of fixing clip on the lamp;
 b.Suspendent method on the right install the clip on the lamp.

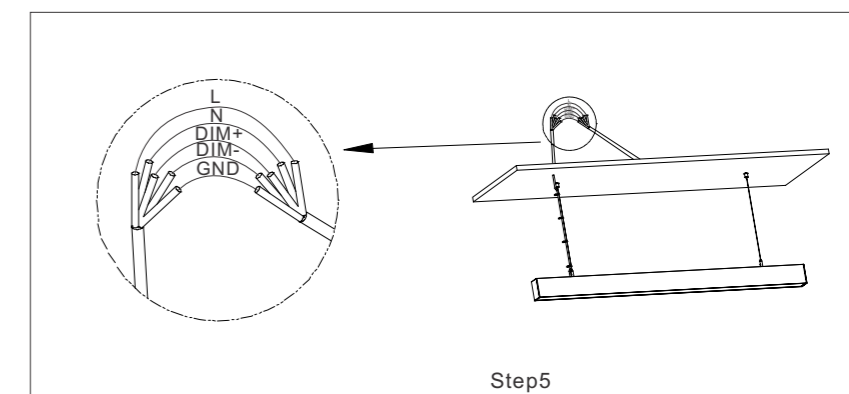

Step5:fix the fixing head 1 with fixing head 2 tightly, and adjust suspendent rope with sewing machine to balance the lamp, finally connect input wire of lamp;



INSTRUCTION MANUAL

Ceiling installation

Step1:Accessories

a. 8050 lamp body	1pcs	b. screw	6pcs	c. safety rope	2pcs
d. clip	2pcs	e. screw	2pcs	f. elevated part of clip	2pcs
g. rubber plug	4pcs				

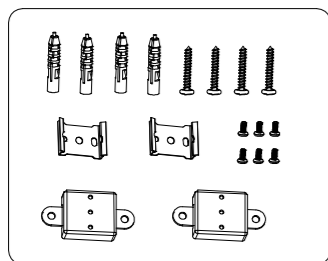
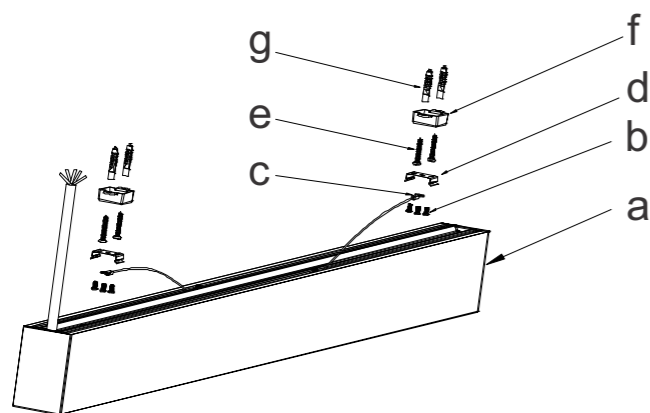

ceiling accessories

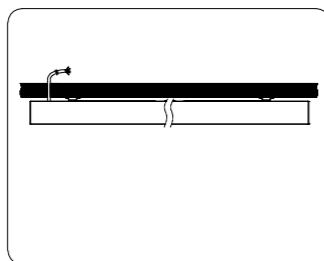

installation diagram

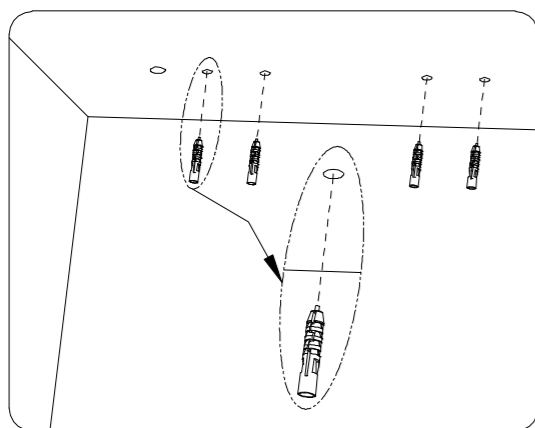

1. Plan hole distance, and drill 4 holes of 3.0mm φ and 1 hole of 10.0mm φ;

INSTRUCTION MANUAL

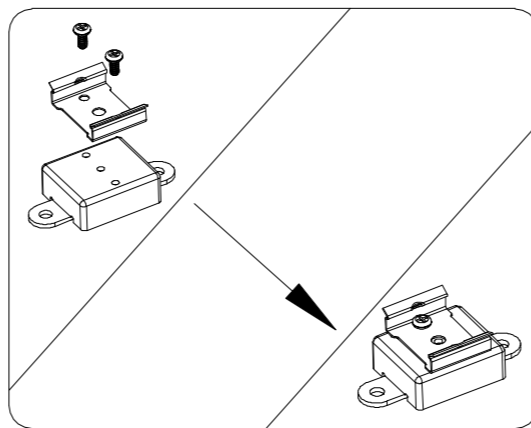

2. Fasten clip and elevated parts of clip with screws;

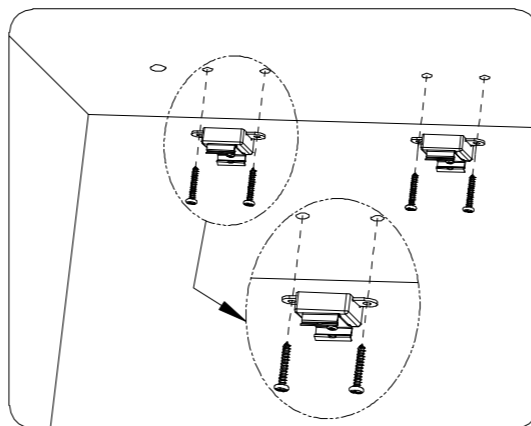

3. Fasten assembled clip kits in plastic rubber of ceiling with screws;

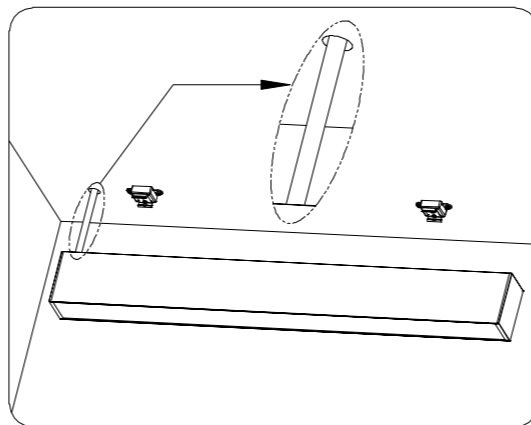

4. Thread AC input wire of lamp through another side of ceiling;

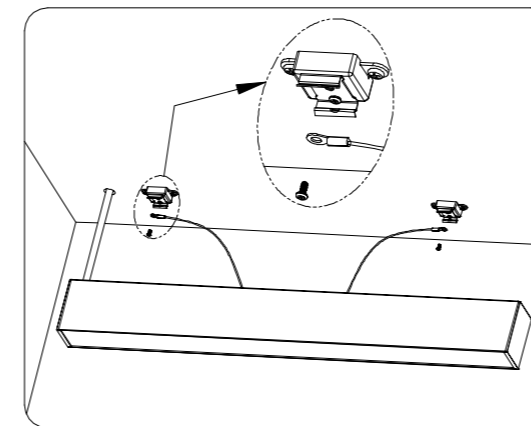

5. Thread screw through fixing hole of safety hole, then fasten it with clips kits;

INSTRUCTION MANUAL

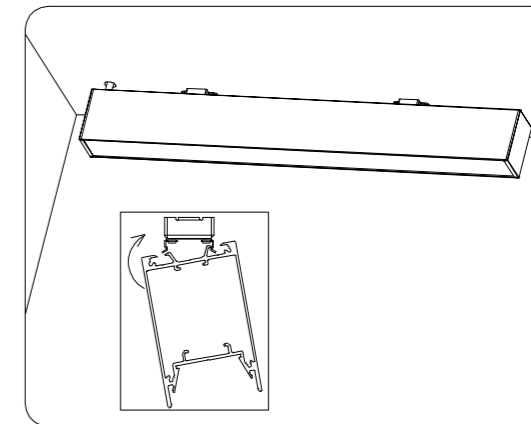

6. According above detailed figure, first snap one side on clip kits, then rotate it to install on another side of clip kits;

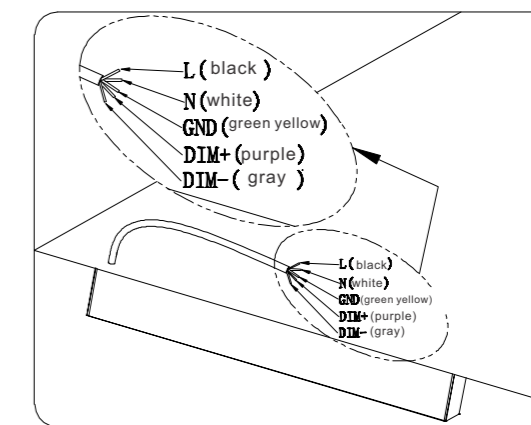

7. Connect AC according mark on the input wire, then illuminate lamp, installation finish.

! Notice

1. Please read the specification first, to make sure the service environment matches the condition in the specification before using.
2. Please confirm the applicable power supply before using.
3. Make sure the switch of product is off before connect to the power supply to prevent electric shock.
4. Operation against rules may damage your property even harm to your personal safety.
5. Preliminarily estimate required quantity of LED linear lights, then according to the power rating of single linear light to figure out the total power and design power supply plan.
6. Dangerous high voltage, Non-professionals are not allowed to maintain the products.
7. If the exterior flexible cable or wire is damaged, it must exchange by the supplier, its agent or other similar qualified personnel to avoid dangers.