

User's Guide

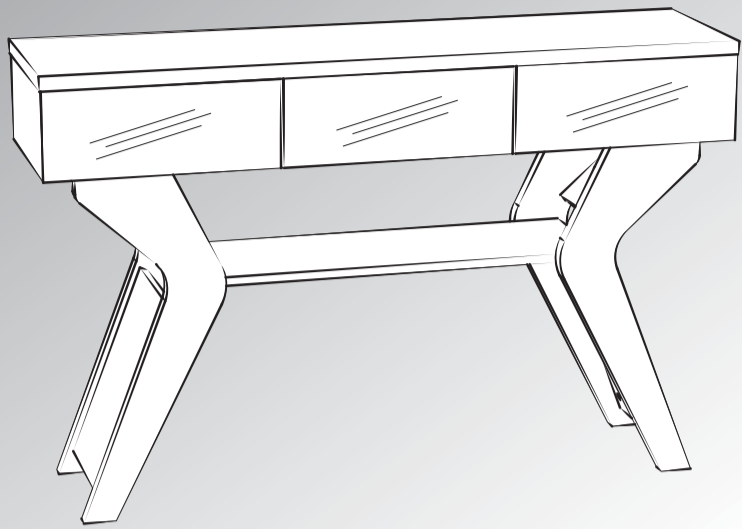

Virginia Console Table

1.0 Version

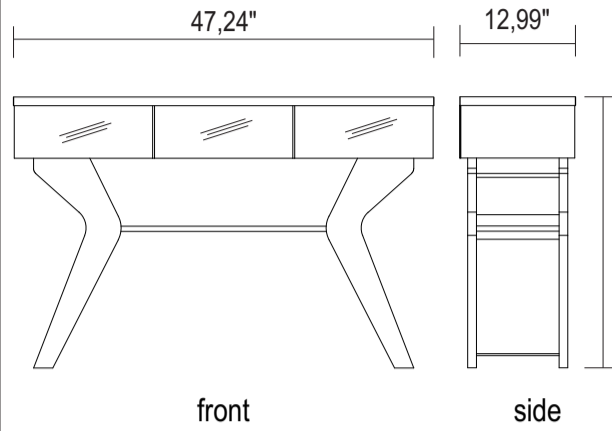

Conservation and Cleaning

Do not expose the product to sunlight, high temperatures and humidity. Do not drag objects across the surface of the unit (TV, DVD, stereo, decorative objects ...). Keep it in a fresh dry place. For cleaning, use a dry and soft cloth. Do not use abrasive materials or alcohol.

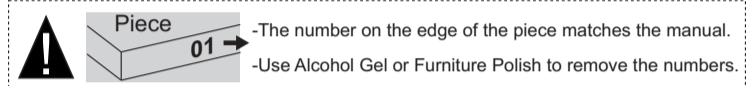

Hardware List

A		Peg	36
B		Minifix	32
C		Minifix Cam	32
D		Hole Cover	12
E		Screw Ø5,0x40mm	08
F		Fixed Foot	04
G		Double face tape	15
I		Allen Key	01

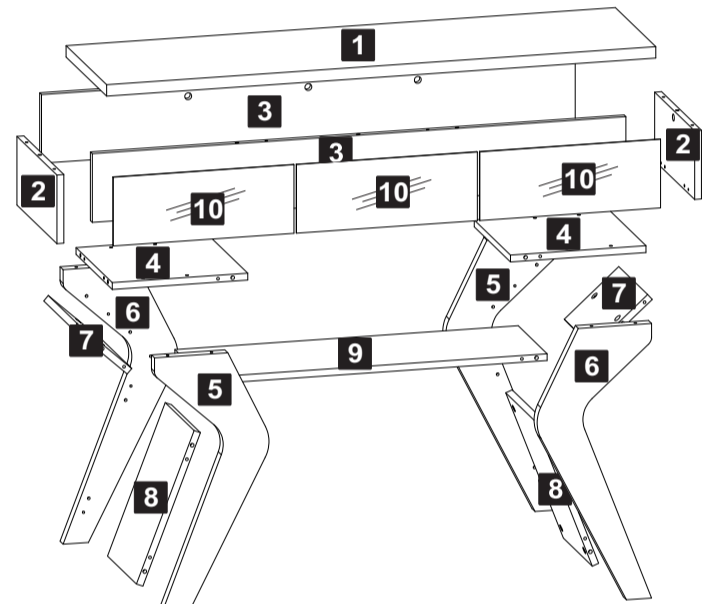

- Descrição
- 1-Top (1200x330x25mm)
 - 2-Side (150x326x15mm)
 - 3-Front/Back (1166x150x15mm)
 - 4-Base (296x296x15mm)
 - 5-left foot (600x250x25mm)
 - 6-right foot (600x250x25mm)
 - 7-Foot upper side (160x236x15mm)
 - 8-Foot back side (350x236x15mm)
 - 9-Shelf (750x236x15mm)
 - 10-Mirror (395x150x3mm)

1st Step

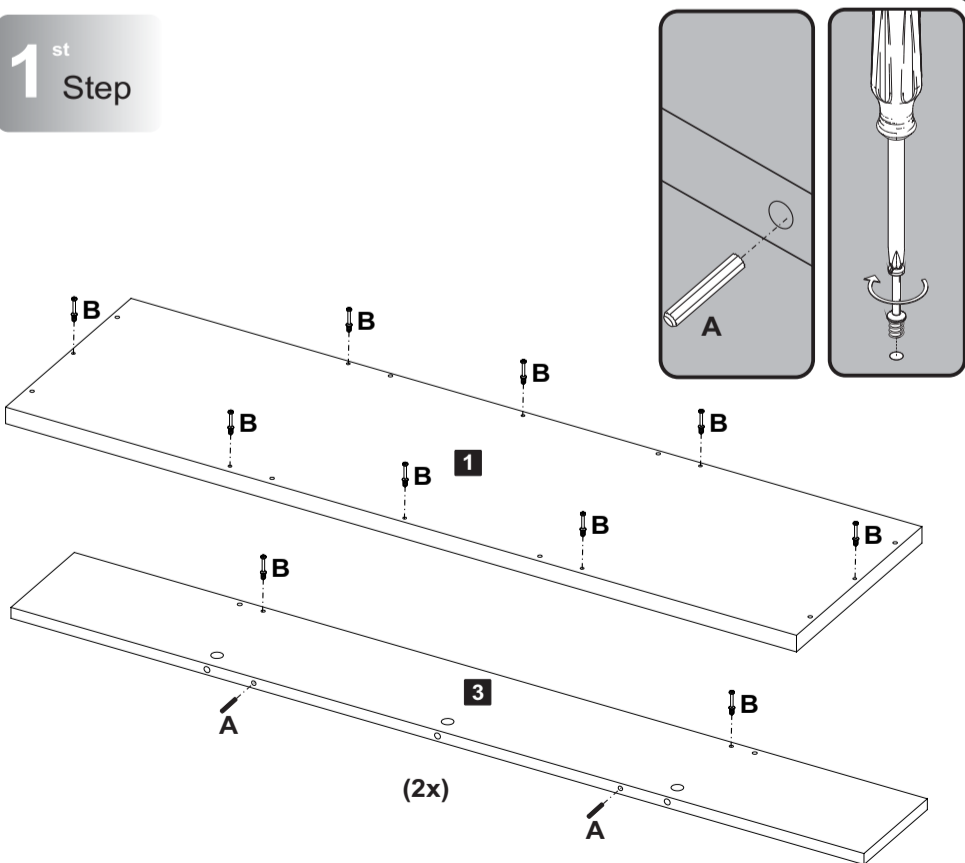

A Peg 04 **B** Minifix 14

2nd Step

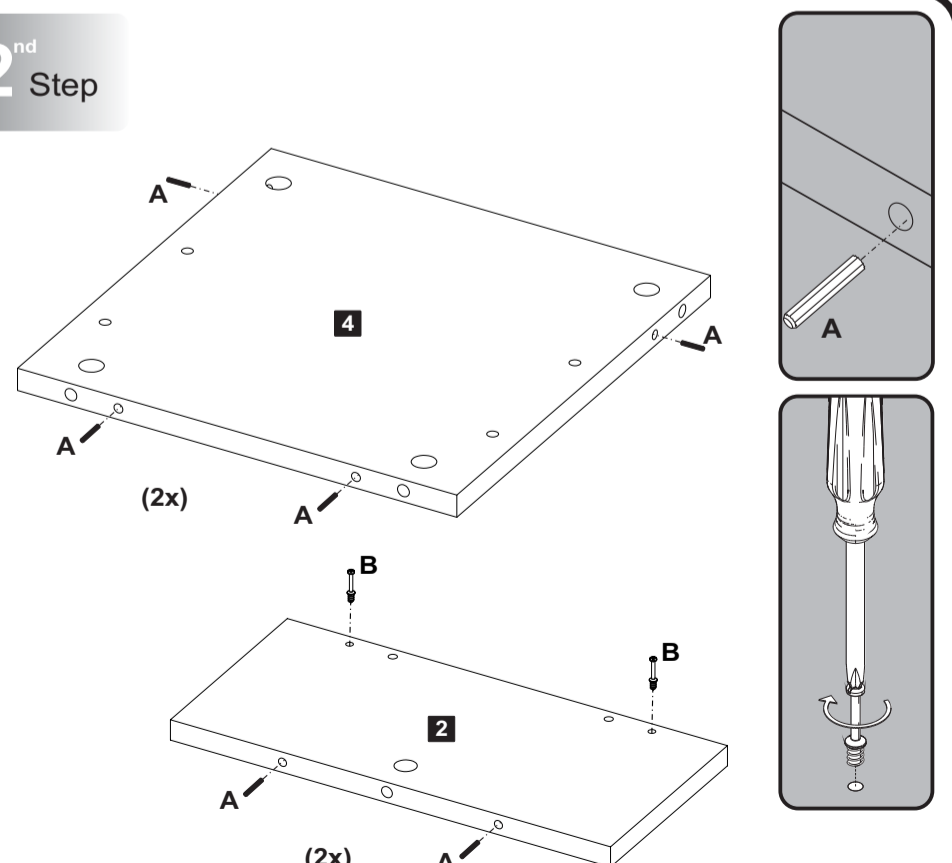

A Peg 12 **B** Minifix 04

3rd Step

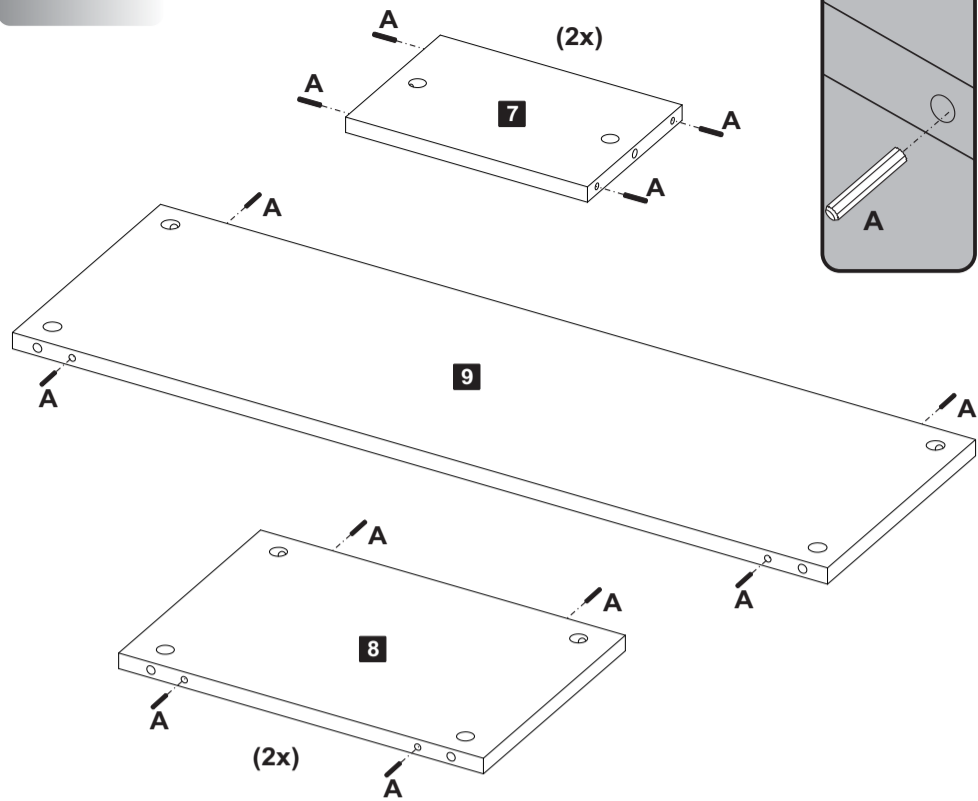

A Peg 20

4th Step

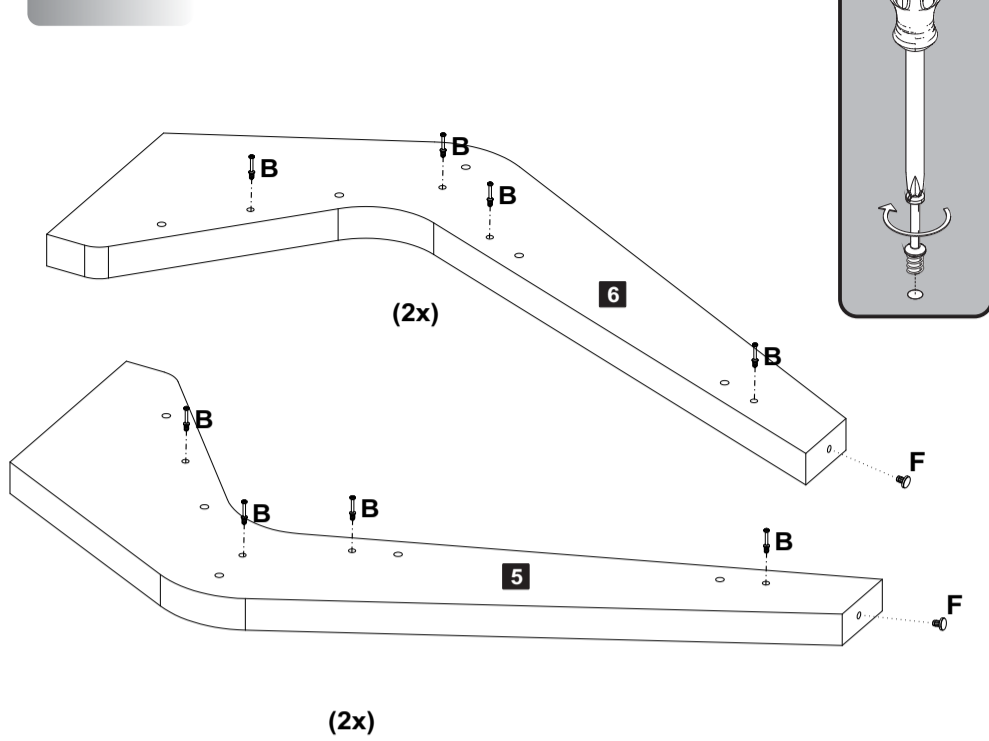

B Minifix 16 F Fixed Foot 04

5th Step

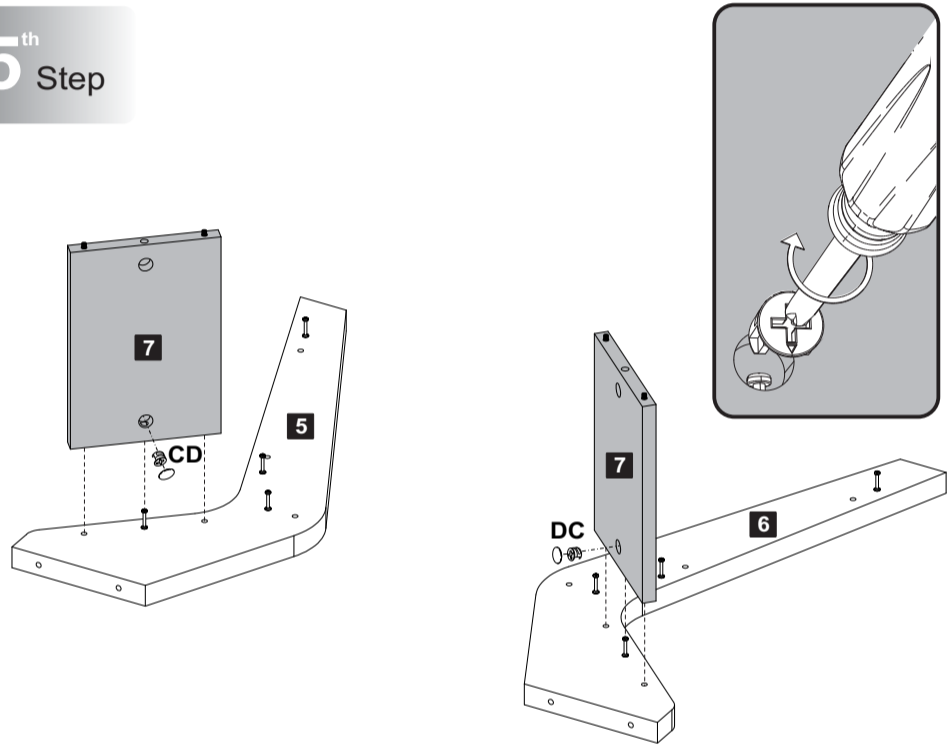

C Minifix Cam 02 D Hole Cover 02

6th Step

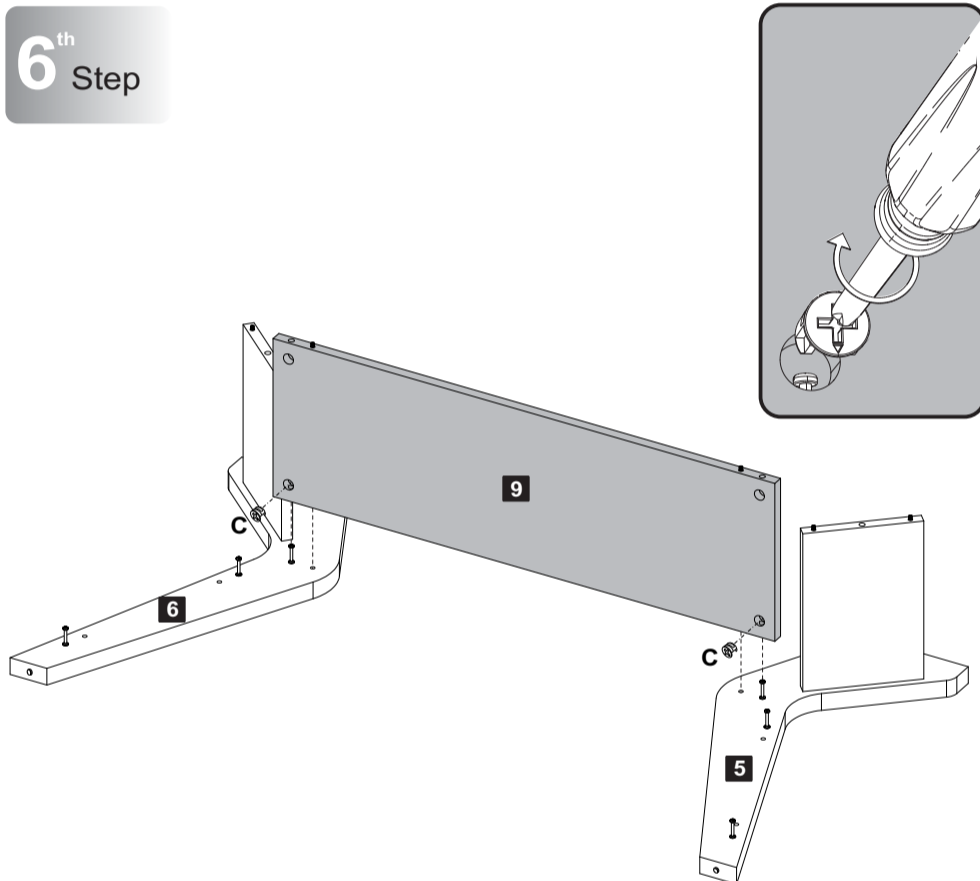

C Minifix Cam 02

7th Step

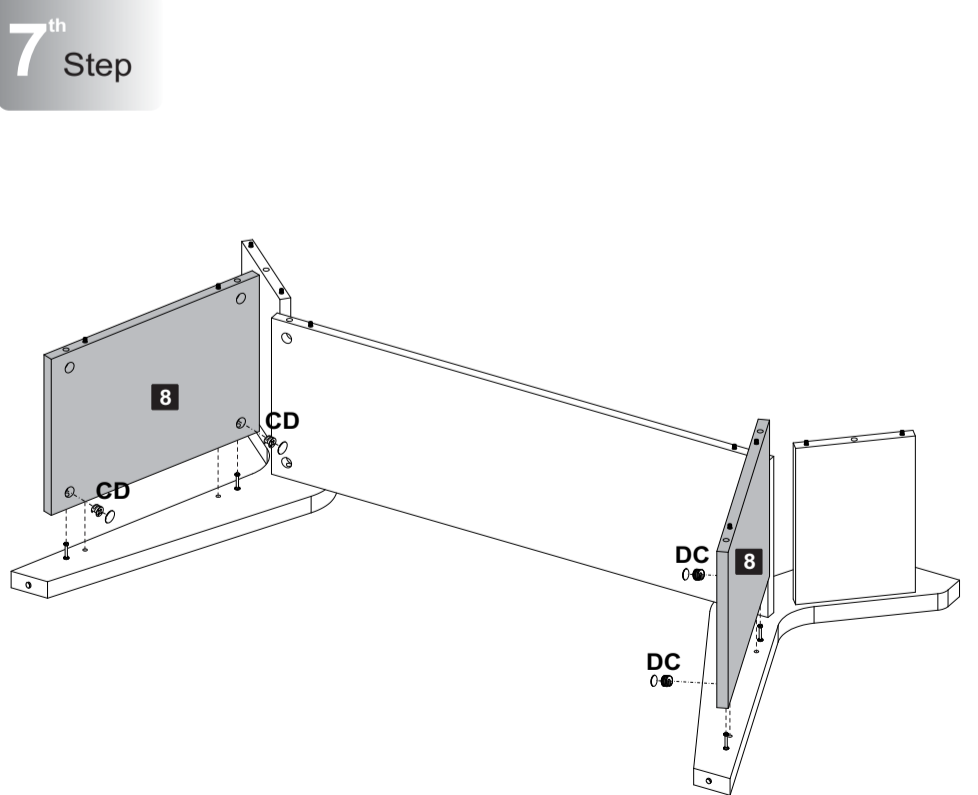

C Minifix Cam 04 D Hole Cover 04

8th Step

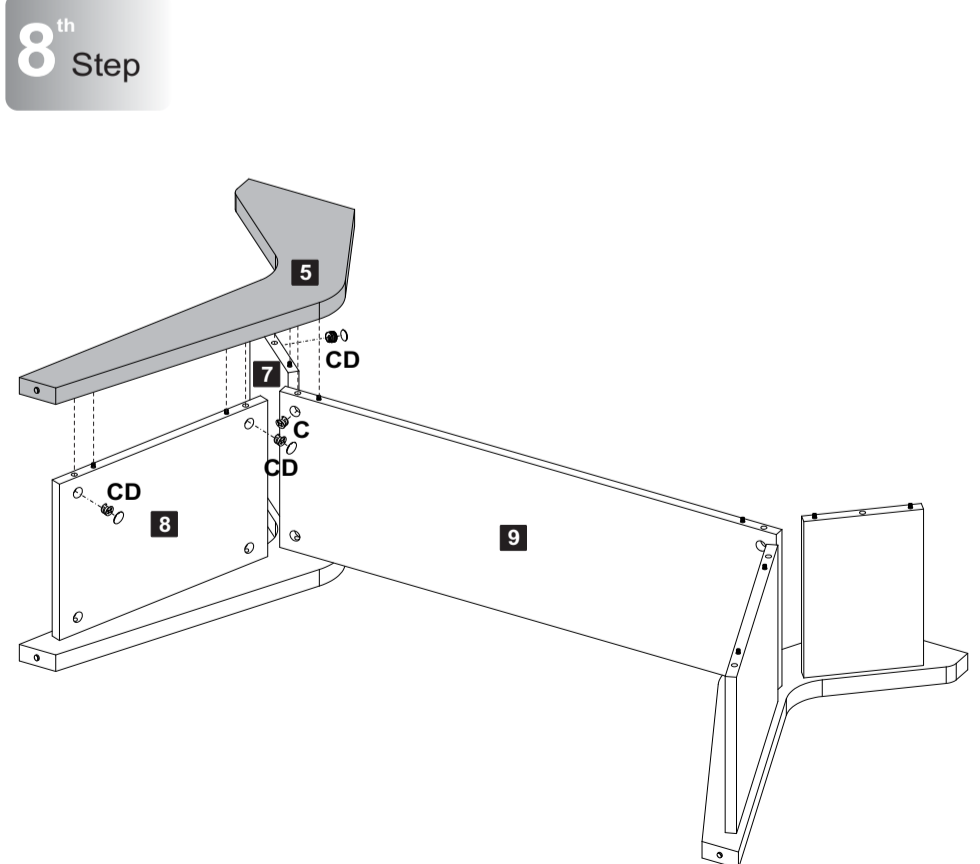

C Minifix Cam 04 D Hole Cover 03

9th Step

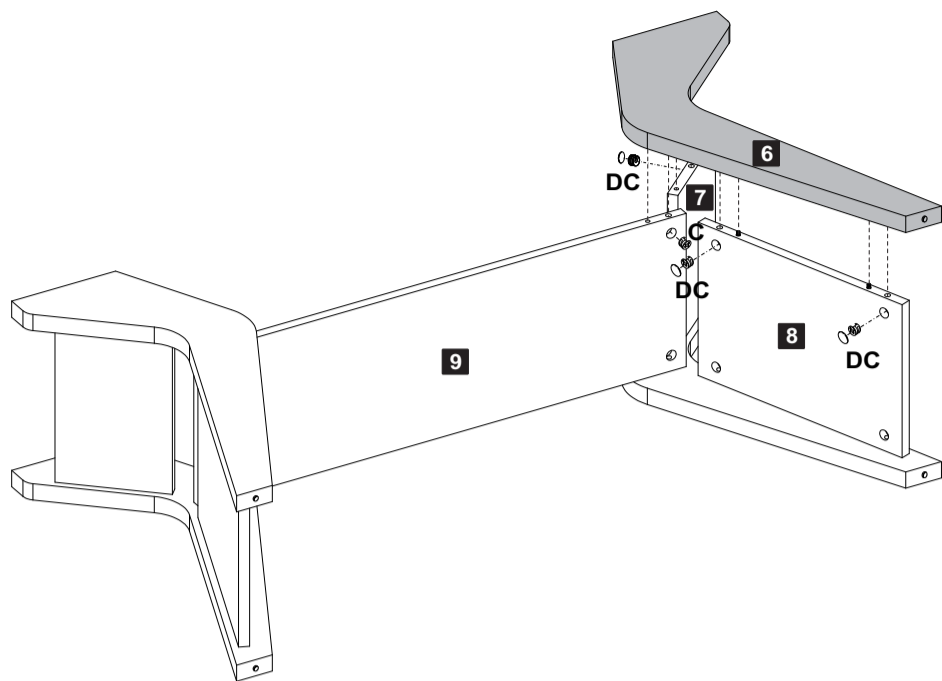

C Minifix Cam 04 D Hole Cover 03

10th Step

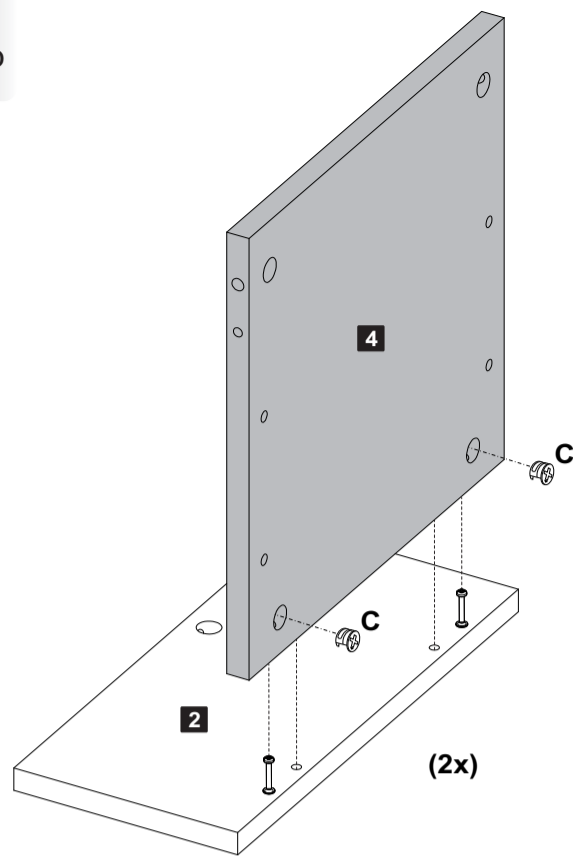

C Minifix Cam 04

11th Step

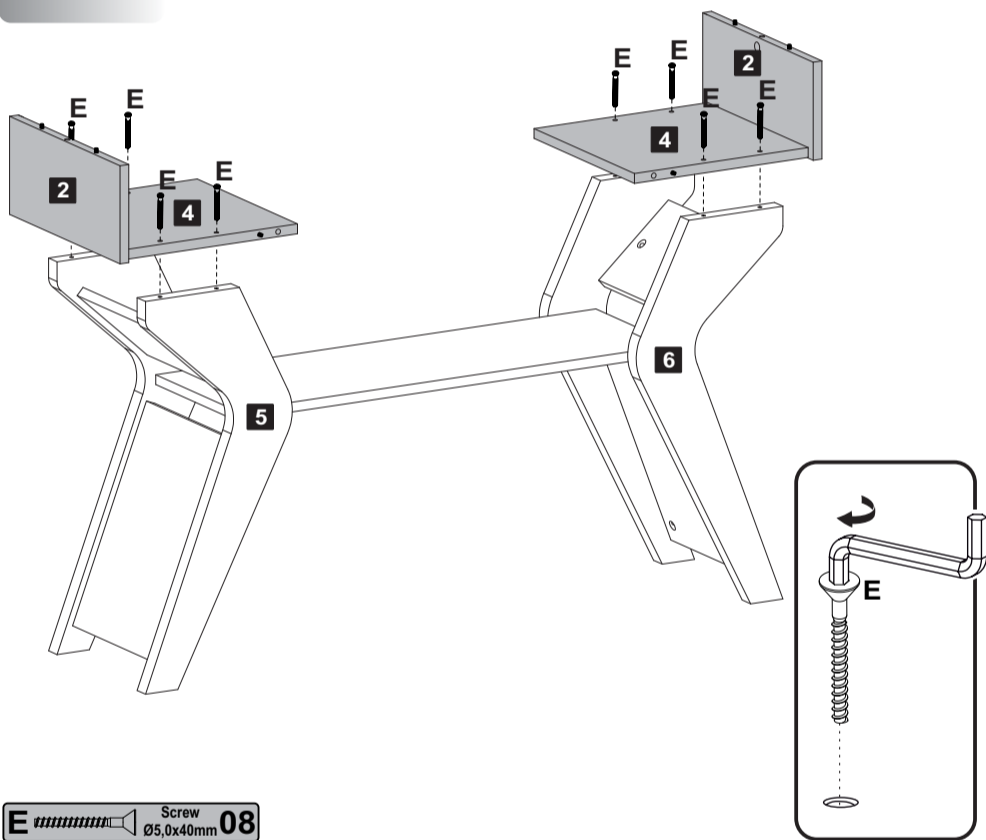

E Screw Ø5,0x40mm 08

12th Step

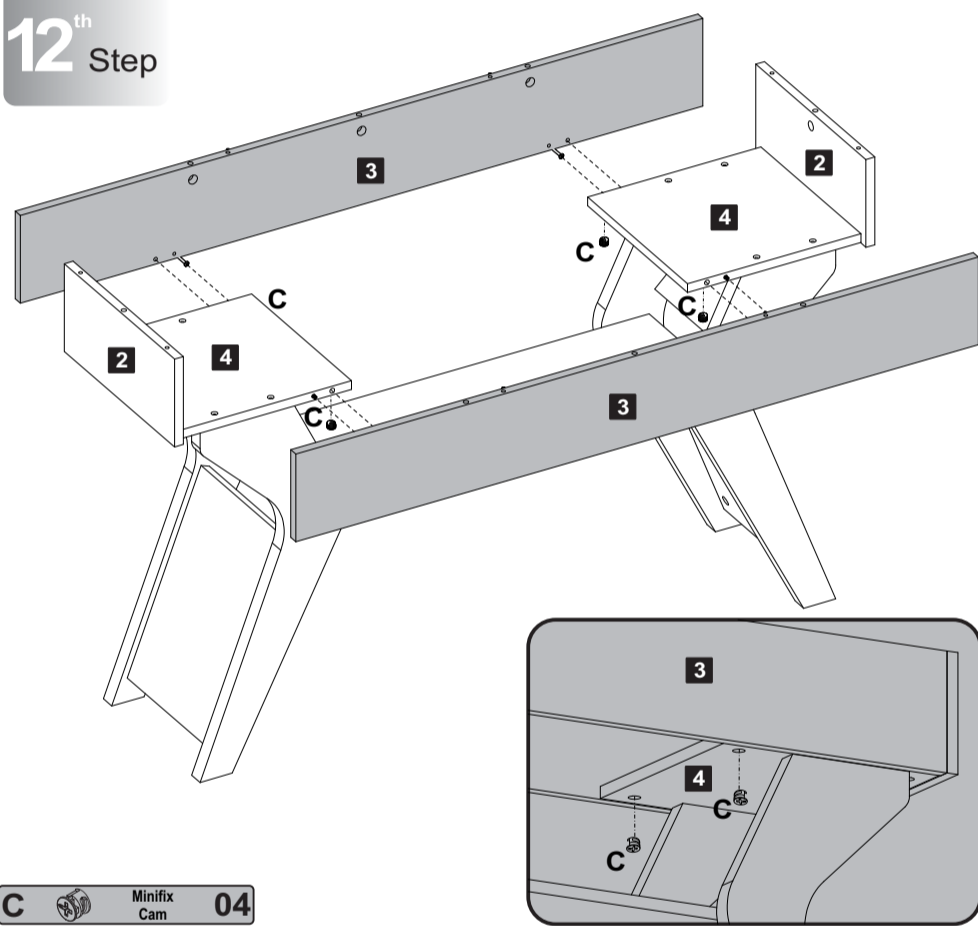

C Minifix Cam 04

13th Step

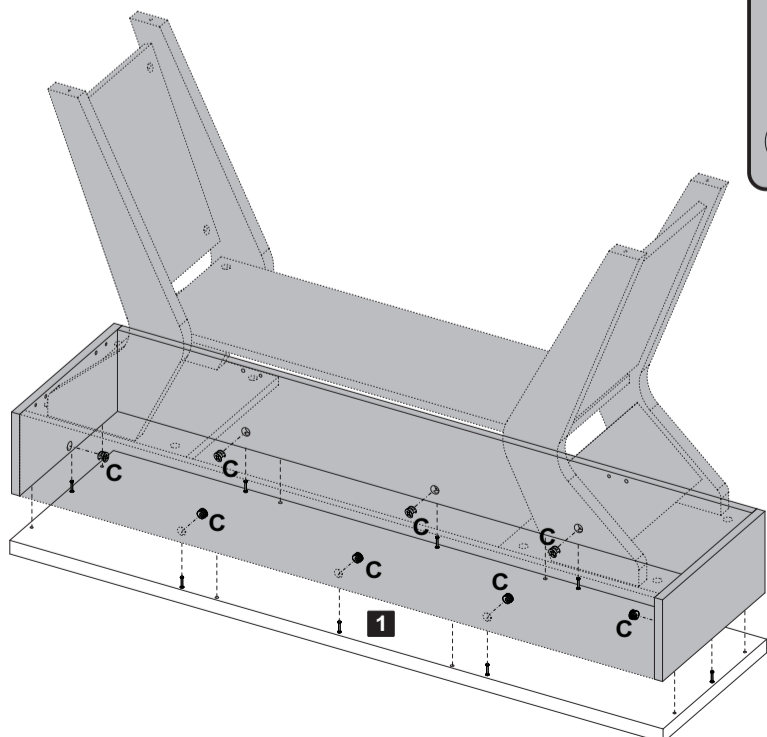

C Minifix Cam 08

14th Step

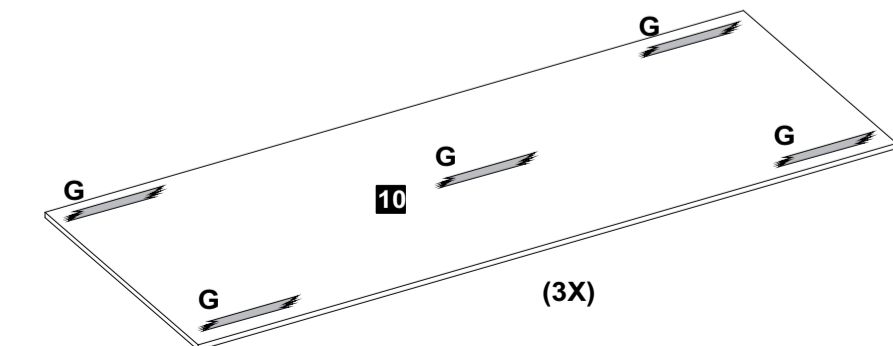
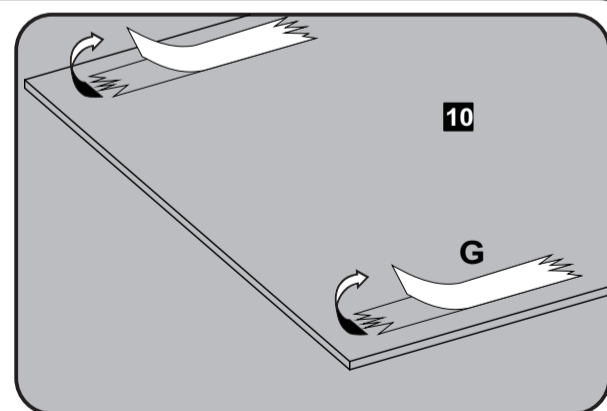

G Double face tape 15



-Wipe the surface with a cloth before to apply the double face tape.

15th Step

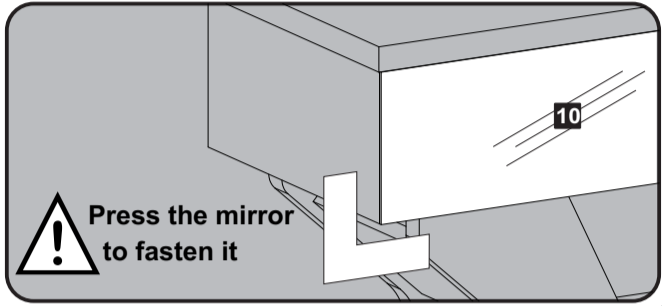
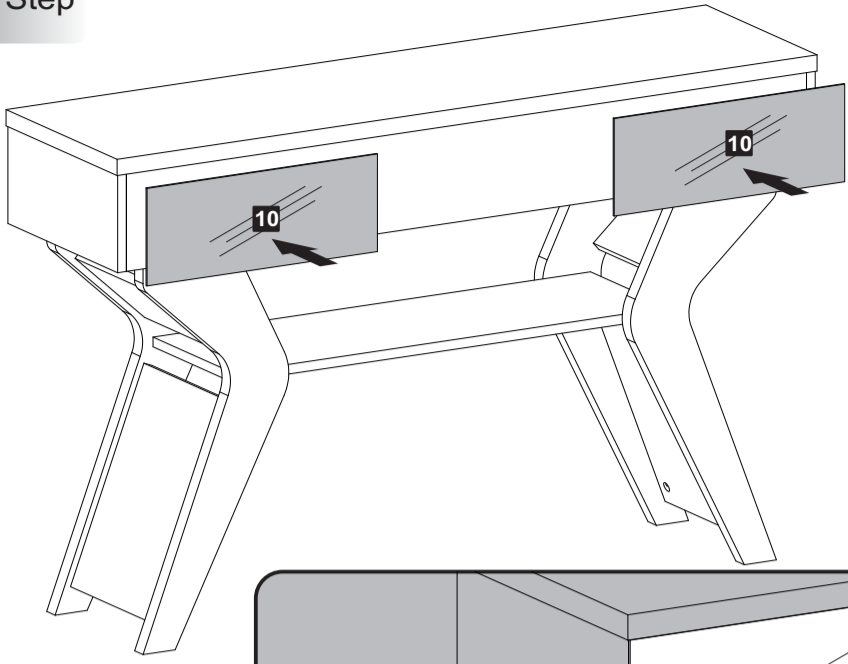

16th Step

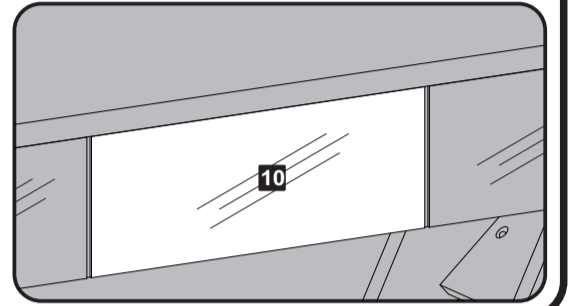
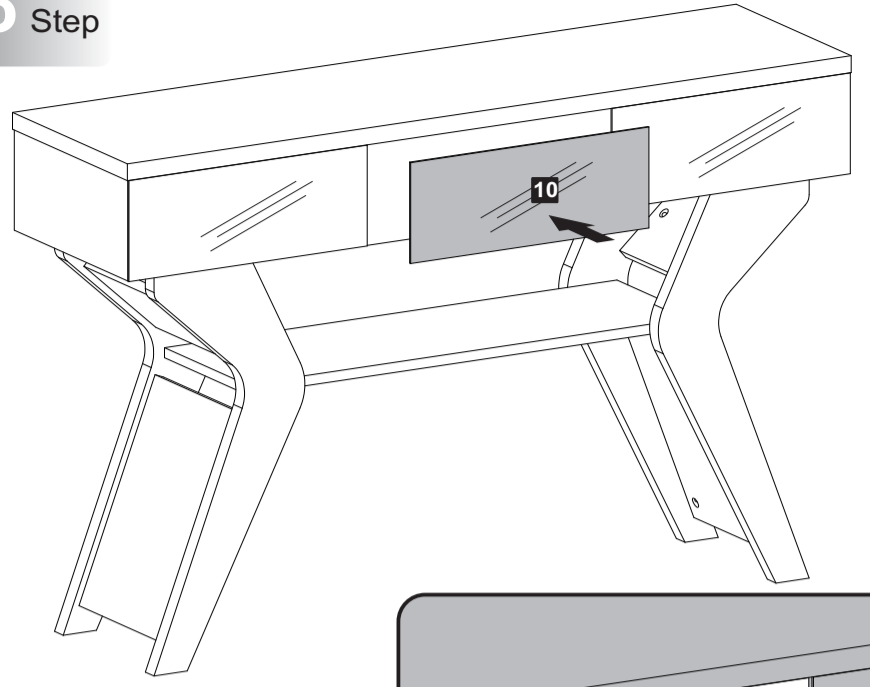

17th Step

