

Depot TV Stand

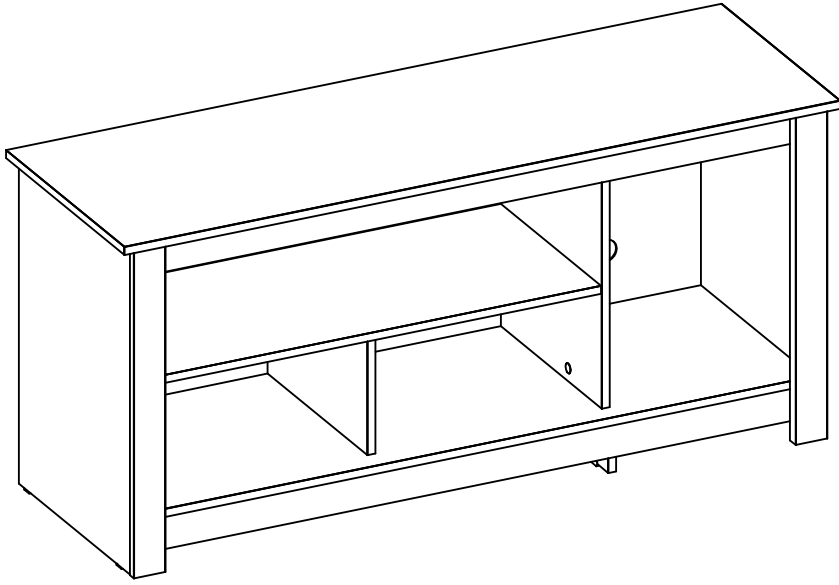

Dimensions/Dimensiones:

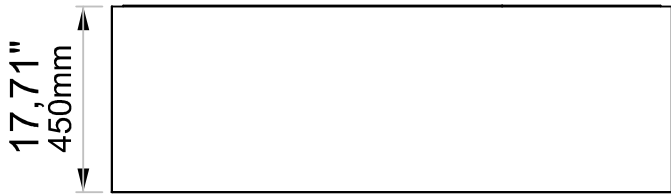
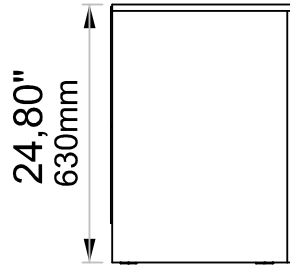
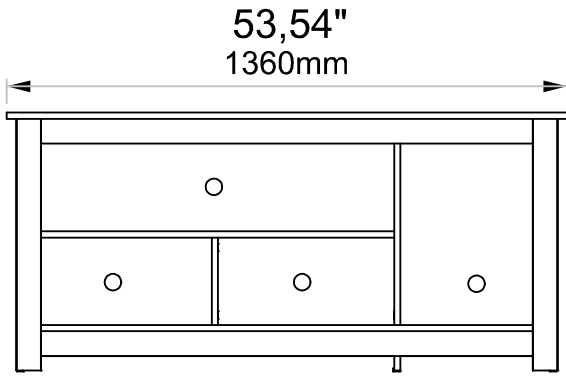

Assembly Instructions/
Instrucciones de Montaje.

Introduction / Introducción:

- *Read the manual and follow the steps for a perfect assembly.**
- *Prepare the environment before you start. Leave the room completely clean to start the assembly. Use the carton of the box as a protection layer to separate and protect the parts in order to avoid damages. Image 01.**
- *Don't install it in areas that may be damp, with infiltrations.**

*Observe cuidadosamente el manual y siga estrictamente los pasos de montaje.

*Antes de comenzar prepare el ambiente, dejando completamente limpio y con buen espacio para iniciar el montaje del producto. Utilice el cartón del propio embalaje, así como la protección de manta aislante para separar y apoyar las piezas retiradas de la caja. Forra el área de montaje con la manta aislante, así evita avería en la piezas durante el proceso de montaje, Image 01.

*No instalar en superficies húmedas, o con infiltraciones.

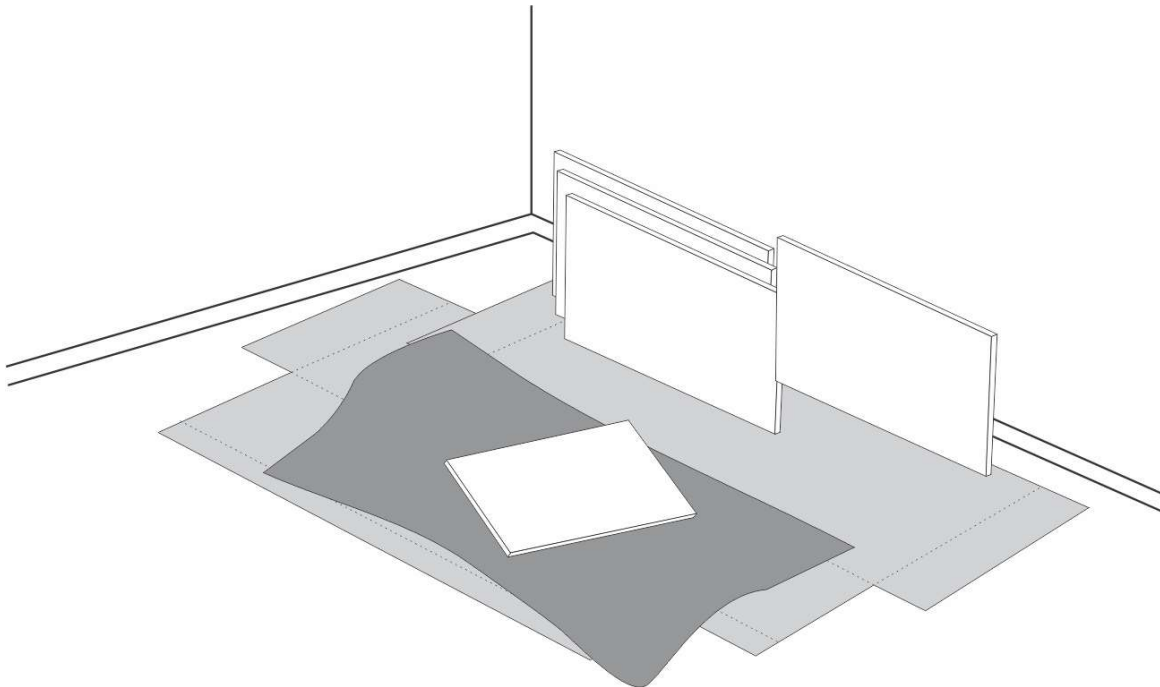

*Image 01 Separated parts / Piezas separadas

*** Before beginning the assembly check all components with the parts list, separate hardware by type and assemble the furniture lying down.**

* Antes de comenzar el montaje chequea todos los componentes con la lista de piezas, separe los herrajes por tipo y arma el mueble acostado.

*** The parts come with their code stamped on.**

* Los códigos de las pieza están sellados en las mismas.

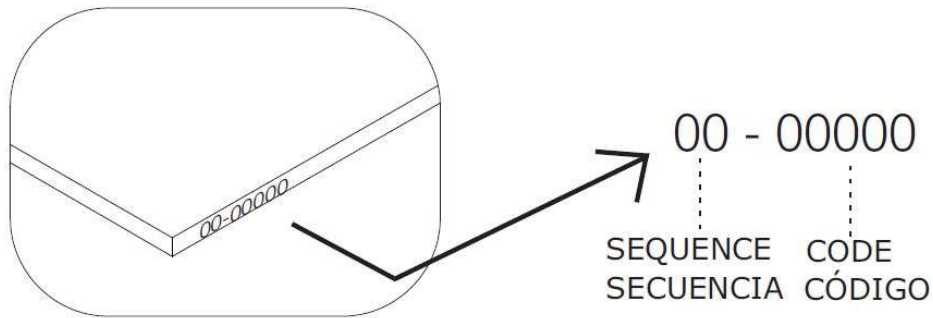

Tools / Herramientas

SCREWDRIVER

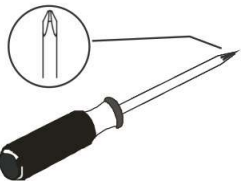

RUBBER CAUCHO



ELETRIC
SCREWDRIVER

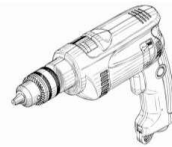

= X01

Hardwares / Accesorios



(A) = x24



(B) = x20



(C) = x20

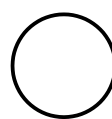

(D) = x12



(E) = x50

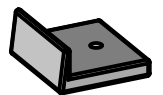

(F) = x6

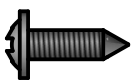

(G) = x12

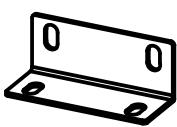

(H) = x3

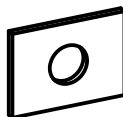

(I) = x12





(J) = x4

SEQUENCE	CODE	DESCRIPTION	QTY
01	90000	BASE	1
02	90001	LEFT SIDE	1
03	90002	RIGHT SIDE	1
04	90003	FRONT BASEBOARD	1
05	90004	LOCK	1
06	90005	BACK BASEBOARD	1
07	90006	DIVISION	1
08	90007	SMALL DIVISION	1
09	90008	SHELF	1
10	90009	TOP BOARD	1
11	90010	SIDEVIEW	2
12	90014	VISTA FRONTAL	1
13	90011	LEFT BACKGROUND	1
14	90012	BOTTON BACKGROUND	1
15	90013	TOP BACKGROUND	1

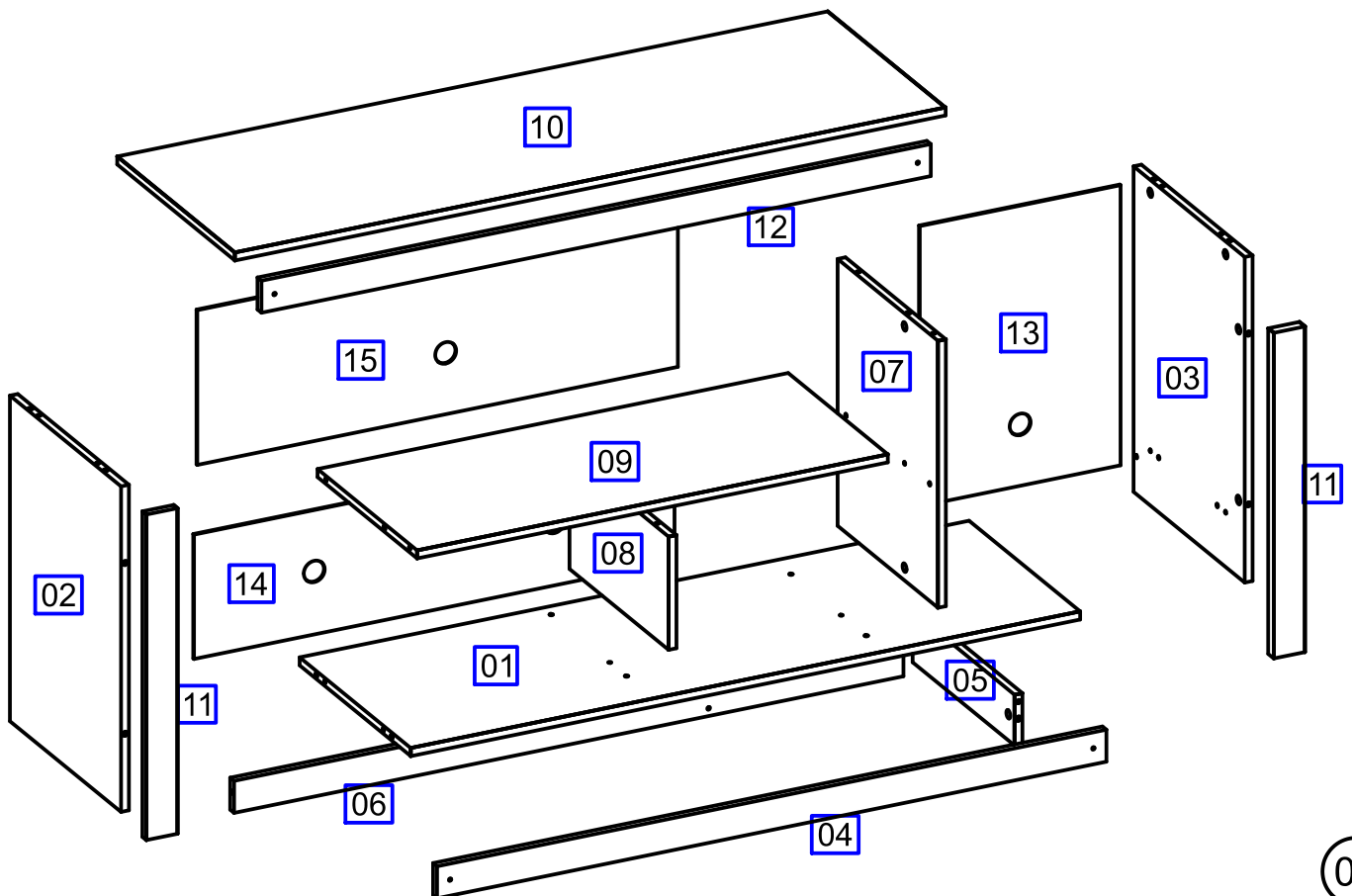
SECUENCIA	CÓDIGO	DESCRIPCIÓN	CANTIDAD
01	90000	BASE	1
02	90001	LADO IZQUIERDO	1
03	90002	LADO DERECHO	1
04	90003	RODAPIÉ DELANTERO	1
05	90004	TRABA	1
06	90005	RODAPIÉ TRASERO	1
07	90006	DIVISIÓN	1
08	90007	DIVISIÓN PEQUEÑA	1
09	90008	REPISA	1
10	90009	CUBIERTA	1
11	90010	PIEZA LATERAL	2
12	90014	PIEZA FRONTAL	1
13	90011	FONDO IZQUIERDO	1
14	90012	FONDO INFERIOR	1
15	90013	FONDO SUPERIOR	1



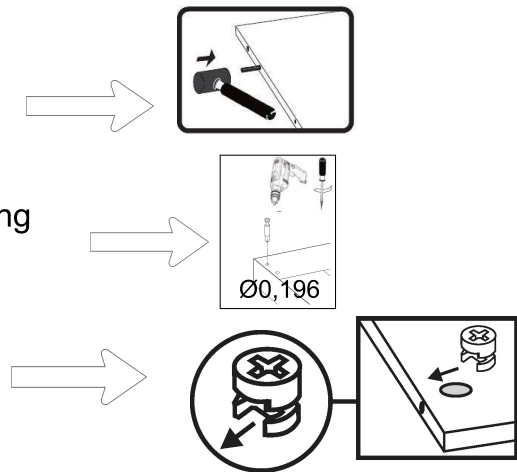

*** Before starting, you have to know:**

- () You should always fix the dowel until the end using a rubber hammer.
- () You must screw the hardware using an electric drilling machine or phillips screwdriver only in the 0,196 inches hole (the smaller hole).
- () Always fix this hardware with the arrow faced to the hole. Use screwdriver if necessary.



*** Antes de empezar, necesitas saber:**

- () Deves siempre fijar ese accesorio hasta el final usando un martillo de caucho
- () Deves siempre fijar ese accesorio usando un taladrador eléctrico o llave Phillips solamente en el agujero de 5mm.
- () Deves siempre fijar ese accesorio con la seta hacia el agujero. Use la llave phillips si es necesario.

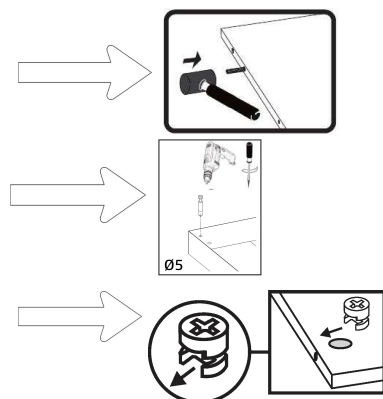

STEP/PASO 01

*** Insert hardware "B" on the faces of part 04.**

* Encaja los accesorios "B" en las caras.

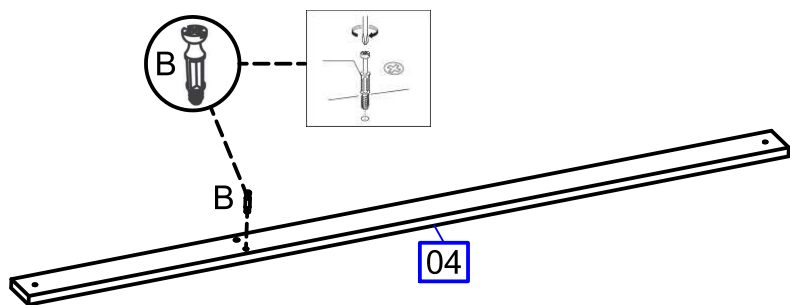

STEP/PASO 02

*** Insert the hardware "F" using the nail "E" and hardware "A" on the extremities of part 05. Then insert hardware "C" on the faces.**

* Encaja el componente "F" con el accesorio "E", y "A" en los extremos de la pieza 05. Insertar "C" en las caras.

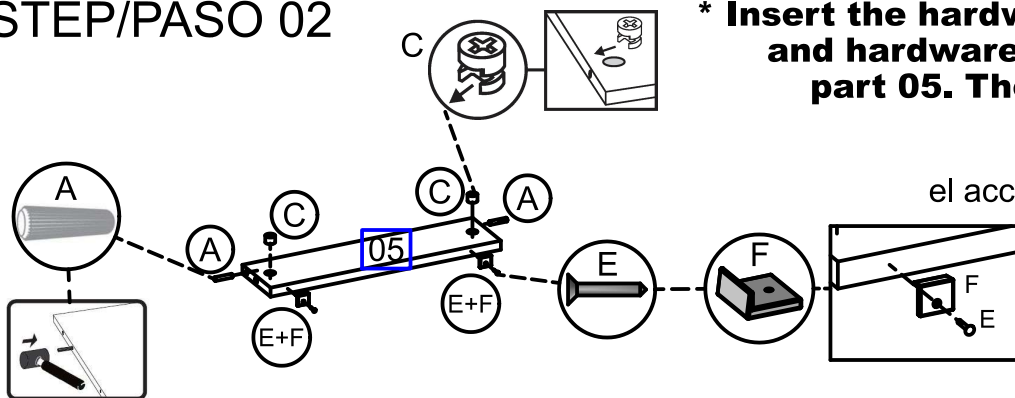

STEP/PASO 03

*** Insert hardware "A" into the extremity of part 06, and "B" on the faces.**

* Encaja los accesorios "A" en los extremos de la pieza 06 y "C" en las caras de la pieza 06.

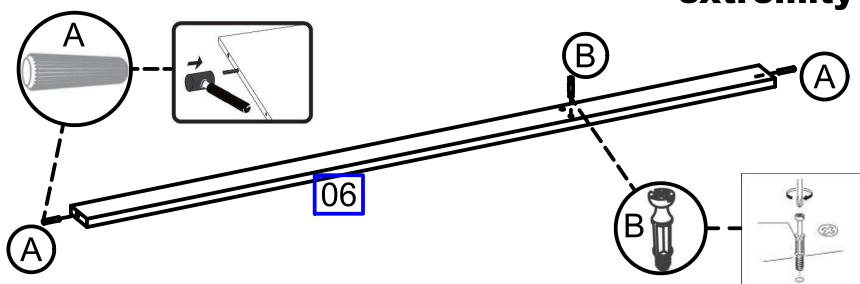

STEP/PASO 04

*** Insert hardware "A" on the extremities of part 01 and "B", "C" on the faces. Then fix hardware "H" with screw "G".**

*** Encaja los accesorios "A" en los extremos de la pieza 01, "B" y "C" en las caras. Fijar el accesorio "H" con el tornillo "G".**

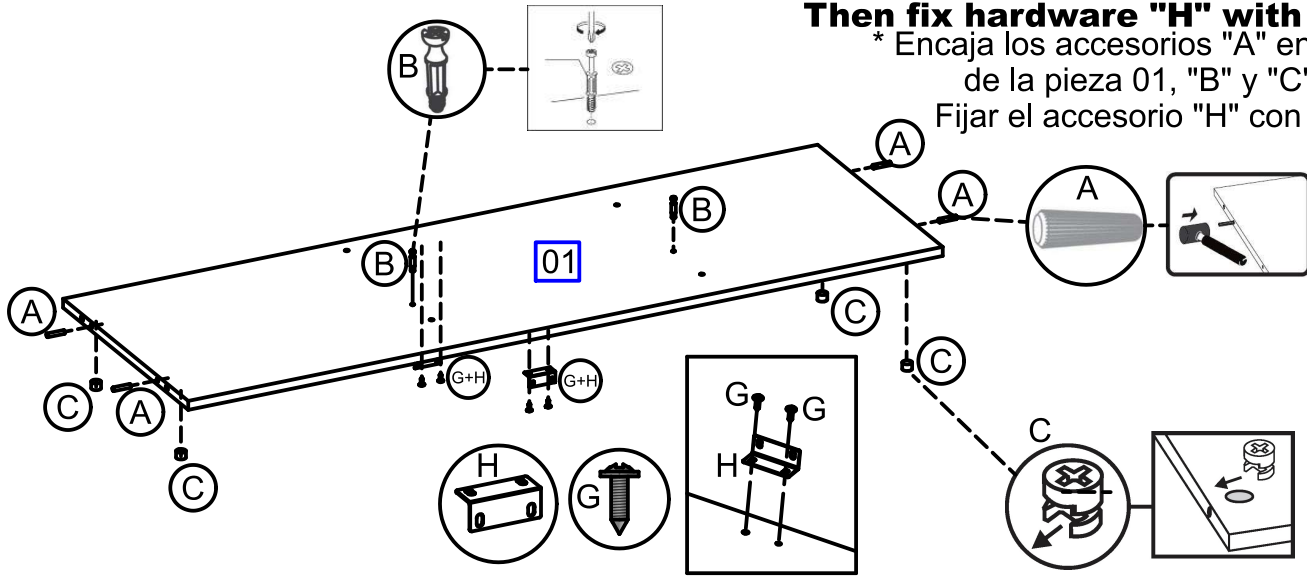

STEP/PASO 05

*** Insert hardware "B" on the part 11.**

*** Encaja el accesorio "B" en la pieza 11.**

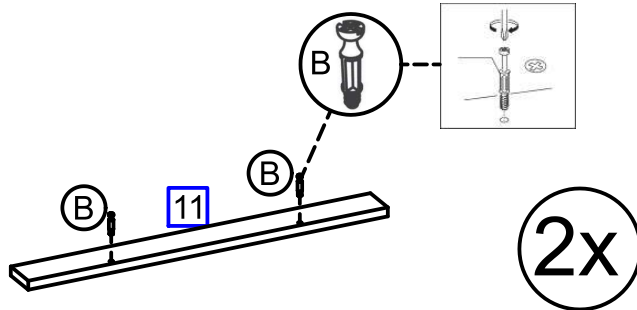

STEP/PASO 06

*** Insert hardware "F" using the nail "E" and hardware "A" on the extremities of the parts 02 and 03. Then insert hardware "B" and "C" on them.**

*** Encaja el componente "F" con lo accesorio "E", y "A" en los extremos de las piezas 02 y 03. Insertar "B" y "C" en las caras.**

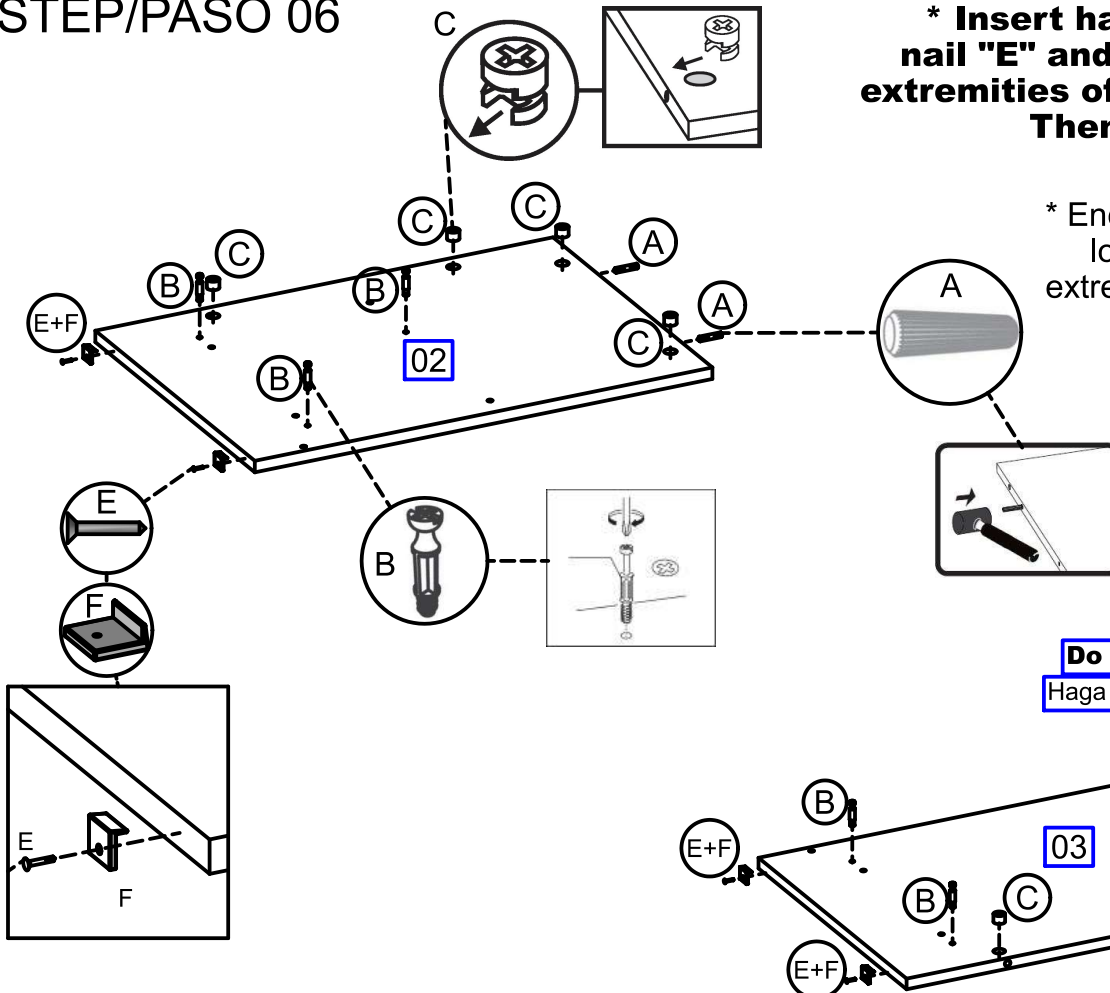

Do the same with part 03

Haga lo mismo con la parte 03

STEP/PASO 07

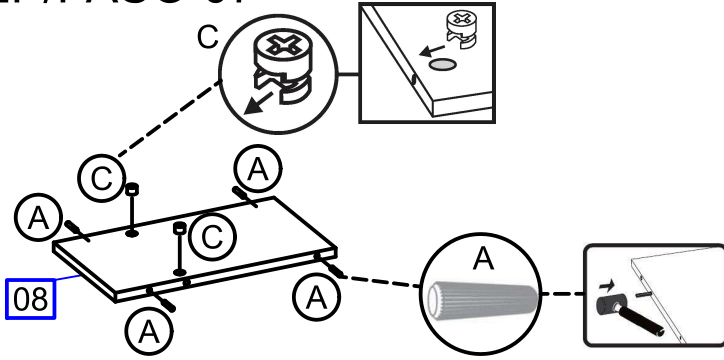

* Insert hardware "A" on the extremities of part 08 and "C" on the faces.

* Encaja los accesorios "A" en los extremos de la pieza 08, "C" en las caras.

STEP/PASO 08

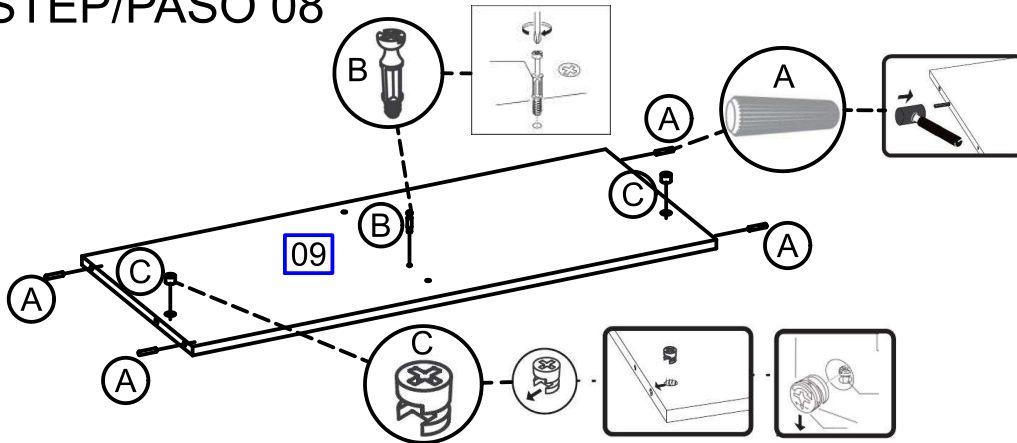

* Insert hardware "A" on the extremities of part 09 and "B", "C" on the faces.

* Encaja los accesorios "A" en los extremos de la pieza 09, "B" y "C" en las caras.

STEP/PASO 09

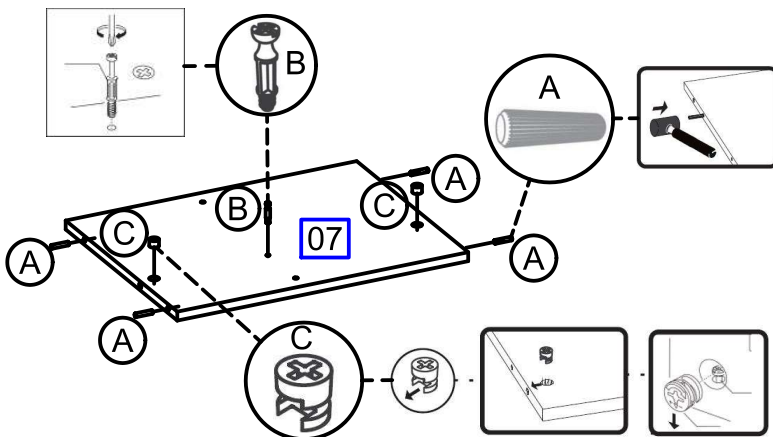

* Insert hardware "A" on the extremities of part 07 and "B", "C" on the faces.

* Encaja los accesorios "A" en los extremos de la pieza 07, "B" y "C" en las caras.

STEP/PASO 10

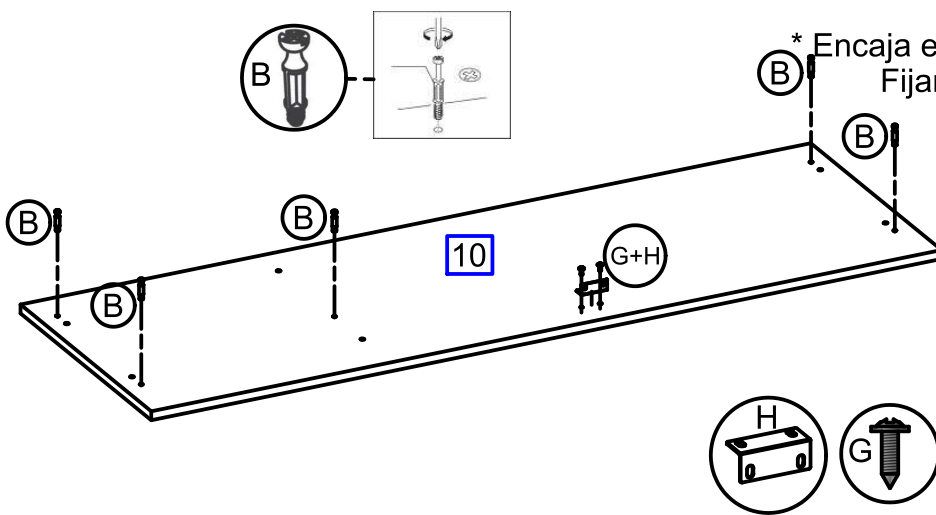

* Insert hardware "B" on the face of part 10. Fix the hardware "H" with screw "G" according to the pre roles.

* Encaja el accesorio "B" en la cara pieza 10. Fijar el accesorio "H" con lo tornillo "G" según las marcaciones.

STEP/PASO 11

Parts Preparation Preparación de Piezas

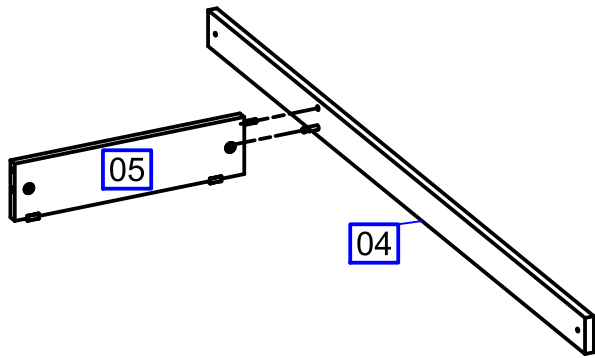

*** Attach part 05 to the part 04 according to the image. Then screw the nuts "C".**

* Enganche la pieza 05 en la pieza 04. Atonillar las tuercas "C".

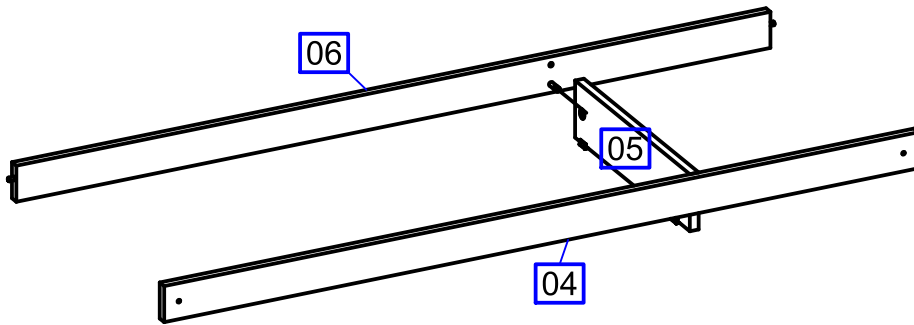
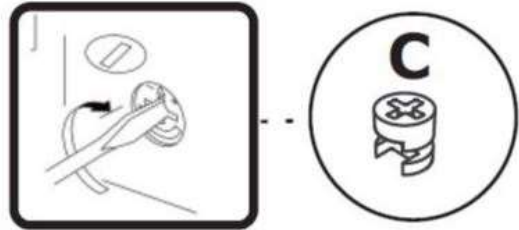

*** Attach part 06 to the part 05 according to the image. Then screw the nuts "C".**

* Enganche la pieza 06 en la pieza 05. Atonillar las tuercas "C".

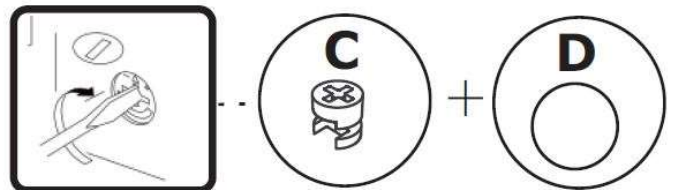
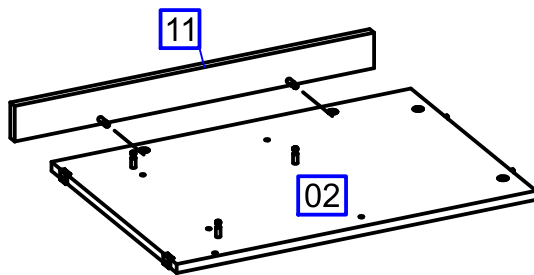

*** Attach part 11 to the part 02 and 03 according to the image. Then screw the nuts "C".**

* Enganche pieza 11 en la pieza 02 y 03. Atonillar las tuercas "C".

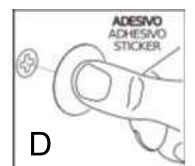
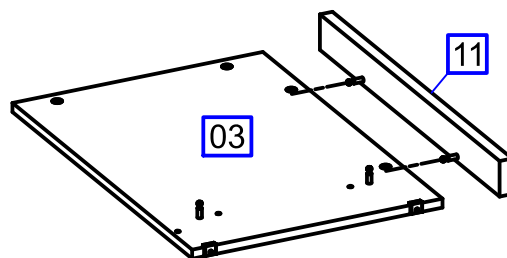

STEP/PASO 12

*** Attach part 01 to the parts 04 and 06 according to the image. Then screw them using "G".**

* Enganche la pieza 01 en las piezas 04 y 06 de acuerdo con la image. Fijar con el tornillo "G".

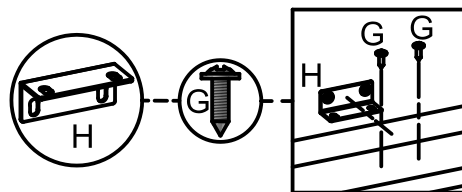
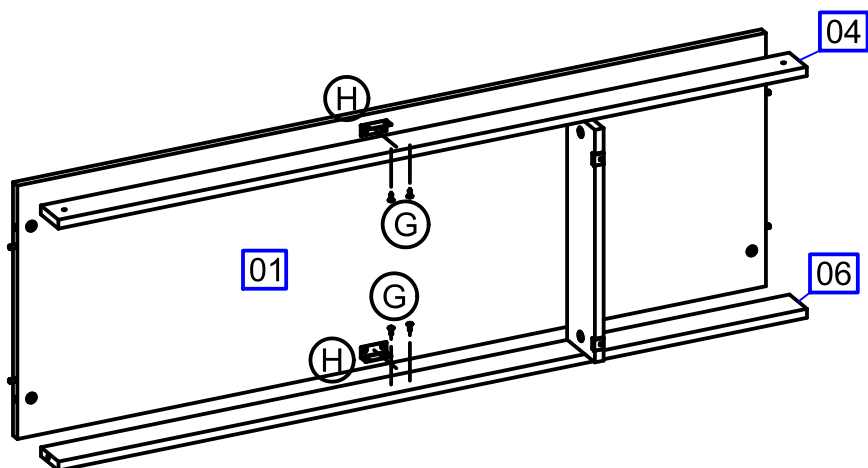

STEP/PASO 13

*** Attach part 02 to the parts 01 and 04 according to the image. Then screw them using nuts "C" and "J".**

* Enganche la pieza 02 en las piezas 01 y 04 de acuerdo con la image. Fijar usando el tornillo "C" y "J".

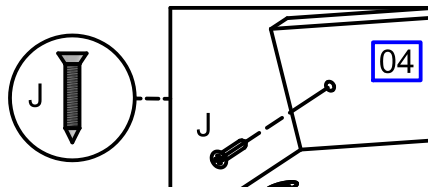
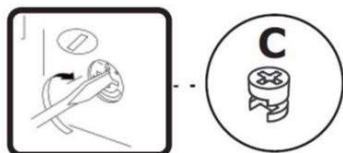
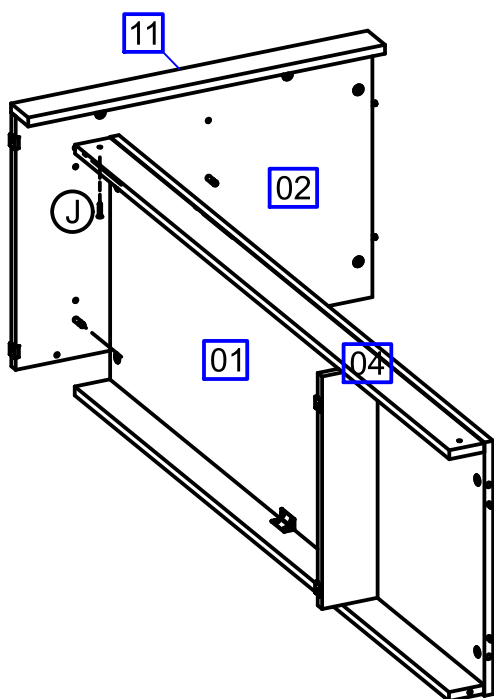

Do the same with part 03

Haga lo mismo con la parte 03

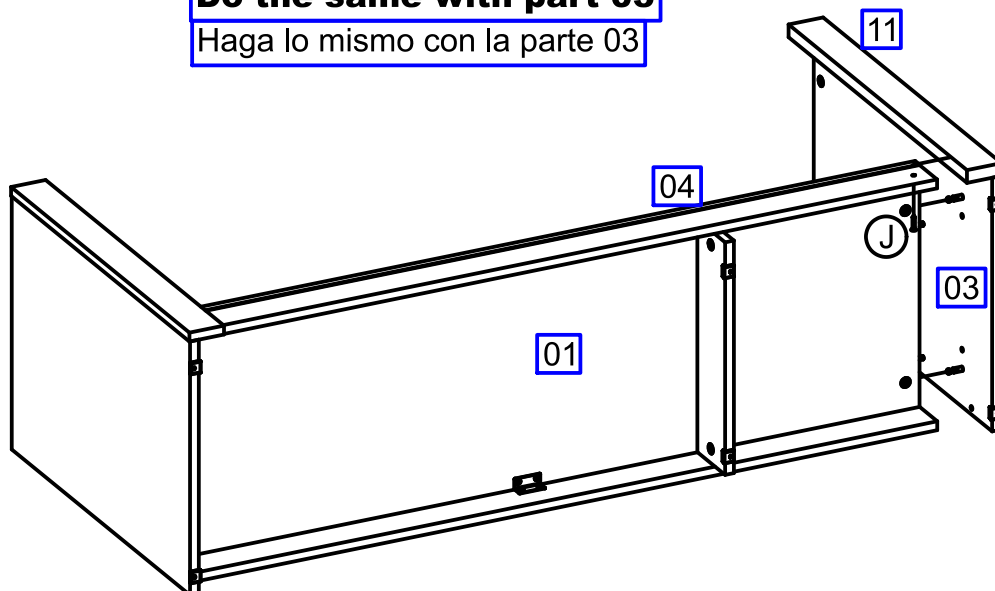

STEP/PASO 14

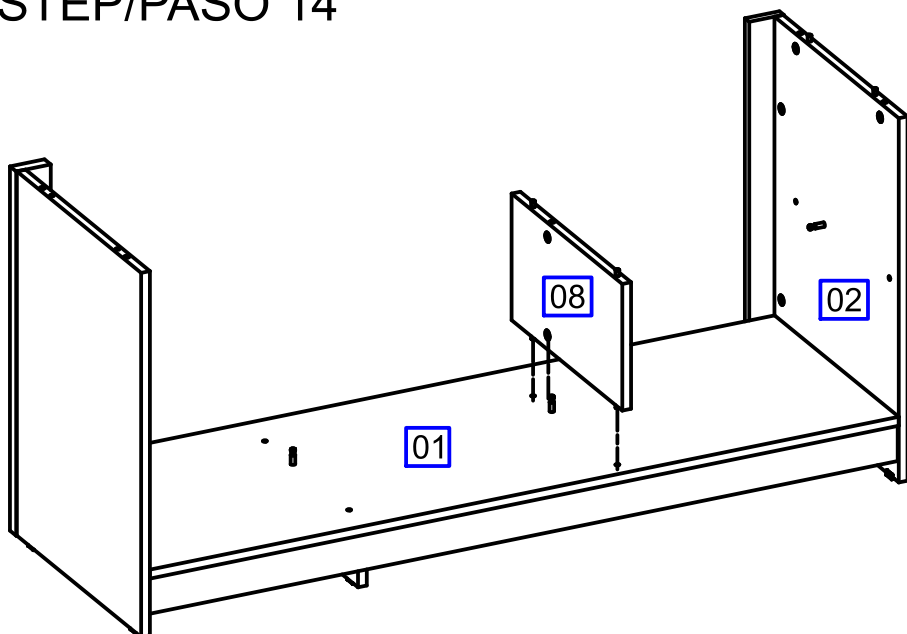

*** Attach part 08 to the part 01 according to the image. Then screw the nuts "C".**

* Enganche pieza 08 en la pieza 01. Atonillar las tuercas "C".

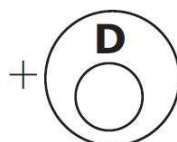
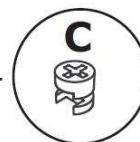
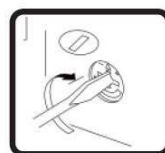
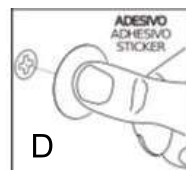

STEP/PASO 15

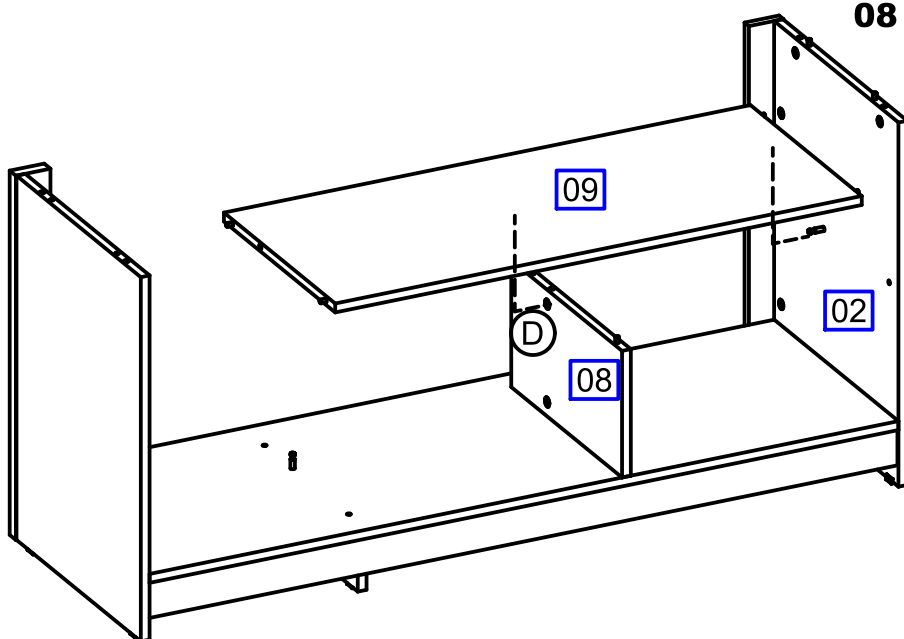

*** Attach part 09 to the part 02 and 08 according to the image. Then screw the nuts "C".**

* Enganche pieza 09 en la pieza 02 y 08. Atonillar las tuercas "C".

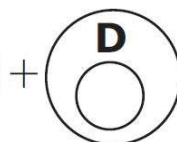
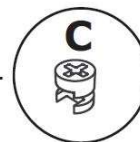
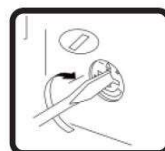

STEP/PASO 16

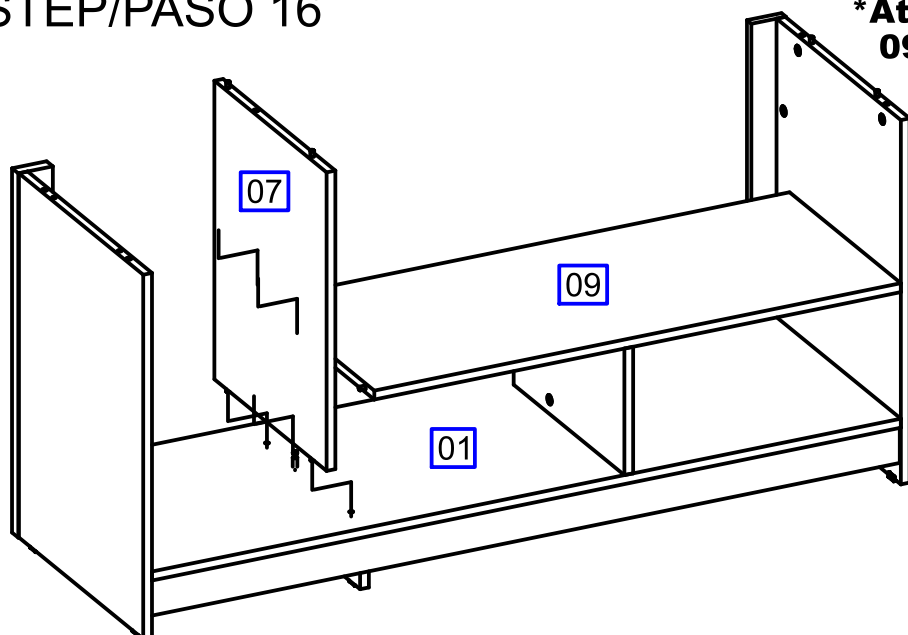

*** Attach part 07 to the part 01 and 09 according to the image. Then screw the nuts "C".**

* Enganche pieza 07 en la pieza 01 y 09. Atonillar las tuercas "C".

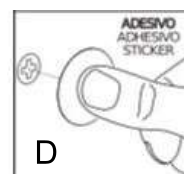
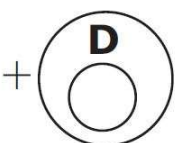
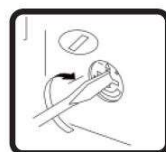

STEP/PASO 17

*** Attach part 12 to the part 11, align the pieces according to the picture and fix it with screw "J".**

* Enganche la pieza 12 en la pieza 11, alinear las piezas de acuerdo con la image. Fijar el tornillo "J".

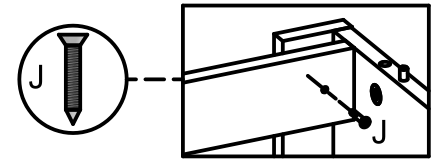
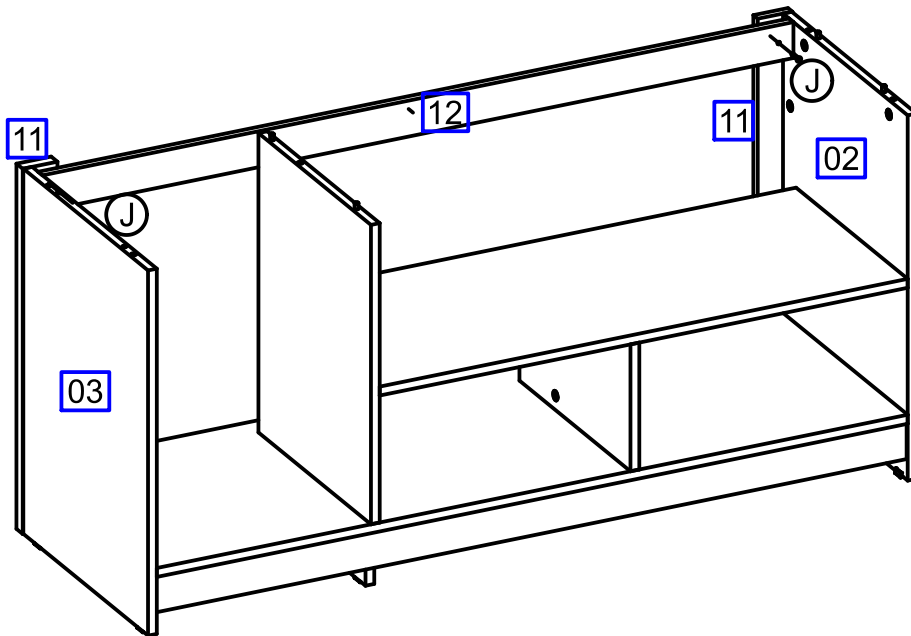

STEP/PASO 18

*** Attach part 10 to the parts 02, 03 and 12 according to the image. Then screw them using "G".**

* Enganche la pieza 10 en las piezas 02, 03 y 12 de acuerdo con la image. Fijar con el tornillo "G".

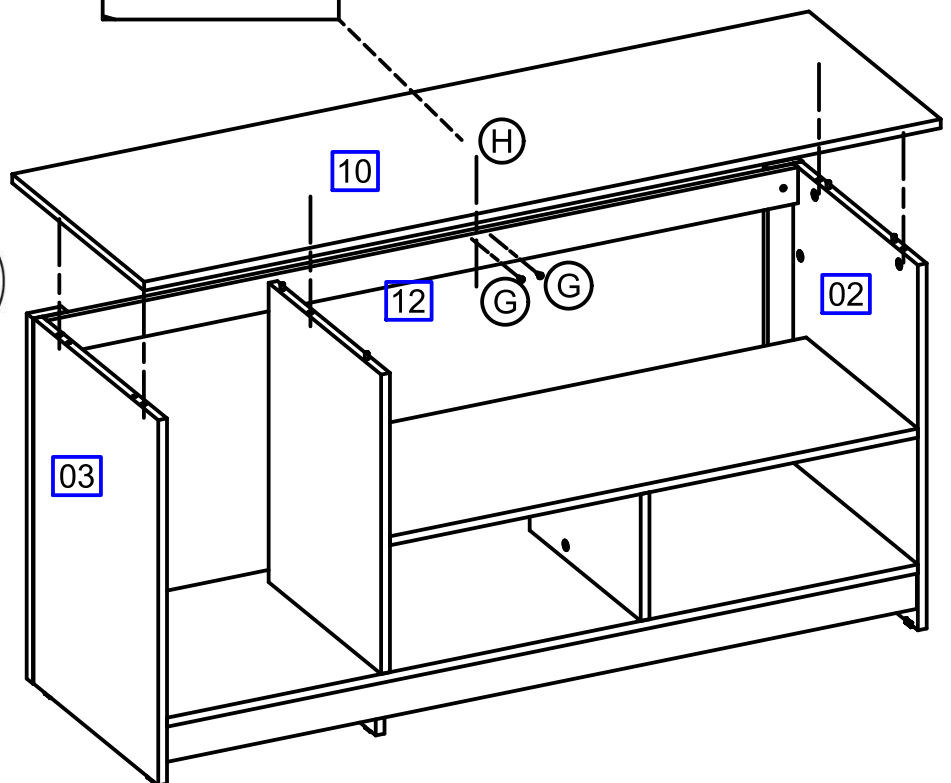
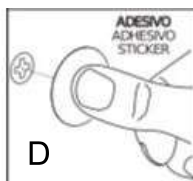
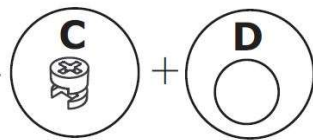
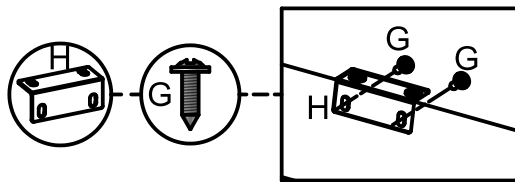

STEP/PASO 19

*** Attach parts 13, 14 and 15 using nail "E" according to the image.**

* Enganche las piezas 13, 14 y 15 usando clavo "E" de acuerdo con la image.

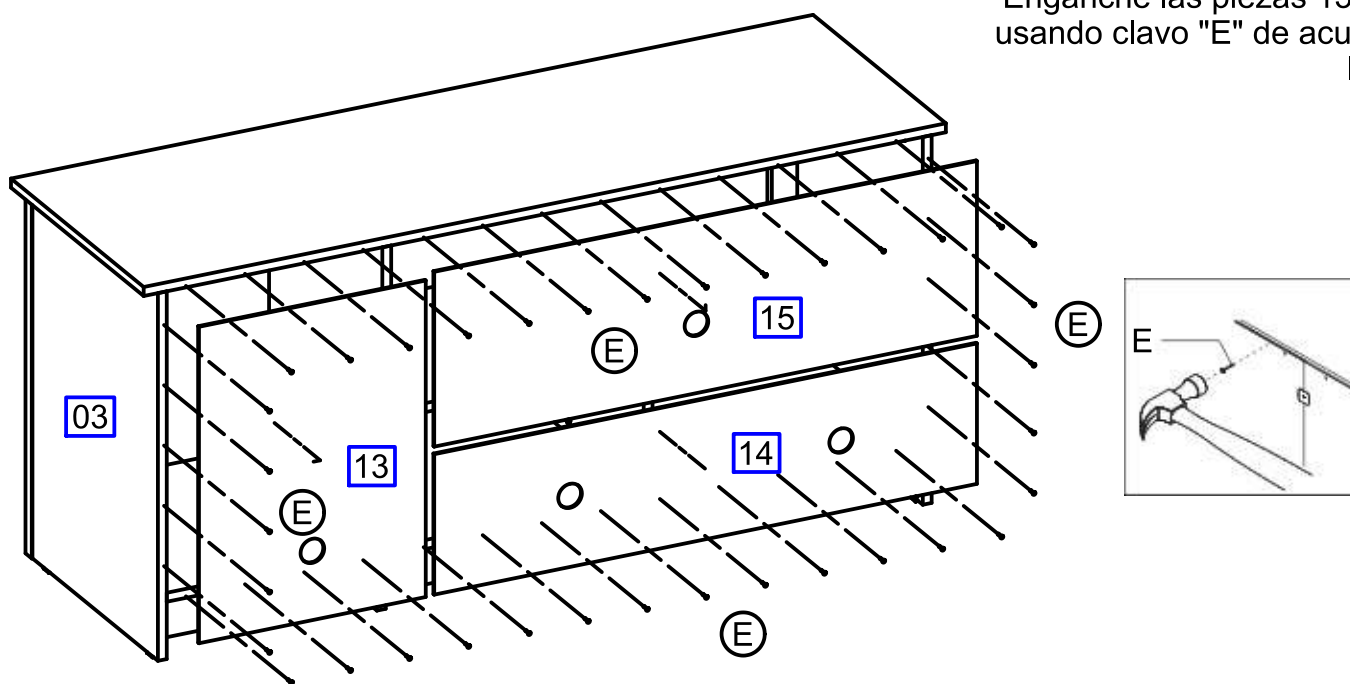

STEP/PASO 20

*** Join parts 13, 14 and 15 using nail "E" + hardware "I" according to the image.**

* Fija las piezas 13, 14 y 15 usando clavo "E" + "I" de acuerdo con la image.

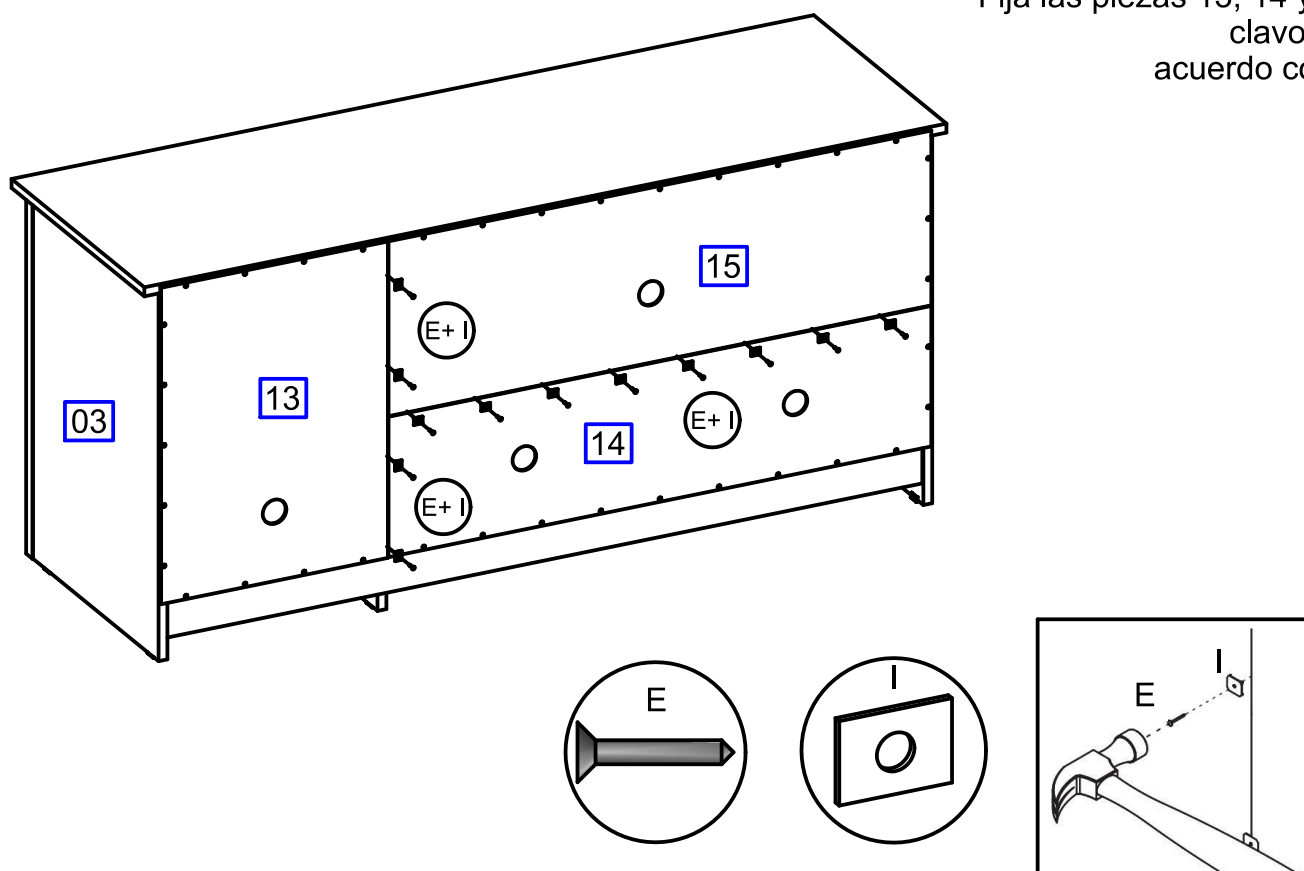

FINAL VIEW / ASPECTO FINAL

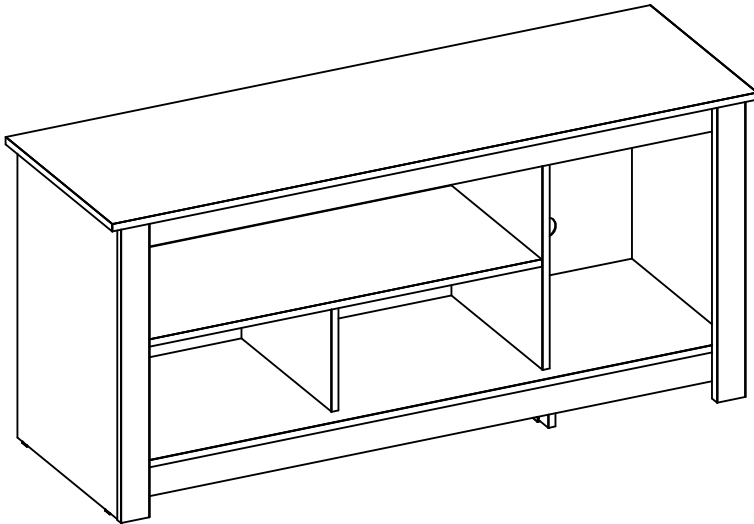

WEIGHT / PESO

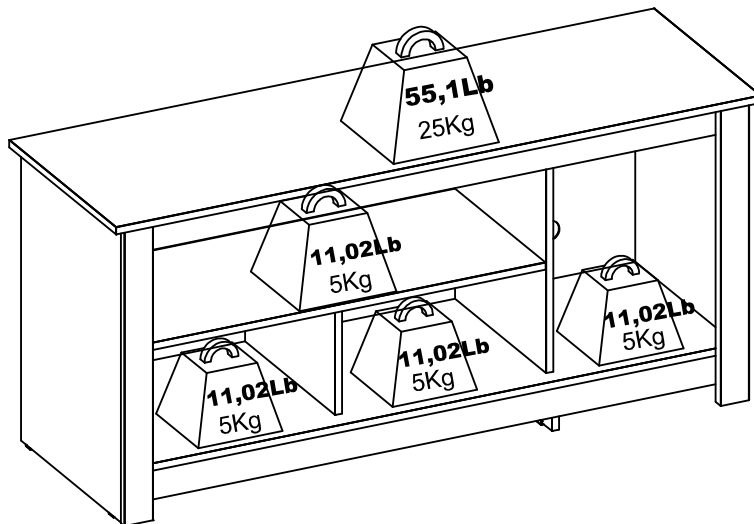

*** Be aware about maximum weights shown in the assembly instruction.**

* Todos los pesos máximos indicados en el manual deben ser respetados.

AVOID ACCIDENTS / PREVENIR ACCIDENTES

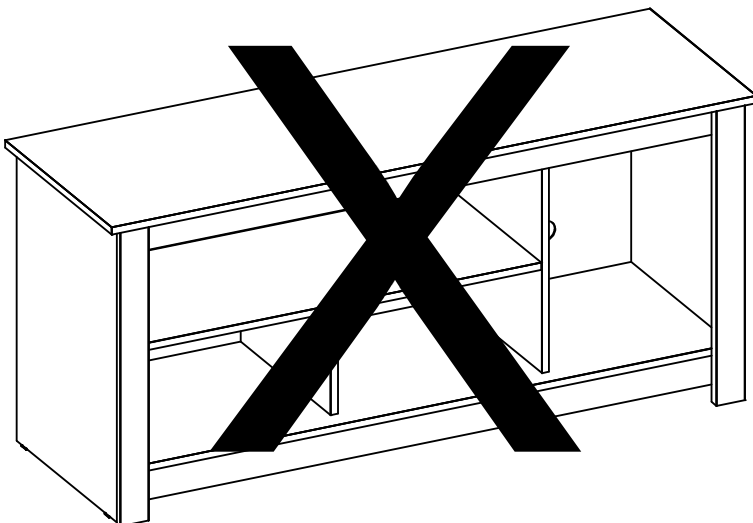

*** Don't climb or lean on the furniture.**

* No se suba ni se apoye en el mueble.

MAINTENANCE AND CLEANING / MANTENIMIENTO Y LIMPIEZA

*** For cleaning use only cloth slightly dampened in water.**

* Para la limpieza utilice sólo un paño húmedo con agua.