



# Speedibin

COMPOSTER

## Assembly Instructions

### SPEEDIBIN CLASSIC

You do not need tools as the wing nuts can be finger tightened onto the bolts. However, if you want to tighten more securely, use a Philips #2 and a crescent wrench. Wear work gloves when handling the sheet metal during assembly.

---

#### Parts List

---

<b>A</b> Lid	<b>F</b> End Bolt	<b>K</b> Right Side Panel
<b>B</b> Handle	<b>G</b> Top Brace	<b>L</b> Ground Staples (4)
<b>C</b> Spacer	<b>H</b> Back Panel	<b>M</b> Screen
<b>D</b> Nut	<b>I</b> Bolts and Wing Nuts (8)	<b>N</b> Bottom Brace
<b>E</b> Cam	<b>J</b> Left Side Panel	<b>O</b> Front Door

#### TIPS

1. Toss in your mix of greens, browns, kitchen scraps, coffee grounds, lawn clippings, leaves, and even shredded paper or cardboard such as the Speedibin packaging material.
2. If you can, in a few days or when it heats up, turn over the compost.
3. Grass clippings heat the pile. If it reaches 60C (140F) most weed seeds are killed.
4. When you have created a rich black loam – in a few weeks or much longer in the winter – use your compost on your garden.
5. Sit back and enjoy the lush growth in your garden!

- LOCATION:** Select a suitable area on the ground, preferably close to the source of your compostable material. The ground must be level so that the screen sits flat. A sunny location may slightly speed the composting but may also necessitate watering. It needs to be on earth or grass. Worms and microorganisms cannot get through concrete!
- Identify all the pieces. **Figure 1**

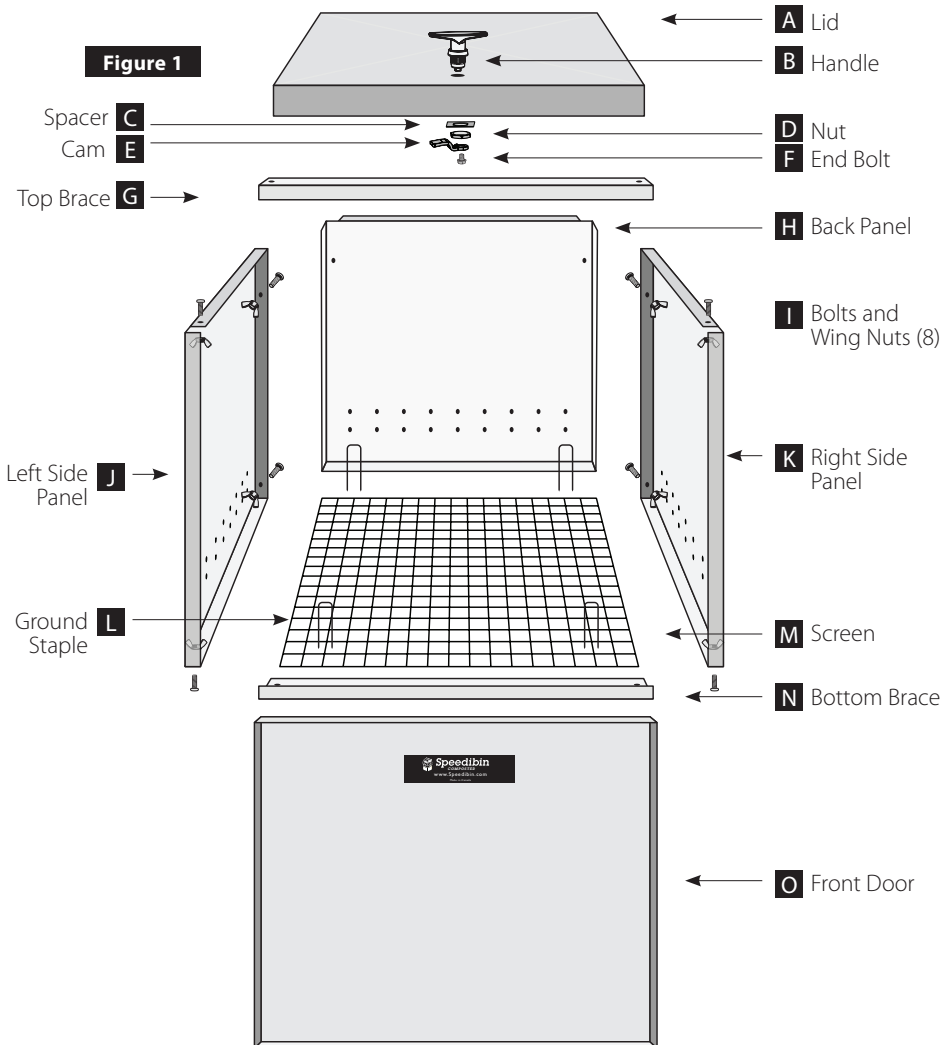

3. **SIDES:** Attach a side panel to the back panel by lining up the matching pre-drilled holes. Push a bolt through one. Green sides out, gray sides in. Fasten by tightening the wing nut onto the bolt. Finger tight is good. **Figure 2.** It is a little easier to do the upper bolt first. Then bolt together the bottom hole. Bolt together the other side to the back panel. **Figure 3.**

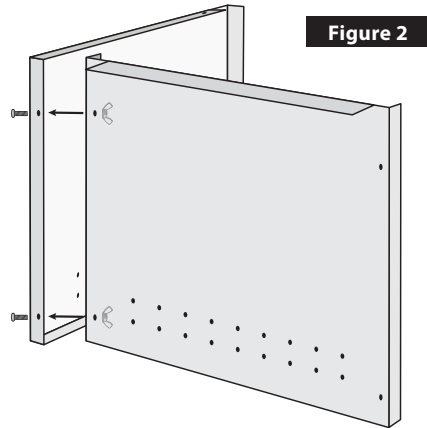
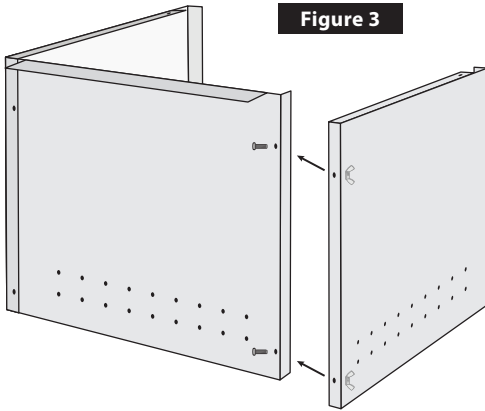

4. **BRACES:** Attach the top and bottom braces to the side panels by pushing a bolt through the pre-drilled holes and fastening with a wing nut. It is a little easier to do the top brace first. **Figure 4.**

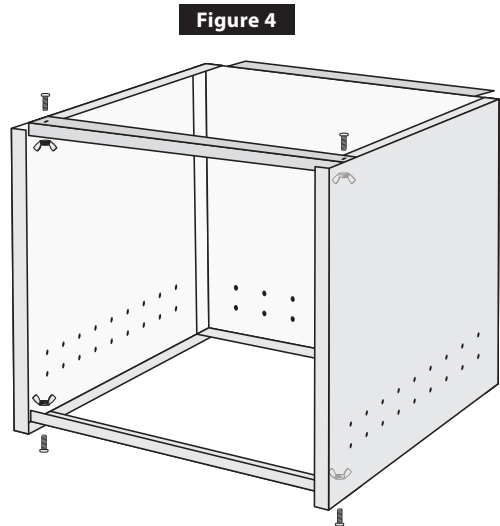

5. **SCREEN:** Place the screen on the floor of the bin.

6. **DOOR:** Slide the front door into the slot you have made in front of the braces. **Figure 5.**

**Figure 5**

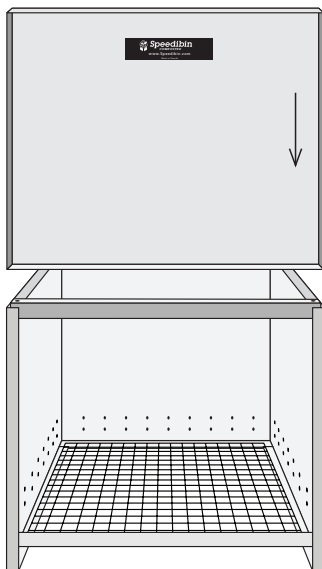

7. **HANDLE INSTALLATION:**  
**Figure 6**

- Remove end bolt and nut.
- Place the handle through the mounting hole of the lid.
- Place square spacer plate on the handle shaft.
- Tighten nut onto handle.
- Put the cam onto the shaft so that the raised notch slots into the groove on the shaft.
- Insert the end bolt and tighten.
- Ensure that the cam turns the correct direction to catch the top brace.

**Figure 6**

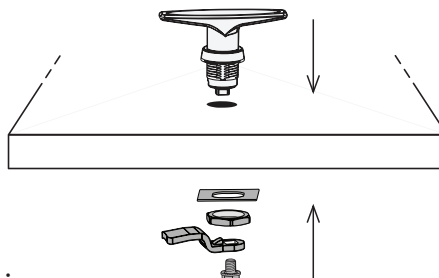

8. **LID:** Put the lid onto the Speedibin. Ensure that the lid's back tab tucks under the tab on the back panel. Twist the handle to lock out raccoons.

9. **GROUND STAPLES:** Secure the screen flat onto the ground by pushing a ground staple through the screen in each corner. **Figure 7.**

**Figure 7**

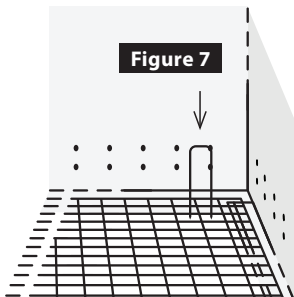

10. Done! **Figure 8.**

**Figure 8**

