

4

3

2

1

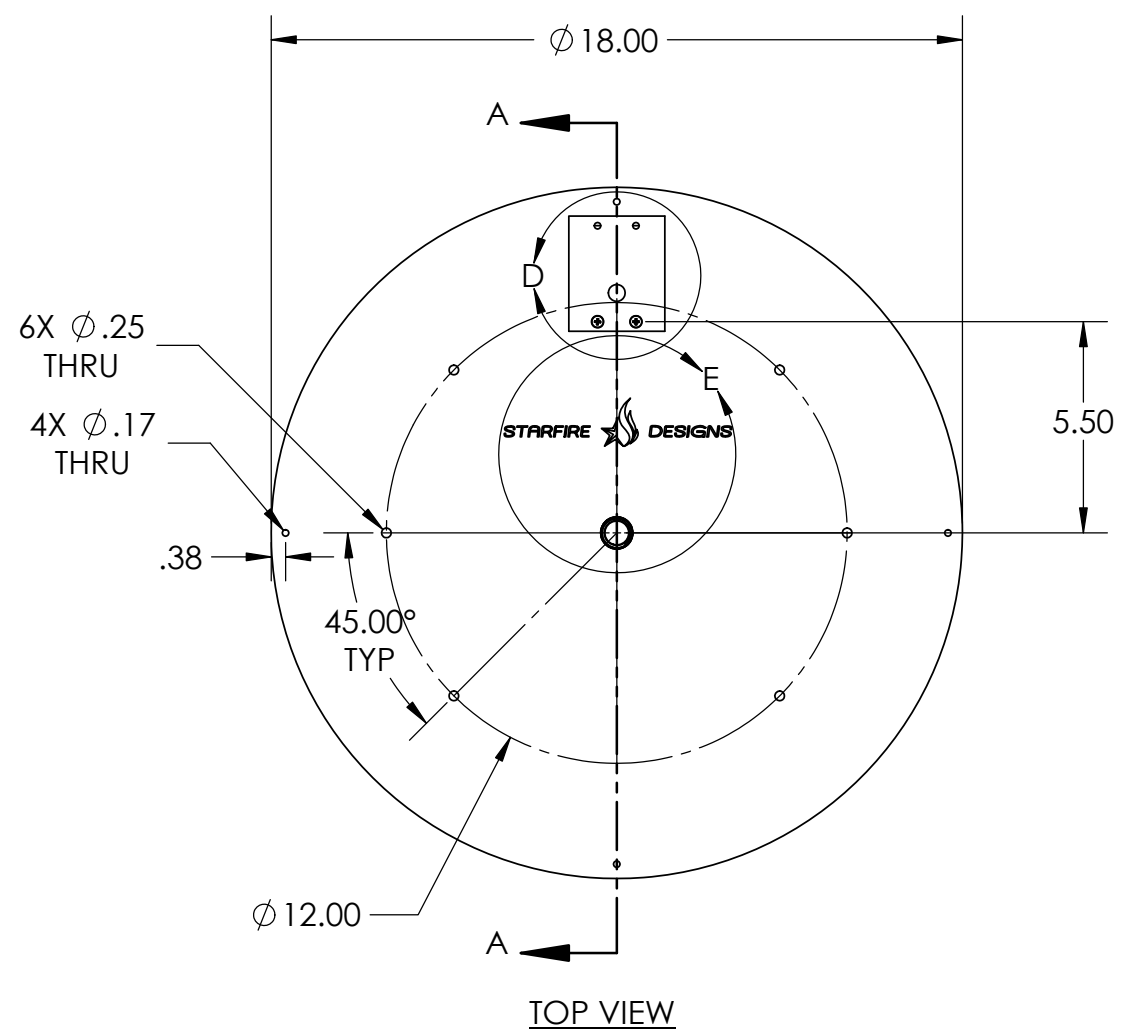

TOP VIEW

LASER ETCH LOGO AS SHOWN

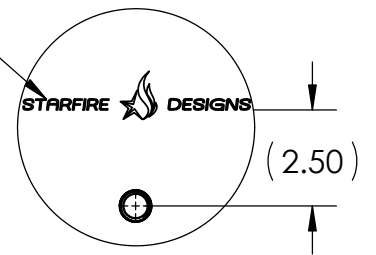

DETAIL E SCALE 1 : 5

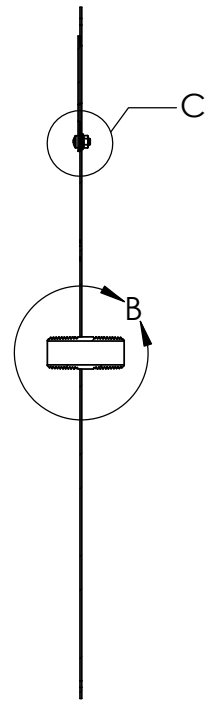

SECTION A-A

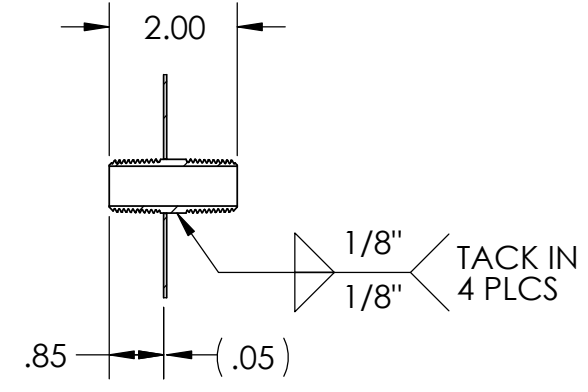

DETAIL B SCALE 1 : 3

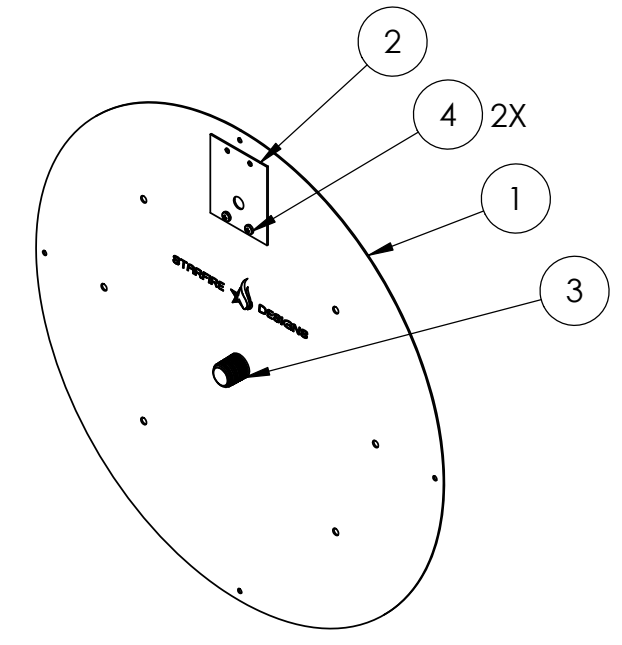

ISOMETRIC VIEW

NOTES:

- 1. ALL DIMENSIONS ARE IN INCHES UNLESS OTHERWISE SPECIFIED.
- 2. MATERIAL: 304SS
- 3. UNIT WEIGHT: ____ LBS

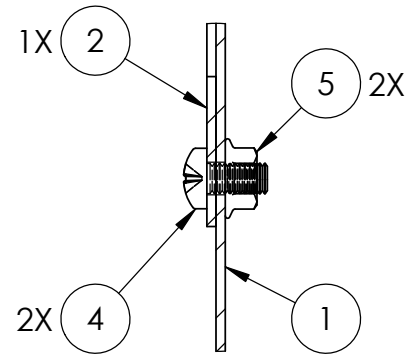

DETAIL C SCALE 1 : 1

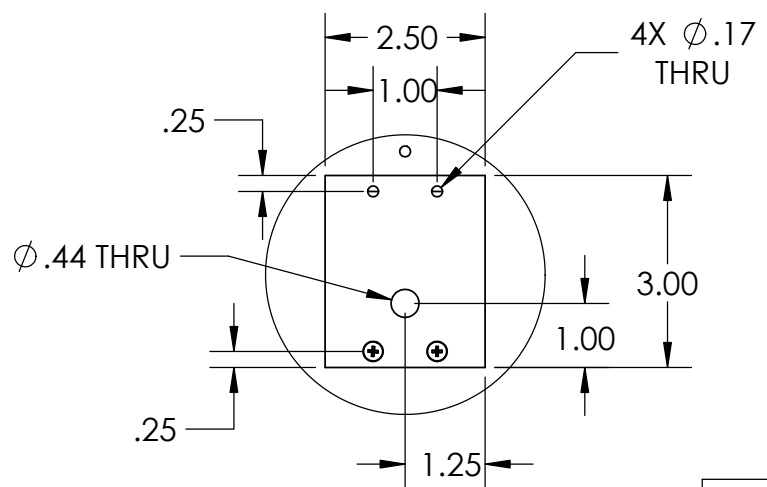

DETAIL D SCALE 1 : 3

ITEM NO.	QTY.	PART NUMBER	DESCRIPTION
5	2	-	M4 HEX FLANGE NUT
4	2	-	M4 PAN HD SCREW, 8MM LONG
3	1	-	SS THRD PIPE NIPPLE, 1/2 NPT X 2" LONG
2	1	PAN-RND-IGN-CVR	IGNITION COVER PLATE
1	1	PAN-RND-18	18" DIAMETER SS PAN

PROPRIETARY AND CONFIDENTIAL
 THE INFORMATION CONTAINED IN THIS DRAWING IS THE SOLE PROPERTY OF STARFIRE DIRECT. ANY REPRODUCTION IN PART OR AS A WHOLE WITHOUT THE WRITTEN PERMISSION OF STARFIRE DIRECT IS PROHIBITED.

UNLESS OTHERWISE SPECIFIED:		NAME	DATE	TITLE:
DIMENSIONS ARE IN INCHES		DRAWN		ROUND BURNER PAN - ϕ 18" OD
TOLERANCES:		CHECKED		
FRACTIONAL \pm 1/8"		ENG APPR.		
ANGULAR: MACH \pm BEND \pm		MFG APPR.		
TWO PLACE DECIMAL \pm		Q.A.		SIZE B
THREE PLACE DECIMAL \pm		STARFIRE DESIGNS		DWG. NO. PAN-FP-RND-18
INTERPRET GEOMETRIC TOLERANCING PER:				REV A
MATERIAL				SCALE: 1:5
FINISH				WEIGHT:
NEXT ASSY	USED ON			SHEET 1 OF 1
APPLICATION		DO NOT SCALE DRAWING		

4

3

2

1

4

3

2

1

B

B

A

A

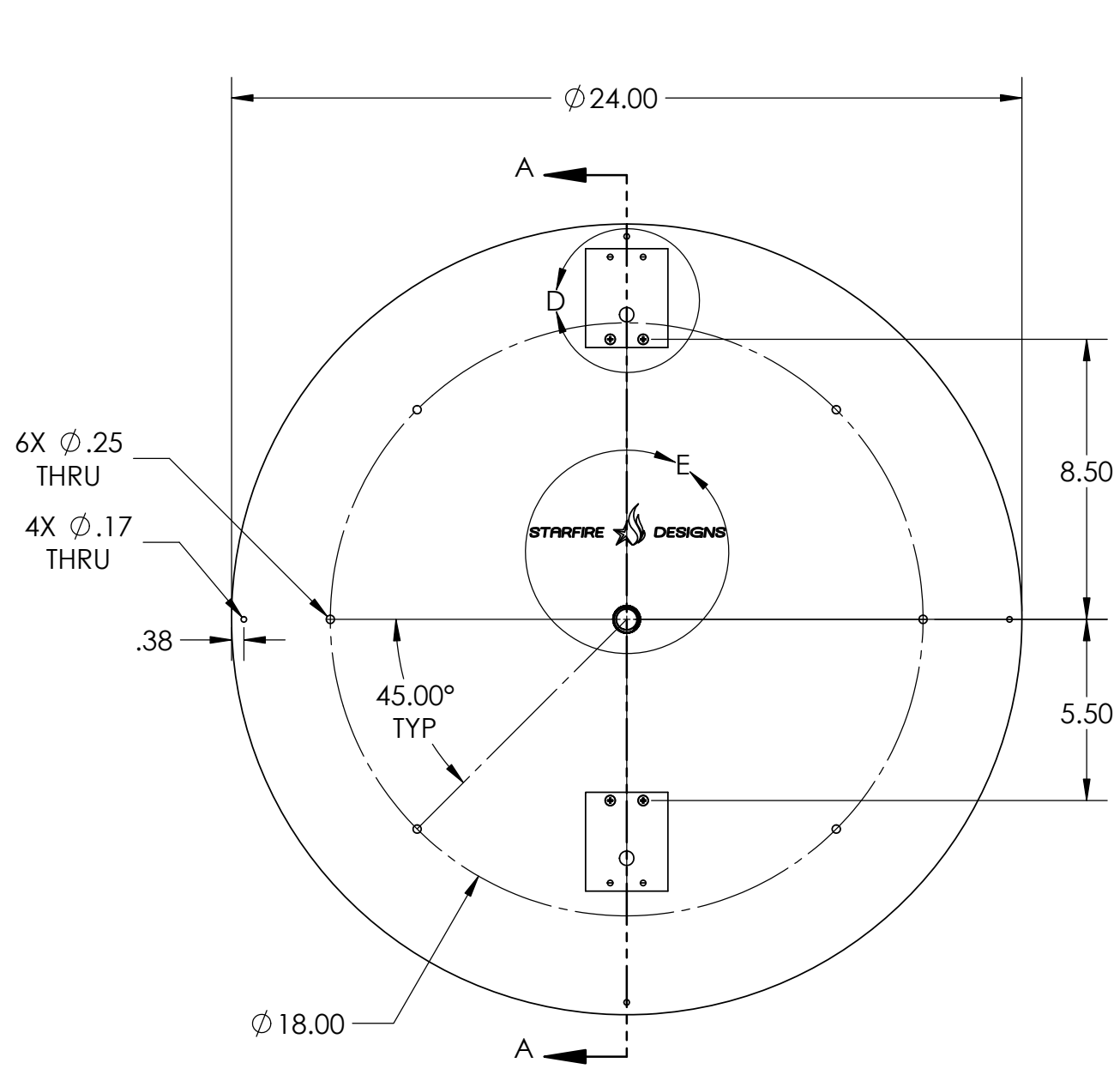

TOP VIEW

LASER ETCH LOGO AS SHOWN

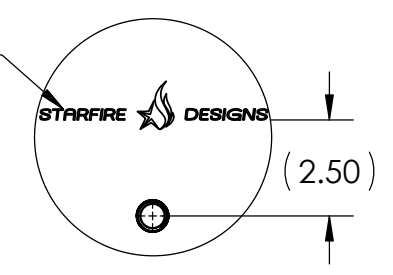

DETAIL E SCALE 1 : 5

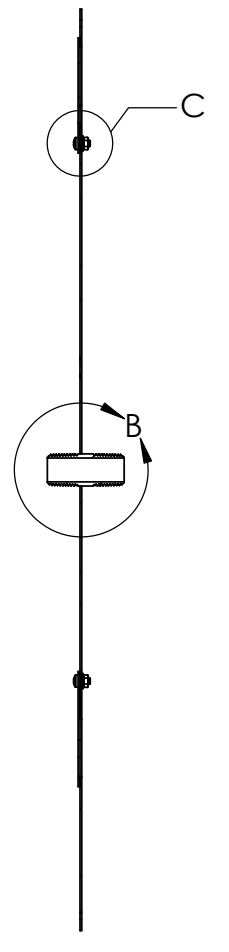

SECTION A-A

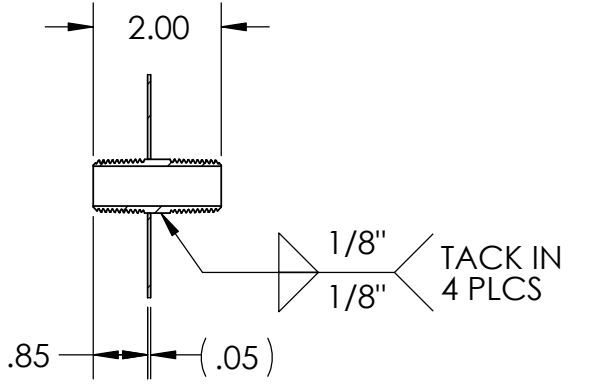

DETAIL B SCALE 1 : 3

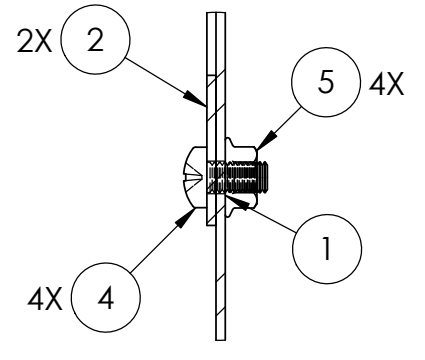

DETAIL C SCALE 1 : 1

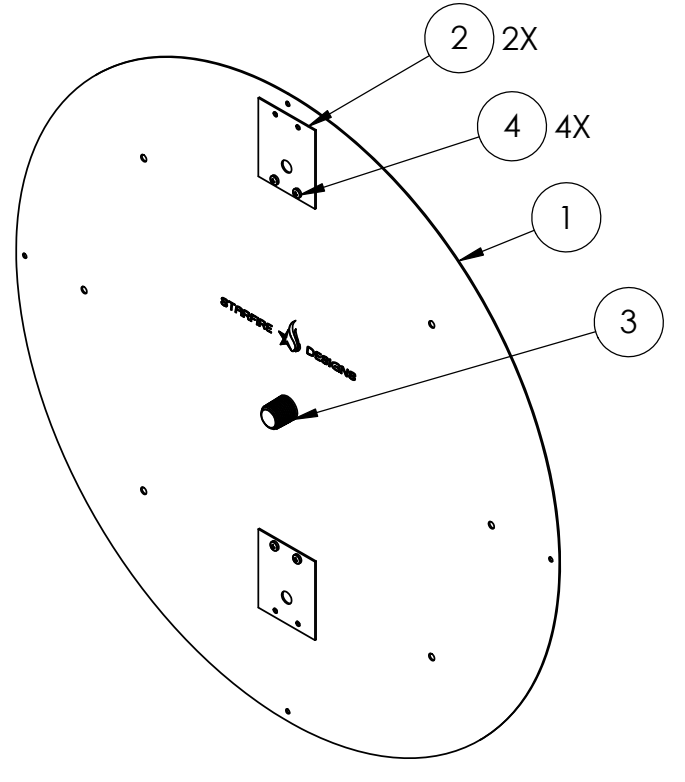

ISOMETRIC VIEW

NOTES:

- 1. ALL DIMENSIONS ARE IN INCHES UNLESS OTHERWISE SPECIFIED.
- 2. MATERIAL: 304SS
- 3. UNIT WEIGHT: ____ LBS

ITEM NO.	QTY.	PART NUMBER	DESCRIPTION
5	4	-	M4 HEX FLANGE NUT
4	4	-	M4 PAN HD SCREW, 8MM LONG
3	1	-	SS THRD PIPE NIPPLE, 1/2 NPT X 2" LONG
2	2	PAN-RND-IGN-CVR	IGNITION COVER PLATE
1	1	PAN-RND-24	24" DIAMETER SS PAN

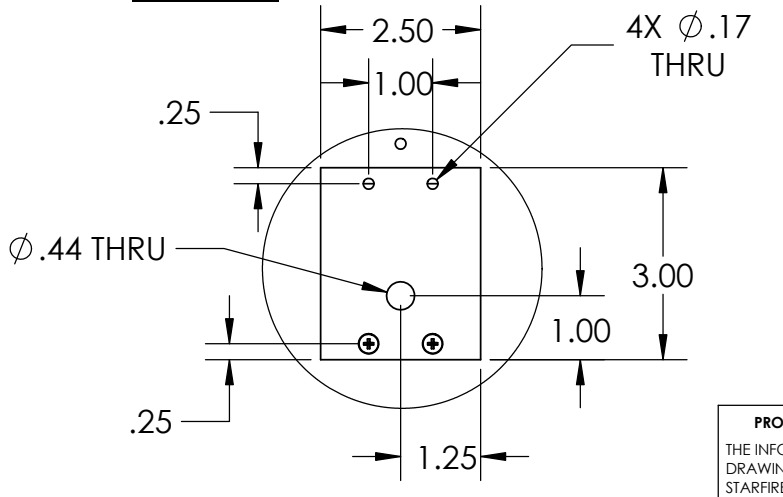

DETAIL D SCALE 1 : 3

PROPRIETARY AND CONFIDENTIAL
 THE INFORMATION CONTAINED IN THIS DRAWING IS THE SOLE PROPERTY OF STARFIRE DIRECT. ANY REPRODUCTION IN PART OR AS A WHOLE WITHOUT THE WRITTEN PERMISSION OF STARFIRE DIRECT IS PROHIBITED.

UNLESS OTHERWISE SPECIFIED:		NAME	DATE	TITLE:
DIMENSIONS ARE IN INCHES		DRAWN		ROUND BURNER PAN - 24" OD
TOLERANCES:		CHECKED		
FRACTIONAL: ± 1/8"		ENG APPR.		
ANGULAR: MACH ± BEND ±		MFG APPR.		
TWO PLACE DECIMAL ±		Q.A.		SIZE B DWG. NO. PAN-FP-RND-24 REV A
THREE PLACE DECIMAL ±		STARFIRE DESIGNS		SCALE: 1:5 WEIGHT: SHEET 1 OF 1
INTERPRET GEOMETRIC TOLERANCING PER:	MATERIAL			
FINISH				
NEXT ASSY	USED ON			
APPLICATION	DO NOT SCALE DRAWING			

4

3

2

1

B

B

A

A

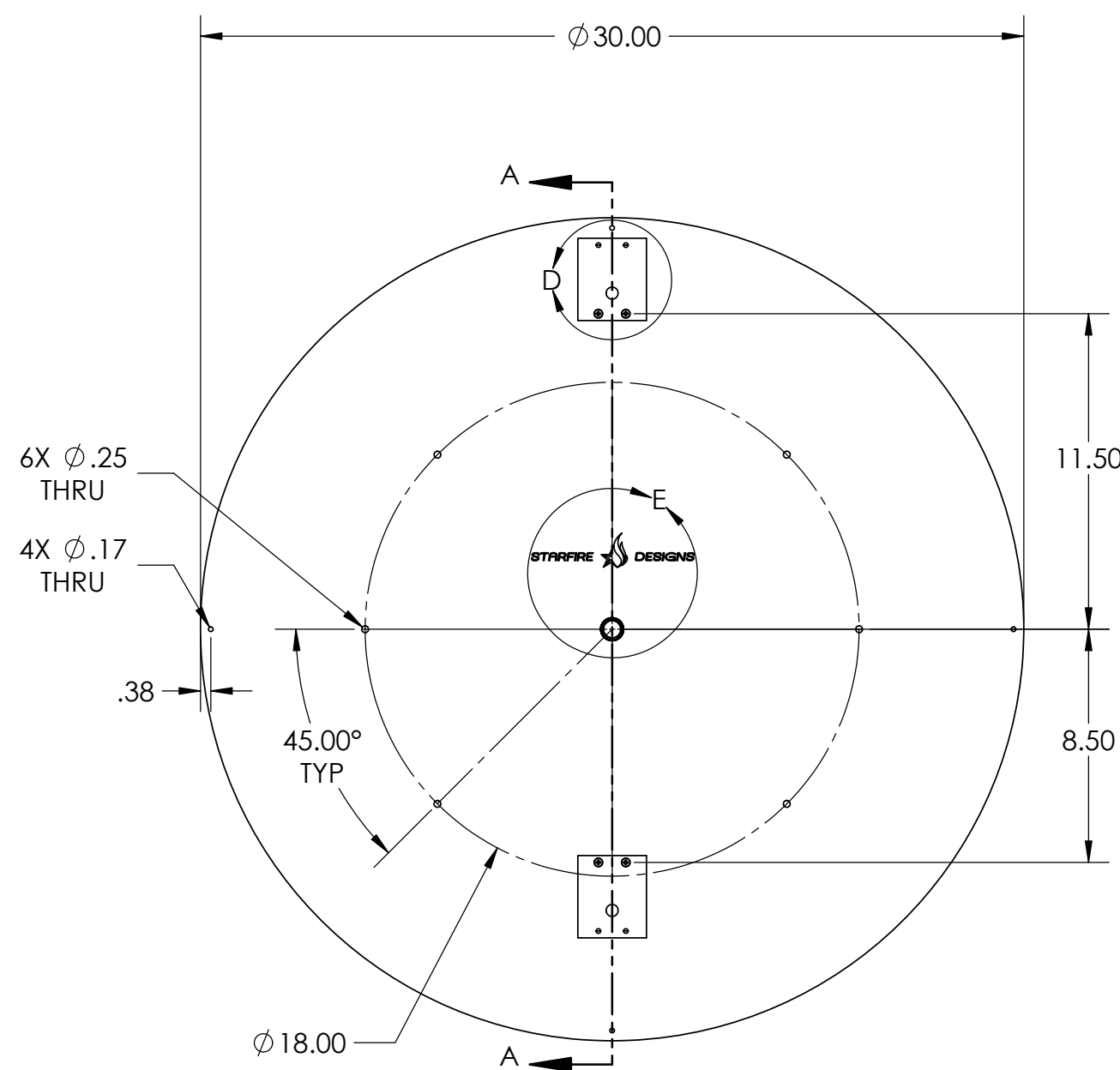

LASER ETCH LOGO AS SHOWN

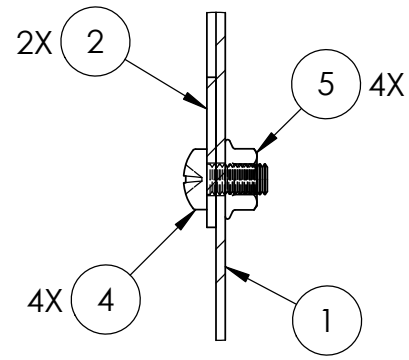
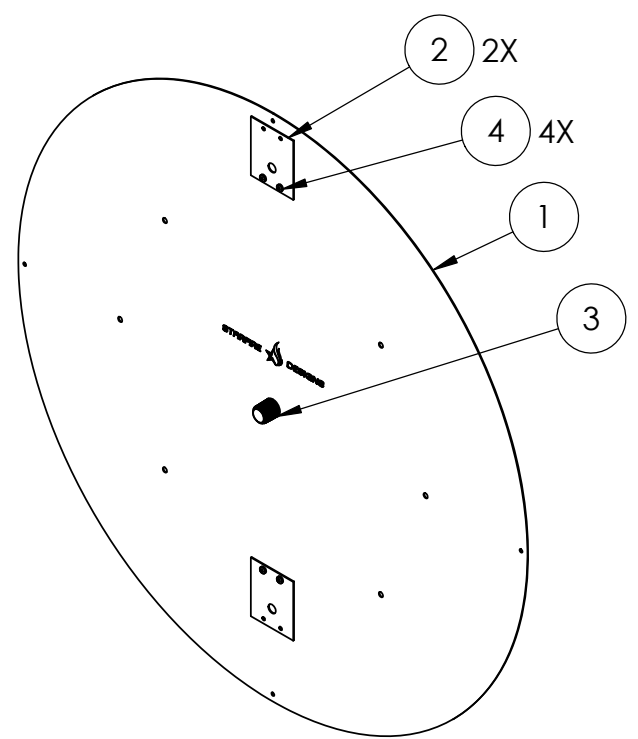
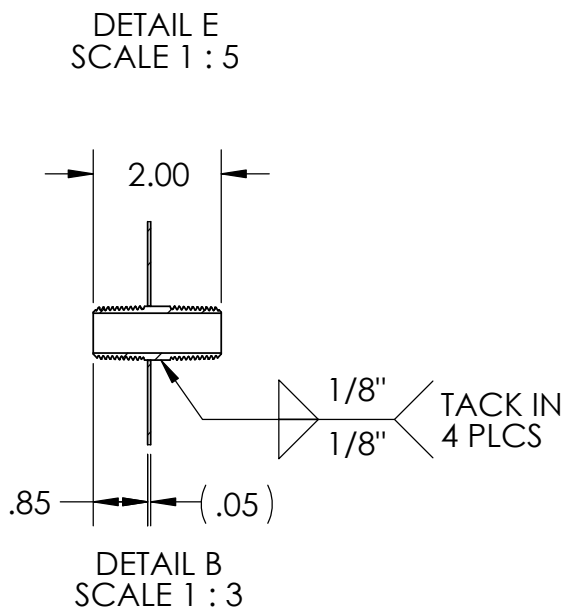
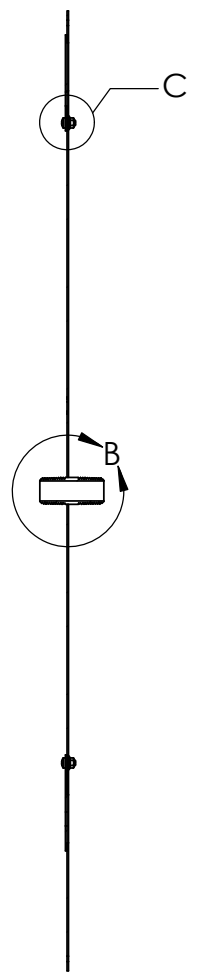
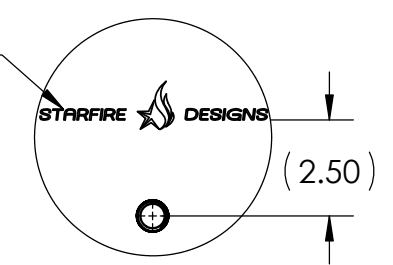

NOTES:

- ALL DIMENSIONS ARE IN INCHES UNLESS OTHERWISE SPECIFIED.
- MATERIAL: 304SS
- UNIT WEIGHT: ____ LBS

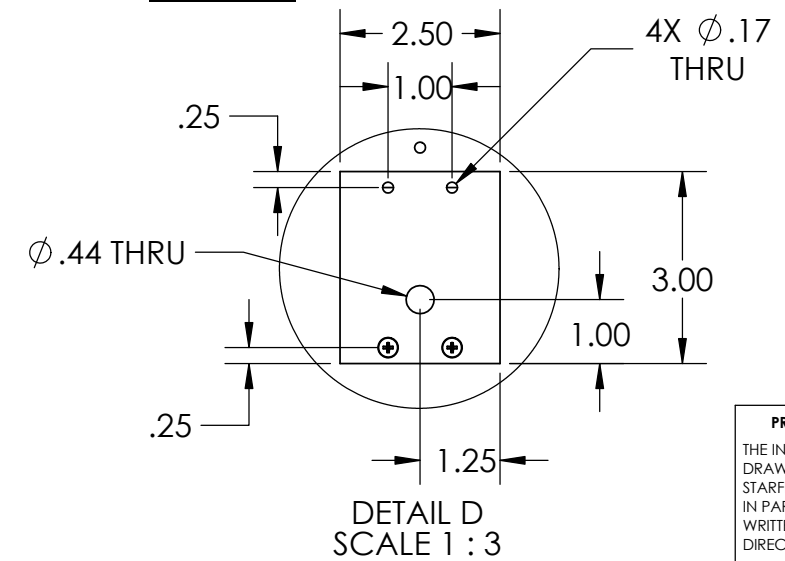

PROPRIETARY AND CONFIDENTIAL
THE INFORMATION CONTAINED IN THIS DRAWING IS THE SOLE PROPERTY OF STARFIRE DIRECT. ANY REPRODUCTION IN PART OR AS A WHOLE WITHOUT THE WRITTEN PERMISSION OF STARFIRE DIRECT IS PROHIBITED.

ITEM NO.	QTY.	PART NUMBER	DESCRIPTION
5	4	-	M4 HEX FLANGE NUT
4	4	-	M4 PAN HD SCREW, 8MM LONG
3	1	-	SS THRD PIPE NIPPLE, 1/2 NPT X 2" LONG
2	2	PAN-RND-IGN-CVR	IGNITION COVER PLATE
1	1	PAN-RND-30	30" DIAMETER SS PAN

UNLESS OTHERWISE SPECIFIED:		NAME	DATE	TITLE:
DIMENSIONS ARE IN INCHES TOLERANCES: FRACTIONAL: ± 1/8" ANGULAR: MACH ± BEND ± TWO PLACE DECIMAL ± THREE PLACE DECIMAL ±		DRAWN		ROUND BURNER PAN - Ø 30" OD
INTERPRET GEOMETRIC TOLERANCING PER:		CHECKED		
MATERIAL		ENG APPR.		
FINISH		MFG APPR.		
NEXT ASSY	USED ON	Q.A.		SIZE B
APPLICATION		DO NOT SCALE DRAWING		DWG. NO. PAN-FP-RND-30
				REV B
				SCALE: 1:6
				WEIGHT:
				SHEET 1 OF 1

4

3

2

1

4

3

2

1

B

B

A

A

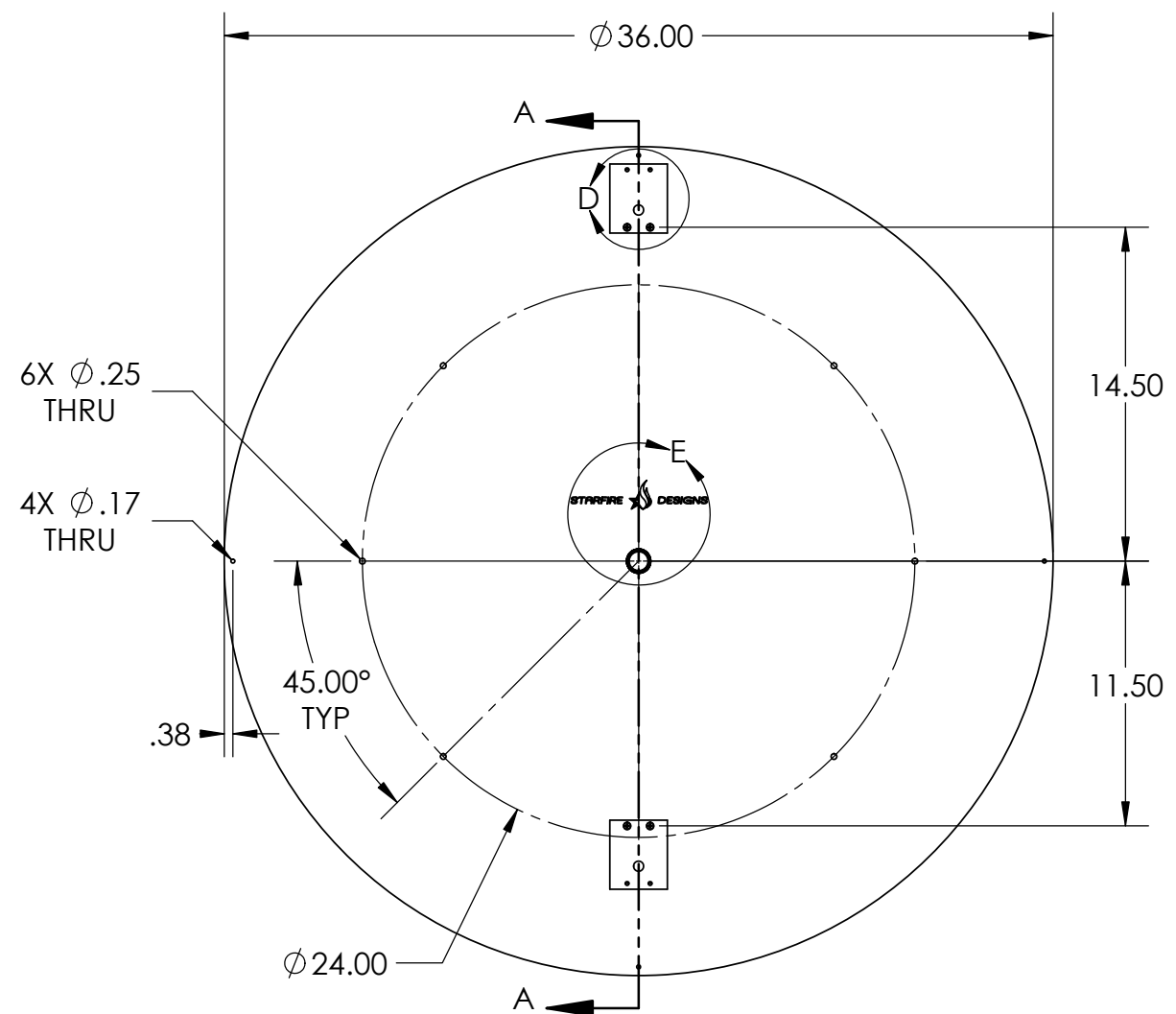

TOP VIEW

LASER ETCH LOGO AS SHOWN

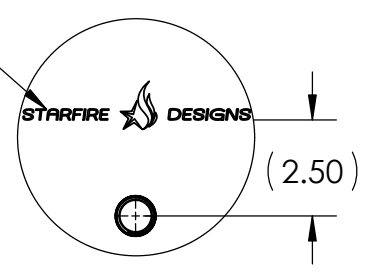

DETAIL E SCALE 1 : 5

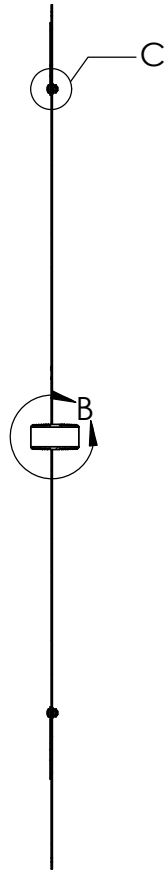

SECTION A-A

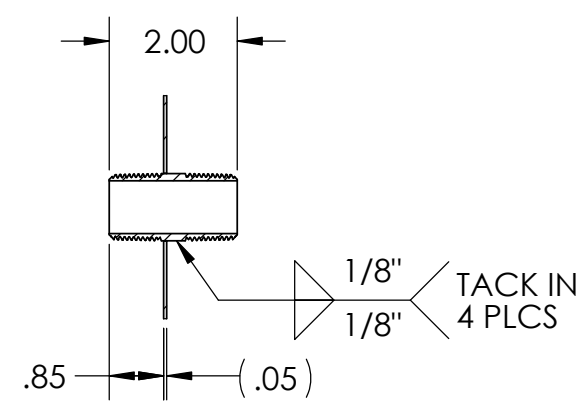

DETAIL B SCALE 1 : 3

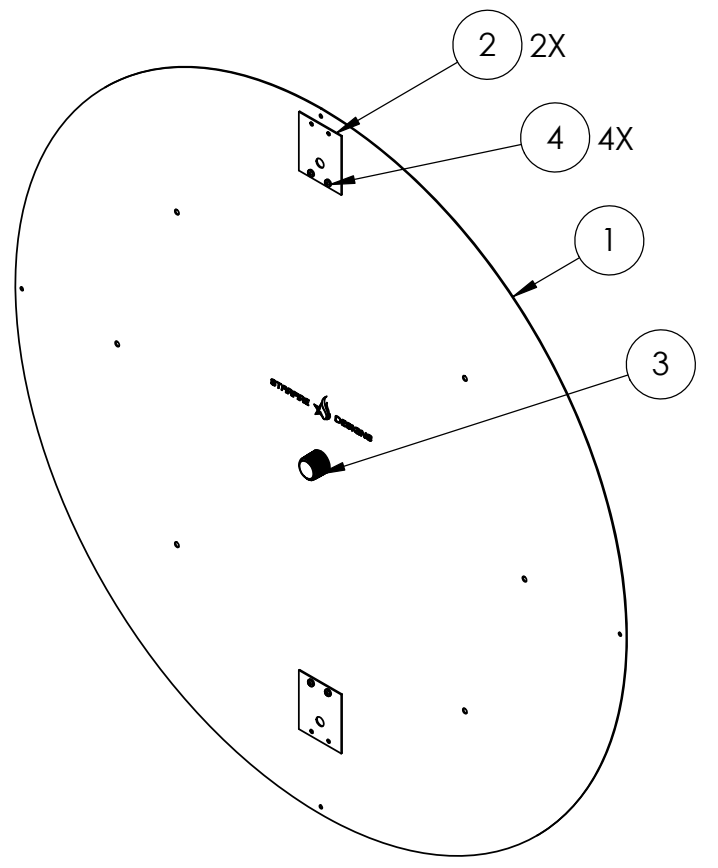

ISOMETRIC VIEW

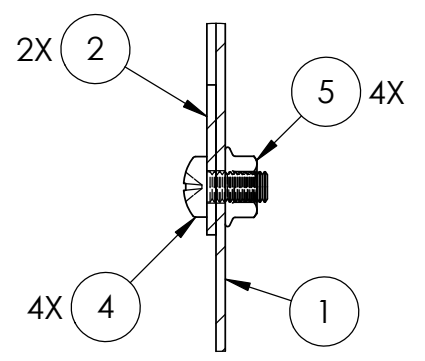

DETAIL C SCALE 1 : 1

NOTES:

1. ALL DIMENSIONS ARE IN INCHES UNLESS OTHERWISE SPECIFIED.
2. MATERIAL: 304SS
3. UNIT WEIGHT: ____ LBS

ITEM NO.	QTY.	PART NUMBER	DESCRIPTION
5	4	-	M4 HEX FLANGE NUT
4	4	-	M4 PAN HD SCREW, 8MM LONG
3	1	-	SS THRD PIPE NIPPLE, 3/4 NPT X 2" LONG
2	2	PAN-RND-IGN-CVR	IGNITION COVER PLATE
1	1	PAN-RND-36	36" DIAMETER SS PAN

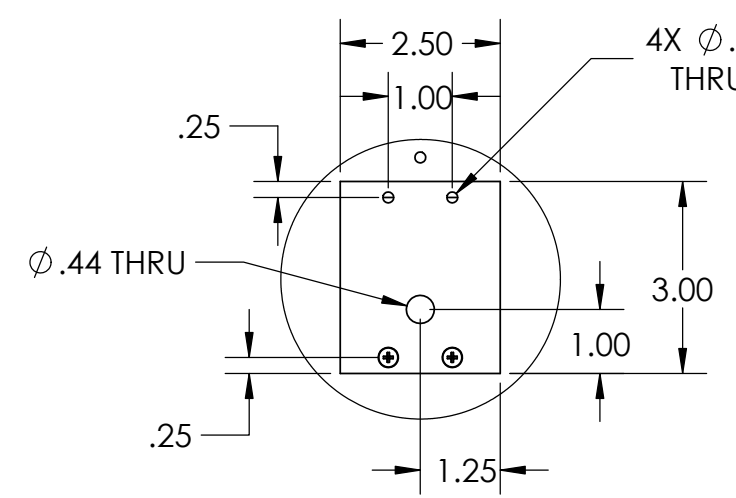

DETAIL D SCALE 1 : 3

PROPRIETARY AND CONFIDENTIAL
 THE INFORMATION CONTAINED IN THIS DRAWING IS THE SOLE PROPERTY OF STARFIRE DIRECT. ANY REPRODUCTION IN PART OR AS A WHOLE WITHOUT THE WRITTEN PERMISSION OF STARFIRE DIRECT IS PROHIBITED.

UNLESS OTHERWISE SPECIFIED:		NAME	DATE	TITLE:
DIMENSIONS ARE IN INCHES		DRAWN		ROUND BURNER PAN - 36" OD
TOLERANCES:		CHECKED		
FRACTIONAL: ± 1/8"		ENG APPR.		
ANGULAR: MACH ± BEND ±		MFG APPR.		
TWO PLACE DECIMAL ±		Q.A.		SIZE B DWG. NO. PAN-FP-RND-36 REV A
THREE PLACE DECIMAL ±		STARFIRE DESIGNS		SCALE: 1:8 WEIGHT: SHEET 1 OF 1
INTERPRET GEOMETRIC TOLERANCING PER:	MATERIAL			
FINISH				
NEXT ASSY	USED ON			
APPLICATION	DO NOT SCALE DRAWING			