

Ductile Cast Iron Grating 8" (Mesh)

Primary Usage

Reference No.

Sign and date

Copy inv. No.

Repl. Inv. No.

Sign and date

Orig. Inv. No.

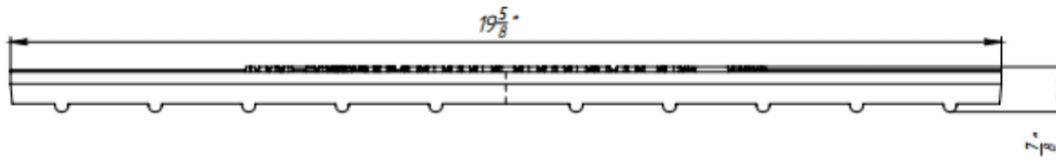
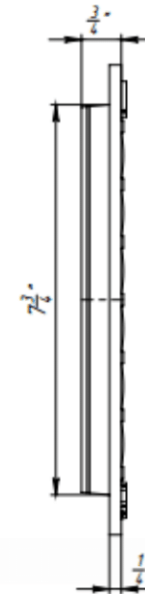
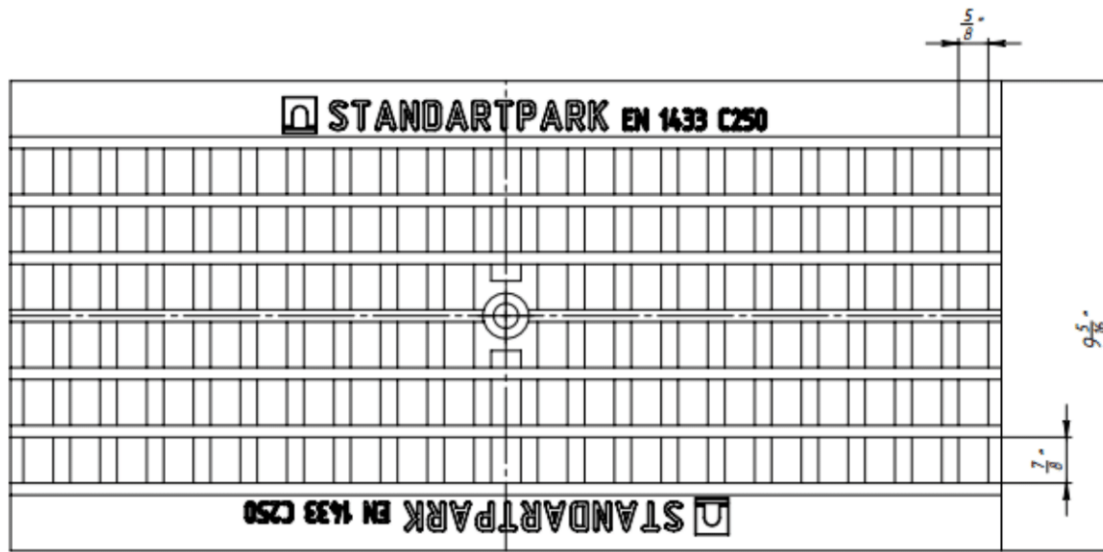

- 1 Area of water intake slats 66,7 sq in
- 2 Deviation of the actual weight of the nominal can be up to 10%

				Ductile Cast Iron Grating 8" (Mesh)			Art.	25403
Rev.	Sheet	Doc. No.	Sign.	Date	Let.	Weight (lb)	Scale	
				04.08.18		14.54	1:2.5	
					NP-DG 25403			
					Load Classes A-C			
					Sheet	Sheets 1		
					Ductile Cast Iron (powder painting)			