

Sensor Installation

Positioning Sensors

Install each sensor halfway between the side and the center of the vehicle.

For optimal performance, sensors need to be facing straight forward not at an angle. Make sure that each sensor is parallel with the road (using supplied bubble level).

Note

Vehicle must be positioned on a flat surface in order to position sensors parallel with the road. Make sure that sensors have an unobstructed "view" of the road so the unit can function properly. Do not install sensors behind a solid surface, which would block laser transmission/reception.

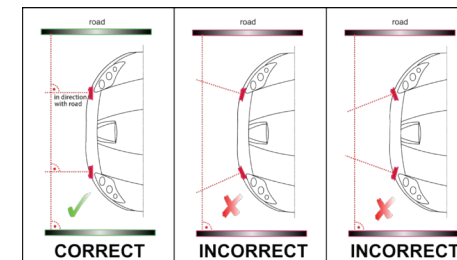
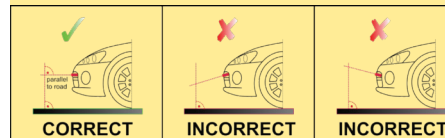

7

Sensor Installation (continued)

1 Snap mounting bracket onto sensor and install the included bolts but do not tighten them. If the bolts do not thread into the sensor then you have the bracket on backwards.

2 Apply the double sided tape to the underside of the sensor's mounting bracket. Check front alignment and mount the sensor to a solid surface of the vehicle.

3 Use the supplied bubble level to ensure the sensor is parallel to the road and tighten the sensor's mounting bracket bolts.

4 Repeat for additional sensor.

Securing Connectors with Shrink Tube

Once you've installed all components properly and tested to ensure all parts are working properly, use cable ties to fasten sensor cables to a solid surface, keeping them away from heat and any moving parts. It is advisable to use the supplied heat shrink tubes to protect connectors against water, moisture, dust, etc.

ZW5 SmartCord Installation

ZW5 SmartCord



If your ZW5 includes a coiled ZW5 SmartCord then replace your detector's power cord with the ZW5 SmartCord.

ZW5 Direct Wire SmartCord

If your ZW5 includes a direct wire ZW5 SmartCord then:

1 Attach the lug on the cord's black wire (-) to any grounded screw under your vehicle's dash

2 Position the provided blue 3M connector around an existing switched (powers on and off with ignition) 12 Volt wire

3 Squeeze the connector with pliers until the halves snap together

4 Plug the insulated male spade lug on the red striped wire into the 3M connector, ensuring the insulator completely covers the connector

5 Use the mounting tape and zip ties to secure any loose/dangling wires

8

Warranty

ESCORT One Year Limited Warranty

What this warranty covers: Escort, Inc. ("Escort") warrants your Product against all defects in materials and workmanship.

For how long: One (1) year from the date of original purchase from an authorized Escort dealer.

What we will do: If a breach of warranty occurs, Escort, at its discretion, will either repair or replace your Product free of charge.

What we will not do: Escort will not pay shipping charges that you incur for sending your Product to us.

What you must do to maintain this warranty: Show original proof of purchase or receipt from an authorized Escort dealer.

Warranty exclusions: This warranty does not apply to your product under any of the following conditions: 1. The serial number has been removed or modified. 2. Your product has been subjected to misuse or damage (including water damage, physical abuse, and/or improper installation). 3. Your product has been modified in any way. 4. Your receipt or proof-of-purchase is from a nonauthorized dealer or internet auction site, including E-bay, U-bid, or other non-authorized resellers. 5. You are not the original purchaser of the Product from an authorized dealer or did not receive it as a gift from the original purchaser of the Product from an authorized dealer.

9

To obtain service: 1. Contact ESCORT (1-800-543-1608) to obtain a Return Authorization Number. 2. Properly pack your Product and include: your name, complete return address, written description of the problem with your Product, daytime telephone number, and a copy of the original proof of purchase or receipt. 3. Label the outside of the package clearly with your Return Authorization Number. Ship the Product pre-paid (insured, for your protection) to: ESCORT, Inc., 5440 West Chester Rd., West Chester, OH 45069.

LIMITATION OF WARRANTY: The obligations set forth above are ESCORT's sole obligations and your exclusive remedy. **ESCORT makes no other express warranty. Any implied warranty of merchantability or fitness for a particular purpose that may be applicable to the Product is limited in duration to the duration of this warranty.** Some States do not allow limitations on how long an implied warranty lasts, so the above limitation may not apply to you. ESCORT SHALL NOT BE LIABLE FOR CONSEQUENTIAL, SPECIAL OR INCIDENTAL DAMAGES INCLUDING, WITHOUT LIMITATION, DAMAGES ARISING OUT OF THE USE, MISUSE OR MOUNTING OF THE PRODUCT.

Some States do not allow the exclusion or limitation of incidental or consequential damages, so the above limitation or exclusion may not apply to you. ESCORT is not responsible for products lost in shipment between the owner and our service center.

Other legal rights: This warranty gives you specific legal rights, and you may also have other rights which vary from State to State.

Contact Us

800.433.3487

EscortRadar.com

Designed and manufactured in the USA by Escort Inc. with components of Polish origin

ESCORT Inc.
5440 West Chester Road
West Chester OH 45069

Sales / Service 800.433.3487
www.EscortRadar.com

FCC NOTE: Modifications not expressly approved by the manufacturer could void the user's FCC granted authority to operate the equipment.

FCC ID:QKLZW5

This device complies with part 15 of the FCC rules. Operation is subject to the following two conditions: (1) This device may not cause harmful interference, and (2) This device must accept any interference received including interference that may cause undesired operation.

©2017 ESCORT Inc. ESCORT®, ZW5® and LASER SHIFTERMAX® are trademarks of ESCORT, Inc.

ESCORT® ZW5 WIRELESS

Laser Defense System for select ESCORT and Beltronics Radar Detectors*



[Radar Detector Not Included]



Laser Shifters Provide Speed of Light Protection



Wireless Communication Provides Simple Installation

Installation and Owner's Manual

Congratulations and Important Warning

Congratulations

Your new ZW5 is the most advanced defense system against targeting laser guns available for select ESCORT and Beltronics radar detectors*. ZW5 comes with twin front-mounted ShifterMax sensors, ShifterMax Bridge Box, Interface, ZW5 SmartCord and mounting hardware.

ZW5 will not operate on its own. A compatible radar detector* is required to use ZW5.

Please read this guide in detail to get the most out of your new ZW5.

Please drive safely.

Please Note

This product may be limited or prohibited in some jurisdictions. Check applicable laws before using.

*ZW5 is compatible with Passport MAX, MAX 2, MAX 360, MAX 360c, ESCORT iX, PASSPORT, X70, X80, RedLine EX and Beltronics GT-7. Check the EscortRadar.com website or contact us for the latest compatibility information.

Important Installation Warning

ZW5 requires installation. If you are unsure about installing ZW5, visit EscortRadar.com to find an authorized installer near you.



2

Safety Precautions

ZW5 was designed to meet high performance and quality standards; however, there are certain precautions that must be considered before approaching installation and operation:

- Use only original ZW5 parts included with your unit. Do not plug any third-party components into your unit, and do not plug any supplied components into any third-party products, as this may cause failure and will void warranty.
- Special care must be taken during installation of sensors, as damaging factory-installed cables or connectors may cause damage or device malfunction and may void warranty.
- ZW5 cannot detect through glass or other transparent objects, and certain materials may absorb infrared light.
- Check your local laws before using ZW5, as transmitted light can interfere with other laser equipment.

Maintenance

Once ZW5 is installed, dirt and filth can accumulate on the front covers of the sensors, especially during the winter. To ensure peak performance, check front covers of sensors often and, if necessary, wipe clean with a cloth.

Warning

Never, under any circumstances, look at the sensors while powered on and operating. Do not view with optical instruments (like magnifiers).



3

What's Included

Interface

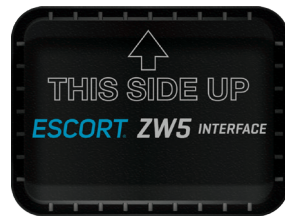

Laser ShifterMax Sensors



- Twin weatherproof sensors
- 6-foot cables with waterproof connectors
- Mounting hardware and bubble level

ZW5 SmartCord



- Replaces your detector's power cord
- Wirelessly communicates with ZW5 Interface

ShifterMax Bridge Box

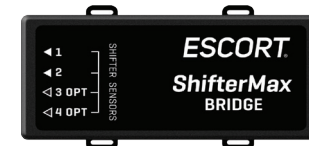

- Weatherproof Bridge Box is used to connect ShifterMax Sensors to Interface

Important Note

Before using ZW5, check for software updates for your radar detector. To do this, connect your Escort or Beltronics radar detector to a computer using a USB cable (not included) and run Escort or Beltronics Detector Tools software. In Detector Tools, select the update option and follow any prompts.

4

Controls and Features

Power

ZW5 does not use a power switch. ZW5 automatically powers on and off with the connected detector.

Alert Indications

Laser activity is reported through the connected detector and the alert light on the ZW5 SmartCord.

Mute

Alerts can be muted by pressing MUTE on the connected detector or ZW5 SmartCord.

Shifters Mode

The Shifters Mode is selected from the Preferences menu of the connected detector. For help accessing the Preferences menu consult your detector's manual or quick reference guide. The **Shifters** Preferences category will be available when the detector is connected to ZW5. There are three selectable modes: Shift, Receive, and Off.

Shift - Sensors alert and shift when detecting laser, default mode

Receive - Sensors alert to laser without shifting

Off - Disables sensors

By default the Shifters Mode is set to **Shift**. To confirm communication with ZW5, the detector will display **Laser Shifters Shift** on power up.



Inline Module

Re-pairing ZW5 SmartCord

ZW5 SmartCord comes already paired to the Interface. Should a component ever need to be replaced then you will need to re-pair ZW5 SmartCord to the Interface. To re-pair:

- 1 Unplug ZW5 SmartCord from vehicle's lighter socket. If using ZW5 Direct Wire SmartCord, turn vehicle's ignition off
- 2 Disconnect radar detector from ZW5 SmartCord
- 3 Plug ZW5 SmartCord into vehicle's lighter socket. If using ZW5 Direct Wire SmartCord, turn vehicle's ignition on
- 4 Locate the pinhole in the barrel of the inline module. Use a straightened paper clip to press the button inside the pinhole. Hold down button for 5 seconds
- 5 The ZW5 SmartCord Alert light will blink indicating that it is pairing
- 6 Pairing is complete when Alert light is on without blinking

5

Interface Installation

- 1 Install the Interface in a higher location within the vehicle's engine compartment. It should not be located deep down inside the engine compartment. A common installation method is to wrap cable ties around a wiring harness and the cables exiting from both sides of the interface.

Important:

The Interface must be installed with the arrow pointing up to ensure wireless communication with the ZW5 SmartCord.



- 2 The power cable consists of a black wire and a red-striped wire ending in lugs. Connect black wire (-) to ground or vehicle's negative (-) battery terminal, and red-striped wire (+) to vehicle's positive (+) battery terminal or a positive (+) 12 Volt wire. Side terminal batteries may require using battery side post extenders which we offer separately.

Caution:

Do not short across battery terminals. Do not short positive (+) battery terminal to vehicle's chassis.

ShifterMax Bridge Box Installation

- 3 The Bridge Box cable labeled "Interface" connects to the Interface cable. See the ShifterMax Bridge Box Installation section of the manual for details.

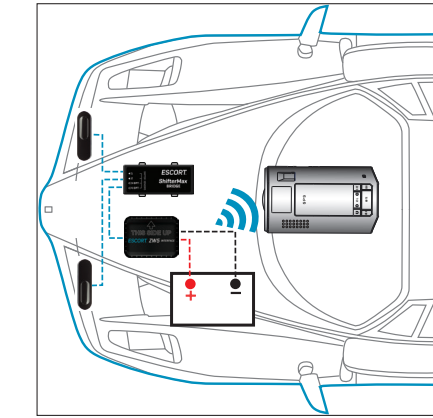

ShifterMax Bridge Box



- 1 Install the Bridge Box inside the vehicle's engine compartment using the included cable ties.
- 2 Slide the included heat shrink tubing onto the Bridge Box cable labeled "Interface" then plug the connector into the Interface cable's connector.
- 3 Shrink the heat shrink onto the inline connection and secure the cable with cable ties.

6