

INSTALLATION GUIDE

MODEL: 2001, 2002, 2003, 2004, 8000, 8001, 8002, 8003, 8004, 2017CL, 2018CL, 8017CL, 8018CL, 9017, 9018

If for some reason you are missing parts or have a problem with your fixture

DO NOT CALL OR RETURN TO THE RETAILER. Call for direct assistance at 1-877-870-9283.

PLEASE READ ALL INSTRUCTIONS CAREFULLY BEFORE INSTALLING FIXTURES.

BEFORE INSTALLATION

1. Please check to see that your fixture was not damaged during shipment, and that you received all the hardware needed for installation. While we strive for perfection, accidents do happen. If you have a problem or are missing any parts, please call us at 1-877-870-9283 immediately.
2. **CAUTION: Disconnect main power at the breaker box before beginning installation. Do not turn power off at the wall switch only. Failure to properly disconnect the main power supply may result in serious injury.**
3. **CAUTION:** Install the appropriate size lamp in your Stone fixture. Do not exceed the manufacturer's maximum wattage restrictions.
4. **SPECIAL NOTE:** For easier installation, it is recommended the two (2) people be used when making the electrical connections and mounting the fixture.

INSTALLATION

CAUTION: TURN OFF AT MAIN PANEL BEFORE INSTALLING FIXTURE

1. LOCATE BULB

Do not remove bulb from carton. Set aside for installation in step 4.

2. CONNECT FITTER TO POWER SUPPLY

BEFORE PROCEEDING - Check to ensure power has been turned off at main panel. Using the wire connectors furnished, splice the Black wire on fixture to Black supply wire. **NOTE:** Fixtures with a Universal Voltage Ballast can be used on the following input voltages: 120, 208, 240, & 277 VAC. Label on fixture will indicate permissible input voltages. Splice the White wire on fixture to the White supply wire. Connect Green ground wire to supply ground. Recheck all connections for loose or exposed wires and re-splice if necessary. **NOTE:** These wiring instructions apply only to direct connection from the power supply to the lighting fixture. For installations involving a photo-cell, refer to manufacturer's instructions included with the photo-cell.

3. POSITION FITTER ON POST

Place fitter on top of post and press down into position. Insert set screw in base of fitter and tighten.

4. INSTALL BULB

Read caution (if applicable) on bulb wrapper and then install per one of the following steps. Use extreme caution not to drop or damage bulb. Use lamp type specified on fixture.

A. SCREWTYPE

Screw into lamp socket.

B. TWO OR FOUR PIN FLUORESCENT

Grasp plastic base, align pins on bulb with pin contacts on lampholder and insert into lampholder. **NOTE:** Failure to change lamp on a timely basis could damage your ballast and void the warranty. Do not wait for the lamp to completely burn out. When lamp begins to flicker, replace immediately.

C. MODELS WITH INTEGRATED LAMP/BALLAST (SBCFL)

Grasp the plastic base, insert pins into socket and rotate clockwise until secure.

5. ATTACH DIFFUSER TO FITTER

Slide open end of diffuser under spring loaded fitter plate and secure by tightening the two screws.

6. ENERGIZING THE FIXTURE

After all the preceding steps have been carefully followed and completed, the power can be turned on at the main control panel.

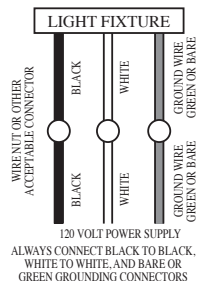
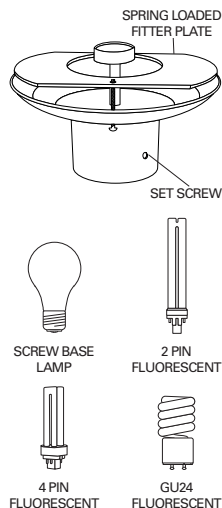

Customer Service 1-877-870-9283
www.wavelighting.com

WAVE
LIGHTING