

Catalog Number

Project

Type

FEATURES & SPECIFICATIONS

APPLICATION — The Genesis Gen2 line of LED Landscape Bullets are the most versatile LED fixtures on the market today. The high end residential grade system was designed for low voltage operation residential applications.

CONSTRUCTION — The die cast aluminum heat sink has 24 heat dissipating fins to maintain a cool operating LED for maximum life. The fins are independently supported to allow for unobstructed airflow. The fixture is designed to efficiently perform in any mounting orientation.

FINISH — A cathodic epoxy electrocoat primer or E-Coat is applied to all die cast aluminum components. E-coating provides the ultimate in corrosion and chemical resistance, providing superior salt spray, humidity and cyclic corrosion endurance. After the E-Coat is applied a super durable polyester powder coat finish is electrostatically applied in our state of the art paint facility. Standard colors available: Black, Bronze, OD Green, White. Custom colors available upon request.

OPTICAL SYSTEM — Techlight's proprietary OpticapSystem™ utilizes reflectors to increase fixture lumen output efficiency. The system is provided with a high performance convex lenticular prismatic flood lens made with low-iron content tempered borosilicate glass. A 96% reflective UV stabilized specular reflector is included with each system. The convex lenses and shields are configured to ensure water runs off and debris is washed clear of the lens in an up light application. A variety of glass lens filters are available to help meet your specific lighting needs

ELECTRICAL SYSTEM — NOTE: A Techlight Surge Protector must be incorporated into the LED system at the beginning of each circuit as a minimum. Failure to do so will void the system warranty. Fixture operates at 9-16VAC or 9-24VDC input voltage. A 13 watt LED source provides approximately 645 (CW) Lumens of light.

MOUNTING — The die cast aluminum mount is secured to the heat sink by stainless steel screws and is

GS2-LV SERIES

Genesis Gen2 Small Low Voltage LED Landscape Bullet

Patent: D0648056



Fixture shown with
SGM2DN60 Down Shield

SERIES	HOUSING HEIGHT	LENGTH & WIDTH
GS2	2.7"	4.8" x 2.0"

sealed with an integral o-ring. A 1/2" threaded knuckle is provided standard.

LISTINGS — ETL listed for wet locations (IP67). Meets US and Canadian safety standards. -40°C to 40°C ambient operation.

WARRANTY — Techlight warrants the LED lighting Product(s) to be free from defects in material and workmanship for a period of three years for LED Light Engines and LED Power Components, from the date of shipment. Ground mounted products that are provided standard with our proprietary E-Coat pretreatment prior to the application of a powdercoat finish will carry a full 10 year finish warranty. Proper maintenance is required for full finish warranty.

ORDERING INFORMATION

Choose the bold face options for the appropriate luminaire configuration for your application and enter on the line above each fixture attribute. Accessories may be factory installed, depending on the particular accessory chosen, but still be ordered as a separate line item.

EXAMPLE:

GS2 FL 13 CW LV ODG

GS2					
SERIES	DISTRIBUTION	WATTAGE	COLOR TEMP	VOLTAGE	FINISH
	FL = Flood (60°)	13 = 13W	CW = Cool White NW = Neutral White WW = Warm White CRI >80	LV = 9-16VAC and 9-24VDC	BZ = Bronze BK = Black ODG = OD Green WH = White SP = Special ¹

ACCESSORIES

(Order as separate line items)

SGS2DN60	Downlight Shield
SGS2UP30	Uplight Shield
SGS2TUBE	Tube Shield
B01GL	Tree Base with Ground Lug
B03	4" Round 3 Hole Cover
B16-12	Palm Tree Base with 12' Strap
TLSBBJB	Brass Junction Box
SMSB	12" x 1" Mounting Stake
MMSB	18" x 1" Mounting Stake
LMSB	20" x 2.5" Mounting Stake
LEDSFG120LENS	Green Glass Lens Filter (each)
LEDSB120LENS	Blue Glass Lens Filter (each)
TLHB800RCH	Digital Timer
PSJ163	16 Gauge 3 Strand Lead Wire
SPD120-277V10KAPARALLEL²	10kV Surge Protector
GS2CAPCVXFLDREFL³	60° Flood OpticapSystem™ Field Installable Flood Optic

NOTES

1 = Custom RAL color matching is available. Contact your sales representative for additional info.

2 = A Techlight Surge Protector must be incorporated into the LED system at the beginning of each circuit as a minimum. Failure to do so will void the system warranty.



AVAILABLE FIXTURE DIMENSIONS

Dimensions shown are for fixture bodies only. Mounting options must be ordered separately.

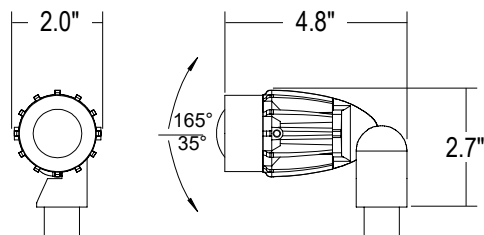

MOUNTING ACCESSORIES

GEPTBZ
Low Profile Tree Base



B16-12
Palm Tree Base with 12' Strap



B03
4" Round 3 Hole Cover



B01GL
Tree Base with Ground Lug



TLSBBJB
Brass Junction Box



SMSB, MMSB, LMSB
12" x 1", 18" x 1" and 20" x 2.5" Mounting Stakes



ADDITIONAL FIXTURE ACCESSORIES

GL2CAPCVXFLDREFL
60° Flood OpticapSystem™
Field Installable Flood Optic



Change the optic on the job by simply swapping the OpticapSystem™ on any fixture

SPD120-277V10KAPARALLEL²
10kV Surge Protector



P20000PC-LVENC
Photocell (DC Transformer Operation Only)



PCCORD-6 6' Photocell Extension Cord
PCCORD-8 8' Photocell Extension Cord



PSJ163
16 Gauge 3 Strand Lead Wire



PW122LV 12-2 Low Voltage Wire
PW102LV 10-2 Low Voltage Wire



TLTN11²
Mechanical Timer



TLHB800RCH
Digital Timer



LEDLFG120LENS
Green Glass Lens Filter (each)



LEDLB120LENS
Blue Glass Lens Filter (each)



SHIELDS

SGS2DN60
Downlight Shield

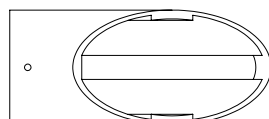
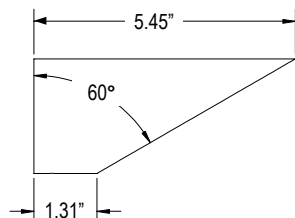

SGS2UP30
Uplight Shield

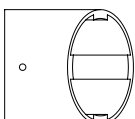
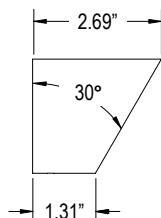

SGS2TUBE
Tube Shield

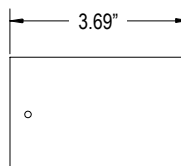

TRANSFORMERS



ELV300 300W AC Low Voltage Enclosure
ELV600 600W AC Low Voltage Enclosure
ELV900 900W AC Low Voltage Enclosure
ELV1200 1200W AC Low Voltage Enclosure

ELV300 thru ELV1200 are 120VAC-11-15VAC magnetic stepdown xformers. They have 11, 12, 13, 14, 15VAC outputs. The 600W, 900W, & 1200W units have 2ea, 3ea, & 4ea 300W rated output circuits respectively. They are enclosed in a aluminum NEMA raintight enclosure polyester powder coated BK finish.



LVSS300 300W SS AC Low Voltage Enclosure
LVSS600 600W SS AC Low Voltage Enclosure
LVSS900 900W SS AC Low Voltage Enclosure
LVSS1200 1200W SS AC Low Voltage Enclosure

LVSS300 THRU LVSS1200 are 120VAC-11-15VAC magnetic stepdown xformers. They have 11, 12, 13, 14, 15VAC outputs. The 600W, 900W, & 1200W units have 2ea, 3ea, & 4ea 300W rated output circuits respectively. They are enclosed in a stainless steel NEMA raintight enclosure, with natural finish.



ELV300MV24DCSS
 300W DC Transformer in a Stainless Steel Enclosure

Output Voltage	Input Voltage Range	Output Current Range	Max. Output Power	Typical Efficiency (1)	Power Factor	
					110Vac	220Vac
24 Vdc	90 ~ 305 Vac	0 ~ 12.5 A	300 W	91%	.99	.96



ELV500MV24DCSS
 500W DC Transformer in a Stainless Steel Enclosure

Output Voltage	Input Voltage Range	Output Current Range	Max. Output Power	Typical Efficiency (1)	Power Factor	
					110Vac	220Vac
24 Vdc	175 ~ 305 Vac	0 ~ 20.83 A	500 W	94%	.99	.96

The **ELV150MV24DCSS** thru **ELV500MV24DCSS** are 120-277VAC – 24VDC electronic power supplies. They are equipped with surge protection, and are enclosed in a stainless steel NEMA raintight enclosure with natural finish. The data listed for these power supplies is correct.

PERFORMANCE

ILLUMINANCE CONE DIAGRAMS

GS2FL13CWL 13W GS2 LED Bullet
Flood Optic Color Temperature: 5,900 K

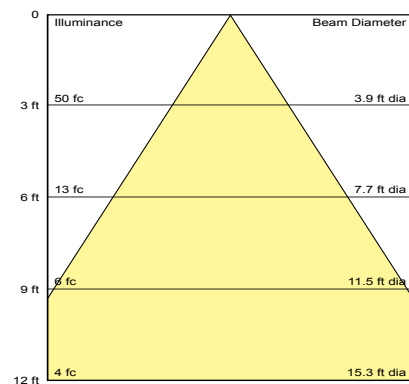

*Lumen output less any shielding

Fixture	Color Temp	13W Lumen Output
GS2	CW (5900K)	511
	NW (4000K)	485
	WW (3000K)	459

WARNING: Maintenance performed including the replacement of LED bricks while power is still supplied to the luminaire may result in system failures and will void the warranty.



TECHLIGHT
 INNOVATION IN ILLUMINATION