

## PRODUCT FEATURES

- Inspired by Mid-Century modern art, the Orbel Flush Mount features a circular canopy that supports alternating metal squares and four frosted spheres of light
- Available in two modern finishes. Aged Brass and Matte Black
- Ceiling mount only
- Complete the look with other fixtures in the Orbel family, Bath Light, Wall Sconce and Pendants
- Lamping options are compatible with most ELV and TRIAC dimmers
- Protected by a 1-year warranty, please visit the "About Us" Page on [techlighting.com](http://techlighting.com) for more for warranty details



## LAMPING

Rated for (4) 5W max. G9 bi-pin lamps (Not Included) LED includes (4) 5 watt (20 total watts) 1023.2 total delivered lumens, 3000K LED module. Dimmable with most LED compatible ELV and TRIAC dimmers. Ceiling mount only.

Aged Brass



Aged Brass

Matte Black

## ORDERING INFORMATION

700FMOBL FINISH	LAMP
R AGED BRASS	NO LAMP
B MATTE BLACK	-LED930 BI-PIN G9 LED 90 CRI 3000K 120V (T20/T24)

700FMOBL \_\_\_\_\_

JOB NAME \_\_\_\_\_

NOTES \_\_\_\_\_

\_\_\_\_\_



# ORBEL CEILING

## SPECIFICATIONS

HARDWARE MATERIAL	Metal
SHADE MATERIAL	Glass
NET WEIGHT	13 lbs
HEIGHT	6.3in
WIDTH	15in
LENGTH	15in
UP LIGHT / DOWN LIGHT / BOTH?	
WET LISTED	
DAMP LISTED	Yes
DRY LISTED	
WALL / CEILING MOUNT	
GENERAL LISTING	ETL Listed
INCLUDES	

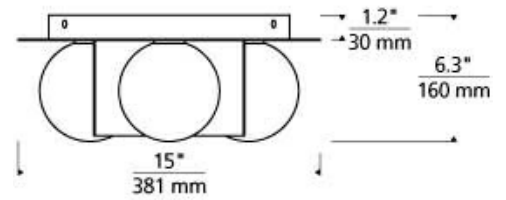

## LAMPING SPECIFICATIONS

	LED LAMP	INTEGRATED LED	NON LED	NO LAMP
DELIVERED LUMENS	1023.0			
WATTS	5			
MAX WATTAGE PER BULB	5W		5W	
INPUT VOLTAGE	120V		120V	
DIMMING TYPE*	ELV, TRIAC		ELV, TRIAC	
CCT	3000K			
CRI	90 CRI			
LED LIFETIME				
L70	>25000			
AVERAGE BULB HOURS				
FIELD SERVICEABLE LED				
LAMP BASE	G9		G9	
LAMP SHAPE	T4		T4	
LAMP INCLUDED?	True		False	
WARRANTY**	1 Year		1 Year	

\*Dimming information available at [www.techlighting.com/Downloads#dimming](http://www.techlighting.com/Downloads#dimming)

\*\* Visit [techlighting.com](http://techlighting.com) for specific warranty limitations and details.

## T20 / T24 / JA8 INFORMATION

	Integrated LED	Replacement LED Lamp	No Lamp *
This product can be used to comply with California Building Energy Efficiency Standards 2016 <b>Title 24</b> Part 6 / <b>JA8</b> .		Yes	N/A
This product can be used to comply with California Appliance Efficiency Standards 2016 <b>Title 20</b> and may be shipped to and sold in California.		Yes	N/A

\* If a light fixture or component does not include a lamp or light source, it is the responsibility of the customer to select a lamp that meets the T24 and T20 requirements.

