

## DESCRIPTION

The EPIC Collection delivers custom luminaire flexibility with high quality, yet availability expectations of standard specification grade product. The EPIC Collection can be dressed to suit any application. Recognizing evolving environmental and legislative trends, the EPIC Collection delivers world class LED optical and performance solutions to the decorative luminaire marketplace.

<b>Catalog #</b>		<b>Type</b>	
<b>Project</b>			
<b>Comments</b>		<b>Date</b>	
<b>Prepared by</b>			

## SPECIFICATION FEATURES

### Construction

**TOP:** Cast aluminum top housing attaches to cast aluminum mounting arm hub with four stainless steel fasteners. One-piece silicone gasket between mounting hub and top casting seals out moisture and contaminants. (See the mounting accessories section for a full selection of mounting arms. (Only these arms are compatible with the Epic luminaire). **MIDSECTION:** Continuous silicone gaskets seal lens to top casting and shade. The mid section features cast aluminum construction and stainless steel assembly. **SHADES:** Heavy gauge precision spun aluminum shades offer superior surface finish and consistency in form. **DOORFRAME:** Die-cast aluminum 1/8" thick door and doorframe seal to underside of shade with a thick wall continuous silicone gasket. Mounting hub ships attached to mounting arm.

### Optics

Choice of twelve patented, high-efficiency AccuLED Optic™ technology manufactured from

injection-molded acrylic. Optics are precisely designed to shape the optics, maximizing efficiency and application spacing. AccuLED Optic technology, creates consistent distributions with the scalability to meet customized application requirements. Offered Standard in 4000K (+/- 275K) CCT and nominal 70 CRI. Optional 3000K CCT and 5000K CC. For the ultimate level of spill light control, an optional house-side shield accessory can be field or factory installed. The house-side shield is designed to seamlessly integrate with the SL2, SL3 or SL4 optics.

### Electrical

LED drivers mount to die-cast aluminum back housing for optimal heat sinking, operation efficacy, and prolonged life. Standard drivers feature electronic universal voltage (120-277V 50/60Hz), 347V 60Hz or 480V 60Hz operation, greater than 0.9 power factor, less than 20% harmonic distortion, and is suitable for operation in -40°C to 40°C ambient environments. All fixtures are shipped standard

with 10kV/10kA common – and differential – mode surge protection. LightBARs feature and IP66 enclosure rating and maintain greater than 95% lumen maintenance at 60,000 hours per IESNA TM-21. Occupancy sensor and dimming options available.

### Finish

Housing is finished in five-stage super TGIC polyester powder coat paint, 2.5 mil nominal thickness for superior protection against fade and wear. LightBAR™ cover plates are standard white and may be specified to match finish of luminaire housing. Standard colors include black, bronze, grey, white, dark platinum and graphite metallic. RAL and custom color matches available. Consult Outdoor Architectural Colors brochure for a complete selection. Options to meet Buy American and other domestic preference requirements.

### Warranty

Five-year warranty.



## CEM/MEM EPIC MEDIUM LED

1 - 4 LightBARs  
Solid State LED

DECORATIVE AREA LUMINAIRE



### CERTIFICATION DATA

UL/cUL Listed  
IP66 LightBARs  
LM79 / LM80 Compliant  
2G Vibration Tested  
ISO 9001

### ENERGY DATA

**Electronic LED Driver**  
>0.9 Power Factor  
<20% Total Harmonic Distortion  
120-277V 50/60Hz, 347V/60Hz,  
480V/60Hz  
-40°C Minimum Temperature  
40°C Ambient Temperature Rating

### EPA

Effective Projected Area: (Sq. Ft.) 0.94

### SHIPPING DATA

Approximate Net Weight:  
45 lbs. [20 kgs.]

## DIMENSIONS

### CEM Classical

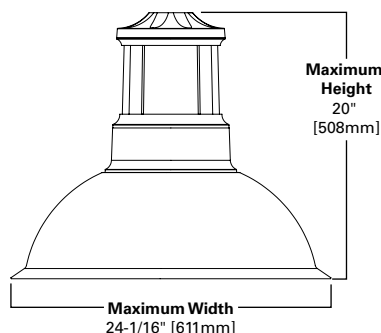

### MEM Classical

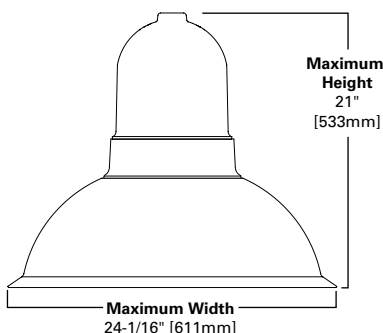

See configurations for more detailed information.

CONFIGURATIONS

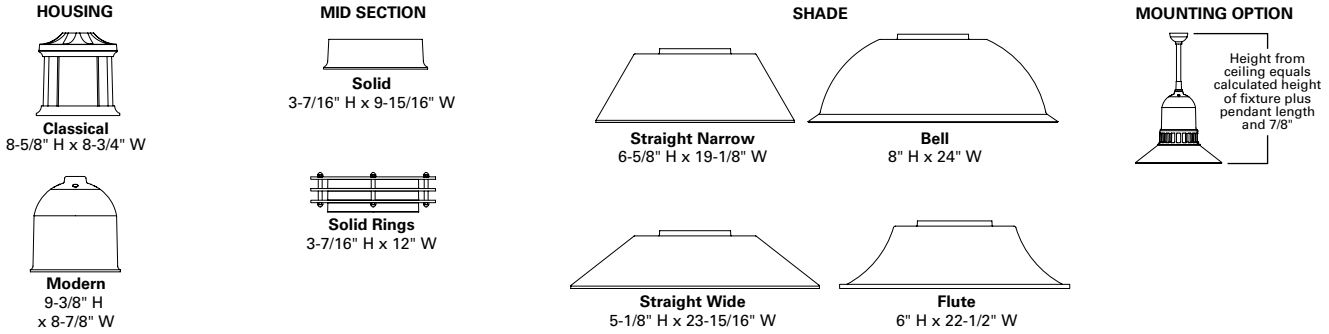

POWER AND LUMENS BY BAR COUNT (21 LED LIGHTBARS)

Number of LightBARs	E01	E02	E03	E04	
<b>Drive Current</b>	350mA Drive Current				
<b>Power (Watts)</b>	25W	52W	75W	97W	
<b>Current @ 120V (A)</b>	0.22	0.44	0.63	0.82	
<b>Current @ 277V (A)</b>	0.10	0.20	0.28	0.36	
<b>Power (Watts)</b>	31W	58W	82W	99W	
<b>Current @ 347V (A)</b>	0.11	0.19	0.28	0.29	
<b>Current @ 480V (A)</b>	0.09	0.15	0.20	0.21	
<b>T2</b>	Lumens	2,948	5,896	8,844	11,792
	BUG Rating	B1-U0-G1	B2-U0-G2	B3-U0-G3	B3-U0-G3
<b>T3</b>	Lumens	2,936	5,873	8,809	11,745
	BUG Rating	B1-U0-G1	B2-U0-G2	B3-U0-G3	B3-U0-G3
<b>T4</b>	Lumens	2,876	5,752	8,627	11,503
	BUG Rating	B1-U0-G1	B1-U0-G2	B1-U0-G2	B2-U0-G3
<b>5MQ</b>	Lumens	3,054	6,108	9,161	12,215
	BUG Rating	B2-U0-G1	B3-U0-G1	B3-U0-G2	B4-U0-G2
<b>5WQ</b>	Lumens	2,987	5,975	8,962	11,949
	BUG Rating	B2-U0-G1	B3-U0-G1	B3-U0-G2	B4-U0-G2
<b>5XQ</b>	Lumens	2,982	5,963	8,945	11,926
	BUG Rating	B2-U0-G1	B3-U0-G2	B3-U0-G3	B4-U0-G3
<b>SL2</b>	Lumens	2,878	5,756	8,634	11,512
	BUG Rating	B1-U0-G1	B1-U0-G2	B2-U0-G2	B2-U0-G2
<b>SL3</b>	Lumens	2,894	5,788	8,682	11,576
	BUG Rating	B1-U0-G1	B1-U0-G2	B2-U0-G2	B2-U0-G2
<b>SL4</b>	Lumens	2,823	5,647	8,470	11,294
	BUG Rating	B1-U0-G1	B1-U0-G2	B2-U0-G2	B2-U0-G2
<b>RW</b>	Lumens	2,957	5,915	8,872	11,829
	BUG Rating	B2-U0-G2	B3-U0-G3	B3-U0-G3	B3-U0-G3
<b>SLL/SLR</b>	Lumens	2,616	5,231	7,847	10,462
	BUG Rating	B1-U0-G2	B1-U0-G2	B1-U0-G3	B2-U0-G3

POWER AND LUMENS BY BAR COUNT (7 LED LIGHTBARS)

Number of LightBARs	F01	F02	F03	F04	
<b>Drive Current</b>	1A Drive Current				
<b>Power (Watts)</b>	26W	55W	78W	102W	
<b>Current @ 120V (A)</b>	0.22	0.46	0.66	0.86	
<b>Current @ 277V (A)</b>	0.10	0.21	0.29	0.37	
<b>Power (Watts)</b>	32W	60W	85W	105W	
<b>Current @ 347V (A)</b>	0.11	0.19	0.28	0.30	
<b>Current @ 480V (A)</b>	0.09	0.15	0.21	0.22	
<b>T2</b>	Lumens	2,434	4,867	7,301	9,735
	BUG Rating	B1-U0-G1	B2-U0-G2	B2-U0-G2	B3-U0-G3
<b>T3</b>	Lumens	2,424	4,848	7,272	9,696
	BUG Rating	B1-U0-G1	B2-U0-G2	B2-U0-G2	B3-U0-G3
<b>T4</b>	Lumens	2,374	4,748	7,122	9,496
	BUG Rating	B1-U0-G1	B1-U0-G2	B1-U0-G2	B2-U0-G2
<b>5MQ</b>	Lumens	2,521	5,042	7,563	10,084
	BUG Rating	B2-U0-G1	B3-U0-G1	B3-U0-G1	B3-U0-G2
<b>5WQ</b>	Lumens	2,466	4,932	7,398	9,864
	BUG Rating	B2-U0-G1	B3-U0-G1	B3-U0-G2	B4-U0-G2
<b>5XQ</b>	Lumens	2,461	4,923	7,384	9,845
	BUG Rating	B2-U0-G1	B3-U0-G2	B3-U0-G2	B4-U0-G3
<b>SL2</b>	Lumens	2,376	4,752	7,127	9,503
	BUG Rating	B1-U0-G1	B1-U0-G1	B2-U0-G2	B2-U0-G2
<b>SL3</b>	Lumens	2,389	4,778	7,167	9,556
	BUG Rating	B1-U0-G1	B1-U0-G1	B1-U0-G2	B2-U0-G2
<b>SL4</b>	Lumens	2,331	4,662	6,993	9,323
	BUG Rating	B1-U0-G1	B1-U0-G2	B1-U0-G2	B2-U0-G2
<b>RW</b>	Lumens	2,441	4,883	7,324	9,765
	BUG Rating	B1-U0-G1	B2-U0-G2	B3-U0-G3	B3-U0-G3
<b>SLL/SLR</b>	Lumens	2,159	4,318	6,478	8,637
	BUG Rating	B1-U0-G1	B1-U0-G2	B1-U0-G3	B1-U0-G3

LUMEN MAINTENANCE

Ambient Temperature	25,000 Hours*	50,000 Hours*	60,000 Hours*	100,000 Hours	Theoretical L70 (Hours)
25°C	> 99%	> 97%	> 96%	> 93%	> 450,000
40°C	> 98%	> 97%	> 96%	> 92%	> 425,000
50°C	> 97%	> 96%	> 95%	> 91%	> 400,000

\* Per IESNA TM-21 data.

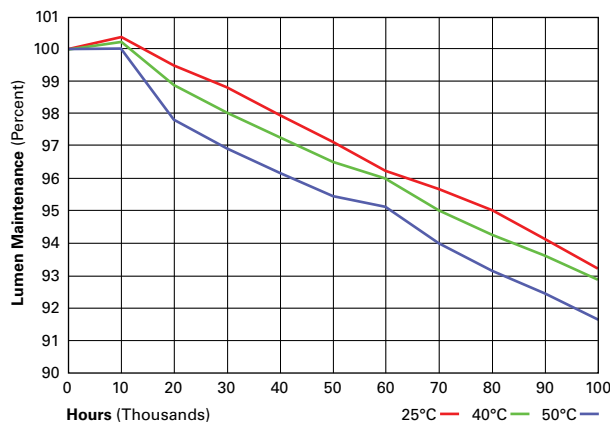

LUMEN MULTIPLIER

Ambient Temperature	Lumen Multiplier
10°C	1.02
15°C	1.01
25°C	1.00
40°C	0.99
50°C	0.96

CONTROL OPTIONS

0-10V (DIM)

This fixture is offered standard with 0-10V dimming driver(s). The DIM option provides 0-10V dimming wire leads for use with a lighting control panel or other control method.

Photocontrol (PC, PER and PER7)

Optional button-type photocontrol (PC) and photocontrol receptacles (PER and PER7) provide a flexible solution to enable "dusk-to-dawn" lighting by sensing light levels. Advanced control systems compatible with NEMA 7-pin standards can be utilized with the PER7 receptacle.

Dimming Occupancy Sensor (MS/DIM-LXX, MS/X-LXX and MS-LXX)

These sensors are factory installed in the luminaire housing. When the MS/DIM-LXX sensor option is selected, the occupancy sensor is connected to a dimming driver and the entire luminaire dims when there is no activity detected. When activity is detected, the luminaire returns to full light output. The MS/DIM sensor is factory preset to dim down to approximately 50 percent power with a time delay of five minutes. The MS-LXX sensor is factory preset to turn the luminaire off after five minutes of no activity. The MS/X-LXX is also preset for five minutes and only controls the specified number of light engines to maintain steady output from the remaining light engines.

These occupancy sensors includes an integral photocell that can be activated with the FSIR-100 accessory for "dusk-to-dawn" control or daylight harvesting - the factory preset is OFF. The FSIR-100 is a wireless tool utilized for changing the dimming level, time delay, sensitivity and other parameters.

A variety of sensor lens are available to optimize the coverage pattern for mounting heights from 8'-40'.

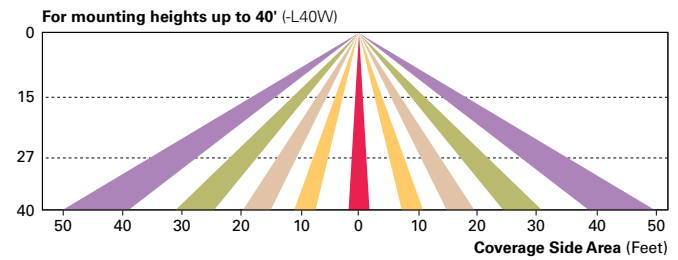
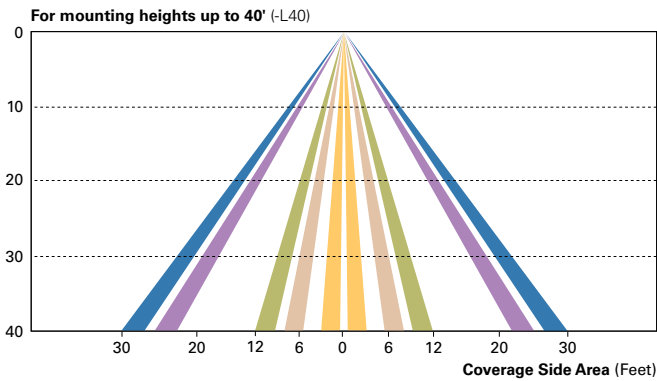
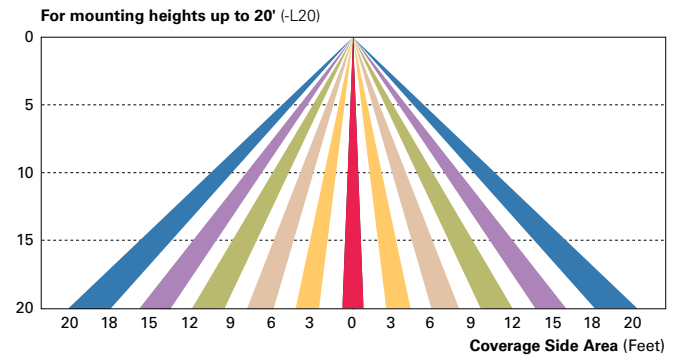
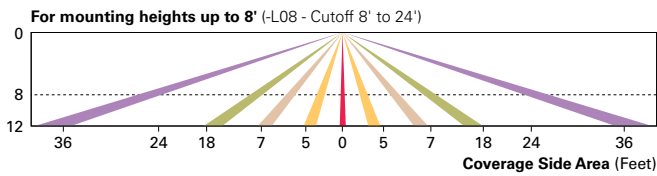

**ORDERING INFORMATION**

Sample Number: CEM-E04-LED-E1-T2-FL-GM

Product Family <sup>1</sup>	Number of LightBARs <sup>2,3</sup>	Lamp Type	Voltage	Distribution	Mid Section Type	Shade Type	Color <sup>5</sup>
CEM=Epic Classical Medium MEM=Epic Modern Medium BAA-CEM= Epic Classical Medium, Buy American Act Compliant <sup>19</sup> TAA-CEM= Epic Classical Medium, Trade Agreements Act Compliant <sup>19</sup> BAA-MEM= Epic Modern Medium, Buy American Act Compliant <sup>19</sup> TAA-MEM= Epic Modern Medium, Trade Agreements Act Compliant <sup>19</sup>	E01=(1) 21 LED LightBAR E02=(2) 21 LED LightBARs E03=(3) 21 LED LightBARs E04=(4) 21 LED LightBARs F01=(1) 7 LED LightBAR F02=(2) 7 LED LightBARs F03=(3) 7 LED LightBARs F04=(4) 7 LED LightBARs	LED=Solid State Light Emitting Diodes	E1=Electronic (120-277V) 347=347V 480=480V <sup>4</sup>	T2=Type II T3=Type III T4=Type IV SL2=Type II w/Spill Control SL3=Type III w/Spill Control SL4=Type IV w/Spill Control 5MQ=Type V Square Medium 5WQ=Type V Square Wide 5XQ=Type V Square Extra Wide RW=Rectangular Wide SLL=90° Spill Light Eliminator Left SLR=90° Spill Light Eliminator Right	SO=Solid SR=Solid Rings	SN=Straight Narrow SW=Straight Wide BL=Bell FL=Flute	AP=Grey BZ=Bronze BK=Black DP=Dark Platinum GM=Graphite Metallic GN=Hartford Green WH=White

Options (Add as Suffix)	Accessories (Order Separately) <sup>13,20</sup>	Accessory Options <sup>16</sup>
2L=Two Circuits <sup>6</sup> 7030=70 CRI / 3000K CCT <sup>7</sup> 7050=70 CRI / 5000K CCT <sup>7</sup> 8030=80 CRI / 3000K CCT <sup>7</sup> LCF=LightBAR Cover Plate Matches Housing Finish MS-LXX=Motion Sensor for ON/OFF Operation <sup>8</sup> MS/X-LXX=Motion Sensor for Bi-Level Switching <sup>9</sup> PMXX=Pendant Mount (XX=Pendant Length in Inches, 9.5" min - 48.0" max) <sup>10</sup> HSS=Factory Installed House Side Shield <sup>11</sup> DIM=0-10V Dimming Driver <sup>12</sup> 10MSP=Parallel 10kV MOV Surge Protective Device 20MSP=Parallel 20kV MOV Surge Protective Device 20K=Series 20kV UL 1449 Surge Protective Device	OA/RA1016=NEMA Twistlock Photocontrol - Multi-Tap OA/RA1027=NEMA Twistlock Photocontrol - 480V OA/RA1201=NEMA Twistlock Photocontrol - 347V OA/RA1013=Photocontrol Shorting Cap LB/HSS-21=Field Installed House Side Shield for "E" LightBARs <sup>11,15</sup> LB/HSS-07=Field Installed House Side Shield for "F" LightBARs <sup>11,15</sup>  <b>Mounting Accessories (Order Separately)</b> <b>Classical</b> SA6150-XX=Bishop Wall Mount Arm SA6151-XX=Bishop Wall Mount Arm with Cross Rod SA6152-XX=Traditional Wall Mount Arm SA6153-XX=Traditional Wall Mount Arm with 45° Strap SA6154-XX=Bishop Single Pole Mount Arm SA6155-XX=Bishop Single Pole Mount Arm with Cross Rod SA6156-XX=Bishop Twin Pole Mount Arm SA6157-XX=Bishop Twin Pole Mount Arm with Cross Rods SA6158-XX=Traditional Single Pole Mount Arm SA6159-XX=Traditional Single Pole Mount Arm with Rounded Upper Bar SA6160-XX=Traditional Single Pole Mount Arm with Rounded Lower Bar <sup>14</sup> SA6161-XX=Traditional Single Pole Mount Arm with 45° Upper Bar SA6162-XX=Traditional Single Pole Mount Arm with 45° Lower Bar <sup>14</sup> SA6163-XX=Traditional Single Pole Mount Arm with 45° Upper Strap SA6165-XX=Traditional Twin Pole Mount Arm SA6166-XX=Traditional Twin Pole Mount Arm with Rounded Upper Bars SA6167-XX=Traditional Twin Pole Mount Arm with Rounded Lower Bars <sup>14</sup> SA6168-XX=Traditional Twin Pole Mount Arm with 45° Upper Bars SA6169-XX=Traditional Twin Pole Mount Arm with 45° Lower Bars <sup>14</sup> SA6170-XX=Traditional Twin Pole Mount Arm with 45° Upper Straps SA6171-XX=Mast Arm Adapter  <b>Modern</b> SA6101-XX=Bishop Wall Mount Arm SA6102-XX=Bishop Wall Mount Arm with Cross Rod SA6103-XX=Traditional Wall Mount Arm SA6104-XX=Traditional Wall Mount Arm with 45° Strap SA6105-XX=Bishop Single Pole Mount Arm SA6106-XX=Bishop Single Pole Mount Arm with Cross Rod SA6107-XX=Bishop Twin Pole Mount Arm SA6108-XX=Bishop Twin Pole Mount Arm with Cross Rods SA6109-XX=Traditional Single Pole Mount Arm SA6110-XX=Traditional Single Pole Mount Arm with Rounded Upper Bar SA6111-XX=Traditional Single Pole Mount Arm with Rounded Lower Bar <sup>14</sup> SA6112-XX=Traditional Single Pole Mount Arm with 45° Upper Bar SA6113-XX=Traditional Single Pole Mount Arm with 45° Lower Bar <sup>14</sup> SA6114-XX=Traditional Single Pole Mount Arm with 45° Upper Strap SA6116-XX=Traditional Twin Pole Mount Arm SA6117-XX=Traditional Twin Pole Mount Arm with Rounded Upper Bars SA6118-XX=Traditional Twin Pole Mount Arm with Rounded Lower Bars <sup>14</sup> SA6119-XX=Traditional Twin Pole Mount Arm with 45° Upper Bars SA6120-XX=Traditional Twin Pole Mount Arm with 45° Lower Bars <sup>14</sup> SA6121-XX=Traditional Twin Pole Mount Arm with 45° Upper Straps SA6122-XX=Mast Arm Adapter	V=Victorian Finial <sup>17</sup> M=Modern Finial <sup>17</sup> A=Architectural Finial <sup>17</sup> N=Nostalgic Finial <sup>17</sup> R=NEMA Twistlock Photocontrol Receptacle <sup>18</sup> PER7=NEMA 7-PIN Twistlock Photocontrol Receptacle <sup>18</sup>

- NOTES:**
1. Arm not included. Order separately. See accessories.
  2. Standard 4000K CCT and greater than 70 Rl.
  3. 21 LED LightBAR powered by 350mA and 7 LED LightBAR powered by 1A.
  4. Only for use with 480V Wye systems. Per NEC, not for use with ungrounded systems, impedance grounded systems or corner grounded systems (commonly known as Three Phase Three Wire Delta, Three Phase High Leg Delta and Three Phase Corner Grounded Delta systems).
  5. Custom and RAL color matching available upon request. Consult your lighting representative at Cooper Lighting Solutions for more information.
  6. Low-level output varies by bar count. Consult factory. Requires quantity of two or more LightBARs.
  7. Consult customer service for lead times and multiplier.
  8. Sensor mounted to the luminaire. Available in E01-E04 and F01-F04 configurations. Replace "XX" with mounting height in feet for proper lens selection, (e.g., MS-L25). Consult factory for additional information.
  9. Sensor mounted to the luminaire. Available in E02-E04 and F02-F04 configurations. Replace "X" with number of LightBARs operating in low output mode and replace XX with mounting height in feet for proper lens selection, (e.g., MS/3-L25). Maximum four bars in low output mode. Consult factory for additional information.
  10. Pendant mount option "PMXX" must be used with Invue Pendant mount kit only. Includes pendant pipe, swivel hanger and canopy cover. Other pendant lengths can be specified in inches (XX). Minimum pendant length is 9-1/2". For lengths above 48", consult your lighting representative at Cooper Lighting Solutions for more information.
  11. Only for use with SL2, SL3 and SL4 distributions.
  12. Dimming leads provide for external 0-10V control system (by others).
  13. Replace XX with color suffix.
  14. Only available with traditional arms.
  15. One required for each LightBAR.
  16. Add as suffix to mounting accessory. Example: VA6106-BK-R.
  17. Not available with finials, pendant mount "PM48" or bishop wall mounts.
  18. Requires use of 4" O.D. round straight pole.
  19. Only product configurations with these designated prefixes are built to be compliant with the Buy American Act of 1933 (BAA) or Trade Agreements Act of 1979 (TAA), respectively. Please refer to [DOMESTIC PREFERENCES](#) website for more information. Components shipped separately may be separately analyzed under domestic preference requirements.
  20. Accessories sold separately will be separately analyzed under domestic preference requirements. Consult factory for further information.

**MOUNTING ACCESSORIES**

Pole mount arms are designed to fit both medium CEM/MEM housings. (Only these arms are compatible with the Epic luminaire). Arms feature a precision welded cast aluminum mounting hub for attachment of fixture head to arm with four stainless steel fasteners. Wall mount arms compliment pole mount luminaires and attractively transition fixture scale in lower mounting height pedestrian environments. Wall mount arms are designed to fit both medium CEM/MEM housings. Arms feature a precision welded cast aluminum mounting hub for attachment of fixture head to arm with four stainless steel fasteners.

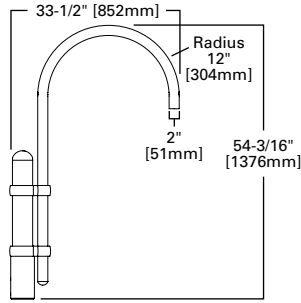

**BISHOP SINGLE POLE MOUNT ARM**  
 SA6105 (Modern), SA6154 (Classical)  
 Slipfits over 4" round straight pole, or 4" O.D. by 6" tall round tenon.  
 Weight: 24 lbs. E.P.A: 0.92

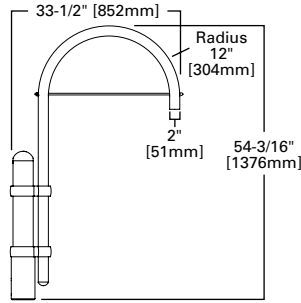

**BISHOP SINGLE POLE MOUNT ARM WITH CROSS ROD**  
 SA6106 (Modern), SA6155 (Classical)  
 Slipfits over 4" round straight pole, or 4" O.D. by 6" tall round tenon.  
 Weight: 25 lbs. E.P.A: 0.98

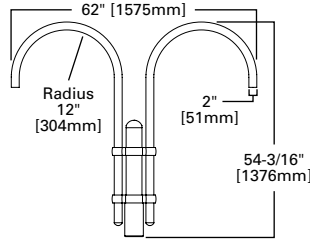

**BISHOP TWIN POLE MOUNT ARM**  
 SA6107 (Modern), SA6156 (Classical)  
 Slipfits over 4" round straight pole, or 4" O.D. by 6" tall round tenon.  
 Weight: 37 lbs. E.P.A: 1.43

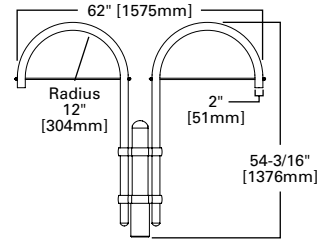

**BISHOP TWIN POLE MOUNT ARM WITH CROSS RODS**  
 SA6108 (Modern), SA6157 (Classical)  
 Slipfits over 4" round straight pole, or 4" O.D. by 6" tall round tenon.  
 Weight: 39 lbs. E.P.A: 1.55

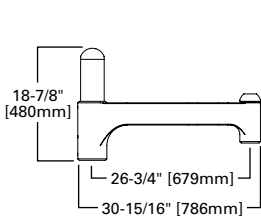

**TRADITIONAL SINGLE POLE MOUNT ARM**  
 SA6109 (Modern), SA6158 (Classical)  
 Slipfits over 4" round straight pole, or 4" O.D. by 6" tall round tenon.  
 Weight: 20 lbs. E.P.A: 0.86

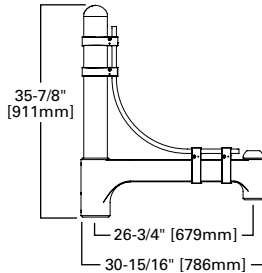

**TRADITIONAL SINGLE POLE MOUNT ARM WITH ROUNDED UPPER BAR**  
 SA6110 (Modern), SA6159 (Classical)  
 Slipfits over 4" round straight pole, or 4" O.D. by 6" tall round tenon.  
 Weight: 28 lbs. E.P.A: 1.4

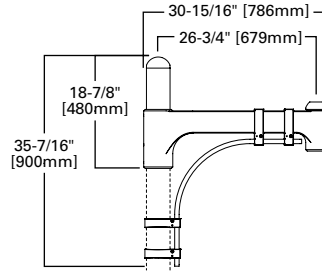

**TRADITIONAL SINGLE POLE MOUNT ARM WITH ROUNDED LOWER BAR**  
 SA6111 (Modern), SA6160 (Classical)  
 Slipfits over 4" round straight pole, or 4" O.D. by 6" tall round tenon.  
 Weight: 25 lbs. E.P.A: 1.16

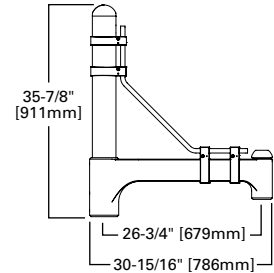

**TRADITIONAL SINGLE POLE MOUNT ARM WITH 45° UPPER BAR**  
 SA6112 (Modern), SA6161 (Classical)  
 Slipfits over 4" round straight pole, or 4" O.D. by 6" tall round tenon.  
 Weight: 28 lbs. E.P.A: 1.38

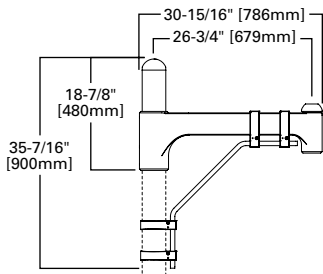

**TRADITIONAL SINGLE POLE MOUNT ARM WITH 45° LOWER BAR**  
 SA6113 (Modern), SA6162 (Classical)  
 Slipfits over 4" round straight pole, or 4" O.D. by 6" tall round tenon.  
 Weight: 24 lbs. E.P.A: 1.17

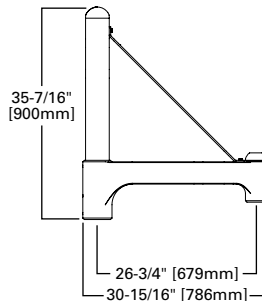

**TRADITIONAL SINGLE POLE MOUNT ARM WITH 45° UPPER STRAP**  
 SA6114 (Modern), SA6163 (Classical)  
 Slipfits over 4" round straight pole, or 4" O.D. by 6" tall round tenon.  
 Weight: 24 lbs. E.P.A: 1.17

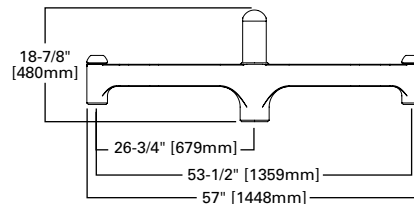

**TRADITIONAL TWIN POLE MOUNT ARM**  
 SA6116 (Modern), SA6165 (Classical)  
 Slipfits over 4" round straight pole, or 4" O.D. by 6" tall round tenon.  
 Weight: 30 lbs. E.P.A: 1.44

**MOUNTING ACCESSORIES**

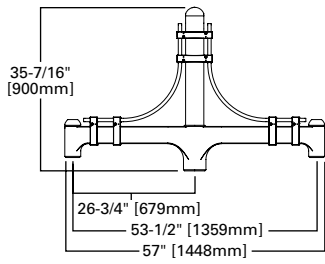

**TRADITIONAL TWIN POLE MOUNT ARM WITH ROUNDED UPPER BARS**  
 SA6117 (Modern), SA6166 (Classical)  
 Slipfits over 4" round straight pole, or 4" O.D. by 6" tall round tenon.  
 Weight: 43 lbs. E.P.A.: 2.28

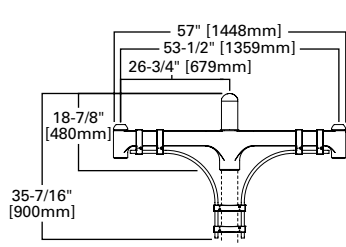

**TRADITIONAL TWIN POLE MOUNT ARM WITH ROUNDED LOWER BARS**  
 SA6118 (Modern), SA6167 (Classical)  
 Slipfits over 4" round straight pole, or 4" O.D. by 6" tall round tenon.  
 Weight: 40 lbs. E.P.A.: 2.04

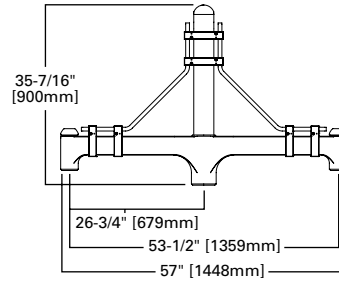

**TRADITIONAL TWIN POLE MOUNT ARM WITH 45° UPPER BARS**  
 SA6119 (Modern), SA6168 (Classical)  
 Slipfits over 4" round straight pole, or 4" O.D. by 6" tall round tenon.  
 Weight: 43 lbs. E.P.A.: 2.24

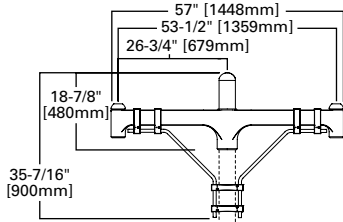

**TRADITIONAL TWIN POLE MOUNT ARM WITH 45° LOWER BARS**  
 SA6120 (Modern), SA6169 (Classical)  
 Slipfits over 4" round straight pole, or 4" O.D. by 6" tall round tenon.  
 Weight: 40 lbs. E.P.A.: 2.0

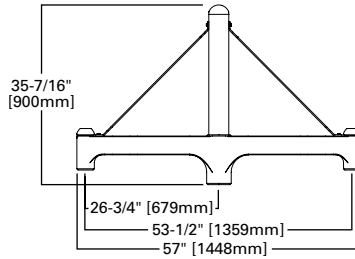

**TRADITIONAL TWIN POLE MOUNT ARM WITH 45° UPPER STRAPS**  
 SA6121 (Modern), SA6170 (Classical)  
 Slipfits over 4" round straight pole, or 4" O.D. by 6" tall round tenon.  
 Weight: 37 lbs. E.P.A.: 1.81

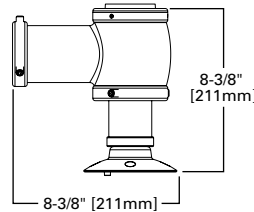

**MAST ARM ADAPTER**  
 SA6122 (Modern), SA6171 (Classical)  
 Secures fixture to nominal 2" pipe (2-3/8" horizontal O.D.)  
 Weight: 4 lbs.

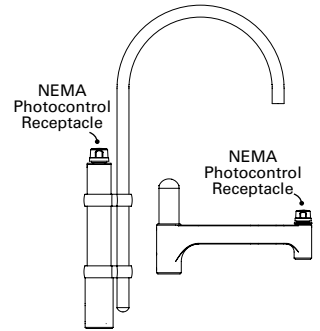

**NEMA TWISTLOCK PHOTOCONTROL (R)**  
 Order separately (Not compatible with finials or wall mount bishop arms)

**Wall Mount Accessories**

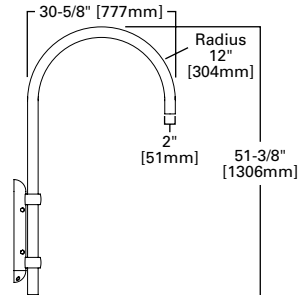

**BISHOP WALL MOUNT ARM**  
 SA6101 (Modern), SA6150 (Classical)  
 Mounts to wall with four stainless steel lag bolts (provided by other).  
 Weight: 16 lbs.

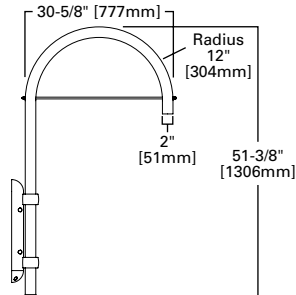

**BISHOP WALL MOUNT ARM WITH CROSS ROD**  
 SA6102 (Modern), SA6151 (Classical)  
 Mounts to wall with four stainless steel lag bolts (provided by other).  
 Weight: 17 lbs.

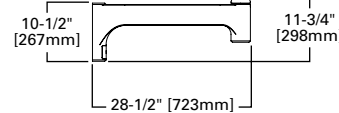

**TRADITIONAL WALL MOUNT ARM**  
 SA6103 (Modern), SA6152 (Classical)  
 Mounts to wall with four stainless steel lag bolts (provided by other).  
 Weight: 17 lbs.

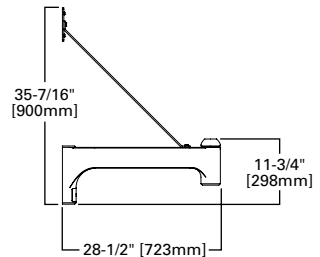

**TRADITIONAL WALL MOUNT ARM WITH 45° STRAP**  
 SA6104 (Modern), SA6153 (Classical)  
 Mounts to wall with four stainless steel lag bolts (provided by other).  
 Weight: 18 lbs.