

Shaper

DESCRIPTION

673-W and 673-WP Luminous wall sconce features 6 standard finishes, 3 decorative trim bar options and is ADA compliant.

- Wall Luminous Vanity Luminaire
- Painted solid aluminum w/ extruded white acrylic panel
- Universal circular strap for a standard 4" J-box or plaster ring
- UL and CUL approved for interior and damp locations

Catalog #		Type
Project		
Comments		Date
Prepared by		

SPECIFICATION FEATURES

Material

Painted or plated solid aluminum with a 1/8" matte white extruded acrylic panel, open top and bottom end caps, with acrylic inserts. Luminous top and bottom for LED.

Finishes

ALP (Aluminum Paint)
 MW (Matte White)
 MB (Matte Black)
 GRM (Graphite Metallic)
 DP (Dark Platinum)
 BM (Bronze Metallic)
 CC (Custom Color – Specify)

For Custom Color contact factory for quotation.

LED

16": L3:2000 nominal lumens at max 20W
 25": L3:2000 nominal lumens at max 20W
 37": L4:3000 nominal lumens at max 29W

Driver

LED system coupled with electronic driver to deliver optimal performance. Electronic drivers are available for 120-277V applications. A 0-10V dimming control is standard on all models. Standard integral class 2 driver 29W max., 0-10V dimming.

Installation

Supplied with a universal circle

strap for a standard 4" J-box or round or octagonal plaster ring. Horizontal or vertical mount. Shaper 673-W luminaires are designed for interior installations only. Shaper 673-WP are listed for wet location. Battery must be remote mounted in an interior location at a 5ft max distance.

Compliance

Shaper 673-W is U.L. and C.U.L approved for indoor and damp location. Shaper 673-WP is listed for wet location. ADA compliant, except with proud trim options.

Warranty

5 year limited warranty on LED components.

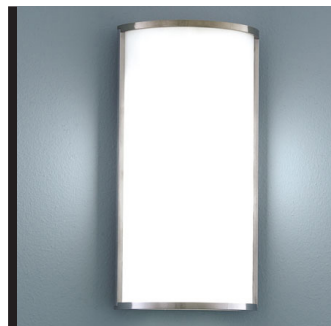

673-W SERIES 673-WP SERIES

Height: 16"

- Lumen Output Source Lumens: L3:2000
- Wattage: 20W
- Color Rendering: CRI 83+
- Correlated Color Temperature: 4000K, 3500K, 3000K, 2700K
- Rated Life of Lamp (hrs): 50,000
- Dimming: 0-10V

Height: 25"

- Lumen Output Source Lumens: L3:2000
- Wattage: 20W
- Color Rendering: CRI 83+
- Correlated Color Temperature: 4000K, 3500K, 3000K, 2700K
- Rated Life of Lamp (hrs): 50,000
- Dimming: 0-10V

Height: 37"

- Lumen Output Source Lumens: L4:3000
- Wattage: 29W
- Color Rendering: CRI 83+
- Correlated Color Temperature: 4000K, 3500K, 3000K, 2700K
- Rated Life of Lamp (hrs): 50,000
- Dimming: 0-10V

DIMENSIONS

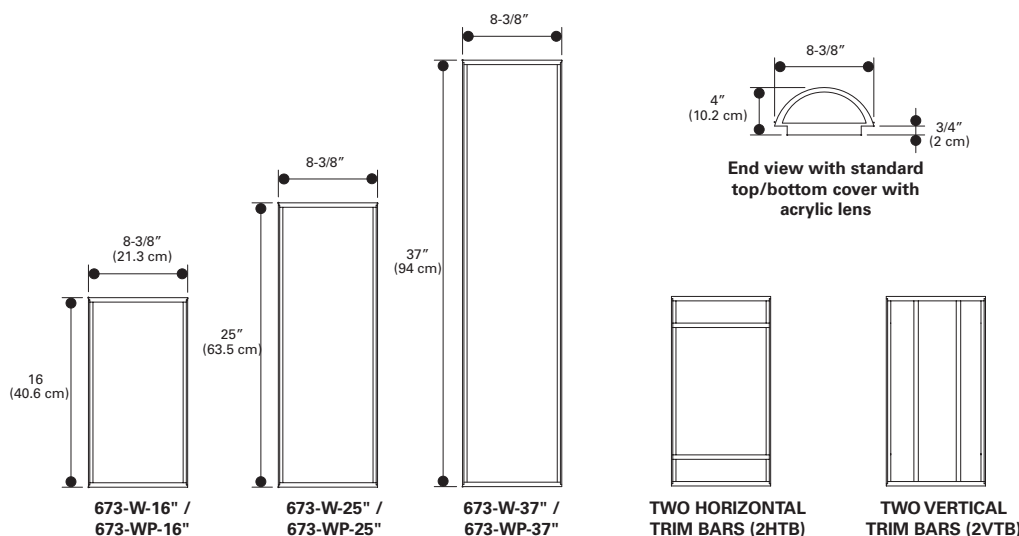

ORDERING INFORMATION

Sample Number: 673-16-W-L3/827-UNV-ALP-RBP

Series	Size	Mounting Type	LED Lamp			LED Voltage	Finish	Options
			16"	25"	37"			
673 = Luminous Half Cylinder	16=16" 25=25" 37=37"	W = Interior Wall WP = Exterior Wall	L3/827	L3/827	L4/827	UNV = (120-277V)	ALP=Aluminum Paint MW=Matte White MB =Matte Black DP = Dark Platinum GRM=Graphite Metallic BM=Bronze Metallic CC =Custom Color - Contact factory for quotation	2VTB=Two Vertical Trim Bars 2HTB=Two Horizontal Trim Bars 2VTB/2HTB=Two Vertical Trim Bars/ Two Horizontal Trim Bars 2VTB/PC=Two Vertical Trim Bars with Perforated Center BC = Closed Bottom Cover RBP =Remote Battery Pack
			L3/830	L3/830	L4/830			
			L3/835	L3/835	L4/835			
			L3/840	L3/840	L4/840			