

Shaper

DESCRIPTION

673-W and 673-WP Luminous wall sconce features 6 standard finishes, 3 decorative trim bar options and is ADA compliant.

- Wall Luminous Vanity Luminaire
- Painted solid aluminum w/ extruded white acrylic panel
- Universal circular strap for a standard 4" J-box or plaster ring
- UL and CUL approved for interior and damp locations

Catalog #		Type
Project		
Comments		Date
Prepared by		

SPECIFICATION FEATURES

Material

Painted or plated solid aluminum with a 1/8" matte white extruded acrylic panel, open top and bottom end caps, with acrylic inserts. Luminous top and bottom for LED.

Finishes

ALP (Aluminum Paint)
 MW (Matte White)
 MB (Matte Black)
 GRM (Graphite Metallic)
 DP (Dark Platinum)
 BM (Bronze Metallic)
 CC (Custom Color - Specify)

For Custom Color contact factory for quotation.

LED

16": L3:2000 nominal lumens at max 20W
 25": L3:2000 nominal lumens at max 20W
 37": L4:3000 nominal lumens at max 29W

Driver

LED system coupled with electronic driver to deliver optimal performance. Electronic drivers are available for 120-277V applications. A 0-10V dimming control is standard on all models. Standard integral class 2 driver 29W max., 0-10V dimming.

Installation

Supplied with a universal circle strap for a standard 4" J-box or round or octagonal plaster ring.

Horizontal or vertical mount. Shaper 673-W luminaires are designed for interior installations only. Shaper 673-WP are listed for wet location. Battery must be remote mounted in an interior location at a 5ft max distance.

Compliance

Shaper 673-W is U.L. and C.U.L approved for indoor and damp location. Shaper 673-WP is listed for wet location. ADA compliant, except with proud trim options. Options to meet Buy American Act requirements

Warranty

5 year limited warranty on LED components.



673-W SERIES 673-WP SERIES

Height: 16"

- Lumen Output Source Lumens: L3:2000
- Wattage: 20W
- Color Rendering: CRI 83+
- Correlated Color Temperature: 4000K, 3500K, 3000K, 2700K
- Rated Life of Lamp (hrs): 50,000
- Dimming: 0-10V

Height: 25"

- Lumen Output Source Lumens: L3:2000
- Wattage: 20W
- Color Rendering: CRI 83+
- Correlated Color Temperature: 4000K, 3500K, 3000K, 2700K
- Rated Life of Lamp (hrs): 50,000
- Dimming: 0-10V

Height: 37"

- Lumen Output Source Lumens: L4:3000
- Wattage: 29W
- Color Rendering: CRI 83+
- Correlated Color Temperature: 4000K, 3500K, 3000K, 2700K
- Rated Life of Lamp (hrs): 50,000
- Dimming: 0-10V



DIMENSIONS

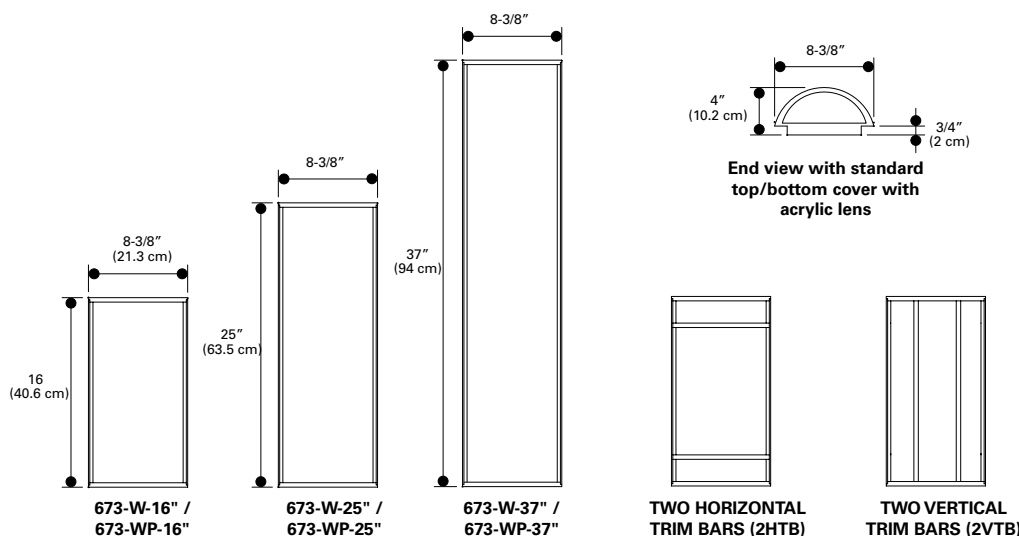

ORDERING INFORMATION

Sample Number: 673-16-W-L3/827-UNV-ALP-RBP

Domestic Preferences ⁽¹⁾	Series	Size	Mounting Type	LED Lamp			LED Voltage	Finish	Options
[Blank]=Standard BAA = Buy American Act	673 = Luminous Half Cylinder	16=16" 25=25" 37=37"	W = Interior Wall WP = Exterior Wall	16" L3/827 L3/830 L3/835 L3/840	25" L3/827 L3/830 L3/835 L3/840	37" L4/827 L4/830 L4/835 L4/840	UNV = (120-277V)	ALP=Aluminum Paint MW=Matte White MB=Matte Black DP = Dark Platinum GRM=Graphite Metallic BM=Bronze Metallic CC =Custom Color - Contact factory for quotation	2VTB=Two Vertical Trim Bars 2HTB=Two Horizontal Trim Bars 2VTB/2HTB=Two Vertical Trim Bars/ Two Horizontal Trim Bars 2VTB/PC=Two Vertical Trim Bars with Perforated Center BC = Closed Bottom Cover RBP =Remote Battery Pack

Notes (1) Only product configurations with this designated prefix are built to be compliant with the Buy American Act of 1933 (BAA). Please refer to [DOMESTIC PREFERENCES](#) website for more information. Components shipped separately may be separately analyzed under domestic preference requirements.



Cooper Lighting Solutions
 18001 E. Colfax Avenue
 Aurora, CO 80011
 P: 303-393-5122
 www.cooperlighting.com

Specifications and dimensions subject to change without notice.

673 SERIES WALL LUMINAIRE

PS525084EN

05-23-19

1 of 1