

Installation Instructions – Define Gen 2 Perimeter GYP/FSR S122-S125

⚠ WARNING

RISK OF ELECTRIC SHOCK—Disconnect power at fuse or circuit breaker before installing or servicing.

⚠ WARNING

Risk of fire/electric shock. If not qualified, consult an electrician.

⚠ WARNING

Risk of fire or electric shock. Fixture wiring, driver, or other electrical parts may be damaged during installation. Check enclosed wiring and components.

⚠ WARNING

RISK OF PERSONAL INJURY - Fixture may become damaged and/or unstable if not installed properly.

NOTE: This product must be installed in accordance with the applicable installation code by a certified electrician familiar with the construction and operation of the product and hazards involved.

NOTE: Only those open holes indicated in the photographs and/or drawings may be made or altered as a result of kit installation. Do not leave any other open holes in an enclosure of wiring or electrical components.

NOTE: To prevent wiring damage or abrasion, do not expose wiring to edges of sheet metal or any sharp objects.

NOTE: Disconnect all power before proceeding.

Installation Instructions

Define Series (2" - 5" Housing Size)

Individual and Continuous Luminaires - Perimeter Installation

For Installation in Gypsum Ceilings

MUST BE INSTALLED BEFORE COMPLETION OF CEILING!



Before starting any work, ensure that all power sources are turned off. All work must meet local/national electrical codes and be performed by a certified electrician.

Parts List

- Luminaire
- Grid Bracket/Joiner (pre-installed in fixture)
- Access Plate (pre-installed in remote enclosure)
- Support Wire/Threaded Rod (by others)
- Shielded Cable (by others)
- J-rail
- Lens Removal Tool
- Push-in Quick Connects or Wire Nuts
- Alignment Pins (pre-installed in fixture) (Continuous runs only)
- #8-18 3/4" T10 Torx Head Screws (Continuous runs only)
- 9/64" Allen Wrench (by others)
- 11/32" Flexible Nut Driver (by others)
- T10 Torx Driver (by others, continuous runs only)
- #2 Phillips Screw Driver (by others)

Cross Section

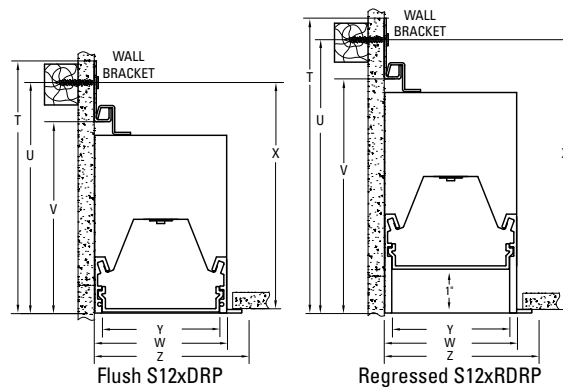

Spacing Details

Perimeter GRID	T	U	V	W	X	Y	Z
Fixture Type	TOP OF J-RAIL TO BOTTOM OF FIXTURE	MOUNTING HOLE LOCATION TO BOTTOM OF FIXTURE	BOTTOM OF J-RAIL TO BOTTOM OF FIXTURE	FIXTURE WIDTH	MOUNTING HOLE LOCATION TO CEILING FACE (CRITICAL)	APERTURE SIZE	CUTOUT WIDTH
Flush Installation							
Define 1	3.109	2.922	2.047	1.500"	2.892	1.180"	1.625"
Define 2	4.864	4.677	3.802	2.000"	4.647	1.680"	2.125"
Define 3	5.314	5.127	4.252	3.000"	5.097	2.680"	3.125"
Define 4	5.814	5.627	4.752	4.000"	5.597	3.680"	4.125"
Define 5	6.314	6.127	5.252	5.000"	6.097	4.680"	5.125"
Regressed Installation							
Define 1	4.109	3.922	3.047	1.500"	3.892	1.180"	1.625"
Define 2	5.864	5.677	4.802	2.000"	5.647	1.680"	2.125"
Define 3	6.314	6.127	5.252	3.000"	6.097	2.680"	3.125"
Define 4	6.814	6.627	5.752	4.000"	6.597	3.680"	4.125"
Define 5	7.314	7.127	6.252	5.000"	7.097	4.680"	5.125"

Mounting Information - Extruded Trim Flange Details - Refer to submittal drawings for detailed flange information

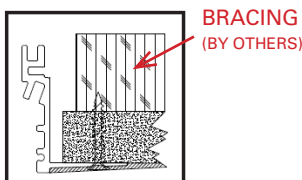

FSR
"Flangeless"
Gypsum Board

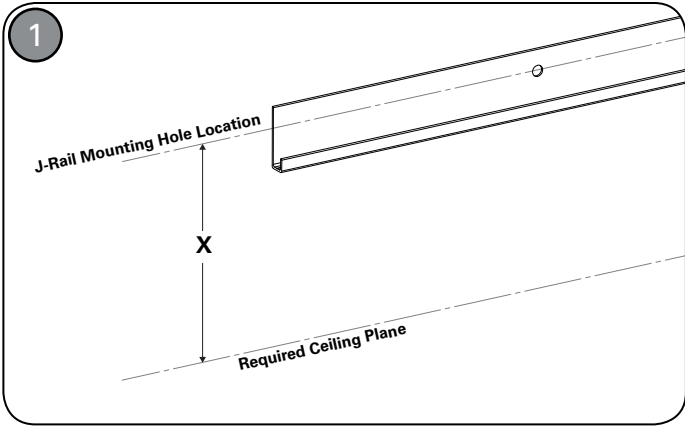

Mark wall at desired location for mounting J-rail. Use dimension "X" as shown on table of page 1 for locating the correct ceiling to mounting hole location. Using J-rail as a template, mark hole locations along wall for pre-drilling where needed. Secure J-rail to wall. Hardware, bracing, and other structural support for J-rail to be supplied and installed by contractor as needed. J-rail hole diameter is 1/4" so #12 screws recommended.

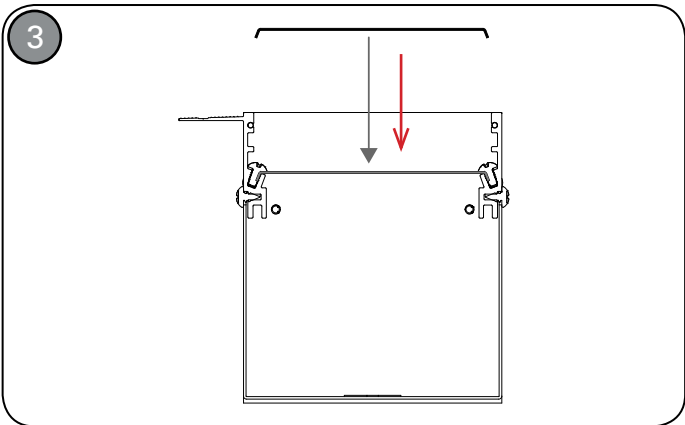

Remove 1/4" knockouts to line up with threaded rods. FOR FSR ONLY: Using (2) 8-32 screws from the LED tray assembly, install aperture guide snugly to ensure housing opening does not open or close during installation. NOTE: This will be removed prior to reinstalling the lens.

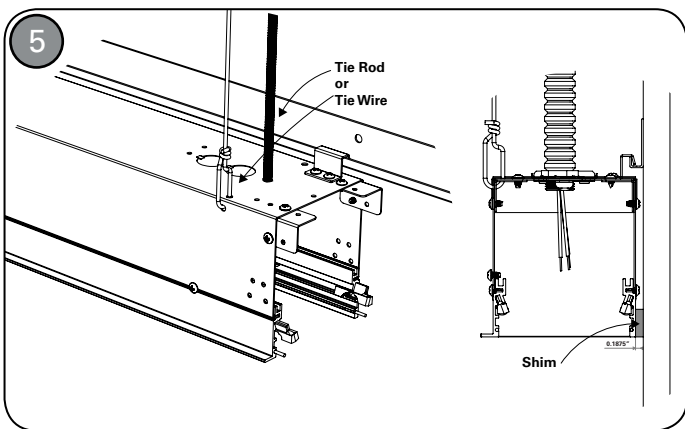

Secure fixture to structure via tie wire or 1/4" tie rod and nut as required. Note: If desired or required, J-rail allows for up to 3/16" adjustment. Fixture can be shimmed for a shadow reveal effect if desired. Standard mounting is flush against wall.

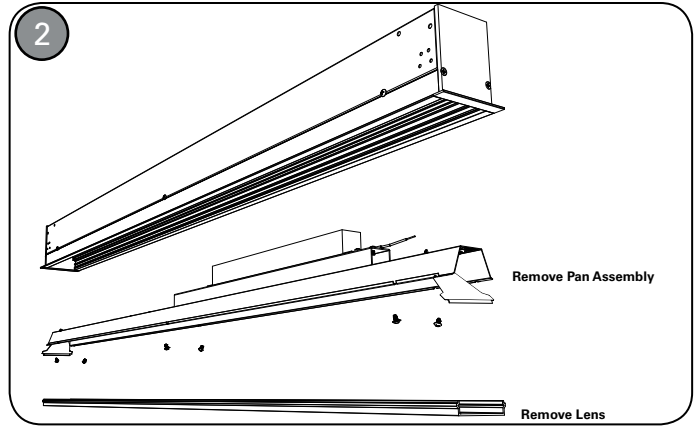

Prior to installing fixture: Remove top access plate. Turn fixture over and remove lens using lens removal tool per lens instruction provided. Remove screws and carefully lift LED tray assembly from housing frame. Disconnect wire-harness quick connects and store pan assembly in a safe place. Lens diffusers do not need to be removed from pan assembly. Repeat for each LED Tray.

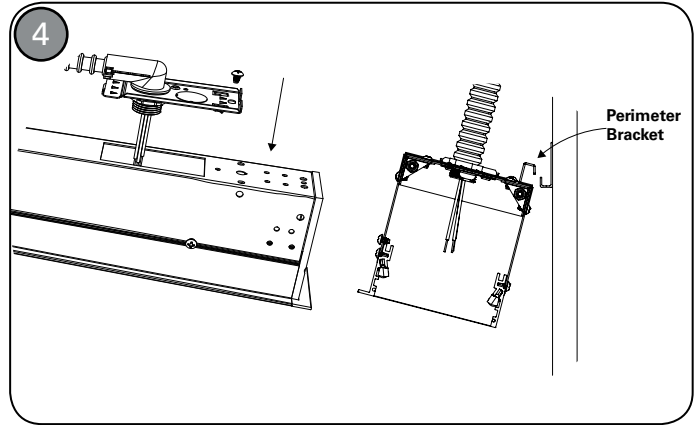

Secure shielded cable to access plate. Reinstall access plate pulling wiring through housing. Lift fixture onto J-rail via perimeter brackets on side of fixture.

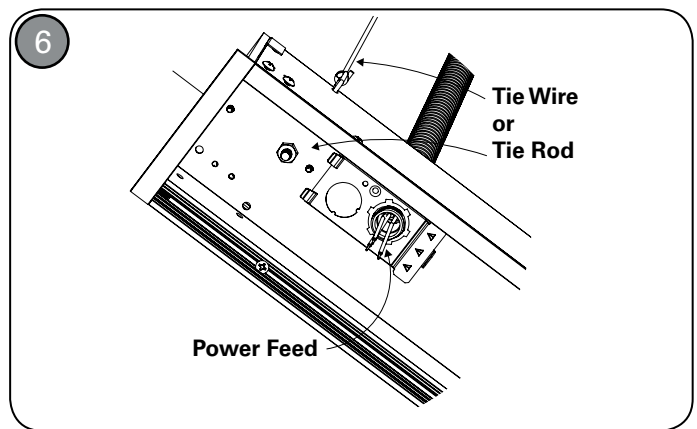

Wiring should enter fixture housing as shown. Ties rods extend into housing and are secured with nuts. Tie wires can be looped through holes in top of housing if used instead of tie rods.

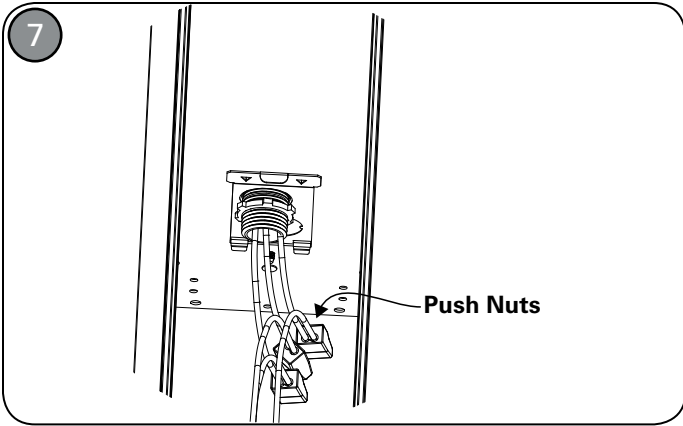

Connect feed wiring to fixture through wiring via push-in quick connects or wire nuts.

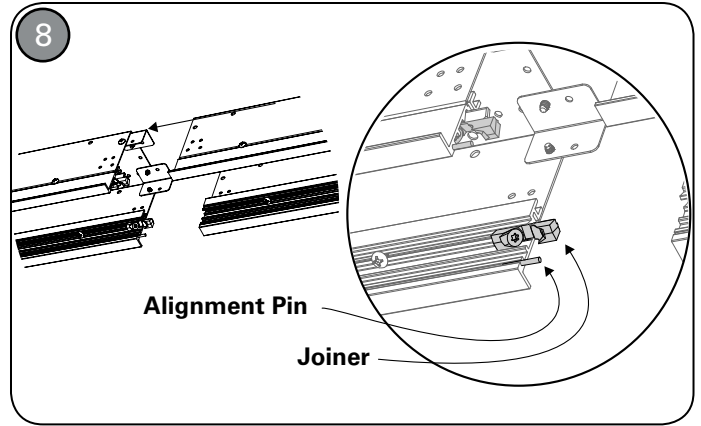

FOR CONTINUOUS ROWS: Repeat step 2 (and 3 for FSR) to prepare fixture. Slide fixtures together ensuring alignment pins are in the correct position.

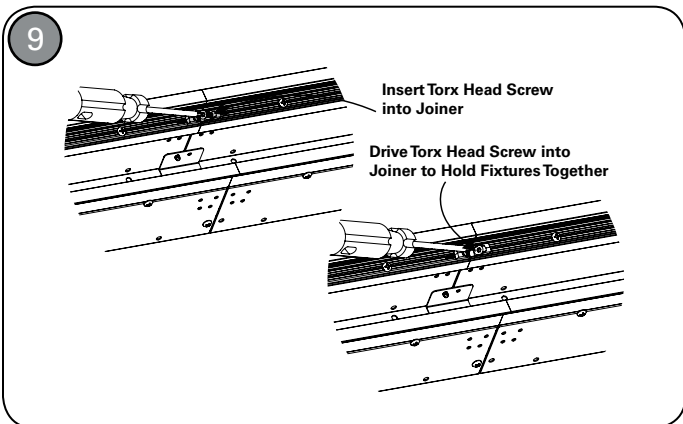

FOR CONTINUOUS ROWS: Insert torx head into joiner and drive screw into housing to hold fixtures together. Ensure there are no gaps between fixtures and joint is secure.

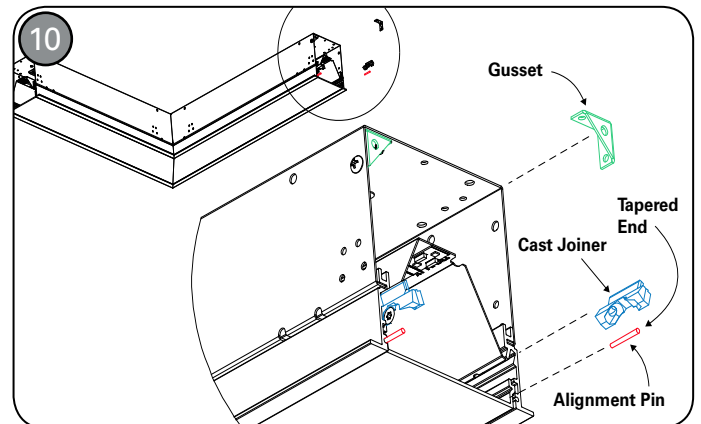

FOR CORNER INSTALLATION: Prepare corner unit for installation. Identify power feed side (end toward Beginning of Run). Prep wires on power feed side for connection to previous section in the run / pattern. Add Joining Hardware. Install alignment pins with tapered side facing outward. Install gussets with provided screws. Install cast joiner brackets using provided screw. Note that for sections with a corner at each end, it may be necessary to install the alignment pins on the last fixture such that there is only 1/8" of the pin exposed or by removing the pins entirely.

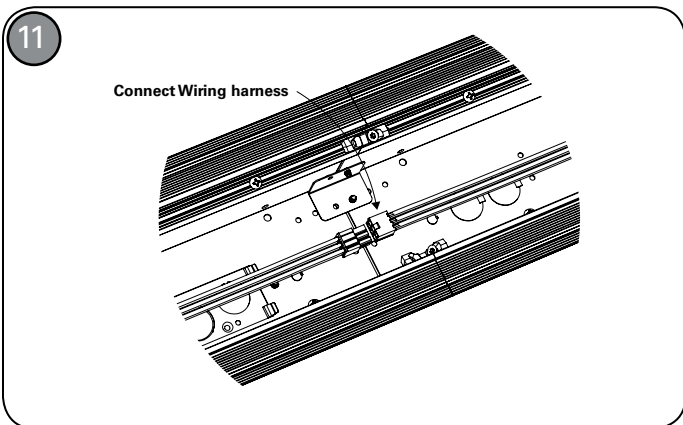

Make appropriate wire connections between fixture housings using provided connectors.

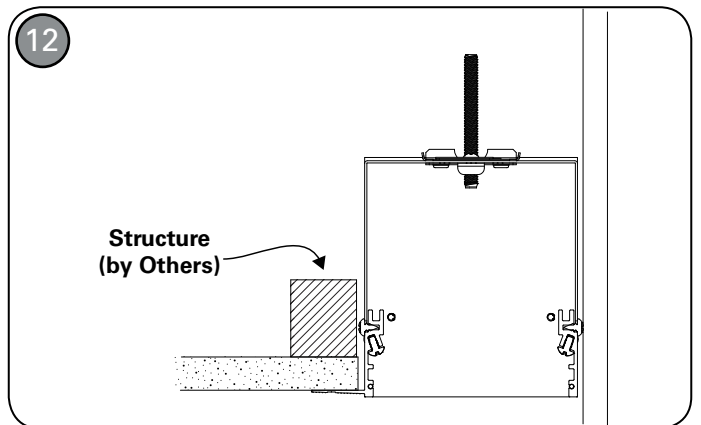

Install blocking (FSR); gypsum board to meet fixture flange as required.

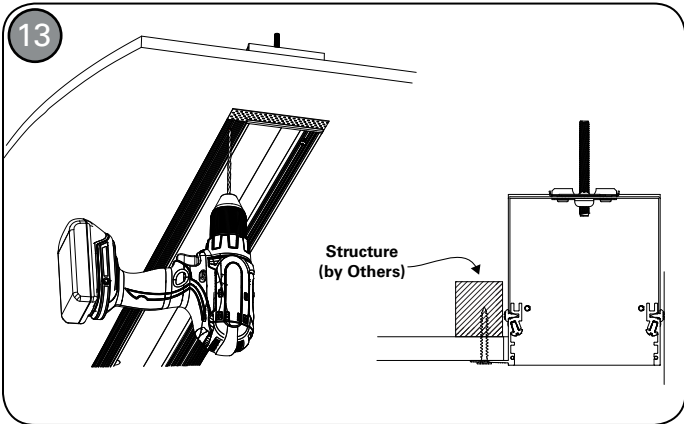

FOR FSR ONLY: Drive screws (provided by others) through fixture flange into structure as shown. Size and length of screws determined by local building code.

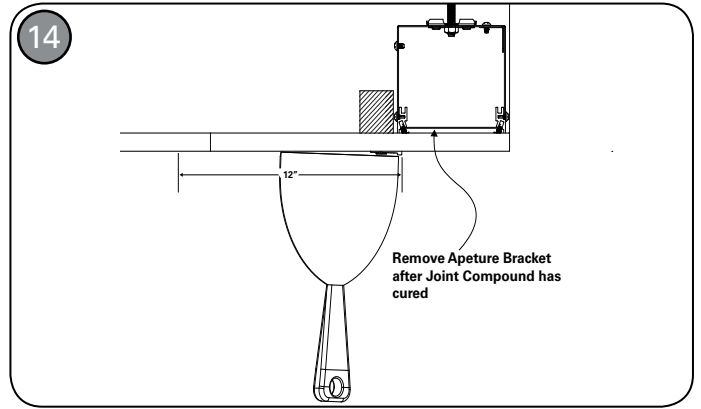

FOR FSR ONLY: Apply a generous amount of joint compound to fixture flange and "feather" at least 12" from fixture aperture. Ensure compound has properly cured before removing aperture bracket.

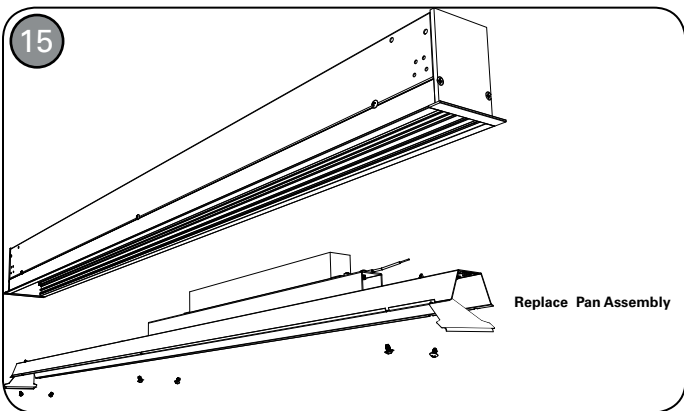

With fixture securely secured in opening, reconnect the first tray assembly to the power feed. Carefully tuck all wiring back into fixture. Reinstall screws to secure tray assembly back into housing. Continue reinstalling additional LED tray assemblies in the same manner using the quick disconnects pre-installed on the LED tray.

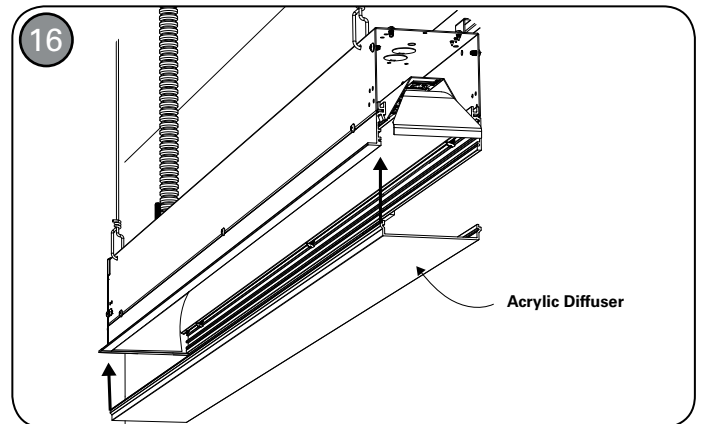

Reinstall acrylic diffuser by squeezing one end, inserting that end into the fixture opening and slowly pressing the diffuser into the housing along the length of the lens until it snaps into place. For continuous runs, ensure seams of adjacent lenses are touching to avoid light leak. Diffuser film should not require re-installation, however, if required, insert tabs into the slots of the LED tray assembly with the shiny side facing toward the LED array.

Installation is complete.

Lens Removal

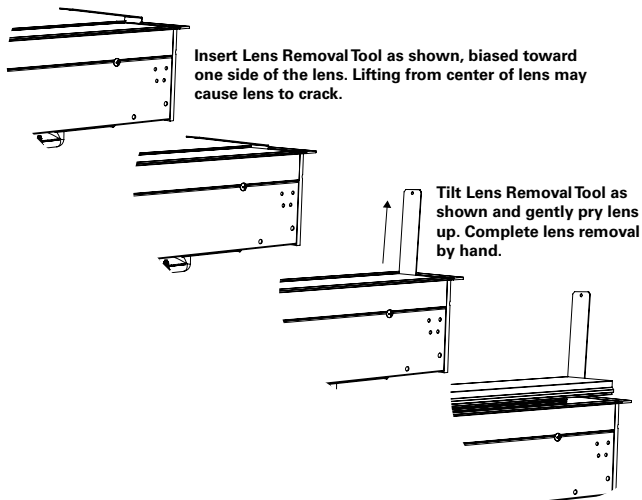

Insert Lens Removal Tool as shown, biased toward one side of the lens. Lifting from center of lens may cause lens to crack.

Tilt Lens Removal Tool as shown and gently pry lens up. Complete lens removal by hand.

Warranties and Limitation of Liability

Please refer to www.cooperlighting.com for our terms and conditions.

Garanties et limitation de responsabilité

Veuillez consulter le site www.cooperlighting.com pour obtenir les conditions générales.

Garantías y Limitación de Responsabilidad

Visite www.cooperlighting.com para conocer nuestros términos y condiciones.

Cooper Lighting Solutions
1121 Highway 74 South
Peachtree City, GA 30269
P: 770-486-4800
www.cooperlighting.com

© 2020 Cooper Lighting Solutions
All Rights Reserved
Printed in USA
Imprimé aux États-Unis
Impreso en los EE. UU.
Publication No. IL519031EN
August 22, 2019

Cooper Lighting Solutions is a registered trademark. All trademarks are property of their respective owners.

Cooper Lighting Solutions est une marque de commerce déposée. Toutes les autres marques de commerce sont la propriété de leur propriétaire respectif.

Cooper Lighting Solutions es una marca comercial registrada. Todas las marcas comerciales son propiedad de sus respectivos propietarios.

Product availability, specifications, and compliances are subject to change without notice

La disponibilité du produit, les spécifications et les conformités peuvent être modifiées sans préavis

La disponibilidad de productos, las especificaciones y los cumplimientos están sujetos a cambio sin previo aviso