

Metalux RBG

Narrow Lines of Light





Lengths

2'

4'

8'

Shallow plenum linear family with Lumen and CCT select

4" aperture, 6" grid width providing sleek lines of light

Simple switch to adjust color on site as desired

Simple switch to set lumens and watts as needed for the task

Switch tamper cover included

High performance efficacy up to 115 lm/W

Flexible – recessed, drywall, surface and suspension mount

Integrated sensors with IoT Connectivity

RBG Architectural | Shallow Plenum | Linear

The **RBG** is an elegant 4 inch aperture fixture family designed to please architects, engineers, contractors and designers. Available in three fixed lengths, RBG can be recessed, surface or suspension mounted and strategically placed throughout the space to create pleasing illumination and appealing topology in rows or individual placement. A selectable switch comes standard with three selectable lumen levels and three selectable color temperatures, providing RBG the flexibility to adapt to the changing needs of the space, setting, or environment. Customer applications include open and traditional offices, classrooms, coves, corridors, retail or anywhere stylish lines of light are desired.

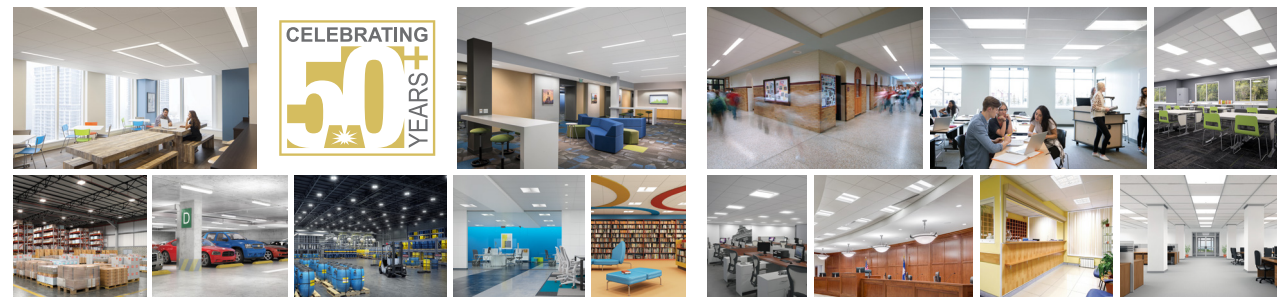

Certifications



Features





CCT | Lumen Select

RBG is stocked with CCT and Lumen select providing designers, contractors, engineers and end users with the ultimate control of their space. RBG is capable of changing between multiple color temperatures and lumens with the simple slide of a switch. If desired, "locking" lumens/watts and CCT settings can occur via a tamper resistant cover (included).



Lumen and CCT switches



Understanding Lumens

Toggle between preset lumen outputs to choose the right light output creating your optimal lighting experience. Lumens per foot can be set to 500, 750 or 1000 for each length to match.

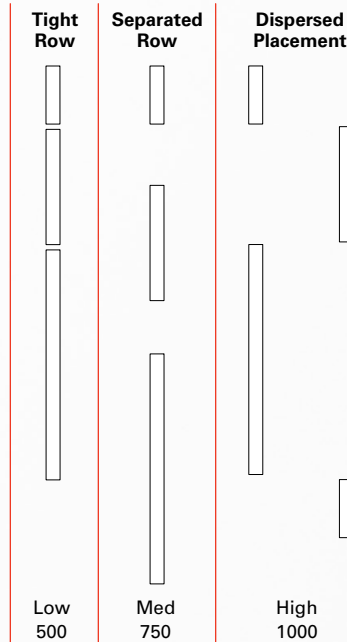
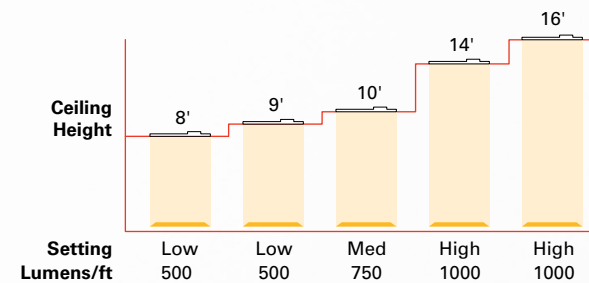

Understanding Color Temperature

SeleCCTable technology puts flexibility at your fingertips. By using switches located on the driver, users can choose from three color temperatures 3000K, 3500K and 4000K. Easily adapt to changes in paint, floor or furniture finish with a simple switch adjustment.

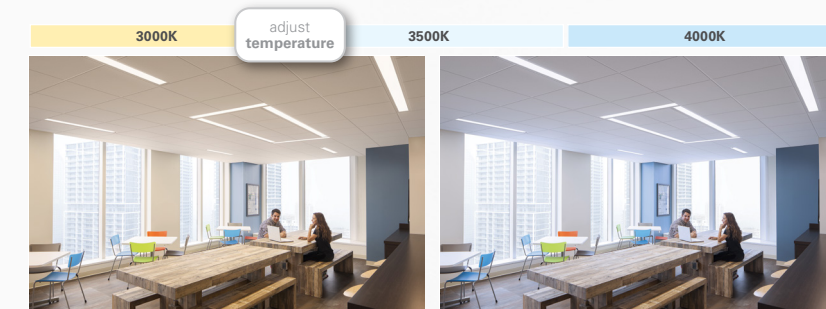



Product Features

Construction

Aperture/Grid: 4 inch nominal aperture w/ 6 inch grid spacing w/acrylic light guide, aluminum frame and matte white paint after fab finish

Surface/Suspension and drywall frame kits optimized for use in many spaces

Large external switches to adjust lumens and/or color before or after installation. Cover kit included for optional "lock out"

Flex with 90 degree connector enables shallow row mounting and labor savings with single feed per row

Optimized for shallow plenum spaces

Aluminum frame with matte white paint after fabrication standard

Built for speed, labor saving features such as quick disconnects and sized to fit common grid spacing with multiple KOs

IP40 rating - tightly sealed lens with no gaps to prevent bug or debris

Driver shown mounted on 2 ft.

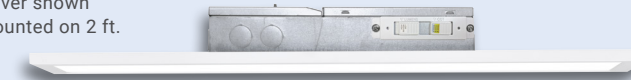

Performance

IC rated with high performance efficacy up to 115 lumens per watt

Energy savings more than 50% compared to traditional sources

0-10V dimming to 10% standard

DLC listings at all three lumen/watt settings to enable maximum rebates based on watt reductions

TM21 life >L89@ 60,000 hours

80+ CRI

Options

Integrated Wavelinx, LumaWatt Pro, DLVP, and SVPD connected lighting options available

Emergency – EL7W and EL14W

Lutron and DALI 2.0 control options

Universal (120V – 277V) or 347V or Low Voltage with DLVP system

Ultra-thin profile
(shown at actual size)

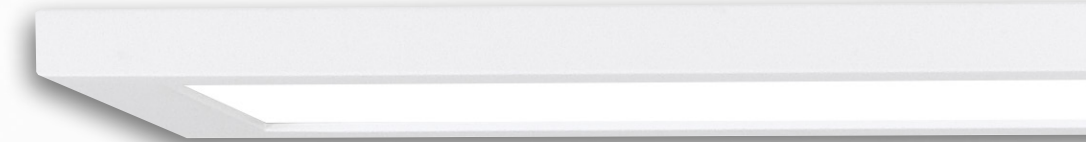



Maximize valuable space - Configure 27 options with only 3 SKUs

Energy and Performance

Catalog No.	Size	CCT	Lumen Output			Wattage			Efficacy		
			Lumen Setting			Lumen Setting			Lumen Setting		
			Low	Medium	High	Low	Medium	High	Low	Medium	High
2RBG6-SL1-L8SCT3	2FT	3000	1176	1722	2031	10.9	16.1	19.4	107.9	107	104.7
		3500	1207	1763	2090	10.8	16.1	19.4	111.8	109.5	107.7
		4000	1223	1790	2107	10.8	16	19.4	113.2	111.9	108.6
4RBG6-SL1-L8SCT3	4FT	3000	2203	3258	4100	18.3	27.6	36.1	120.4	118	113.6
		3500	2241	3315	4147	18.3	27.7	36.1	122.5	119.7	114.9
		4000	2262	3339	4195	18.2	27.5	35.9	124.3	121.4	116.9
8RBG6-SL1-L8SCT3	8FT	3000	4704	6888	8124	41.7	62.1	74.8	112.8	110.9	108.7
		3500	4828	7052	8360	41.4	62.1	74.8	116.6	113.5	111.8
		4000	4892	7160	8428	41.4	62.1	74.8	118.1	115.3	112.7

Note: DLC listings are separate for each selection.

Lumen Maintenance

Size	Ambient Temperature	TM-21 Lumen Maintenance (60,000 hours)	Theoretical L70 (hours)
2' 4'	25°C	90%	200,000
8'	25°C	89%	175,000

Load Data (Stock Products)

	2'	4'	8'
Thd	< 20%		
Power Factor	> .9		
Weight (lbs.)	3.8	6.6	15
Low Temp. Start	-20°C		

Architectural Linear LED

Lines of Light

Click on products to learn more



		Metalux RBG	Metalux RCG	Metalux SkyRidge Single	Corelite CL	Neo-Ray Define Standard	Neo-Ray Define Premium
APPLICABILITY¹	Office	★★	★★	★★	★★	★★★	★★★
	Secondary Education	★★	★★	★★	★★	★★★	★★
	Primary Education	★★★	★★★	★	★★★	★★	★
	Healthcare	★★	★	★★	★	★★	★★★
	Tenant Improvement	★★★	★★★	★★★	★★★	★★	★
FEATURES / PERFORMANCE	Apertures	4"	3"	Luminous Blade	2", 4"	1.5", 2", 3", 4", 5"	1.5", 2", 3", 4", 5"
	Sizes	Fixed 2', 4', 8'	4', 8'	2', 4'	4', 8' + Continuous Runs	2'-12' + Continuous Runs	2'-12' + Continuous Runs
	Length Resolution	Fixed	Fixed	2' Increments	4' Increments	1" Increments	1" Increments
	Installation Type	Ceiling, Wall	Ceiling	Ceiling, Wall	Ceiling	Ceiling, Wall, Perimeter	Ceiling, Wall, Perimeter
	Configuration Geometry	Straight	Straight	Straight	Straight	Straight, Corners, Intersection	Straight, Corners, Intersection
	Compatible Family Fixtures	Surface/Susp & Drywall Kits	N/A	N/A	N/A	Suspended, Surface, Wall	Suspended, Surface, Wall
	lm/W (Max)	115	121	151	124	127	141
	Lms/ft (Max)	1,000	1,000	1,625	1,200	1,400	1,500
	Standard Lumen Levels	3	4	4	5	5 + Custom	5 + Custom
	Lens	Flush Frosted	Flush Frosted, Asymmetric	Wavestream	Flush Frosted, Asymmetric	Flush & Drop Frosted, Asymmetric, Louver	Flush & Drop Frosted, Asymmetric, Louver
	Emergency	Integrated, Remote Switch	Integrated	Integrated	Integrated	Integrated	Integrated
	CRI	80+	80 Standard, 90 Optional	80 Standard	80 Standard, 90 Optional	80 Standard, 90 Optional	80 Standard, 90 Optional
	Ceiling Integration / Flange Type	Standard T-Grid, Gypsum	Standard T-Grid, Gypsum	Standard T-Grid, Gypsum	6 Common Architectural Systems	>12 Architectural Ceiling Systems	>12 Architectural Ceiling Systems
DLC	Standard	Standard	Standard & Premium	Standard	Standard & Premium	Standard & Premium	
INTEGRATED CONTROLS	WaveLinx, Enlighted, DLVP, Stand Alone	Integrated or Tile Mount	Integrated	Tile Mount	Integrated	Integrated or Tile Mount	Integrated or Tile Mount
	Integral Downlights	N/A	N/A	N/A	N/A	Optional Fixed or Adjustable	Optional Fixed or Adjustable
	White Tuning	N/A	N/A	N/A	N/A	N/A	Available

Notes: 1. ★★★ = high applicability, ★★ = medium applicability, ★ = low applicability, blank = non-applicable

Connected Lighting Systems



WaveLinx

Wireless Connected Lighting System

Adjustable occupancy sensing and daylight dimming control

Simple, secure wireless connectivity with out-of-the-box code compliance

Easy to use mobile application allows for fast set up and unlocks advanced control capabilities

Detection pattern covers standard ceiling applications up to 12 feet

Take compliance, network security, and energy savings into your own hands

Automatic code compliance. Seven tiers of information security features. Integrated wireless sensors to collect and transmit key building data. Control your system from a mobile app. It's simple: WaveLinx just works.



Connected Systems

Enlighted

Wireless Connected Lighting System

Configurable dimming, occupancy, light, temperature and power use sensing

Enterprise-class wireless networking with fully addressable settings

Powerful software for energy management and Internet of Things (IoT) data capture and analytics

Low bay detection pattern covers low- and high-ceiling applications up to 20 feet

A lighting system that transforms into an enterprise network

Enlighted is the connected lighting solution that combines a broad selection of energy-efficient LED luminaires with a powerful wireless sensor system. The sensor controls the lighting system in compliance with the latest energy codes and collects valuable data about building performance and use.

Lighting Brands

Ametrix
AtLite
Corelite
Ephesus
Fail-Safe
Halo
Halo Commercial
Invue
io
Iris
Lumark
Lumière
McGraw-Edison
Metalux
MWS
Neo-Ray
Portfolio
RSA
Shaper
Streetworks
Sure-Lites

Controls Brands

Greengate
Fifth Light

Connected Lighting Systems

HALO Home
WaveLinx

IoT Platform

Trellix

Cooper Lighting Solutions

1121 Highway 74 South
Peachtree City, GA 30269
P: 770-486-4800
www.cooperlighting.com

Canada Sales
5925 McLaughlin Road
Mississauga, Ontario L5R 1B8
P: 905-501-3000
F: 905-501-3172



Cooper Lighting Solutions is a registered trademark.

All other trademarks are property of their respective owners.

Product availability, specifications, and compliances are subject to change without notice.

© 2020 Cooper Lighting Solutions
All Rights Reserved
Printed in USA
Publication No. BR519048EN
January 27, 2021 11:57 AM