

DESCRIPTION

Lanterra 9004-W1 (Up or Down) and 9004-W2 (Up and Down) are 4.25" O.D., line voltage cylinder fixtures with dimmable LED. The luminaire comes in various mountings, surface mount with integral driver in the housing, remote driver mount with round and square wall plates and square wall integral driver, all of which can be mounted over standard 4 inch j-box. The luminaire also comes with various field replaceable optics and premium color tuning option. It also comes with various lens, louvers and colors or dichroic filters, which can combine up to two at once to create multiple lighting effects. The fixture may be used indoors or outdoors and carries IP66 rating.

SPECIFICATION FEATURES

Material

Housing, hood and mounting stem are precision-machined from corrosion resistant billet stock 6061-T6 aluminum.

Finish

Fixtures constructed from 6061-T6 aluminum are double protected by an ROHS complaint chemical film undercoating and polyester powder coat paint finish, surpassing the rigorous demands of the outdoor environment. A variety of standard colors are available.

Hood

Hood is removable and accepts up to two internal accessories at once (lenses, louvers and filters) to achieve multiple lighting effects. Weep holes prevents water and mineral stains from collecting on the lens, even in the straight up position. The flush lens design reduces fixture length, minimizes debris collection and prevents water and mineral stains from collecting on the lens.

DIMENSIONS

9004-W1-RW

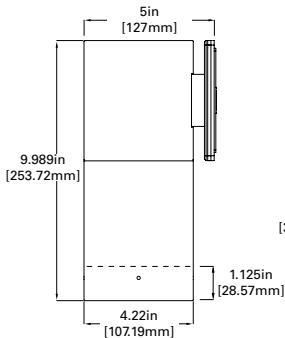

9004-W2-RW

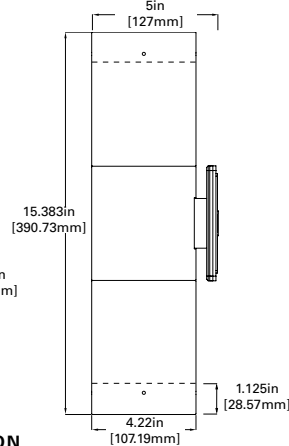

9004-W1-FL

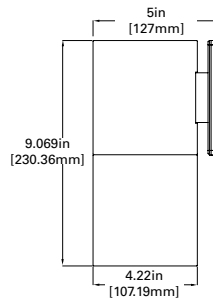

9004-W2-FL

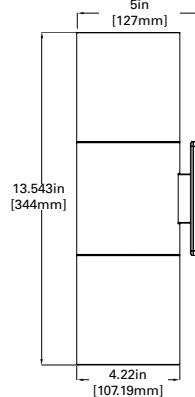

ORDERING INFORMATION

DOMESTIC PREFERENCES ⁹	SERIES	DIRECTION	HOOD	LED CCT & CRI	FIELD REPLACEABLE OPTIC 1	FIELD REPLACEABLE OPTIC 2 ⁷	FINISH	LIGHT LEVEL	VOLTAGE	MOUNTING	OPTIONS
[Blank]=Standard BAA=Buy American Act	9004	W1 Up or Down W2 ⁵ Up and Down	RW Standard-Recessed Lens with weep holes - Outdoor RI Recessed Lens with no weep holes - Indoor FL Flush lens hood	Standard CRI LED2790 - 2700K, 90 CRI LED 3090 - 3000K, 90 CRI LED 3590 - 3500K, 90 CRI LED 4080 - 4000K, 80 CRI LED 5080 - 5000K, 80 CRI Premium CRI LED 2797 - 2700K, 97 CRI LED 3097 - 3000K, 97 CRI LED 3597 - 3500K, 97 CRI LED 4097 - 4000K, 97 CRI	S Spot M Medium F Flood W Wide Flood	S Spot M Medium F Flood W Wide Flood	Standard Paint Finish BK Black BZ Bronze CS City WT Silver White	L1 Light Level 1 (10W) L2 Light Level 2 (20W) LC1 Light Level 3 (30W) LC2 Light Level Color 1 (12W) Light Level Color 2 (20W)	UNV 120-277V	Surface Mount - Wall, Ceiling, Ground RSM Round Surface Mount- mounts directly to junction box Thermal Limitations (unless otherwise noted 50C) 9004-W1-xxx-L3-xxx-WRx (45C) 9004-W2-xxx-L3-xxx-WRx (35C) 9004-W2-xxx-LC2-xxx-WRx (40C) Remote Driver Housing WRR ⁸ Remote Driver Housing - Round Wall Plate WRS ⁸ Remote Driver Housing - Square Wall Plate Thermal Limitations (unless otherwise noted 50C) 9004-W1-xxx-L3-xxx-WRx (45C) 9004-W2-xxx-L3-xxx-WRx (35C) 9004-W2-xxx-LC2-xxx-WRx (40C) Integral Driver Mount WIS ^{3,4} Wall Integral Driver Plate Thermal Limitations (unless otherwise noted 45C) 9004-(W1,W2)-xx-L1-xx-WIS (50C)	SVPD2 ⁵ Stand-alone integral sensor

Notes: 1. Order LC remote separately

2. Only available for double head option (W2)

3. 9004-W1 not available in LC2, L3

4. 9004-W2 not available in L2, L3, LC1 and LC2

5. Only available for Single head, Up or down (W1) with RSM only

6. W2 doubles input wattage listed

7. Only available for LEDCR

8. Remote Driver distance up to 60', For L3 (30W) remote distance up to 15'

9. Only product configurations with this designated prefix are built to be compliant with the Buy American Act of 1933 (BAA). Please refer to [DOMESTIC PREFERENCES](#) website for more information. Components shipped separately may be separately analyzed under domestic preference requirements.

10. Accessories sold separately will be separately analyzed under domestic preference requirements. Consult factory for further information.

Catalog #		Type
Project		
Comments		Date
Prepared by		

industry leading high output with 87% lumen maintenance at 60,000hrs.

Compliance

Components are UL recognized and luminaires are cULus listed for 50°C ambient environments unless noted otherwise, wet location listed, and ROHS compliant. IP66 Rated. Options to meet Buy American Act requirements

Warranty

Lumiere warrants the Lanterra series of fixtures against defects in material and workmanship for five (5) years. Auxiliary equipment such as LED drivers carries the original manufacturer's warranty.



Lanterra 9004

LED
INTERIOR / EXTERIOR
CYLINDER FLOOD LIGHT
CERTIFICATION DATA
cULus - 1598



Wet Location Listed - IP66
LM79/LM80 Compliant
ROHS Compliant

10W LED, L70/102,000@25° Celcius
20W LED, L70/102,000@25° Celcius
30W LED, L70/102,000@25° Celcius

ACCESSORIES - ORDER SEPARATELY

		ACCESSORIES ¹⁰			OPTICS	
LCTL1RZRT452L-PK	Light Comissioning Tool (LCT)	Filters		Lens	Louwer	LLR-S-3-4 15° Spot
ISHH01LUM	Programming Remote for sensor	F71-4 Peach Dichroic		LSL-4 Linear Spread Lens	LVR-4 45° Hex Cell Louwer	LLR-M-3-4 25° Medium
ISHH02LUM	Personal Control Remote for sensor	F72-4 Amber Dichroic		DIF-4 Diffused Lens		LLR-F-3-4 36° Flood
		F73-4 Green Dichroic		OSL-4 Overall Spread Lens		LLR-W-3-4 60° Wide Flood
		F74-4 Medium Blue				LLR-K-3-4 Spot, Medium, Flood, Wide Flood Optic Kit
		F75-4 Yellow Dichroic				
		F76-4 Red Dichroic				LLR-S-LC-3-4 20° Spot - Color tuning optic
		F77-4 Dark Blue Dichroic				LLR-M-LC-3-4 32° Medium - Color tuning optic
		F78-4 Light Blue Dichroic				LLR-F-LC-3-4 42° Flood - Color tuning optic
		F79-4 Neutral Density Dichroic				LLR-W-LC-3-4 56° Wide Flood - color tuning optic
		F80-4 Magenta Dichroic				LR-K-LC-3-4 Spot, Medium, Flood, Wide Flood Color tuning optic Kit
		F22-4 Red Color				
		F33-4 Blue Color				
		F44-4 Green Color				
		F55-4 Yellow Color				
		F66-4 Mercury Color				

MOUNTINGS

ROUND SURFACE MOUNT (RSM)

RSM-W1 (Up or down)

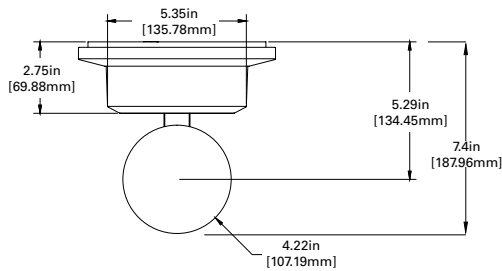

TOP VIEW

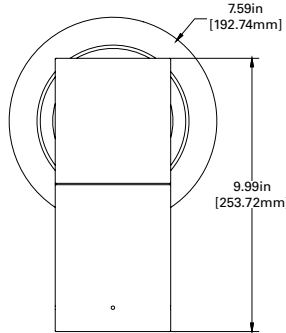

FRONT VIEW

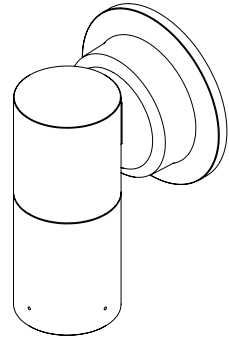

ISO VIEW

ROUND SURFACE MOUNT (RSM)

RSM-W2 (Up and down)

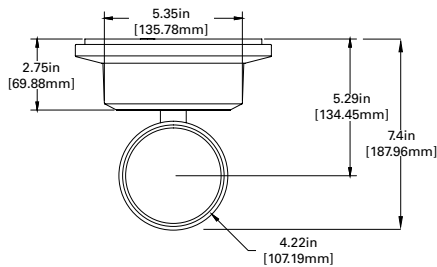

TOP VIEW

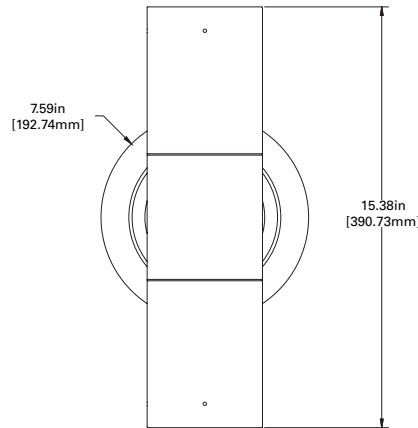

FRONT VIEW

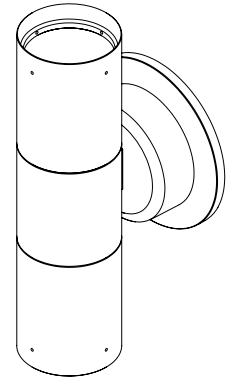

ISO VIEW

WALL INTEGRAL DRIVER PLATE (WIS)

WIS-W1 (Up or down)

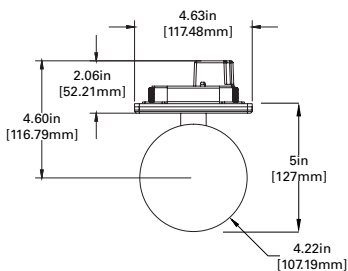

TOP VIEW

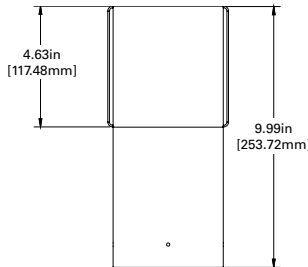

FRONT VIEW

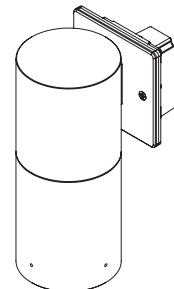

ISO VIEW

WALL INTEGRAL DRIVER PLATE (WIS)

WIS-W2 (Up and down)

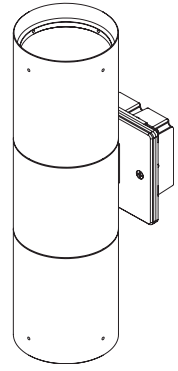
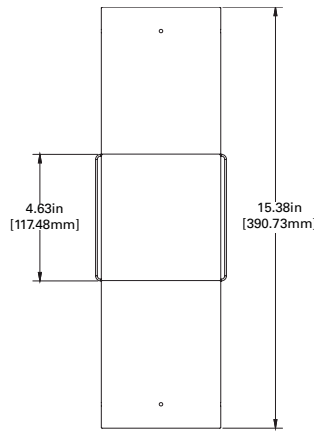
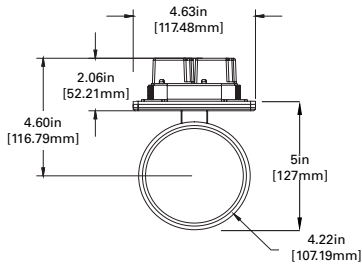

TOP VIEW

FRONT VIEW

ISO VIEW

REMOTE DRIVER HOUSING ROUND WALL (WRR)

**WRR-W1 (Up or down), as shown
WRS-W1 (Square option also available)**

TOP VIEW

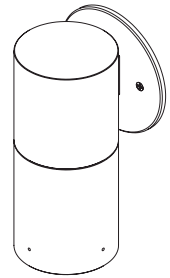
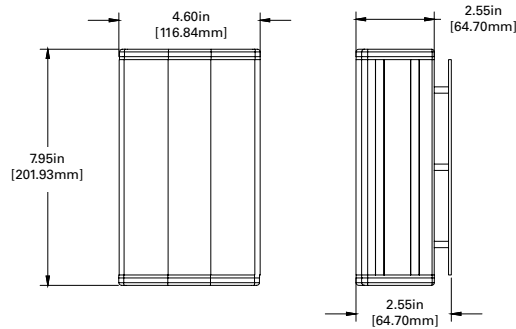
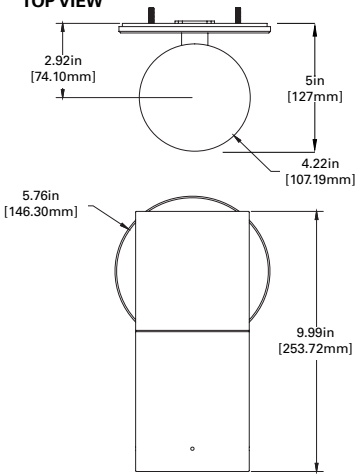

Remote Driver distance up to 60',
For L3 remote distance up to 15'

FRONT VIEW

REMOTE BOX

ISO VIEW

REMOTE DRIVER HOUSING ROUND WALL (WRR)

**WRR-W2 (Up and down)
WRS-W2 (Square option also available)**

TOP VIEW

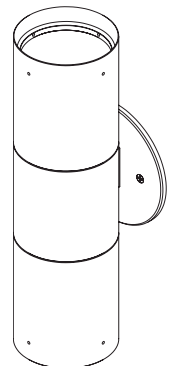
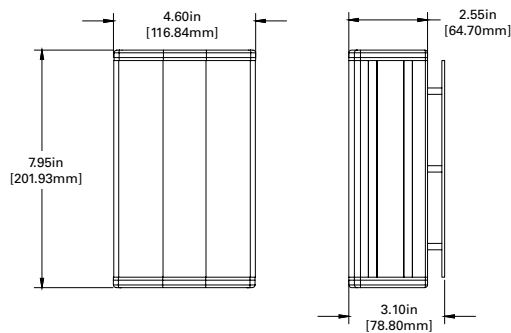
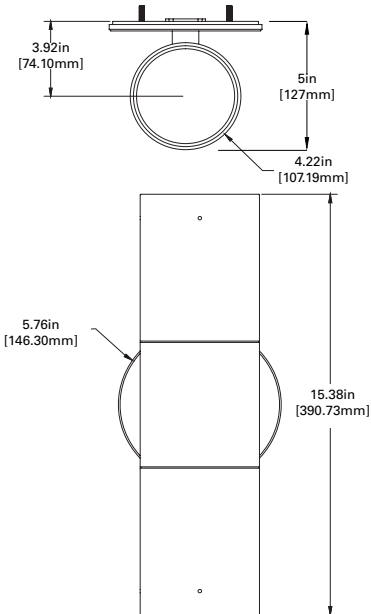

Remote Driver distance up to 60',
For L3 remote distance up to 15'

FRONT VIEW

REMOTE BOX

ISO VIEW

PHOTOMETRICS

Test Number	P29496
Lumcat	9004-[W1]-X-FL-LED4080-S-BK-L3-UNV
Lumens	2801 Lm
Watts	28.6 W
LPW	97.9 Lm/W
CCT	4000K
SC (0/90/45)	0.27 / 0.27 / 0.27
Beam Angle	15.9°

COLOR METRIC SUMMARY	
TM-30-15	Rf = 82.5 Rg = 94.3
CRI/CIE	Ra = 83.1 R9 = 11.4

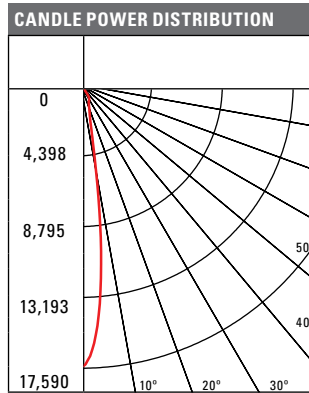
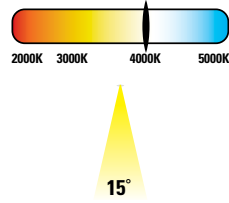

CONE OF LIGHT			
Horizontal Illuminance on Floor			
MH	FC	L	W
2'	4397.5	0.4	0.4
4'	1099.4	1	1
6'	488.6	1.6	1.6
8'	274.8	2	2
10'	175.9	2.6	2.6
15'	78.2	4	4
20'	44	5.4	5.4
30'	19.5	8.2	8.2
40'	11	10.8	10.8

CANDELA TABLE	
Angle	0-deg
0	17590
5	13640
10	5616
15	2329
20	1555
30	1057
40	161
50	11
60	4
70	1
80	0
90	0

Test Number	29497
Lumcat	9004-[W1]-X-FL-LED4080-M-BK-L3-UNV
Lumens	2826 Lm
Watts	28.6 W
LPW	98.8 Lm/W
CCT	4000K
SC (0/90/45)	0.43 / 0.43 / 0.44
Beam Angle	25.5°

COLOR METRIC SUMMARY	
TM-30-15	Rf = 82.5 Rg = 94.3
CRI/CIE	Ra = 83.1 R9 = 11.4

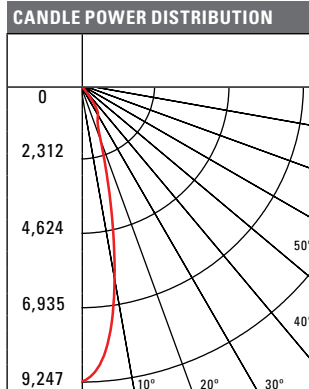
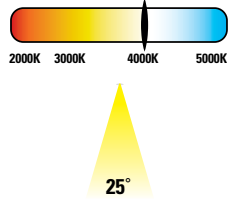

CONE OF LIGHT			
Horizontal Illuminance on Floor			
MH	FC	L	W
2'	2311.8	0.8	0.8
4'	577.9	1.6	1.6
6'	256.9	2.4	2.4
8'	144.5	3.4	3.4
10'	92.5	4.2	4.2
15'	41.1	6.4	6.4
20'	23.1	8.6	8.6
30'	10.3	12.8	12.8
40'	5.8	17.2	17.2

CANDELA TABLE	
Angle	0-deg
0	9247
5	8453
10	6140
15	3506
20	1860
30	1098
40	170
50	13
60	4
70	1
80	0
90	0

Test Number	P29498
Lumcat	9004-[W1]-X-FL-LED4080-F-BK-L3-UNV
Lumens	2871 Lm
Watts	28.5 W
LPW	100.7 Lm/W
CCT	4000K
SC (0/90/45)	0.58 / 0.58 / 0.56
Beam Angle	35.1°

COLOR METRIC SUMMARY	
TM-30-15	Rf = 82.5 Rg = 94.3
CRI/CIE	Ra = 83.1 R9 = 11.4

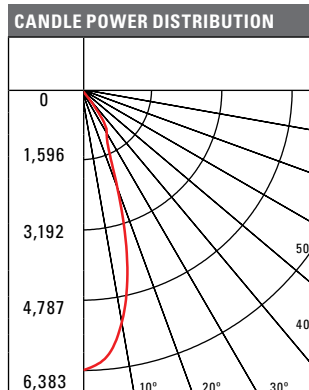
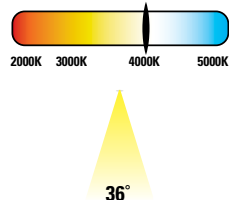

CONE OF LIGHT			
Horizontal Illuminance on Floor			
MH	FC	L	W
2'	1595.8	1	1
4'	398.9	2.2	2.2
6'	177.3	3.4	3.4
8'	99.7	4.6	4.6
10'	63.8	5.8	5.8
15'	28.4	8.6	8.6
20'	16	11.6	11.6
30'	7.1	17.4	17.4
40'	4	23.2	23.2

CANDELA TABLE	
Angle	0-deg
0	6383
5	6141
10	5345
15	4027
20	2423
30	1153
40	178
50	6
60	4
70	1
80	0
90	0

Test Number	P29499
Lumcat	9004-[W1]-X-FL-LED4080-W-BK-L3-UNV
Lumens	2790 Lm
Watts	28.5 W
LPW	97.9 Lm/W
CCT	4000K
SC (0/90/45)	0.86 / 0.86 / 0.91
Beam Angle	58.5°

COLOR METRIC SUMMARY	
TM-30-15	Rf = 82.5 Rg = 94.3
CRI/CIE	Ra = 83.1 R9 = 11.4

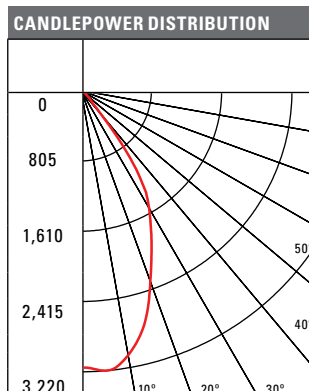
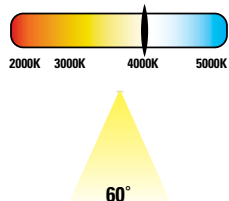

CONE OF LIGHT			
Horizontal Illuminance on Floor			
MH	FC	L	W
2'	796.9	1.6	1.6
4'	199.2	3.4	3.4
6'	88.5	5	5
8'	49.8	6.8	6.8
10'	31.9	8.4	8.4
15'	14.2	12.8	12.8
20'	8	17	17
30'	3.5	25.6	25.6
40'	2	34.2	34.2

CANDELA TABLE	
Angle	0-deg
0	3173
5	3220
10	3082
15	2784
20	2321
30	1560
40	366
50	95
60	25
70	3
80	0
90	0

CCT/CRI	LED2790	LED3090	LED3590	LED4080	LED5080	LED2797	LED3097	LED3597	LED4097
FC Multiplier	0.754	0.798	0.808	1.000	1.039	0.699	0.706	0.801	0.793

Light Level	L1	L2	L3
FC Multiplier	0.418	0.772	1.000

Note: Photometric tables show lumen output for W1 only. For W2 (Up and Down) option, uplight and downlight both match lumen output as W1.

PHOTOMETRICS (PREMIUM COLOR TUNING)

Test Number	P29571
Lumcat	9004-[W1]-X-FL-[LEDCB, LEDCR]-S-BK-LC-UNV
Lumens	853 Lm
Watts	24 W
LPW	35.5 Lm/W
CCT	3500K
SC (0/90/45)	0.41 / 0.41 / 0.45
Beam Angle	24.1°

COLOR METRIC SUMMARY	
TM-30-15	Rf = 90.6 Rg = 100.4
CRI/CIE	Ra = 92.7 R9 = 67.5

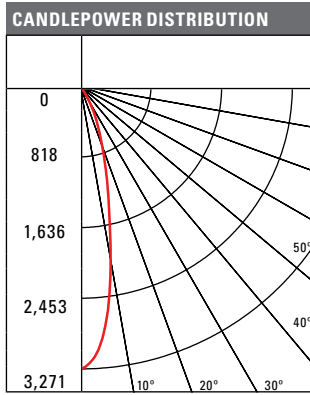
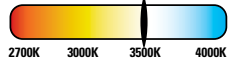

CONE OF LIGHT			
Horizontal Illuminance on Floor			
MH	FC	L	W
2'	817.8	0.8	0.8
4'	204.4	1.6	1.6
6'	90.9	2.4	2.4
8'	51.1	3.2	3.2
10'	32.7	4	4
15'	14.5	6	6
20'	8.2	8	8
30'	3.6	12	12
40'	2	16.2	16.2

CANDELA TABLE	
Angle	0-deg
0	3271
5	2929
10	2021
15	1231
20	747
30	227
40	5
50	1
60	0
70	0
80	0
90	0

Test Number	P29572
Lumcat	9004-[W1]-X-FL-[LEDCB, LEDCR]-M-BK-LC-UNV
Lumens	853 Lm
Watts	24 W
LPW	35.5 Lm/W
CCT	3500K
SC (0/90/45)	0.55 / 0.55 / 0.58
Beam Angle	33.7°

COLOR METRIC SUMMARY	
TM-30-15	Rf = 90.6 Rg = 100.4
CRI/CIE	Ra = 92.7 R9 = 67.5

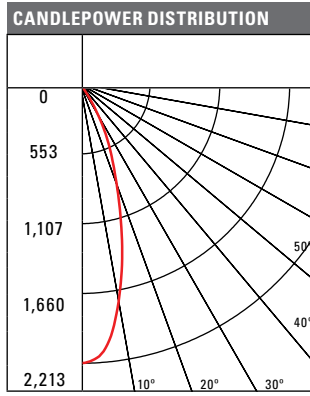
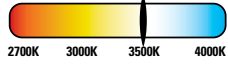

CONE OF LIGHT			
Horizontal Illuminance on Floor			
MH	FC	L	W
2'	553.2	1	1
4'	138.3	2.2	2.2
6'	61.5	3.2	3.2
8'	34.6	4.4	4.4
10'	22.1	5.4	5.4
15'	9.8	8.2	8.2
20'	5.5	11	11
30'	2.5	16.4	16.4
40'	1.4	22	22

CANDELA TABLE	
Angle	0-deg
0	2213
5	2126
10	1754
15	1279
20	845
30	288
40	3
50	1
60	1
70	0
80	0
90	0

Test Number	P29573
Lumcat	9004-[W1]-X-FL-[LEDCB, LEDCR]-F-BK-LC-UNV
Lumens	834 Lm
Watts	24 W
LPW	34.8 Lm/W
CCT	3500K
SC (0/90/45)	0.72 / 0.72 / 0.71
Beam Angle	44.7°

COLOR METRIC SUMMARY	
TM-30-15	Rf = 90.6 Rg = 100.4
CRI/CIE	Ra = 92.7 R9 = 67.5

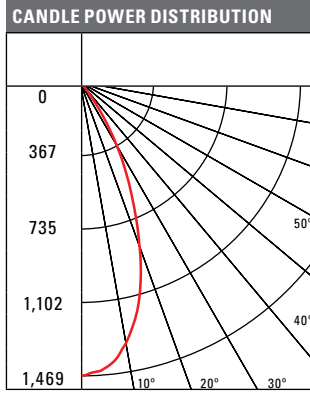
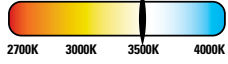

CONE OF LIGHT			
Horizontal Illuminance on Floor			
MH	FC	L	W
2'	367.2	1.4	1.4
4'	91.8	2.8	2.8
6'	40.8	4.2	4.2
8'	23	5.6	5.6
10'	14.7	7	7
15'	6.5	10.6	10.6
20'	3.7	14.2	14.2
30'	1.6	21.4	21.4
40'	0.9	28.6	28.6

CANDELA TABLE	
Angle	0-deg
0	1469
5	1435
10	1324
15	1135
20	865
30	368
40	36
50	3
60	3
70	0
80	0
90	0

Test Number	P29574
Lumcat	9004-[W1]-X-FL-[LEDCB, LEDCR]-W-BK-LC-UNV
Lumens	806 Lm
Watts	24 W
LPW	33.6 Lm/W
CCT	3500K
SC (0/90/45)	0.85 / 0.85 / 0.86
Beam Angle	55.8°

COLOR METRIC SUMMARY	
TM-30-15	Rf = 90.6 Rg = 100.4
CRI/CIE	Ra = 92.7 R9 = 67.5

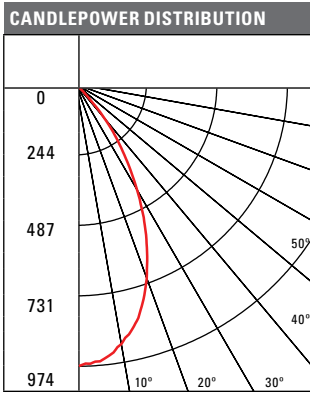
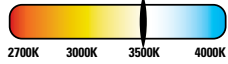

CONE OF LIGHT			
Horizontal Illuminance on Floor			
MH	FC	L	W
2'	243.5	1.6	1.6
4'	60.9	3.4	3.4
6'	27.1	5	5
8'	15.2	6.8	6.8
10'	9.7	8.4	8.4
15'	4.3	12.8	12.8
20'	2.4	17	17
30'	1.1	25.6	25.6
40'	0.6	34	34

CANDELA TABLE	
Angle	0-deg
0	974
5	960
10	910
15	835
20	715
30	424
40	157
50	6
60	4
70	3
80	0
90	0

Note: Photometric tables show lumen output for W1 only. For W2 (Up and Down) option, uplight and downlight both match lumen output as W1.

LUMEN TABLE

		9004-[W1] Regressed Hood - Black								
		L1 - 10 W			L2 - 20 W			L3 - 30W		
		CBCP	Lumens	LPW	CBCP	Lumens	LPW	CBCP	Lumens	LPW
Spot 15°	LED2790	5584	783	79.5	10310	1445	71.9	13357	1872	65.7
	LED3090	5907	828	84.1	10906	1529	76.1	14130	1981	69.5
	LED3590	5983	839	85.1	11047	1549	77.0	14311	2006	70.4
	LED4080	7401	1038	105.3	13666	1916	95.3	17705	2482	87.1
	LED5080	7689	1078	109.4	14197	1990	99.0	18393	2578	90.5
	LED2797	5175	726	73.7	9556	1340	66.6	12380	1736	60.9
	LED3097	5224	732	74.4	9646	1352	67.3	12497	1752	61.5
	LED3597	5926	831	84.3	10941	1534	76.3	14175	1987	69.7
	LED4097	5869	823	83.5	10836	1519	75.6	14038	1968	69.1
Medium Flood 25°	LED2790	2907	781	79.2	5368	1441	71.7	6954	1867	65.5
	LED3090	3075	826	83.8	5678	1525	75.8	7357	1975	69.3
	LED3590	3115	836	84.9	5751	1544	76.8	7451	2001	70.2
	LED4080	3853	1035	105.0	7115	1910	95.0	9218	2475	86.8
	LED5080	4003	1075	109.1	7391	1984	98.7	9576	2571	90.2
	LED2797	2695	723	73.4	4975	1336	66.5	6446	1731	60.7
	LED3097	2720	730	74.1	5022	1348	67.1	6505	1747	61.3
	LED3597	3085	828	84.1	5696	1529	76.1	7380	1981	69.5
	LED4097	3055	820	83.3	5642	1515	75.4	7309	1962	68.9
Flood 36°	LED2790	2006	792	80.4	3704	1463	72.8	4799	1895	66.3
	LED3090	2122	838	85.1	3918	1547	77.0	5076	2004	70.1
	LED3590	2149	849	86.2	3969	1567	78.0	5142	2030	71.0
	LED4080	2659	1050	106.6	4910	1939	96.4	6361	2512	87.8
	LED5080	2762	1091	110.7	5101	2014	100.2	6608	2609	91.2
	LED2797	1859	734	74.5	3233	1356	67.4	4448	1756	61.4
	LED3097	1877	741	75.2	3466	1368	68.1	4490	1773	62.0
	LED3597	2129	841	85.3	3931	1552	77.2	5093	2011	70.3
	LED4097	2108	832	84.5	3893	1537	76.5	5044	1991	69.6
Wide Flood 60°	LED2790	1012	753	76.4	1869	1390	69.2	2422	1801	63.0
	LED3090	1071	796	80.8	1977	1470	73.2	2562	1905	66.6
	LED3590	1085	807	81.9	2003	1489	74.1	2595	1929	67.5
	LED4080	1342	998	101.3	2478	1842	91.7	3210	2387	83.5
	LED5080	1394	1037	105.2	2574	1914	95.2	3335	2480	86.7
	LED2797	938	698	70.8	1733	1288	64.1	2245	1669	58.4
	LED3097	947	704	71.5	1749	1300	64.7	2266	1685	58.9
	LED3597	1074	799	81.1	1984	1475	73.4	2570	1911	66.8
	LED4097	1064	791	80.3	1965	1461	72.7	2545	1893	66.2

TM30 DATA

9004	CCT/CRI	Rf	Rg	Ra	R9
	2790	90.9	98.9	91.7	58.3
	3090	90.8	99.1	92.5	62.6
	3590	90.6	100.4	92.7	67.5
	4080	82.5	94.3	83.1	11.4
	5080	81.6	94.1	82	6
	2797	94.9	100	98.1	86.9
	3097	94	100.3	97.8	88.9
	3597	92.9	99.3	97.2	89.1
	4097	91.5	98.7	95.4	84

LUMEN MAINTENANCE

Ambient Temperature	TM-21 Lumen Maintenance (60,000 Hours)	Theoretical L70 (Hours)
25°C, 40°C, 50°C	> 87%	> 102,000

POWER TABLE

Number of Heads	Light Level	Input Current (A) at 120 VAC	Input Current (A) at 277 VAC	Input Power (W)
W1	L1	0.08	0.03	10
	L2	0.177	0.088	20.93
	L3	0.252	0.118	30.02
	LC1	0.1	0.085	11.4
	LC2	0.183	0.088	21.44
W2	L1	0.16	0.06	20
	L2	0.354	0.176	41.86
	L3	0.504	0.236	60.04
	LC1	0.2	0.17	22.8
	LC2	0.366	0.176	42.88

INTEGRATED SENSOR - SVPD2

The Lanterra Cylinder 9004 with Integrated Sensor technology provides automatic energy savings without sacrificing performance. Traditionally, these types of energy savings required coordination between the luminaire and a lighting control system. The Lanterra Cylinder 9004 delivers superior lighting with integrated PIR occupancy sensing and daylighting controls.

Capture the benefits of traditional lighting controls, without complicated circuit planning or special wiring. The Lanterra Cylinder 9004 delivers automatic ON to an energy saving light level, while ensuring lighting is turned OFF when the space is unoccupied.

The SVPD2 sensor is configured for outdoor use, so the integral daylight sensor will enable the luminaire to automatically adjust to daylight conditions by turning off when sufficient sunlight is present. Consult factory for indoor configuration.

Occupied light levels and unoccupied light levels can be adjusted using the integrated sensor programming remote (Catalog Number: ISHH01LUM). While the default unoccupied level is OFF, a lower light level can be saved instead using the programming remote. The integrated sensor personal remote (Catalog Number: ISHH02LUM) provides code compliant manual raise, lower, ON, OFF control.

The Lanterra Cylinder 9004 with Integrated Sensor is easy to install with no special wiring and ensures energy savings out-of-the-box with default control settings.

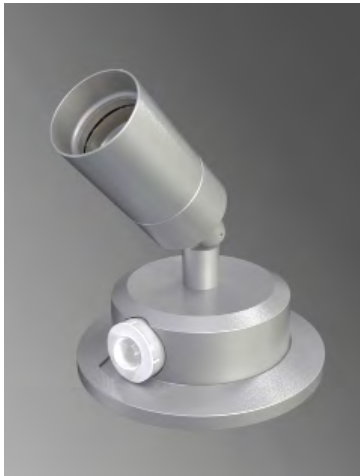

HOW IT WORKS

- As the user enters the space controlled by the integral sensor, the lighting turns ON to the occupied light level.
- Lighting will remain at the occupied level until the space is unoccupied. This will start the occupancy timeout period (default 20 minutes).
- If the space remains unoccupied for half of the timeout period, the lighting will automatically reduce to the Energy Saver light level (default matches occupied level). This adjustable light level is often set to half of the occupied daylight level using the programming remote.
- At the end of the timeout period the lighting will go to the unoccupied light level. This adjustable light level uses the OFF default setting.
- If sufficient sunlight is present, the luminaire will remain OFF, regardless of occupancy.

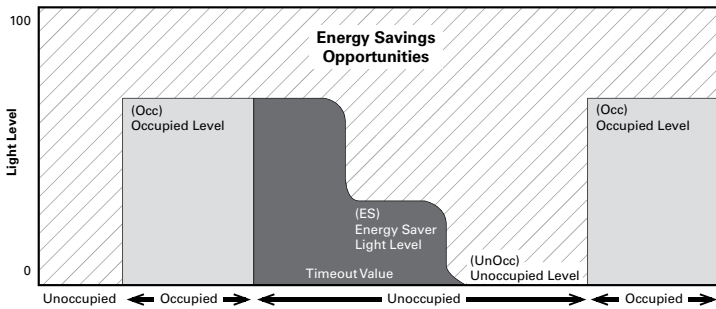

Coverage

SVPD2 Coverage Pattern (not to scale)

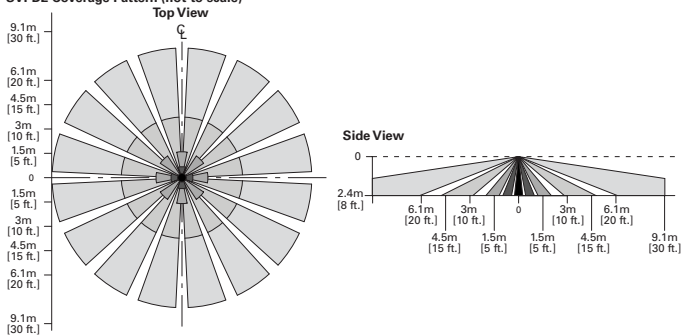

Sensor Dimensions

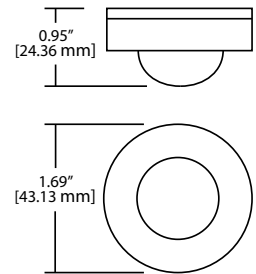

Optional Remote Controls



ISHH01LUM Programming Remote



ISHH02LUM Personal Control Remote