



The UrbanScape LED pendant luminaire combines style and performance to create flexible, durable and attractive energy-saving solutions that blend in well with modern-styled urban architecture. Now available with comfort optics, it provides reduced glare for an enhanced user experience. Includes Service Tag, Philips innovative way to provide assistance throughout the life of the product.

Project: _____
 Location: _____
 Cat.No: _____
 Type: _____
 Lamps: _____ Qty: _____
 Notes: _____

Luminaire ordering guide

Example: MSC-C-140L450WW-G1-1-UNV-DMG-SMA-RCD-BKTX

| Series | LED module | Gen. | Optical System | Voltage | Driver ³ | Adapter ⁷ | Luminaire options | Mountings and poles ⁷ | Finishes |
|--|--|------------|----------------------|-------------------|--|---|--|---|-----------------|
| MSC-C UrbanScape LED pendant luminaire | 3000⁶K | G1 Gen1 | 1 Type I (ASYM) | UNV 120-277VAC | DMG 0-10V | MA1 1 ¹ / ₄ " NPT threaded hole adapter accepting threaded tube | BX Bird repellent | Consult the Signify web site and Lumec 3D for details and the complete line of mountings and poles | Textured |
| | 140L450WW ¹ | | | | | | | | |
| MSCR-C UrbanScape LED pendant luminaire | 4000K | G1 Gen1 | 3 Type III (ASYM) | 480 480VAC | SRD ² Sensor ready driver, standard configuration | MA2 1 ¹ / ₂ " NPT threaded hole adapter accepting threaded tube. | PH8 ⁴ Twist-lock Photoelectric Cell | Consult the Signify web site and Lumec 3D for details and the complete line of mountings and poles | Textured |
| | 140L1150WW 140L1675WW 140L2100WW | | | | | | | | |
| MSCR-C UrbanScape LED pendant luminaire | 4000K | G1 Gen1 | 5 Type V (SYMM) | 480 480VAC | SRD1 ² Sensor ready driver, alternate configuration | SMA Decorative retro side-mounted cast-aluminum, accepts tubes from 1 ⁵ / ₈ " to 2 ³ / ₈ " | PH9 ⁴ Shorting cap | Consult the Signify web site and Lumec 3D for details and the complete line of mountings and poles | Textured |
| | 140L450NW ¹ 140L650NW ¹ 140L1150NW 140L1675NW 140L2100NW | | | | | | | | |
| MSCR-C UrbanScape LED pendant luminaire | 4000K | G1 Gen1 | 5 Type V (SYMM) | 480 480VAC | SRD1 ² Sensor ready driver, alternate configuration | SMA Decorative retro side-mounted cast-aluminum, accepts tubes from 1 ⁵ / ₈ " to 2 ³ / ₈ " | PH9 ⁴ Shorting cap | Consult the Signify web site and Lumec 3D for details and the complete line of mountings and poles | Textured |
| | 140L450NW ¹ 140L650NW ¹ 140L1150NW 140L1675NW 140L2100NW | | | | | | | | |
| MSCR-C UrbanScape LED pendant luminaire | 4000K | G1 Gen1 | 5 Type V (SYMM) | 480 480VAC | SRD1 ² Sensor ready driver, alternate configuration | SMA Decorative retro side-mounted cast-aluminum, accepts tubes from 1 ⁵ / ₈ " to 2 ³ / ₈ " | PH9 ⁴ Shorting cap | Consult the Signify web site and Lumec 3D for details and the complete line of mountings and poles | Textured |
| | 140L450NW ¹ 140L650NW ¹ 140L1150NW 140L1675NW 140L2100NW | | | | | | | | |
| MSCR-C UrbanScape LED pendant luminaire | 4000K | G1 Gen1 | 5 Type V (SYMM) | 480 480VAC | SRD1 ² Sensor ready driver, alternate configuration | SMA Decorative retro side-mounted cast-aluminum, accepts tubes from 1 ⁵ / ₈ " to 2 ³ / ₈ " | PH9 ⁴ Shorting cap | Consult the Signify web site and Lumec 3D for details and the complete line of mountings and poles | Textured |
| | 140L450NW ¹ 140L650NW ¹ 140L1150NW 140L1675NW 140L2100NW | | | | | | | | |

- For 240 or 277 volt with DALI option consult factory.
- Not available with 347V and 480V.
- Select either DMG or DALI mandatory driver options.
- Select either RCD or RCD7 mandatory luminaire options for this option.
- Use of photoelectric cell or shorting cap is required to ensure proper illumination.
- CCT's 3000K and warmer are IDA Dark Sky Approved.



MSC-C UrbanScape pendant

urban luminaire with comfort optics

Dimensions

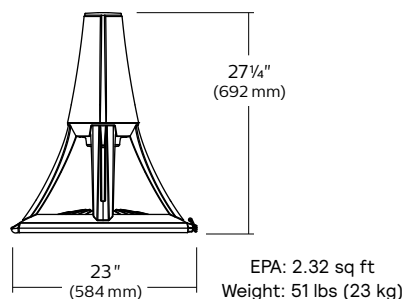

LED Wattage and Lumen Values for MSC-C

| Ordering Code | Total LEDs | System current (mA) | Average System Watts (W) | Type 1 | | | Type 2 | | | Type 3 | | | Type 4 | | | Type 5 | | |
|--------------------|------------|---------------------|--------------------------|--------------|----------------|------------|--------------|----------------|------------|--------------|----------------|------------|--------------|----------------|------------|--------------|----------------|------------|
| | | | | Lumen Output | Efficacy (LPW) | BUG Rating | Lumen Output | Efficacy (LPW) | BUG Rating | Lumen Output | Efficacy (LPW) | BUG Rating | Lumen Output | Efficacy (LPW) | BUG Rating | Lumen Output | Efficacy (LPW) | BUG Rating |
| MSC-C 3000K | | | | | | | | | | | | | | | | | | |
| 140L450WW-G1 | 140 | 450 | 21 | 2291 | 108 | B1-U0-G1 | 2296 | 108 | B1-U0-G1 | 2360 | 111 | B1-U0-G1 | 2473 | 116 | B1-U0-G1 | 2261 | 106 | B1-U0-G1 |
| 140L650WW-G1 | 140 | 650 | 31 | 3205 | 105 | B2-U0-G1 | 3212 | 105 | B1-U0-G1 | 3302 | 108 | B1-U0-G1 | 3460 | 113 | B1-U0-G1 | 3163 | 104 | B2-U0-G1 |
| 140L1150WW-G1 | 140 | 1150 | 52 | 5455 | 104 | B2-U0-G2 | 5467 | 104 | B2-U0-G2 | 5619 | 107 | B2-U0-G2 | 5888 | 112 | B2-U0-G2 | 5383 | 103 | B3-U0-G1 |
| 140L1675WW-G1 | 140 | 1675 | 75 | 7491 | 99 | B3-U0-G3 | 7507 | 100 | B3-U0-G3 | 7717 | 102 | B2-U0-G2 | 8086 | 107 | B2-U0-G2 | 7393 | 98 | B3-U0-G2 |
| 140L2100WW-G1 | 140 | 2100 | 97 | 9090 | 94 | B3-U0-G3 | 9109 | 94 | B3-U0-G3 | 9363 | 97 | B3-U0-G3 | 9812 | 101 | B3-U0-G3 | 8970 | 93 | B3-U0-G2 |
| MSC-C 4000K | | | | | | | | | | | | | | | | | | |
| 140L450NW-G1 | 140 | 450 | 21 | 2296 | 108 | B1-U0-G1 | 2301 | 109 | B1-U0-G1 | 2365 | 112 | B1-U0-G1 | 2478 | 117 | B1-U0-G1 | 2266 | 107 | B1-U0-G1 |
| 140L650NW-G1 | 140 | 650 | 30 | 3211 | 105 | B2-U0-G1 | 3218 | 106 | B1-U0-G1 | 3308 | 109 | B1-U0-G1 | 3467 | 114 | B1-U0-G1 | 3169 | 104 | B2-U0-G1 |
| 140L1150NW-G1 | 140 | 1150 | 52 | 5466 | 105 | B2-U0-G2 | 5478 | 105 | B2-U0-G2 | 5630 | 108 | B2-U0-G2 | 5900 | 113 | B2-U0-G2 | 5394 | 103 | B3-U0-G1 |
| 140L1675NW-G1 | 140 | 1675 | 75 | 7506 | 100 | B3-U0-G3 | 7522 | 100 | B3-U0-G3 | 7732 | 103 | B2-U0-G2 | 8102 | 108 | B2-U0-G2 | 7408 | 99 | B3-U0-G2 |
| 140L2100NW-G1 | 140 | 2100 | 96 | 9108 | 95 | B3-U0-G3 | 9128 | 95 | B3-U0-G3 | 9382 | 97 | B3-U0-G3 | 9831 | 102 | B3-U0-G3 | 8988 | 93 | B3-U0-G2 |

Actual performance may vary due to installation variables including optics, mounting/ceiling height, dirt depreciation, light loss factor, etc.; highly recommended to confirm performance with a layout - contact Applications at outdoorlighting.applications@Signify.com.

Note: Some data may be scaled based on tests of similar but not identical luminaires.

LED Performance

| Predicted lumen depreciation data ¹ | | | | |
|--|---------------|---|--|------------------------------------|
| Ambient Temperature (°C) | Driver mA | Calculated L ₇₀ hours ^{1,2} | L ₇₀ per TM-21 ^{2,3} | Lumen Maintenance % @ 60,000 hours |
| 25°C | Up to 2100 mA | >100,000 hrs | >60,000 hrs | 84% |

1. Predicted performance derived from LED manufacturer's data and engineering design estimates, based on IESNA LM-80 methodology. Actual experience may vary due to field application conditions.

2. L₇₀ is the predicted time when LED performance depreciates to 70% of initial lumen output.

3. Calculated per IESNA TM21-11. Published L₇₀ hours limited to 6 times actual LED test hours.

MSC-C UrbanScape pendant

urban luminaire with comfort optics

Specifications

Cage

In a round shape, this cage is made of four cast aluminum 356 decorative arms welded to the housing and to the access mechanism.

Housing

In a round shape, this housing is made of cast 356 aluminum, c/w a watertight grommet, mechanically assembled to the bracket with four bolts 3/8 16 UNC. This suspension system permits for a full rotation of the luminaire in 90° increments. The housing is complete with a watertight access cap mechanically secured with two captive screws, giving access to the driver. Rated IP66.

Access-Mechanism

Made of cast aluminum 356 technical, ring with latch and hinge. The mechanism shall offer tool free access to the Light engine.

Light Engine

Light guide technology provides low-glare, uniform illumination. Composed of 140 LEDs strategically positioned on the edge of the optical plate. Light engine luminous opening size optimized to best achieve a balance between lumen output and optical performance with the need to provide visual comfort. Light engine frame ensures contact with housing to provide heat conduction and sealing against the elements. Light engine is RoHS compliant. Maximum ambient operating temperature up to 40°C(104°F). Standard color temperatures: 3000K +/- 130K, 4000K +/- 130K, Minimum CRI of 70. Also available in 2700K, 3500K, 5000K and Amber (>590nm) with extended lead times. Contact factory for details.

Optical System

The advanced LED comfort optical system provides Types 1, 2, 3, 4 and 5. Composed of high performance UV-stabilized optical grade lens with molded micro-optics to achieve desired distribution optimized to get a exceptional lighting uniformity. Performance tested per LM-79 and TM-15 (IESNA) certifying its photometric performance. Street side indicated luminaire designed with 0% uplight (UO per IESNA TM-15).

Driver

High power factor of 95%. Electronic driver, operating range 50/60 Hz. Auto adjusting universal voltage input from 120 to 277 and 347 to 480 VAC rated for both application line to line or line to neutral, Class 2, THD of 20% max. Maximum ambient operating temperature from 40°F (40°C) to 130°F (50°C). Certified in compliance to UL1310 cULus requirement. Dry and damp location. Assembled on a unitized removable tray with Tyco quick disconnect plug resisting to 221°F (105°C). Dimmable driver 0-10V. The current supplying the LEDs will be reduced by the driver if the driver experiences internal overheating as a protection to the LEDs and the electrical components. Output is protected from short circuits, voltage overload and current overload. Automatic recovery after correction. Standard built in driver surge protection of 2.5kV (min) with DALI, driver is class 1.

Surge Protector

Surge protector tested in accordance with ANSI/IEEE C62.45 per ANSI/IEEE C62.41.2 Scenario I Category C High Exposure 10kV/10kA waveforms for Line Ground, Line Neutral and Neutral Ground, and in accordance with U.S. DOE (Department of Energy) MSSLC (Municipal Solid State Street Lighting Consortium) model specification for LED roadway luminaires electrical immunity requirements for High Test Level 10kV / 10kA. Optional SP2: 20kV / 10kA surge protection device that provides extra protection beyond the SP1 10kV/10kA level.

Driver options

DMG: Dimmable driver 0-10V.

DALI: DALI compatible.

SRD: Sensor Ready Driver including SR communication (used for dimming and other functionalities), 24V auxiliary supply and a logical signal input (LSI) connected to the top NEMA twist lock receptacle.

SRD1: Sensor Ready Driver including SR communication (used for dimming and other functionalities) but with 24V auxiliary supply and a logical signal input (LSI) not connected to the top NEMA twist lock.

Luminaire options

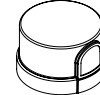

PH8 (allows a 90° rotation) Photoelectric Cell, Twist-lock Type complete with receptacle.

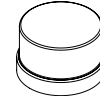

PH9 Shorting cap, Twist-lock Type complete with receptacle.

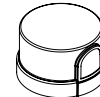

PHXL (allows a 90° rotation) Extended life photoelectric cell, Twist-lock Type complete with receptacle.

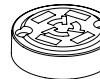

RCD Receptacle 5-pins allowing dimming, can be used with a twist-lock Starsense, shorting cap or a photoelectric cell.



RCD7 Receptacle 7-pins.



BX Bird repellent.

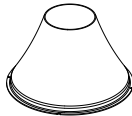

DH Opaque decorative hood.

Adapters

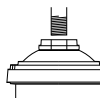

MA1 The luminaire is suspended by means of a mounting adapter with a 1 1/4" (32mm) NPT threaded hole accepting a threaded tube from the mounting. Retrofit adapter for existing mounting.

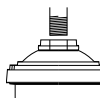

MA2 The luminaire is suspended by means of a mounting adapter with a 1 1/2" (38mm) NPT threaded hole accepting threaded tube from the mounting. Retrofit adapter for existing mounting.

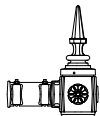

SMA The luminaire is suspended by means of a decorative side-mounted cast aluminum adapter. This adapter accepts tubes from 1 5/8" to 2 3/8" (41 to 60 mm) and is adjustable to more or less 5°. The adapter features a cast aluminum decorative cover and finial.

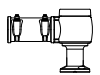

SMB The luminaire is suspended by means of a decorative side-mounted cast aluminum adapter. This adapter accepts tubes from 1 5/8" to 2 3/8" (41 to 60 mm) and is adjustable to more or less 5°.

MSC-C UrbanScape pendant

urban luminaire with comfort optics

Specifications (continued)

Finish

Color to be in accordance with the AAMA 2603 standard. Application of polyester powder coat paint (4 mils/100 microns) with ± 1 mils/24 microns of tolerance. The Thermosetting resins provides a discoloration resistant finish in accordance with the ASTM D2244 standard, as well as luster retention in keeping with the ASTM D523 standard and humidity proof in accordance with the ASTM D2247 standard. The surface treatment achieves a minimum of 2000 hours for salt spray resistant finish in accordance with testing performed and per ASTM B117 standard.

Textured Finishes:

BE2TX: Midnight Blue
BE6TX: Ocean Blue
BE8TX: Royal Blue
BG2TX: Sandstone
BKTX: Black
BRTX: Bronze
GN4TX: Blue Green
GN6TX: Forest Green
GN8TX: Dark Forest Green
GNTX: Green
GY3TX: Medium Grey
RD2TX: Burgundy
RD4TX: Scarlet
WHTX: White

Other Finishes:

GR: Gray Sandtex
NP: Natural Alum.
TG: Hammer-tone Gold
TS: Hammer-tone Silver

LED manufacturing standard

The electronic components sensitive to electrostatic discharge (ESD) such as light emitting diodes (LEDs) are assembled in compliance with IEC61340 5 1 and ANSI/ESD S20.20 standards so as to eliminate ESD events that could decrease the useful life of the product.

Hardware

All exposed screws shall be stainless steel with Ceramic primer seal basecoat to reduce seizing of the parts. All seals and sealing devices are made and/or lined with EPDM and/or silicone and/or rubber.

Quality Control

Manufactured to ISO 9001 2008 & ISO 14001 2004 International Quality Standards Certification.

Vibration Resistance

Meets the ANSI C136.31, American National Standard for Roadway Luminaire Vibration specifications for Bridge/overpass applications.

Service Tag

Each individual luminaire is uniquely identifiable, thanks to the Signify Service tag application. With a simple scan of a QR code, placed inside the luminaire, you gain instant access to the luminaire configuration, making installation and maintenance operations faster and easier, no matter what stage of the luminaire's lifetime. Just download the APP and register your product right away.

For more details visit: signify.com/servicetag

Certifications and Compliance

CSA, cULus Listed for Canada and USA.
Compliant configurations listed on Design Lights Consortium (DLC) qualified products list.

