



The **UrbanScape LED** pendant luminaire combines style and performance to create flexible, durable and attractive energy-saving solutions that blend in well with modern-styled urban architecture. Thanks to the open design it is capable of more powerful lumen packages suited to the higher visibility requirements of roads and intersections – up to 96 LEDs can deliver over 20,000 lumens, equivalent to 400W HID. The pendant model comes with a choice of flat or sag lens and an optional white opaque globe. Includes Service Tag, innovative way to provide assistance throughout the life of the product.

Project: _____
 Location: _____
 Cat.No: _____
 Type: _____
 Lamps: _____ Qty: _____
 Notes: _____

Luminaire ordering guide

Example: MSR-145W64LED4K-T-LE3F-120-CDMGM25-SMA-RCD-BKTX

Series	LED module	CCT	Gen.	Optical System	Lens	Voltage	Driver	Adapter	Luminaire option	Mounting	Pole	Finish
MSC												
MSC ¹ UrbanScape LED pendant luminaire	35W32LED ² 55W32LED ² 72W32LED ² 97W32LED ² 55W48LED 80W48LED 108W48LED 140W48LED 70W64LED 110W64LED 145W64LED ² 195W64LED ² 90W80LED 135W80LED 180W80LED 110W96LED 160W96LED 215W96LED ³	3K 3000K 4K 4000K	G2 Gen2	LE2 Type II (ASYM) LE3 Type III (ASYM) LE3W Type III (ASYM) wide flat lens LE4 Type IV (ASYM) LE5 ⁴ Type V (SYMM)	F Flat lens S Sag lens	120 120V 208 208V 240 240V 277 277V 347 347V 480 480V	CDMG ² Dynadimmer for standard dimming (consult pg 3 for complete Dynadimmer scenarios) CLO ² Pre-set driver to manage lumen depreciation AST ² Pre-set driver for progressive start-up OTL ² Pre-set driver to signal end of lamp life DALI ² Pre-set driver compatible with the DALI control system DMG 0-10 volt	MA1 1 1/4" NPT threaded hole adapter accepting threaded tube MA2 1 1/2" NPT threaded hole adapter accepting threaded tube. SMA Decorative retro side-mounted cast-aluminum, accepts tubes from 1 5/8" to 2 3/8" SMB Decorative contemporary side-mounted cast-aluminum, accepts tubes from 1 5/8" to 2 3/8"	BX ⁶ Bird repellent DH Opaque decorative hood HS House Side Shield PH8 Photoelectric cell PH9 Shorting Cap PHXL ² Photoelectric cell, extended life RCD ⁶ 5-Pin receptacle for dimming photoelectric cell RCD7 ⁶ 7-Pin receptacle for photoelectric cell SP2 20kV/20kA Surge Protector (optional)	Consult the Signify web site for details and the complete line of Mountings	Consult the Signify web site for details and the complete line of Poles	BE2TX BE6TX BE8TX BG2TX BKTX BRTX GN4TX GN6TX GN8TX GNTX GR GY3TX NP RD2TX RD4TX TG TS WHTX (consult pg 4 for all code descriptions)

- DMG 0-10V driver come standard.
- The 347V and 480V are not available.
- Not available with DH option.
- Not available with HS option.
- Can not be used with DH, PH8, PH8XL, PH9 or RCD.
- Use of photoelectric cell or shorting cap is required to ensure proper illumination.



MSC UrbanScape LED Pendant

Urban Luminaire

Dimensions

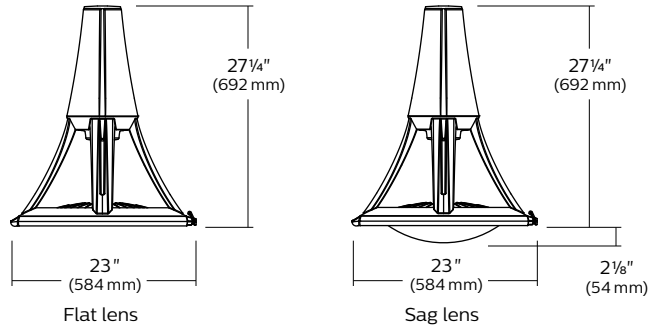

EPA: 2.32 sq ft
Weight: 51 lbs (23 kg)

LED Wattage and Lumen Values for 3000K fixtures

Ordering Code:	Total LEDs	System current (mA)	Average System Watts ¹ (W)	LE2			LE3			LE3W			LE4			LE5		
				Lumen Output ²	Efficacy (LPW)	BUG Rating	Lumen Output ²	Efficacy (LPW)	BUG Rating	Lumen Output ²	Efficacy (LPW)	BUG Rating	Lumen Output ²	Efficacy (LPW)	BUG Rating	Lumen Output ²	Efficacy (LPW)	BUG Rating
Flat Lens MSC 3000K																		
35W32LED3K-G2	32	350	37	3810	102.8	B1-U0-G1	3715	100.3	B1-U0-G1	3666	99.0	B1-U0-G1	3749	101.2	B1-U0-G1	3733	100.8	B3-U0-G1
55W32LED3K-G2	32	530	55	5465	99.4	B1-U0-G1	5328	96.9	B1-U0-G1	5258	95.7	B1-U0-G2	5378	97.8	B1-U0-G2	5355	97.4	B3-U0-G1
72W32LED3K-G2	32	700	72	6893	96.2	B2-U0-G1	6720	93.8	B1-U0-G2	6631	92.5	B1-U0-G2	6783	94.7	B1-U0-G2	6754	94.3	B3-U0-G2
97W32LED3K-G2	32	1050	105	9504	90.5	B2-U0-G2	9267	88.2	B2-U0-G2	9144	87.0	B2-U0-G2	9353	89.0	B2-U0-G2	9313	88.6	B4-U0-G2
55W48LED3K-G2	48	350	54	5715	106.4	B1-U0-G1	5572	103.7	B1-U0-G1	5498	102.3	B1-U0-G2	5624	104.7	B1-U0-G2	5600	104.2	B3-U0-G1
80W48LED3K-G2	48	530	80	8198	102.3	B2-U0-G1	7993	99.7	B2-U0-G2	7887	98.4	B1-U0-G2	8067	100.7	B1-U0-G2	8033	100.2	B3-U0-G2
108W48LED3K-G2	48	700	105	10339	98.2	B2-U0-G2	10080	95.7	B2-U0-G2	9946	94.4	B2-U0-G2	10174	96.6	B2-U0-G2	10131	96.2	B4-U0-G2
140W48LED3K-G2	48	1050	157	14257	90.6	B3-U0-G2	13900	88.3	B2-U0-G2	13715	87.2	B2-U0-G2	14029	89.2	B2-U0-G2	13970	88.8	B4-U0-G2
70W64LED3K-G2	64	350	69	7365	106.5	B2-U0-G1	7054	102.0	B1-U0-G2	7069	102.2	B1-U0-G2	7154	103.5	B1-U0-G2	7128	103.1	B3-U0-G2
110W64LED3K-G2	64	530	105	10564	100.8	B2-U0-G2	10119	96.5	B2-U0-G2	10140	96.7	B2-U0-G2	10262	97.9	B2-U0-G2	10225	97.5	B4-U0-G2
145W64LED3K-G2	64	700	140	13323	95.3	B3-U0-G2	12762	91.3	B2-U0-G2	12789	91.5	B2-U0-G2	12942	92.6	B2-U0-G2	12895	92.2	B4-U0-G2
195W64LED3K-G2	64	1050	214	18371	85.7	B3-U0-G2	17598	82.1	B3-U0-G2	17635	82.3	B3-U0-G3	17846	83.3	B3-U0-G3	17782	83.0	B4-U0-G2
90W80LED3K-G2	80	350	87	9206	105.9	B2-U0-G2	8818	101.5	B2-U0-G2	8837	101.7	B2-U0-G2	8943	102.9	B2-U0-G2	8910	102.5	B3-U0-G2
135W80LED3K-G2	80	530	131	13204	100.4	B3-U0-G2	12648	96.2	B2-U0-G2	12675	96.4	B2-U0-G2	12827	97.6	B2-U0-G2	12781	97.2	B4-U0-G2
180W80LED3K-G2	80	700	175	16653	95.2	B3-U0-G2	15952	91.2	B3-U0-G2	15986	91.4	B2-U0-G3	16177	92.5	B2-U0-G3	16119	92.2	B4-U0-G2
110W96LED3K-G2	96	350	101	11047	109.1	B2-U0-G2	10582	104.5	B2-U0-G2	10604	104.7	B2-U0-G2	10731	105.9	B2-U0-G2	10692	105.5	B4-U0-G2
160W96LED3K-G2	96	530	158	15845	100.3	B3-U0-G2	15178	96.1	B3-U0-G2	15210	96.3	B2-U0-G3	15393	97.5	B2-U0-G2	15337	97.1	B4-U0-G2
215W96LED3K-G2	96	700	209	19984	95.6	B3-U0-G2	19143	91.5	B3-U0-G2	19183	91.7	B3-U0-G3	19413	92.8	B3-U0-G3	19343	92.5	B5-U0-G3
Sag Lens MSC 3000K																		
35W32LED3K-G2	32	350	37	3844	103.8	B1-U0-G1	3790	102.3	B1-U0-G1	3749	101.2	B1-U0-G1	3789	102.3	B1-U0-G1	3847	103.8	B3-U0-G1
55W32LED3K-G2	32	530	55	5514	100.3	B1-U0-G1	5437	98.9	B1-U0-G1	5377	97.8	B1-U0-G2	5435	98.9	B1-U0-G2	5517	100.4	B3-U0-G1
72W32LED3K-G2	32	700	72	6954	97.0	B2-U0-G1	6857	95.7	B1-U0-G2	6782	94.6	B1-U0-G2	6854	95.7	B1-U0-G2	6959	97.1	B3-U0-G2
97W32LED3K-G2	32	1050	105	9589	91.3	B2-U0-G2	9455	90.0	B2-U0-G2	9352	89.0	B2-U0-G2	9451	90.0	B2-U0-G2	9595	91.3	B4-U0-G2
55W48LED3K-G2	48	350	54	5766	107.3	B1-U0-G1	5685	105.8	B1-U0-G2	5624	104.7	B1-U0-G2	5683	105.8	B1-U0-G2	5770	107.4	B3-U0-G1
80W48LED3K-G2	48	530	80	8271	103.2	B2-U0-G2	8155	101.8	B1-U0-G2	8066	100.7	B1-U0-G2	8152	101.7	B1-U0-G2	8276	103.3	B3-U0-G2
108W48LED3K-G2	48	700	105	10431	99.0	B2-U0-G2	10285	97.7	B2-U0-G2	10173	96.6	B2-U0-G2	10281	97.6	B2-U0-G2	10438	99.1	B4-U0-G2
140W48LED3K-G2	48	1050	157	14383	91.4	B3-U0-G2	14182	90.1	B2-U0-G2	14028	89.2	B2-U0-G3	14177	90.1	B2-U0-G3	14393	91.5	B4-U0-G2
70W64LED3K-G2	64	350	69	7358	106.4	B2-U0-G1	7190	104.0	B1-U0-G2	7069	102.2	B1-U0-G2	7362	106.5	B1-U0-G2	7444	107.7	B3-U0-G2
110W64LED3K-G2	64	530	105	10554	100.7	B2-U0-G2	10313	98.4	B2-U0-G2	10140	96.7	B2-U0-G2	10560	100.7	B2-U0-G2	10677	101.8	B4-U0-G2
145W64LED3K-G2	64	700	140	13311	95.2	B3-U0-G2	13006	93.0	B2-U0-G2	12789	91.5	B2-U0-G2	13319	95.2	B2-U0-G2	13466	96.3	B4-U0-G2
195W64LED3K-G2	64	1050	214	18355	85.6	B3-U0-G2	17935	83.7	B3-U0-G3	17635	82.3	B3-U0-G3	18365	85.7	B3-U0-G3	18568	86.6	B5-U0-G3
90W80LED3K-G2	80	350	87	9198	105.8	B2-U0-G2	8987	103.4	B2-U0-G2	8837	101.7	B2-U0-G2	9203	105.9	B2-U0-G2	9305	107.1	B4-U0-G2
135W80LED3K-G2	80	530	131	13193	100.4	B3-U0-G2	12891	98.1	B2-U0-G2	12675	96.4	B2-U0-G2	13200	100.4	B2-U0-G2	13346	101.5	B4-U0-G2
180W80LED3K-G2	80	700	175	16639	95.2	B3-U0-G2	16258	93.0	B2-U0-G2	15986	91.4	B2-U0-G3	16648	95.2	B2-U0-G3	16832	96.3	B4-U0-G2
110W96LED3K-G2	96	350	101	11037	109.0	B2-U0-G2	10785	106.5	B2-U0-G2	10604	104.7	B2-U0-G2	11043	109.0	B2-U0-G2	11166	110.2	B4-U0-G2
160W96LED3K-G2	96	530	158	15832	100.2	B3-U0-G2	15469	97.9	B2-U0-G2	15210	96.3	B2-U0-G3	15840	100.3	B2-U0-G3	16016	101.4	B4-U0-G2
215W96LED3K-G2	96	700	209	19967	95.5	B3-U0-G3	19510	93.3	B3-U0-G3	19183	91.7	B3-U0-G3	19978	95.5	B3-U0-G3	20199	96.6	B5-U0-G3

Actual performance may vary due to installation variables including optics, mounting/ceiling height, dirt depreciation, light loss factor, etc.; highly recommended to confirm performance with a layout - contact Applications at signify.com/outdoorluminaire.

Note: Some data may be scaled based on tests of similar. But not identical luminaires.

MSC UrbanScape LED Pendant

Urban Luminaire

LED Wattage and Lumen Values for 4000K fixtures

Ordering Code:	Total LEDs	System current (mA)	Average System Watts ¹ (W)	LE2			LE3			LE3W			LE4			LE5		
				Lumen Output ²	Efficacy (LPW)	BUG Rating	Lumen Output ²	Efficacy (LPW)	BUG Rating	Lumen Output ²	Efficacy (LPW)	BUG Rating	Lumen Output ²	Efficacy (LPW)	BUG Rating	Lumen Output ²	Efficacy (LPW)	BUG Rating
Flat Lens MSC 4000K																		
35W32LED4K-G2	32	350	37	4267	115.2	B1-U0-G1	4161	112.3	B1-U0-G1	4105	110.8	B1-U0-G1	4199	113.3	B1-U0-G1	4181	112.9	B3-U0-G1
55W32LED4K-G2	32	530	55	6121	111.4	B1-U0-G1	5968	108.6	B1-U0-G1	5889	107.1	B1-U0-G2	6023	109.6	B1-U0-G2	5998	109.1	B3-U0-G1
72W32LED4K-G2	32	700	72	7720	107.7	B2-U0-G1	7527	105.0	B1-U0-G2	7427	103.6	B1-U0-G2	7596	106.0	B1-U0-G2	7564	105.6	B3-U0-G2
97W32LED4K-G2	32	1050	105	10645	101.3	B2-U0-G2	10379	98.8	B2-U0-G2	10241	97.5	B2-U0-G2	10475	99.7	B2-U0-G2	10431	99.3	B4-U0-G2
55W48LED4K-G2	48	350	54	6401	119.1	B2-U0-G1	6241	116.1	B1-U0-G1	6158	114.6	B1-U0-G2	6299	117.2	B1-U0-G2	6272	116.7	B3-U0-G1
80W48LED4K-G2	48	530	80	9181	114.6	B2-U0-G2	8952	111.7	B2-U0-G2	8833	110.2	B2-U0-G2	9035	112.8	B2-U0-G2	8997	112.3	B3-U0-G2
108W48LED4K-G2	48	700	105	11579	109.9	B2-U0-G2	11290	107.2	B2-U0-G2	11140	105.8	B2-U0-G2	11395	108.2	B2-U0-G2	11346	107.7	B4-U0-G2
140W48LED4K-G2	48	1050	157	15967	101.5	B3-U0-G2	15568	98.9	B3-U0-G2	15361	97.6	B2-U0-G3	15713	99.9	B2-U0-G3	15646	99.4	B4-U0-G2
70W64LED4K-G2	64	350	69	8248	119.3	B2-U0-G1	7901	114.3	B2-U0-G2	7918	114.5	B1-U0-G2	8013	115.9	B1-U0-G2	7984	115.5	B3-U0-G2
110W64LED4K-G2	64	530	105	11831	112.9	B2-U0-G2	11333	108.1	B2-U0-G2	11357	108.3	B2-U0-G2	11493	109.6	B2-U0-G2	11452	109.2	B4-U0-G2
145W64LED4K-G2	64	700	140	14921	106.7	B3-U0-G2	14293	102.2	B2-U0-G2	14323	102.4	B2-U0-G3	14495	103.7	B2-U0-G2	14443	103.3	B4-U0-G2
195W64LED4K-G2	64	1050	214	20576	96.0	B3-U0-G3	19709	91.9	B3-U0-G3	19751	92.1	B3-U0-G3	19988	93.2	B3-U0-G3	19915	92.9	B5-U0-G3
90W80LED4K-G2	80	350	87	10310	118.6	B2-U0-G2	9876	113.6	B2-U0-G2	9897	113.9	B2-U0-G2	10016	115.2	B2-U0-G2	9980	114.8	B4-U0-G2
135W80LED4K-G2	80	530	131	14789	112.5	B3-U0-G2	14166	107.8	B2-U0-G2	14196	108.0	B2-U0-G3	14366	109.3	B2-U0-G2	14314	108.9	B4-U0-G2
180W80LED4K-G2	80	700	175	18652	106.7	B3-U0-G2	17866	102.2	B3-U0-G2	17904	102.4	B2-U0-G3	18119	103.6	B3-U0-G3	18053	103.2	B4-U0-G2
110W96LED4K-G2	96	350	101	12372	122.1	B3-U0-G2	11852	117.0	B2-U0-G2	11877	117.2	B2-U0-G2	12019	118.6	B2-U0-G2	11976	118.2	B4-U0-G2
160W96LED4K-G2	96	530	158	17747	112.4	B3-U0-G2	17000	107.6	B3-U0-G2	17035	107.9	B3-U0-G3	17240	109.1	B3-U0-G3	17177	108.7	B4-U0-G2
215W96LED4K-G2	96	700	209	22382	107.0	B3-U0-G3	21440	102.5	B3-U0-G3	21485	102.7	B3-U0-G4	21743	104.0	B3-U0-G3	21664	103.6	B5-U0-G3
Sag Lens MSC 4000K																		
35W32LED4K-G2	32	350	37	4305	116.2	B1-U0-G1	4245	114.6	B1-U0-G1	4199	113.3	B1-U0-G1	4243	114.5	B1-U0-G1	4308	116.3	B3-U0-G1
55W32LED4K-G2	32	530	55	6175	112.3	B1-U0-G1	6089	110.8	B1-U0-G2	6023	109.6	B1-U0-G2	6087	110.7	B1-U0-G2	6180	112.4	B3-U0-G2
72W32LED4K-G2	32	700	72	7788	108.7	B2-U0-G2	7680	107.2	B1-U0-G2	7596	106.0	B1-U0-G2	7676	107.1	B1-U0-G2	7794	108.8	B3-U0-G2
97W32LED4K-G2	32	1050	105	10740	102.2	B2-U0-G2	10590	100.8	B2-U0-G2	10474	99.7	B2-U0-G2	10585	100.7	B2-U0-G2	10747	102.3	B4-U0-G2
55W48LED4K-G2	48	350	54	6458	120.2	B1-U0-G1	6368	118.5	B1-U0-G2	6298	117.2	B1-U0-G2	6365	118.5	B1-U0-G2	6462	120.3	B3-U0-G2
80W48LED4K-G2	48	530	80	9263	115.6	B2-U0-G2	9134	114.0	B2-U0-G2	9034	112.7	B1-U0-G2	9130	113.9	B2-U0-G2	9269	115.7	B4-U0-G2
108W48LED4K-G2	48	700	105	11683	110.9	B2-U0-G2	11519	109.4	B2-U0-G2	11394	108.2	B2-U0-G2	11515	109.3	B2-U0-G2	11690	111.0	B4-U0-G2
140W48LED4K-G2	48	1050	157	16109	102.4	B3-U0-G2	15884	100.9	B2-U0-G3	15711	99.8	B2-U0-G3	15878	100.9	B2-U0-G3	16120	102.4	B4-U0-G2
70W64LED4K-G2	64	350	69	8241	119.2	B2-U0-G2	8053	116.5	B1-U0-G2	7918	114.5	B1-U0-G2	8246	119.3	B1-U0-G2	8337	120.6	B3-U0-G2
110W64LED4K-G2	64	530	105	11821	112.8	B2-U0-G2	11550	110.2	B2-U0-G2	11357	108.3	B2-U0-G2	11828	112.8	B2-U0-G2	11958	114.1	B4-U0-G2
145W64LED4K-G2	64	700	140	14909	106.6	B3-U0-G2	14567	104.2	B2-U0-G2	14323	102.4	B2-U0-G3	14917	106.7	B2-U0-G3	15082	107.9	B4-U0-G2
195W64LED4K-G2	64	1050	214	20558	95.9	B3-U0-G3	20087	93.7	B3-U0-G3	19751	92.1	B3-U0-G3	20569	96.0	B3-U0-G4	20797	97.0	B5-U0-G3
90W80LED4K-G2	80	350	87	10302	118.5	B2-U0-G2	10066	115.8	B2-U0-G2	9897	113.9	B2-U0-G2	10307	118.6	B2-U0-G2	10421	119.9	B4-U0-G2
135W80LED4K-G2	80	530	131	14776	112.4	B3-U0-G2	14438	109.8	B2-U0-G2	14196	108.0	B2-U0-G3	14784	112.5	B2-U0-G3	14948	113.7	B4-U0-G2
180W80LED4K-G2	80	700	175	18636	106.6	B3-U0-G2	18209	104.1	B3-U0-G3	17904	102.4	B2-U0-G3	18646	106.6	B3-U0-G3	18852	107.8	B5-U0-G3
110W96LED4K-G2	96	350	101	12362	122.0	B2-U0-G2	12079	119.2	B2-U0-G2	11877	117.2	B2-U0-G2	12369	122.1	B2-U0-G2	12505	123.4	B4-U0-G2
160W96LED4K-G2	96	530	158	17731	112.3	B3-U0-G2	17326	109.7	B3-U0-G3	17035	107.9	B2-U0-G3	17741	112.3	B2-U0-G3	17937	113.6	B5-U0-G3
215W96LED4K-G2	96	700	209	22363	106.9	B3-U0-G3	21851	104.5	B3-U0-G3	21485	102.7	B3-U0-G4	22375	107.0	B3-U0-G4	22623	108.2	B5-U0-G3

Actual performance may vary due to installation variables including optics, mounting/ceiling height, dirt depreciation, light loss factor, etc.; highly recommended to confirm performance with a layout - contact Applications at signify.com/outdoorluminaires.

Note: Some data may be scaled based on tests of similar. But not identical luminaires.

LED Performance

Predicted lumen depreciation data ¹					
Ordering Code	Ambient Temperature (°C)	Driver mA	Calculated L ₇₀ hours ^{1,2}	L ₇₀ per TM-21 ³	Lumen Maintenance % @ 60,000 hours
MSC-215W96LED4K	25°C	700 mA	>100,000	>60,000	94.01%
MSC-195W64LED4K	25°C	1050 mA	>100,000	>60,000	96.85%

1. Predicted performance derived from LED manufacturer's data and engineering design estimates, based on IESNA LM-80 methodology. Actual experience may vary due to field application conditions.
2. L₇₀ is the predicted time when LED performance depreciates to 70% of initial lumen output.
3. Calculated per IESNA TM21-11. Published L₇₀ hours limited to 6 times actual LED test hours.

MSC UrbanScape LED Pendant

Urban Luminaire

Specifications

Cage

In a round shape, this cage is made of four cast aluminum 356 decorative arms welded to the housing and to the access mechanism.

Housing

In a round shape, this housing is made of cast 356 aluminum, c/w a watertight grommet, mechanically assembled to the bracket with four bolts 3/8 16 UNC. This suspension system permits for a full rotation of the luminaire in 90° increments. The housing is complete with a watertight access cap mechanically secured with two captive screws, giving access to the driver. Rated IP66.

Access-Mechanism

Made of cast aluminum 356 technical, ring with latch and hinge. The mechanism shall offer tool free access to the Light engine.

Light Engine

LEDgine composed of 4 main components: LED lamp / Optical System / Heat Sink / Driver. Electrical components are RoHS compliant.

LExF Lens

Flat Lens: Made of soda lime tempered glass, mechanically assembled and sealed onto the ring of the access mechanism. Dark Sky compliant with 0% uplight and U0 per IESNA TM 15.

LExS Lens

Sag Lens: Made of soda lime clear tempered glass, mechanically assembled and sealed onto the ring of the access mechanism.

LED Module

LED type Lumileds LUXEON T. Composed of high performance white LEDs. Color temperature of 4000 Kelvin nominal, 70 CRI. Operating lifespan 100,000 hours (see chart for specific lifetime based on mA) based on TM 21 extrapolation to get results after which 50% of LEDs still emits over 70% (L70) of its original lumen output. Use of metal core board ensures greater heat transfer and longer lifespan of the light engine.

Optical System

Composed of high performance optical polymer refractor lenses to achieve desired distribution optimized to get maximum spacing, target lumens and a superior lighting uniformity. System is rated IP66. Performance shall be tested per LM 63, LM 79 and TM 15 (IESNA) certifying its photometric performance. Street side indicated.

Heat Sink

Made of cast aluminum optimizing the LEDs efficiency and life. Product does not use any cooling device with moving parts (only passive cooling device).

Driver

High power factor of 95%. Electronic driver, operating range 50/60 Hz. Auto adjusting universal voltage input from 120 to 277 and 347 to 480 VAC rated for both application line to line or line to neutral, Class I, THD of 20% max. Maximum ambient operating temperature from 40°F (40°C) to 130°F (55°C). Certified in compliance to UL1310 cULus requirement. Dry and damp location. Assembled on a unitized removable tray with Tyco quick disconnect plug resisting to 221°F (105°C). Dimmable driver 0-10V. The current supplying the LEDs will be reduced by the driver if the driver experiences internal overheating as a protection to the LEDs and the electrical components. Output is protected from short circuits, voltage overload and current overload. Automatic recovery after correction. Standard built in driver surge protection of 2.5kV (min).

Surge Protector

Surge protector tested in accordance with ANSI/IEEE C62.45 per ANSI/IEEE C62.41.2 Scenario I Category C High Exposure 10kV/10kA waveforms for Line Ground, Line Neutral and Neutral Ground, and in accordance with U.S. DOE (Department of Energy) MSSLC (Municipal Solid State Street Lighting Consortium) model specification for LED Urban luminaires electrical immunity requirements for High Test Level 10kV / 10kA.

Driver options

AST: Pre-set driver for progressive start-up of the LED module(s) to optimize energy management and enhance visual comfort at start-up.

CLO: Pre-set driver to manage the lumen depreciation by adjusting the power given to the LEDs offering the same lighting intensity during the entire lifespan of the LED module.

DMG: Dimmable driver 0-10V.

OTL: Pre-set driver to signal end of life of the LED module(s) for better fixture management.

CDMG: Dynadimmer standard dimming functionalities including pre-programmed scenarios to suit many applications and needs from safety to maximum energy savings.

Order Code	Scenario	Dim. Time	Dim. Level
CDMGS25	Safety	4 hours	25% power
CDMGS50	Safety	4 hours	50% power
CDMGS75	Safety	4 hours	75% power
CDMGM25	Median	6 hours	25% power
CDMGM50	Median	6 hours	50% power
CDMGM75	Median	6 hours	75% power
CDMGE25	Economy	8 hours	25% power
CDMGE50	Economy	8 hours	50% power
CDMGE75	Economy	8 hours	75% power

Luminaire options



HS
House side shield

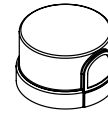

PH8 (allows a 90° rotation)
Photoelectric Cell, Twist-lock Type complete with receptacle.

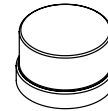

PH9
Shorting cap, Twist-lock Type complete with receptacle.

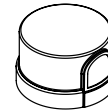

PHXL (allows a 90° rotation)
Extended life photoelectric cell, Twist-lock Type complete with receptacle.

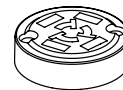

RCD
Receptacle 5-pins allowing dimming, can be used with a twist-lock Starsense, shorting cap or a photoelectric cell.

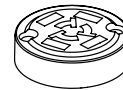

RCD7
Receptacle 7-pins.

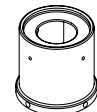

TN3
Fitter to fit over a 3" (76 mm) O.D. by 4" (102 mm) tenon.

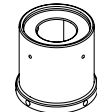

TN3.5
Fitter to fit over a 3-1/2" (89 mm) O.D. by 4" (102 mm) tenon.



BX
Bird repellent.

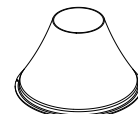

DH
Opaque decorative hood.

MSC UrbanScape LED Pendant

Urban Luminaire

Specifications (continued)

Adapters

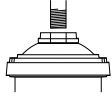

MA1

The luminaire is suspended by means of a mounting adapter with a 1 1/4" (32mm) NPT threaded tube accepting a

threaded tube from the mounting. Retrofit adapter for existing mounting.

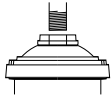

MA2

The luminaire is suspended by means of a mounting adapter with a 1 1/2" (38mm) NPT threaded hole accepting

threaded tube from the mounting. Retrofit adapter for existing mounting.

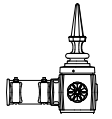

SMA

The luminaire is suspended by means of a decorative side-mounted cast aluminum adapter. This adapter accepts

tubes from 1 5/8" to 2 3/8" (41 to 60 mm) and is adjustable to more or less 5°. The adapter features a cast aluminum decorative cover and finial.

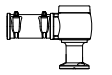

SMB

The luminaire is suspended by means of a decorative

side-mounted cast aluminum adapter. This adapter accepts tubes from 1 5/8" to 2 3/8" (41 to 60 mm) and is adjustable to more or less 5°.

Finish

Color to be in accordance with the AAMA 2603 standard. Application of polyester powder coat paint (4 mils/100 microns) with ± 1 mils/24 microns of tolerance. The Thermosetting resins provides a discoloration resistant finish in accordance with the ASTM D2244 standard, as well as luster retention in keeping with the ASTM D523 standard and humidity proof in accordance with the ASTM D2247 standard. The surface treatment achieves a minimum of 2000 hours for salt spray resistant finish in accordance with testing performed and per ASTM B117 standard.

Textured Finishes:

BE2TX: Midnight Blue

BE6TX: Ocean Blue

BE8TX: Royal Blue

BG2TX: Sandstone

BKTX: Black

BRTX: Bronze

GN4TX: Blue Green

GN6TX: Forest Green

GN8TX: Dark Forest Green

GNTX: Green

GY3TX: Medium Grey

RD2TX: Burgundy

RD4TX: Scarlet

WHTX: White

Other Finishes:

GR: Gray Sandtex

NP: Natural Alum.

TG: Hammer-tone

Gold

TS: Hammer-tone

Silver

LED manufacturing standard

The electronic components sensitive to electrostatic discharge (ESD) such as light emitting diodes (LEDs) are assembled in compliance with IEC61340 5 1 and ANSI/ESD S20.20 standards so as to eliminate ESD events that could decrease the useful life of the product.

Hardware

All exposed screws shall be stainless steel with Ceramic primer seal basecoat to reduce seizing of the parts. All seals and sealing devices are made and/or lined with EPDM and/or silicone and/or rubber.

Wiring

Gauge (#14) TEW/AWM 1015 or 1230 wires, 6" (152mm) minimum exceeding from luminaire.

Quality Control

Manufactured to ISO 9001 2008 and ISO 14001 2004 International Quality Standards Certification.

Vibration Resistance

Meets the ANSI C136.31, American National Standard for Roadway Luminaire Vibration specifications for Bridge/overpass applications. (Tested for 3G over 100 000 cycles by an independent lab).

Service Tag

Each individual luminaire is uniquely identifiable, thanks to the Service tag application. With a simple scan of a QR code, placed inside the luminaire, you gain instant access to the luminaire configuration, making installation and maintenance operations faster and easier, no matter what stage of the luminaire's lifetime. Just download the APP and register your product right away.

For more details visit: signify.com/servicetag

Certifications and Compliance

CSA, cULus Listed for Canada and USA. MetroScape is on the DesignLights Consortium (DLC) Qualified Products List (QPL).

