



The art of design options / **Bollards and Light Columns** add a measure of refinement and originality to any design. They complete a setting and tie-in architectural elements to create a harmonious effect that sets projects apart. They are perfectly suited to embellish and enhance the comfort of parks, walkways, recreational activity sites and building entryways.

Project: _____

Location: _____

Cat.No: _____

Type: _____

Lamps: _____ Qty: _____

Notes: _____

Bollard OVB

Ordering guide

example: OVB-6LEDB-120-VPA-NP

Product	Lamp	Voltage	Options	Finish ¹
OVB				
OVB	6LEDB Blue	120 120V	PH Photocell	BE2TX Midnight Blue Textured
	6LEDE Red	208 208V	VPA Vandalproof hardware	BE6TX Ocean Blue Textured
	6LEDW White	240 240V		BE8TX Royal Blue Textured
				BG2TX Sandstone Gold Textured
				BKTX Black Textured
				BRTX Bronze Textured
				GN4TX Blue Green Textured
				GN6TX Forest Green Textured
				GN8TX Dark Forest Green Textured
				GNTX Green Textured
				GV3TX Medium Grey Textured
				RD2TX Burgundy Textured
				RD4TX Scarlet Textured
				WHTX White Textured
				NP Natural Alum.
				TG Hammer-tone
				TS Hammer-tone Silver

1. Consult Lumec's Color Chart for complete specifications.

OVB Bollard & Light Column Series

Bollard

Luminaires

Conform to the UL 1598 and CSA C22.2 No. 250.0-08 standards.

OVB Surface Mounting

OVB Underground Mounting

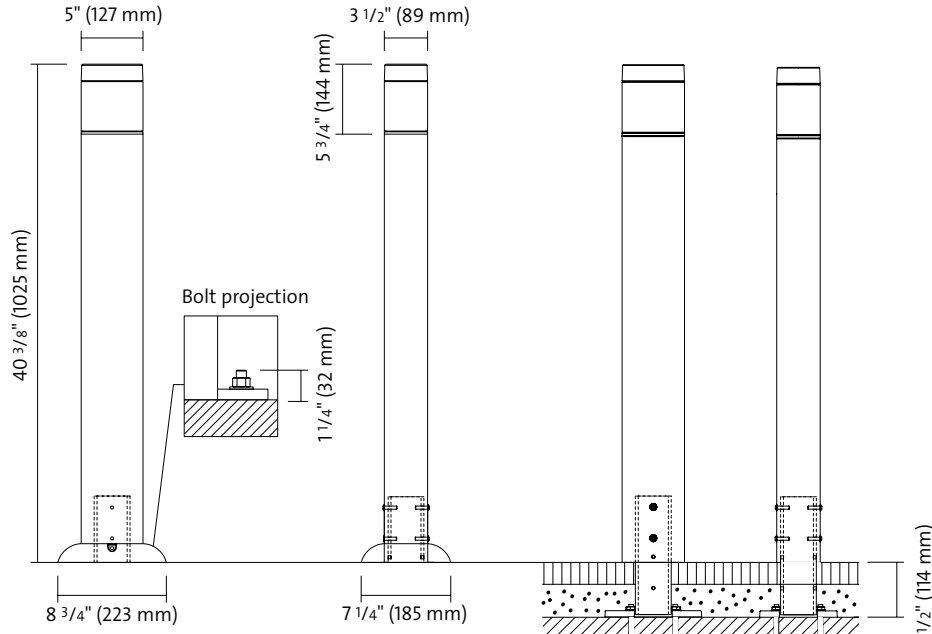

Anchor Plate

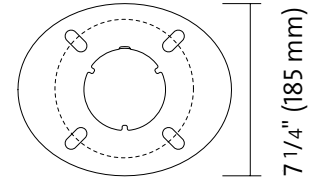

Bolt circle
5" (126mm)
Anchor bolts
3/8" Ø 12" to 6"
(10mm Ø 305mm)

Specifications

Hood

Die cast (356) aluminum cover.

Body

Made from a 5" (127mm) wide by 3 1/2" (89mm) deep, elliptical, extruded (6061-T6) aluminum tubing, having a 0.250" (6.4mm) wall thickness, mechanically assembled to the anchor plate at the bottom of the bollard with 4 steel anchor bolts.

Two mounting possible:

Surface mounting: A base cover hides the anchor plate and the bolts.

Underground mounting: The anchor plate and the bolts are located 4 1/2" (114mm) below apparent ground level.

Lens

Clear acrylic, elliptical lens, satin finish and internal flute.

6LEDA/6LEDB/6LEDG/6LEDR/6LEDW

Lamp 6-watt light-emitting diodes (LEDs).

Driver

High power factor of 90%. Electronic driver, operating range 50-60 kHz. Lamp starting capacity of -40°F (-40°C). Assembled on a tray with quick disconnect plug.

Access Mechanism

Four screws integrated to the base of the body offer access to the inside of the luminaire and to the lamp.

Base cover

Oval shaped, one piece cast (356) aluminum base cover mechanically fastened with two stainless steel screws.

Finish

"Hot dip" chemical etching preparation. Lumital™ polyester powder coat finish. Excellent color retention as per #ASTM D2244, and outstanding salt-spray resistance according to #ASTM D2247 testing procedures.

OV1 Bollard & Light Column Series

Light Column

Light Column OV1

Ordering guide

example: OV1-6LEDB-208-12-PH-NP

Product	Lamp	Voltage	Light Column Height (ft.)		Options	Finish ¹
OV1						
OV1	6LEDB Blue	120 120V	3.5	11.5	PH Photocell VPA Vandalproof hardware	BE2TX Midnight Blue Textured
	6LEDE Red	208 208V	4	12		BE6TX Ocean Blue Textured
	6LEDW White	240 240V	4.5	12.5	BE8TX Royal Blue Textured	
			5	13	BG2TX Sandstone Gold Textured	
			5.5	13.5	BKTX Black Textured	
			6	14	BRTX Bronze Textured	
			6.5	14.5	GN4TX Blue Green Textured	
			7	15	GN6TX Forest Green Textured	
			7.5	15.5	GN8TX Dark Forest Green Textured	
			8	16	GNTX Green Textured	
			8.5	16.5	GY3TX Medium Grey Textured	
			9	17	RD2TX Burgundy Textured	
			9.5	17.5	RD4TX Scarlet Textured	
			10	18	WHTX White Textured	
			10.5	18.5	NP Natural Alum.	
			11		TG Hammer-tone	
					TS Hammer-tone Silver	

1. Consult Lumec's Color Chart for complete specifications.

OV1 Bollard & Light Column Series

Light Column

Luminaires

Conform to the UL 1598 and CSA C22.2 No. 250.0-08 standards.

OV1

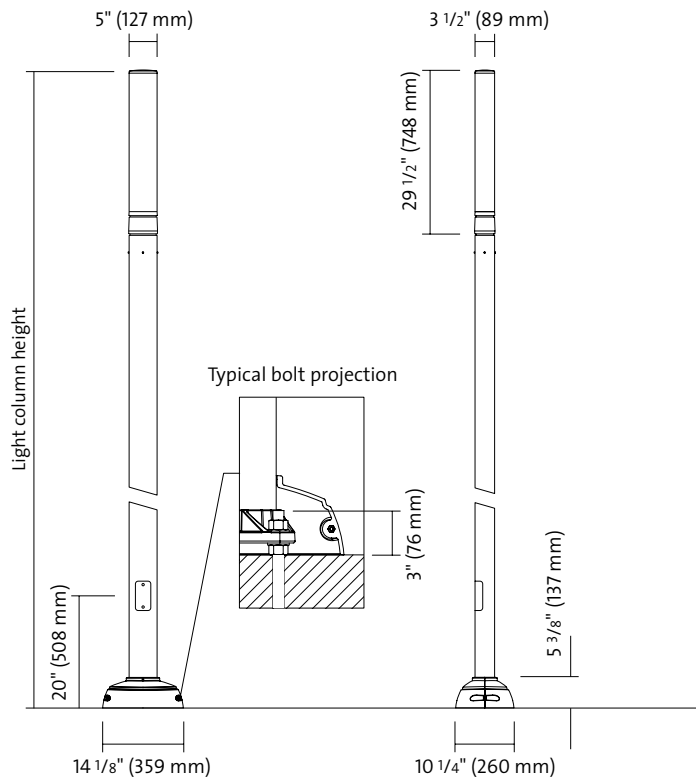

Anchor Plate

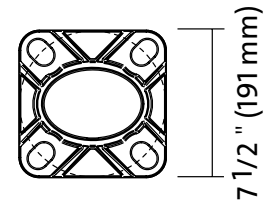

Bolt circle
 7-1/2" Ø (191mm)
 B.C. allowed:
 7" to 8" (178mm to 203mm)

Mounting details

Comes with 4 steel anchor bolts,
 3/4" x 20", (19mm x 508mm)
 4 nuts and 4 washers.

Important: Do not obstruct space between anchor plate and concrete base.

Assembly examples

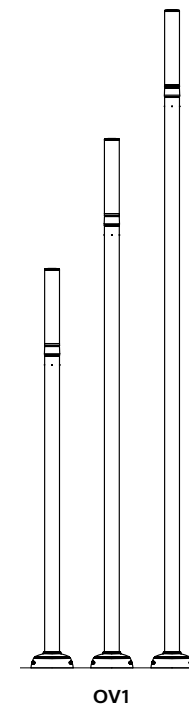

Specifications

Luminaire

Housing made from an elliptical die cast (356) aluminum frame of 5" (127mm) wide by 3-1/2" (89 mm) deep having a 0.188" (4.7mm) wall thickness. The housing is mechanically assembled to the pole. Clear acrylic, elliptical lens with a satin finish, fluted internally and mechanically assembled to the housing.

Driver

High power factor of 90%. Electronic driver, operating range: 50-60 kHz. Lamp starting capacity of -40°F (-40°C). Assembled on a tray with quick disconnect plug.

Pole Shaft

Made from 5" (127mm) wide by 3 1/2" (89mm) deep, elliptical, extruded (6061-T6) aluminum tubing, having a 0.250" (6.4mm) wall thickness, welded to both the bottom and top of the anchor plate.

Base cover

Oval shaped, two piece cast (356) aluminum base cover mechanically fastened with stainless steel screws.

Finish

"Hot dip" chemical etching preparation. Lumital™ polyester powder coat finish. Excellent color retention as per #ASTM D2244, and outstanding salt-spray resistance according to #ASTM D2247 testing procedures.

OV2 Bollard & Light Column Series

Light Column

Light Column OV2

Ordering guide

example: OV1-6LEDB-208-12-PH-NP

Product	Lamp	Voltage	Light Section (ft.)	Light Column Height (ft.)		Options	Finish ¹
OV2							
OV2	70 MH²	120 120V	LH3	6³	13	PH Photocell	BE2TX Midnight Blue Textured
		208 208V	LH4	6.5³	13.5		BE6TX Ocean Blue Textured
		240 240V	4.5	7⁴	14		BE8TX Royal Blue Textured
		277 277V	LH5	7.5⁴	14.5		BG2TX Sandstone Gold Textured
		347 347V	LH6	8⁵	15		BKTX Black Textured
				8.5⁵	15.5		BRTX Bronze Textured
				9	16		GN4TX Blue Green Textured
				9.5	16.5		GN6TX Forest Green Textured
				10	17		GN8TX Dark Forest Green Textured
				10.5	17.5		GNTX Green Textured
				11	18		GY3TX Medium Grey Textured
				11.5	18.5		RD2TX Burgundy Textured
				12	19		RD4TX Scarlet Textured
		12.5	19.5	WHTX White Textured			
				NP Natural Alum.			
				TG Hammer-tone			
				TS Hammer-tone Silver			

1. Consult Lumec's Color Chart for complete specifications.
2. Lamp 70 watts PAR30 spot beam version (not included).
3. Only available with luminous section LH3
4. Only available with luminous section LH3 or LH4
5. Only available with luminous section LH3, LH4 or LH4
6. Lower maintenance opening not included in heights below 8.5 feet.

OV2 Bollard & Light Column Series

Light Column

Luminaires

Conform to the UL 1598 and CSA C22.2 No. 250.0-08 standards.

OV2

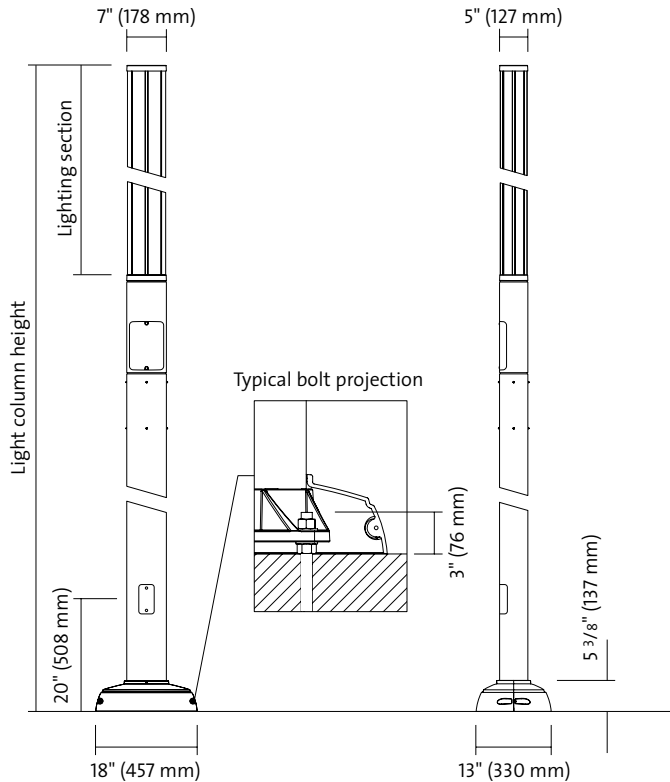

Specifications

Luminaire

Housing made from an elliptical die cast (356) aluminum frame of 7" (178mm) wide by 5" (127mm) deep having a 0.188" (4.7mm) wall thickness with an extruded aluminum guard. The housing is mechanically assembled to the pole. The housing has a 4 1/2" x 6" (114 x 152mm) maintenance opening, complete with a weatherproof aluminum cover. Clear acrylic, elliptical lens with a satin finish and internal flute. Mechanically assembled to the housing.

Ballast

High power factor of 90%. Lamp starting capacity of -20°F (-30°C). Assembled on a unitized removable tray with quick disconnect plug.

Pole Shaft

Made from 7" (178mm) wide by 5" (127mm) deep, elliptical, extruded (6061-T6) aluminum tubing, having a 0.250" (6.4mm) wall thickness, welded to both the bottom and top of the anchor plate.

Base cover

Oval shaped, two piece cast (356) aluminum base cover mechanically fastened with stainless steel screws.

Finish

"Hot dip" chemical etching preparation. Lumital™ polyester powder coat finish. Excellent color retention as per #ASTM D2244, and outstanding salt-spray resistance according to #ASTM D2247 testing procedures.

Anchor Plate

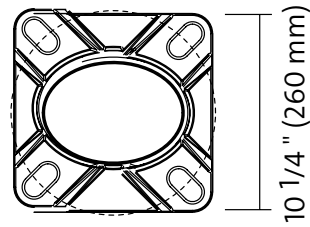

Bolt circle

10-1/2" Ø (267mm)

B.C. allowed:

9-1/2" to 11-1/2" (267mm to 292mm)

Mounting details

Comes with 4 steel anchor bolts,

3/4" x 20", (19mm x 508mm)

4 nuts and 4 washers.

Important: Do not obstruct space between anchor plate and concrete base.

Assembly examples

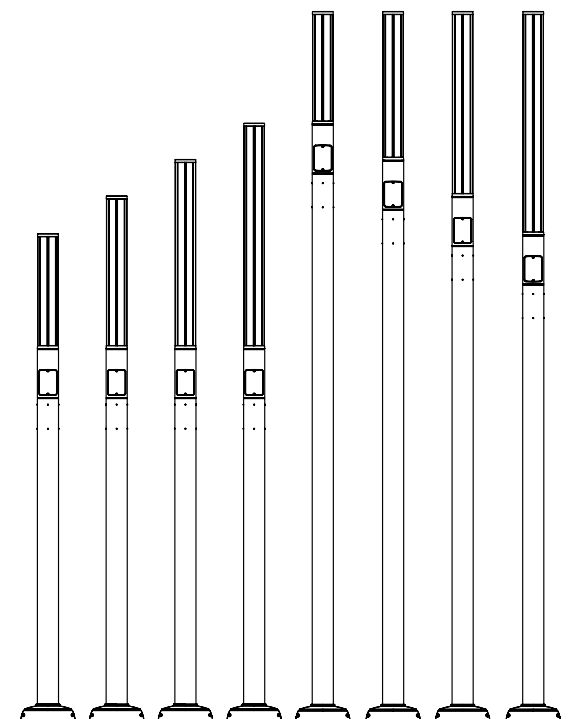

OV2

CALB1 Bollard & Light Column Series

Bollard

CALB1

Ordering guide

example: CALB1-50HPS-240-PH-VPA-BE2TX

Product	Lamp	Voltage	Options	Finish ¹
CALB1				
CALB1	50 MH	120 120V	PH Photocell	BE2TX Midnight Blue Textured
	70 MH	208 208V	VPA Vandalproof hardware	BE6TX Ocean Blue Textured
	35 HPS	240 240V		BE8TX Royal Blue Textured
	50 HPS	277 277V		BG2TX Sandstone Gold Textured
	70 HPS	347 347V		BKTX Black Textured
	18 CF			BRTX Bronze Textured
	26 CF			GN4TX Blue Green Textured
	32 CF			GN6TX Forest Green Textured
	42 CF			GN8TX Dark Forest Green Textured
	6LEDB Blue	20 120V		GNTX Green Textured
	6LEDE Red	208 208V		GY3TX Medium Grey Textured
	6LEDW White	240 240V		RD2TX Burgundy Textured
				RD4TX Scarlet Textured
				WHTX White Textured
				NP Natural Alum.
				TG Hammer-tone
				TS Hammer-tone Silver

1. Consult Lumec's Color Chart for complete specifications.

Socket: GX24Q-2 (18W), GX24Q-3 (26W)(32W), GX24Q-4 (42W), triple tube for compact fluorescent (lamp not included).

CALB1 Bollard & Light Column Series

Bollard

Luminaires

Conform to the UL 1598 and CSA C22.2 No. 250.0-08 standards.

CALB1

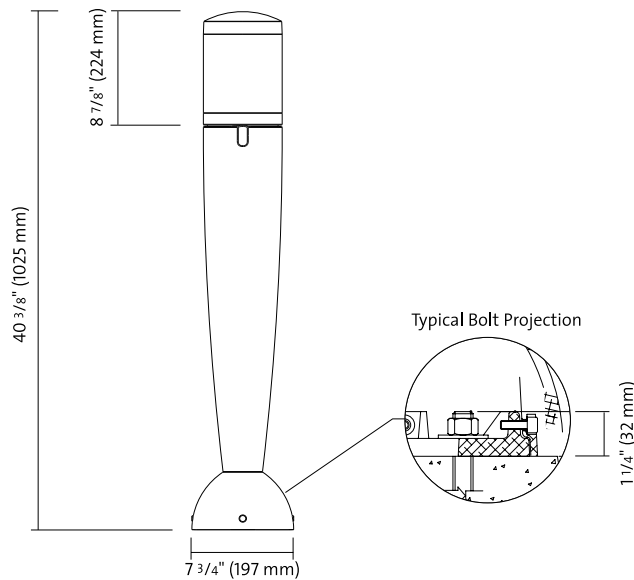

Anchor Plate

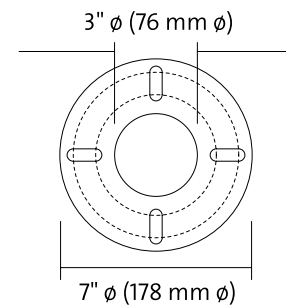

Bolt circle
5-1/2" (140mm)
B.C. possible:
from 4-3/8" to 6" (111mm to 152mm)

Mounting details

Comes with 4 steel anchor bolts,
3/8" x 12" (10mm x 305mm),
4 nuts and 4 washers.

Important: Do not obstruct space between anchor plate
and concrete base.

Specifications

Hood

Made of die cast (356) aluminum, assembled mechanically.

Lens

Made of clear acrylic.

Base

Made of die cast (356) aluminum, mechanically assembled to the anchor plate.

Bollard Options

Stainless steel coated decorative screen. Also available with copper coated decorative screen.

Finish

"Hot dip" chemical etching preparation. Lumital™ polyester powder coat finish. Excellent color retention as per #ASTM D2244, and outstanding salt-spray resistance according to #ASTM B117 testing procedures.

Hardware

All exposed screws are made from stainless steel. All seals and sealing devices are made and/or lined with EPDM and/or silicone.

Ballast / HID

High power factor of 98%. Electronic compact fluorescent ballast, operating range: 50Hz - 60Hz. Programmed rapid start. Lamp minimum starting temperature of 0°F (-18°C), w/ auto reset shutdown circuit. Assembled on a tray with quick disconnect plug.

Ballast / 6LEDA/6LEDB/6LEDG/6LEDR/6LEDW

Lamp

6-watt light-emitting diodes (LEDs).

Driver

High power factor of 90%. Electronic driver, operating range 50Hz - 60Hz. Lamp minimum starting temperature of -40°F (-40°C).

CALB2 Bollard & Light Column Series

Bollard

CALB2

Ordering guide

example: CALB2-50HPS-240-PH-VPA-BE2TX

Product	Lamp	Voltage	Options	Finish ¹
CALB2				
CALB2	50 MH	120 120V	PH Photocell	BE2TX Midnight Blue Textured
	70 MH	208 208V	VPA Vandalproof hardware	BE6TX Ocean Blue Textured
	35 HPS	240 240V		BE8TX Royal Blue Textured
	50 HPS	277 277V		BG2TX Sandstone Gold Textured
	70 HPS	347 347V		BKTX Black Textured
	18 CF			BRTX Bronze Textured
	26 CF			GN4TX Blue Green Textured
	32 CF			GN6TX Forest Green Textured
	42 CF			GN8TX Dark Forest Green Textured
	6LEDB Blue	20 120V		GNTX Green Textured
	6LEDE Red	208 208V		GY3TX Medium Grey Textured
	6LEDW White	240 240V		RD2TX Burgundy Textured
				RD4TX Scarlet Textured
				WHTX White Textured
				NP Natural Alum.
				TG Hammer-tone
				TS Hammer-tone Silver

1. Consult Lumec's Color Chart for complete specifications.

Socket: GX24Q-2 (18W), GX24Q-3 (26W)(32W), GX24Q-4 (42W), triple tube for compact fluorescent (lamp not included).

CALB2 Bollard & Light Column Series

Bollard

Luminaires

Conform to the UL 1598 and CSA C22.2 No. 250.0-08 standards.

CALB2

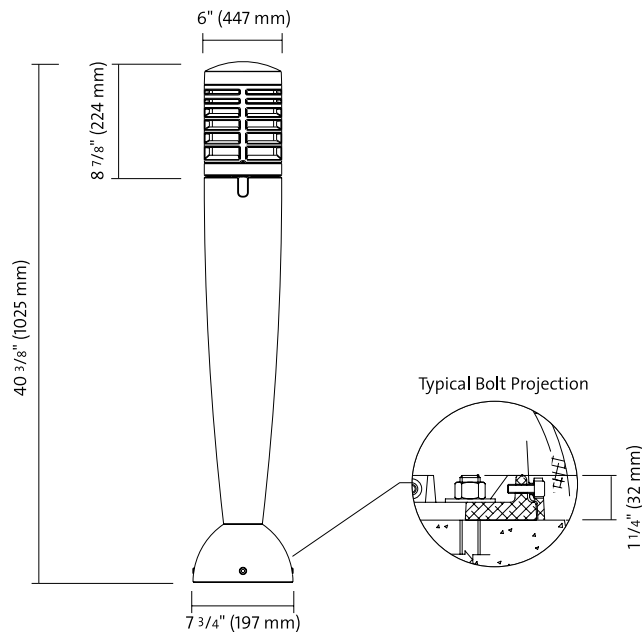

Anchor Plate

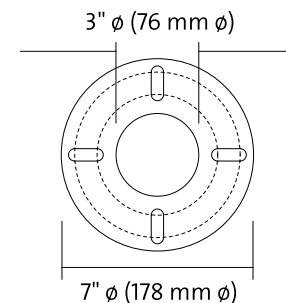

Bolt circle
5-1/2" (140mm)
B.C. possible:
from 4-3/8" to 6" (111mm to 152mm)

Mounting details

Comes with 4 steel anchor bolts,
3/8" x 12" (10mm x 305mm),
4 nuts and 4 washers.

Important: Do not obstruct space between anchor plate
and concrete base.

Specifications

Hood

Made of die cast (356) aluminum, assembled mechanically.

Lens

Made of clear acrylic.

Base

Made of die cast (356) aluminum, mechanically assembled to the anchor plate.

Bollard Options

Stainless steel coated decorative screen. Also available with copper coated decorative screen.

Finish

"Hot dip" chemical etching preparation. Lumital™ polyester powder coat finish. Excellent color retention as per #ASTM D2244, and outstanding salt-spray resistance according to #ASTM B117 testing procedures.

Hardware

All exposed screws are made from stainless steel. All seals and sealing devices are made and/or lined with EPDM and/or silicone.

Ballast / HID

High power factor of 98%. Electronic compact fluorescent ballast, operating range: 50Hz - 60Hz. Programmed rapid start. Lamp minimum starting temperature of 0°F (-18°C), w/ auto reset shutdown circuit. Assembled on a tray with quick disconnect plug.

Ballast / 6LEDA/6LEDB/6LEDG/6LEDR/6LEDW

Lamp

6-watt light-emitting diodes (LEDs).

Driver

High power factor of 90%. Electronic driver, operating range 50Hz - 60Hz. Lamp minimum starting temperature of -40°F (-40°C).

Assembled on a tray with quick disconnect plug.

CANDB Bollard & Light Column Series

Bollard

CANDB

Ordering guide

example: CANDB1-70MH-RR3-120-DR-NP

Product	Lamp	Optical System	Voltage	Options	Finish ¹
CANDB1	50MH medium	FRN	120 120V	DE⁴ Direct burial	BE2TX Midnight Blue Textured
CANDB2	70MH medium	FRNB	208 208V	DR⁵ Duplex receptacle (120V only)	BE6TX Ocean Blue Textured
CANDB3	100MH medium	RR3	240 240V	GFI⁶ Duplex receptacle with ground fault interruptor on mounting (120V only)	BE8TX Royal Blue Textured
CANDB4		RR3MD	277 277V	GT⁷ Luminous hood	BG2TX Sandstone Gold Textured
CANDB1M-CNB-M²		RR5	347 347V	PH7⁸ Photoelectric cell	BKTX Black Textured
	35HPS medium		20 120V	VPA⁹ Vandal proof hardware	BRTX Bronze Textured
	50HPS medium		208 208V	H¹⁰ Variable height, from 15" (380mm) to 48" (1220mm), 1" (25mm) increments. Ballast is remote up to 24" (610mm)	GN4TX Blue Green Textured
	70HPS medium		240 240V		GN6TX Forest Green Textured
	100HPS medium				GN8TX Dark Forest Green Textured
	18CF³				GNTX Green Textured
	26CF³				GY3TX Medium Grey Textured
	32CF³				RD2TX Burgundy Textured
	42CF³				RD4TX Scarlet Textured
					WHTX White Textured
					NP Natural Alum.
					TG Hammer-tone
					TS Hammer-tone Silver

1. Consult Lumec's Color Chart for complete specifications.
2. Remote ballast.
3. Socket: GX24Q-2 (18W), GX24Q-3 (26 or 32W), GX24Q-4 (42W), triple tube compact fluorescent (lamp not included).
4. DE: Direct burial.
5. DR: Duplex receptacle (120V only)
6. GFI: Duplex receptacle with ground fault interruptor on mounting (120V only).
7. GT: Luminous hood.
8. PH7: Photoelectric cell.
9. VPA: Vandal proof hardware.
10. H: Variable height, from 15" (380mm) to 48" (1220mm), in 1" (25mm) increments. Ballast is remote up to 24" (610mm).

Specifications

Hood

Made from cast aluminum (356), mechanically assembled.

Guard

Made from four molded aluminum(356) rods of 0.840" (21mm) outside diameter, mechanically assembled to the housing.

Closing system

Two screws on a housing gives access to the luminaire interior and the lamp.

Housing

Made from cast aluminum (356), mechanically assembled.

Louvers

Made from cast aluminium (356), mechanically assembled.

Hardware

All exposed hardware is stainless steel. All seals and sealing devices are made of and/or lined with EPDM and/or silicone.

Finish

"Hot dip" chemical etching preparation. Lumital™ polyester powder coat finish. Excellent color retention as per #ASTM D2244, and outstanding salt-spray resistance according to #ASTM B117 testing procedures.

CANDB1, CANDB2, CANDB3 and CANDB4

Base

Made from aluminum of 4-1/2" (114mm) of outside diameter, welded to the base cover.

Base-cover

Made from molded aluminum (356), mechanically secured to the anchor plate.

CANDB Bollard & Light Column Series

Bollard

Luminaires

Conform to the UL 1598 and CSA C22.2 No. 250.0-08 standards.

CANDB1

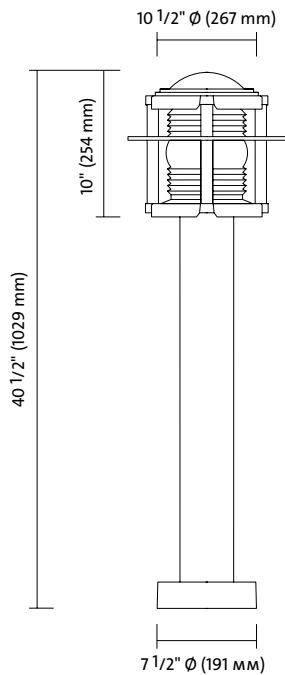

CANDB2

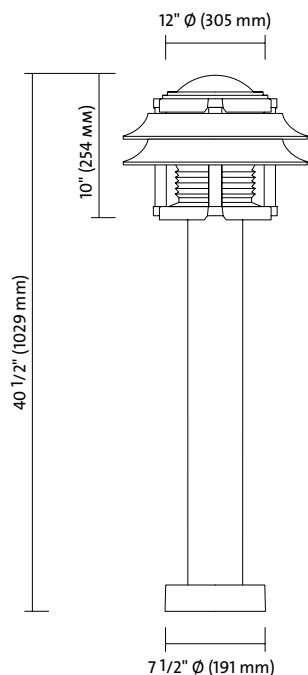

CANDB3

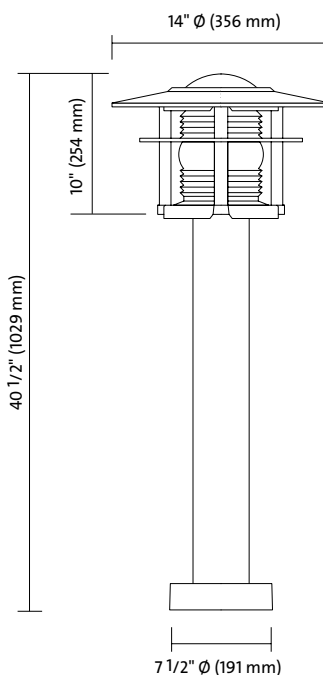

CANDB4

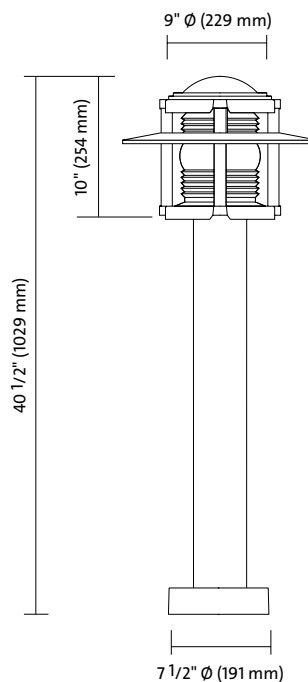

Anchor Plate

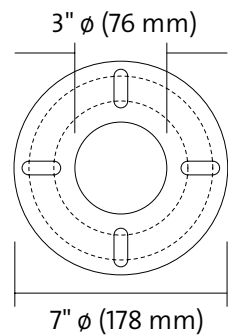

Bolt circle
5-1/2" (140mm)
B.C. possible:
from 4-3/8" to 6" (111mm to 152mm)

Mounting Details

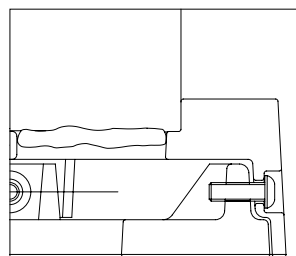

Mounting details
CANDB1, CANDB2, CANDB3
and CANDB4
Comes with 4 steel anchor bolts,
3/8" x 12" (10mm x 305mm),
4 nuts and 4 washers.

Important: Do not obstruct space between anchor plate and concrete base.

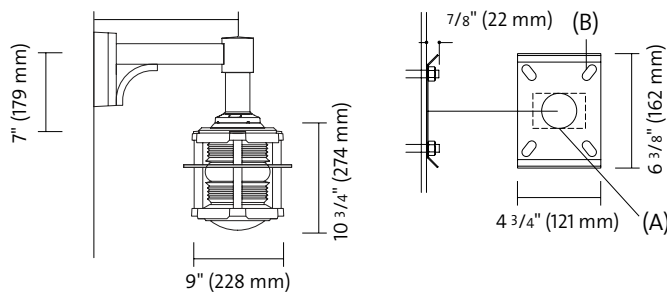

Mounting details CANDB1M-CNB-M

(A) One 2" hole (51mm) \varnothing for wiring.
(B) 4 oblong holes 1/2" x 1" (13mm x 25mm) for anchoring.
Horizontal junction box of 2" x 3" (51 x 76mm).
4 anchor bolts of 3/8" \varnothing (9.5mm) not included.

Important: Structural members must be present in wall to accept bolts.

DOSB1 Bollard & Light Column Series

Bollard

DOSB1

Ordering guide

example: DOSB1-50MH-120-PH7-BE2TX

Product	Lamp	Voltage	Options	Finish ¹
DOSB1	35 MH 50 MH	120 120V 208 208V 240 240V 277 277V 347 347V	PH7 Photoelectric cell VPA Vandalproof hardware	BE2TX Midnight Blue Textured BE6TX Ocean Blue Textured BE8TX Royal Blue Textured BG2TX Sandstone Gold Textured BKTX Black Textured BRTX Bronze Textured GN4TX Blue Green Textured GN6TX Forest Green Textured GN8TX Dark Forest Green Textured GNTX Green Textured GY3TX Medium Grey Textured RD2TX Burgundy Textured RD4TX Scarlet Textured WHTX White Textured NP Natural Alum. TG Hammer-tone TS Hammer-tone Silver
	35 HPS 50 HPS			
	18 CF 26 CF 32 CF			
	20W16LED4K 30W16LED4K	120 120V 208 208V 240 240V 277 277V		

1. Consult Lumec's Color Chart for complete specifications.

Socket: GX24Q-2 (18W), GX24Q-3 (26 or 32W), GX24Q-4 (42W), triple tube compact fluorescent (lamp not included).

DOSB1 Bollard & Light Column Series

Bollard

Luminaires

Conform to the UL 1598 and CSA C22.2 No. 250.0-08 standards.

DOSB1

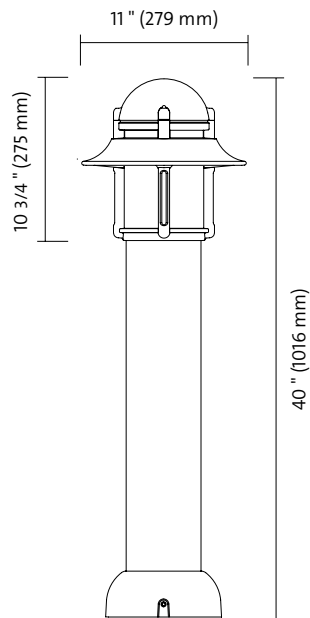

Anchor Plate

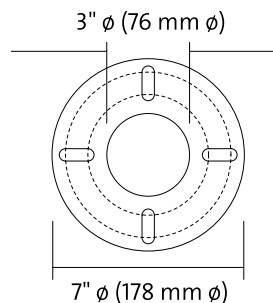

Bolt circle
5-1/2" (140mm)
B.C. possible:
from 4-3/8" to 6" (111mm to 152mm)

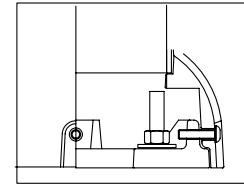

Mounting details

Comes with 4 steel anchor bolts,
3/8" x 12" (10mm x 305mm),
4 nuts and 4 washers.

Important: Do not obstruct space between anchor plate and concrete base.

Specifications

Hood

Made from cast (356) aluminum, mechanically assembled.

Housing

Round shape, made from cast (356) aluminum, c/w one louver, welded to the base.

Ballast

High power factor of 90%. Assembled on a unitized removable tray with quick disconnect plug.

Base

Made from aluminum, 5" (127mm) outside diameter, welded to the base cover.

Base cover

Made from cast (356) aluminum, mechanically secured to the anchor plate.

Finish

"Hot dip" chemical etching preparation. Lumital™ polyester powder coat finish. Excellent color retention as per #ASTM D2244, and outstanding salt-spray resistance according to #ASTM D2247 testing procedures.

BD8G Bollard & Light Column Series

Bollard

BD8G

Ordering guide

example: BD8G-70MH-240-PH7-BE6TX

Product	Lamp	Voltage	Options	Finish ¹
BD8G				
	50MH medium	120 120V	DE Direct burial	BE2TX Midnight Blue Textured
	70MH medium	208 208V	DR Duplex receptacle (120V only)	BE6TX Ocean Blue Textured
	100MH medium	240 240V	FS Fuse (Contact Lumec)	BE8TX Royal Blue Textured
		277 277V	GFI Duplex receptacle with ground fault interruptor on mounting (120V only)	BG2TX Sandstone Gold Textured
		347 347V	PH7 Photoelectric cell	BKTX Black Textured
	35HPS medium	480 480V	VPA Vandal proof hardware	BRTX Bronze Textured
	50HPS medium			GN4TX Blue Green Textured
	70HPS medium			GN6TX Forest Green Textured
	100HPS medium			GN8TX Dark Forest Green Textured
	18CF			GNTX Green Textured
	26CF			GY3TX Medium Grey Textured
	32CF			RD2TX Burgundy Textured
	42CF			RD4TX Scarlet Textured
				WHTX White Textured
				NP Natural Alum.
				TG Hammer-tone
				TS Hammer-tone Silver

1. Consult Lumec's Color Chart for complete specifications.

Socket: GX24Q-2 (18W), GX24Q-3 (26 or 32W), GX24Q-4 (42W), triple tube compact fluorescent (lamp not included).

BD8G Bollard & Light Column Series

Bollard

Luminaires

Conform to the UL 1598 and CSA C22.2 No. 250.0-08 standards.

BD8G

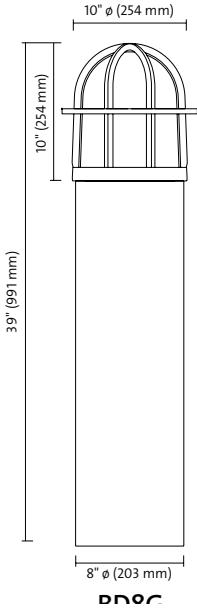

Anchor Plate

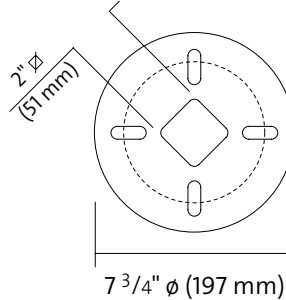

Bolt circle
5-1/2" (140mm)
B.C. possible:
from 4-3/8" to 6" (111mm to 152mm)

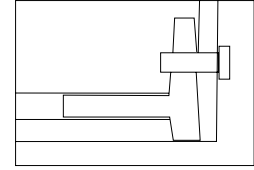

Mounting details

Comes with 4 steel anchor bolts, 3/8" x 12" (10mm x 305mm), 4 nuts and 4 washers.

Important: Do not obstruct space between anchor plate and concrete base.

Specifications

Guard

Made from die cast aluminum (356), mechanically assembled to the housing.

Globe

One piece seamless injected molded opaline polycarbonate, mechanically assembled on the locking system.

Access Mechanism

Four screws integrated on a louver gives access to the inside of the luminaire and to the lamp.

Base

Made from aluminum of 8" (203mm) outside diameter and 1/8" (3mm) wall thickness, mechanically assembled to the anchor plate.

Hardware

All exposed hardware is stainless steel. All seals and sealing devices are made of and/or lined with EPDM and/or silicone.

Finish

"Hot dip" chemical etching preparation. Lumital™ polyester powder coat finish. Excellent color retention as per #ASTM D2244, and outstanding salt-spray resistance according to #ASTM B117 testing procedures.

BOR80 Bollard & Light Column Series

Bollard

BOR80

Ordering guide

example: BOR80-70MH-240-FS-TBC1-BXTX

Product	Lamp	Voltage	Bollard Options	Finish ¹
BOR80	50MH medium	120 120V	BCH1 ○-1 chain handle	BE2TX Midnight Blue Textured
BOR80-W	70MH medium	208 208V	BCH2 ○-2 chain handles at 180°	BE6TX Ocean Blue Textured
	100MH medium	240 240V	BCH2A ○-2 chain handles at 90°	BE8TX Royal Blue Textured
		277 277V	BCH3 ○-3 chain handles at 120°	BG2TX Sandstone Gold Textured
		347 347V	BCH3B ○-3 chain handles at 90°	BKTX Black Textured
		480 480V	BCH4 ○-4 chain handles	BRTX Bronze Textured
	35HPS medium		TBC1 Decorative Cover	GN4TX Blue Green Textured
	50HPS medium		TBC2 Decorative Cover	GN6TX Forest Green Textured
	70HPS medium		DR Duplex receptacle (120V only)	GN8TX Dark Forest Green Textured
	100HPS medium		FS Fuse (Contact Lumec)	GNTX Green Textured
	18CF		GFI Duplex receptacle with ground fault interuptor on mounting (120V only)	GY3TX Medium Grey Textured
	26CF		PH7 Photoelectric cell	RD2TX Burgundy Textured
	32CF		VPA Vandal proof screw	RD4TX Scarlet Textured
	42CF			WHTX White Textured
			NP Natural Alum.	
			TG Hammer-tone	
			TS Hammer-tone Silver	

1. Consult Lumec's Color Chart for complete specifications.

Socket: GX24Q-2 (18W), GX24Q-3 (26 or 32W), GX24Q-4 (42W), triple tube compact fluorescent (lamp not included).

H: Variable height, from 15" (380mm) to 48" (1220mm), in 1" (25mm).

BOR80 Bollard & Light Column Series

Bollard

Luminaires

Conform to the UL 1598 and CSA C22.2 No. 250.0-08 standards.

BOR80

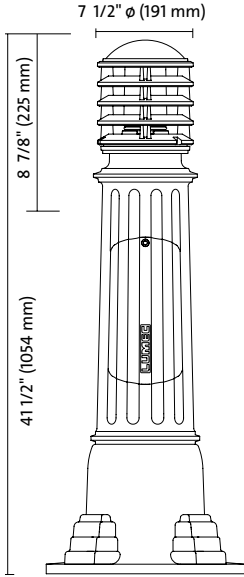

BOR80-TBC1

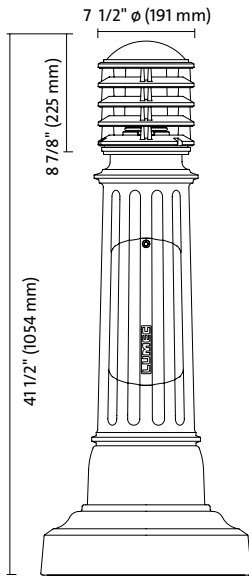

BOR80-TBC2

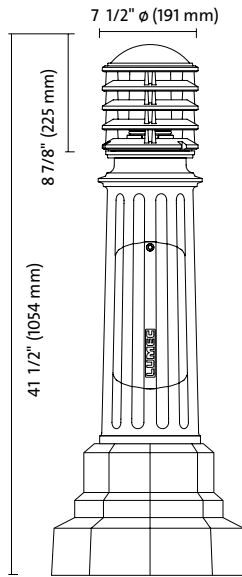

BOR80-W

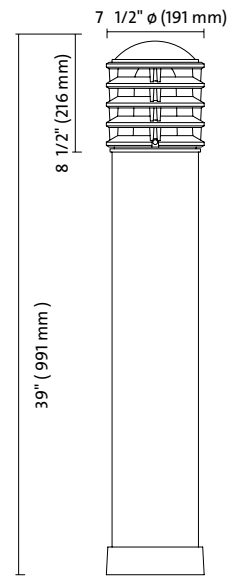

Anchor Plates

BOR80 / BOR80-TBC1 / BOR80-TBC2

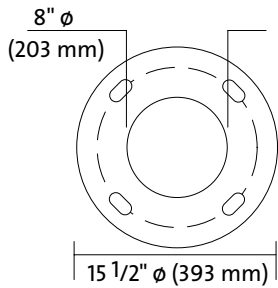

Bolt circle
12-1/2" (318mm)

Mounting details
Comes with 4 steel anchor bolts,
5/8" x 12", 4 nuts and 4 washers.

Important: Do not obstruct space between anchor plate and concrete base.

BOR80-W

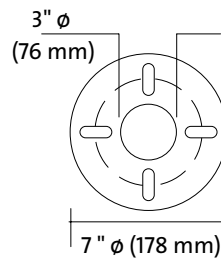

Bolt circle
5-1/2" (140mm)
B.C. possible:
from 4-3/8" to 6" (111mm to 152mm)

Mounting details
Comes with 4 steel anchor bolts,
3/8" x 12" (10mm x 305mm),
4 nuts and 4 washers.

Important: Do not obstruct space between anchor plate and concrete base.

Specifications

Hood

Made from cast aluminum (356), mechanically assembled.

Globe

One piece Seamless injected molded tempered glass. The globe is mechanically assembled on the locking system.

Louvers

Made from die cast aluminium (356), mechanically assembled.

BOR80 / BOR80-TBC

Base

Made from cast aluminum (356), complete with an integrated anchor plate and a 4" x 9" (102mm x 229mm) maintenance opening centered 21" (533mm) from the bottom of the anchor plate, complete with a weatherproof cast (356) aluminum cover and a factory assembled copper ground lug.

BOR80-W

Base

Made from aluminum, 6-5/8" (168mm) outside diameter, welded to the base cover.

Nut Cover

Made from cast aluminum (356), mechanically fastened with stainless steel screws.

Hardware

All exposed hardware is stainless steel. All seals and sealing devices are made of and/or lined with EPDM and/or silicone.

Finish

"Hot dip" chemical etching preparation. Lumital™ polyester powder coat finish. Excellent color retention as per #ASTM D , and outstanding salt-spray resistance according to #ASTM B117 testing procedures.



BOR-DSH Bollard & Light Column Series

Bollard

BOR-DSH

Ordering guide

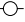
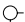
example: BORAM6-DSH-DR-BXTX

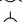
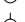
Product	Bollard Options	Finish ¹
BOR80-DSH	BCH1  1 chain handle	BE2TX Midnight Blue Textured
BORAM 6-DSH	BCH2  2 chain handles at 180°	BE6TX Ocean Blue Textured
BORAM 8-DSH	BCH2A  2 chain handles at 90°	BE8TX Royal Blue Textured
BOR61-DSH	BCH3  3 chain handles at 120°	BG2TX Sandstone Gold Textured
	BCH3B  3 chain handles at 90°	BKTX Black Textured
	BCH4  4 chain handles	BRTX Bronze Textured
	TBC1 Decorative Cover	GN4TX Blue Green Textured
	TBC2 Decorative Cover	GN6TX Forest Green Textured
	DR Duplex receptacle (120V only)	GN8TX Dark Forest Green Textured
	GFI Duplex receptacle with ground fault interruptor on mounting (120V only)	GNTX Green Textured
	VPA Vandal proof screw	GY3TX Medium Grey Textured
		RD2TX Burgundy Textured
		RD4TX Scarlet Textured
		WHTX White Textured
		NP Natural Alum.
		TG Hammer-tone
		TS Hammer-tone Silver

1. Consult Lumec's Color Chart for complete specifications.

Socket: GX24Q-2 (18W), GX24Q-3 (26 or 32W), GX24Q-4 (42W), triple tube compact fluorescent (lamp not included).

H: Variable height, from 15" (380mm) to 48" (1220mm), in 1" (25mm).

BOR-DSH Bollard & Light Column Series

Bollard

Luminaires

Conform to the UL 1598 and CSA C22.2 No. 250.0-08 standards.

BOR80-DSH

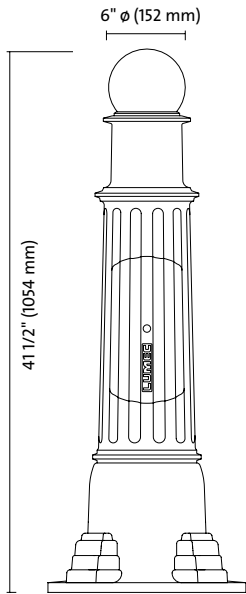

BORAM6-DSH

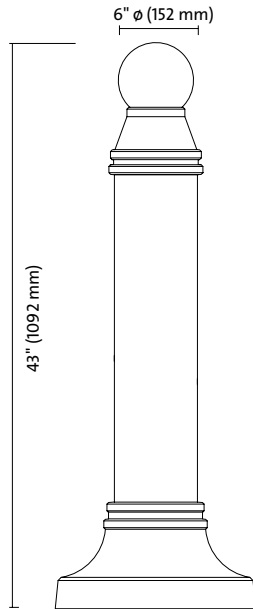

BORAM8-DSH

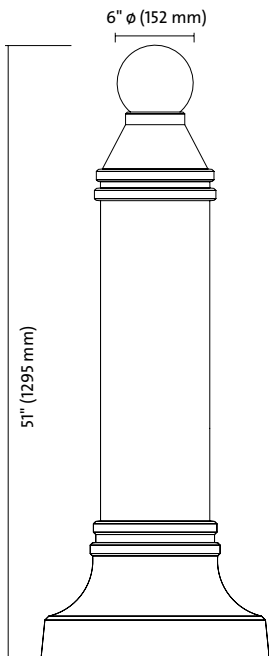

BOR61-DSH

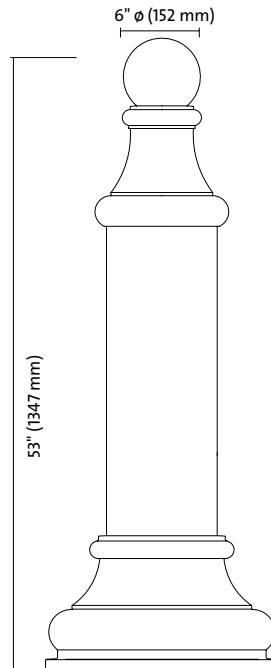

BOR-DSH Bollard & Light Column Series

Bollard

Anchor Plates

BOR80-DSH / BORAM6-DSH

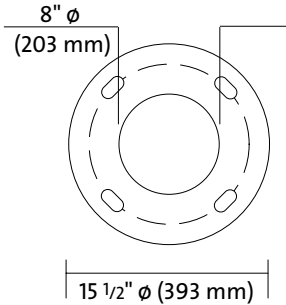

Bolt circle
12-1/2" (318mm)

Mounting details

Comes with 4 steel anchor bolts,
5/8" x 12", 4 nuts and 4 washers.

Important: Do not obstruct space between anchor plate and concrete base.

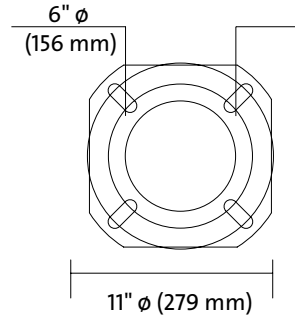

Bolt circle:
10- 1/2" (267mm)
B.C. allowed:
from 8-3/4" to 11"
(222mm to 279mm)

Mounting details

Comes with 4 steel anchor bolts,
5/8" x 12", 4 nuts and 4 washers.

Important: Do not obstruct space between anchor plate and concrete base.

BORAM8-DSH / BOR61-DSH

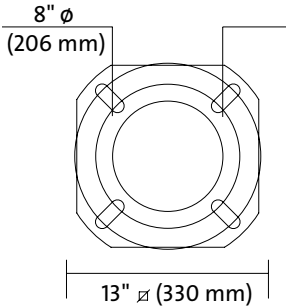

Bolt circle:
12- 1/2" (318mm)
B.C. allowed:
from 10-3/4" to 13"
(273mm to 330mm)

Mounting details

Comes with 4 steel anchor bolts,
5/8" x 12", 4 nuts and 4 washers.

Important: Do not obstruct space between anchor plate and concrete base.

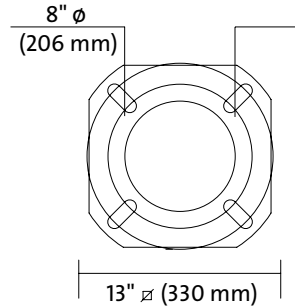

Bolt circle:
12- 1/2" (318mm)
B.C. allowed:
from 10-3/4" to 11"
(273mm to 330mm)

Mounting details

Comes with 4 steel anchor bolts,
5/8" x 12", 4 nuts and 4 washers.

Important: Do not obstruct space between anchor plate and concrete base.

Specifications

Decorative Element

Welded decorative sphere made from cast aluminum (356).

BOR80-DSH

Base

Made from cast aluminum (356), complete with an integrated anchor plate and a 4" x 9" (102mm x 229mm) maintenance opening centered 21" (533mm) from the bottom of the anchor plate, complete with a weatherproof cast (356) aluminum cover.

Nut Cover

Made from cast aluminum (356), mechanically fastened with stainless steel screws.

BORAM6-DSH

Base

Made from a 6-5/8" (168mm) round extruded (6061-T6) aluminum tubing base with a 0.135" (3.4mm) wall thickness, welded to both the bottom and top of the anchor plate.

Base Cover

Two pieces round base cover made from cast aluminum (356), mechanically fastened with stainless steel screws.

BORAM8-DSH / BOR61-DSH

Base

Made from a 8-5/8" (218mm) round extruded (6061 T6) aluminum tubing base with a 0.148" (3.8mm) wall thickness, welded to both the bottom and top of the anchor plate.

Base Cover

Two pieces round base cover made from cast aluminum (356), mechanically fastened with stainless steel screws.

