



Lumece **Ancestra** LED pendant luminaires present a new twist on a classic design. By combining the best aspects of past and present forms with the best that modern technology has to offer, the **Ancestra** luminaires epitomizes Lumece's design philosophy beautifully: to combine the best technology with elegant design.

Project: _____
 Location: _____
 Cat.No: _____
 Type: _____
 Lamps: _____ Qty: _____
 Notes: _____

Ordering guide

example: AT50-C-140L650NW-G1-3-UNV-DMG-BKTX

Series	LED module	Gen.	Optical system	Ballast	Driver options ³	Adapter	Luminaire options	Poles / Brackets	Finish
<input type="text"/>	<input type="text"/>	G1	<input type="text"/>	<input type="text"/>	<input type="text"/>	<input type="text"/>	<input type="text"/>	<input type="text"/>	<input type="text"/>
AT50-C	3000K 140L450WW ⁵ 140L650WW ⁵ 140L1150WW 140L1675WW 140L2100WW 4000K 140L450NW ⁵ 140L650NW ⁵ 140L1150NW 140L1675NW 140L2100NW	G1 Gen1	1 Type I (ASYM) 2 Type II (ASYM) 3 Type III (ASYM) 4 Type IV (ASYM) 5 Type V (SYMM)	UNV 120-277VAC 347 347VAC 480 480VAC	CDMGE25 ¹ Economy 8 hrs. 25% reduction CDMGE50 ¹ Economy 8 hrs. 50% reduction CDMGE75 ¹ Economy 8 hrs. 75% reduction CDMGM25 ¹ Median 6 hrs. 25% reduction CDMGM50 ¹ Median 6 hrs. 50% reduction CDMGM75 ¹ Median 6 hrs. 75% reduction CDMG525 ¹ Safety 4 hrs. 25% reduction CDMG550 ¹ Safety 4 hrs. 50% reduction CDMG575 ¹ Safety 4 hrs. 75% reduction DMG 0-10V DALI ^{1,4} DALI compatible SRD ¹ Sensor ready driver, standard configuration SRD1 ¹ Sensor ready driver, alternate configuration	MA1 1 1/4" NPT threaded hole adapter accepting threaded tube MA2 1 1/2" NPT threaded hole adapter accepting threaded tube SMA Decorative retro side-mounted cast-aluminum, accepts tubes from 1 5/8" to 2 3/8" SMB Decorative contemporary side-mounted cast-aluminum, accepts tubes from 1 5/8" to 2 3/8"	CR20 CR30 CR40 DA Decorative Arches DC Decorative Cap GRD PH7 ⁶ PH8 ⁴ Twist-lock Photoelectric Cell PHXL ¹ Twist-lock Photoelectric Cell, extended life, UNV (120-277VAC) PH9 ⁴ Shorting cap RC ² Receptacle for twist-lock photocell or shorting cap, 3-pin RCD ² Receptacle for twist-lock photocell or shorting cap, 5-pin RCD7 ^{2,7} Receptacle for twist-lock photocell or shorting cap, 7-pin SP2 20kV/10kA Surge Protector (optional)	Consult with Signify.com/luminaires for details and the complete line of poles and brackets.	Textured BE2TX Midnight Blue BE6TX Ocean Blue BE8TX Royal Blue BG2TX Sandstone BKTX Black BRTX Bronze GN4TX Blue Green GN6TX Forest Green GN8TX Dark Forest Green GNTX Green GY3TX Medium Grey RD2TX Burgundy RD4TX Scarlet WHTX White Other GR Gray Sandtex NP Natural Aluminum TG Hammertone Gold
1. Not available with 347V and 480V . 2. Use of photoelectric cell or shorting cap is required to ensure proper illumination. 3. Select either CDMG or DMG or DALI mandatory option. 4. RC , RCD or RCD7 must be selected for this option 5. For 240 or 277 volt with DALI or CDMG options consult factory. 6. Not available with 480V . 7. SMB adaptors is required for this option.									

AT50-C Ancestra LED Pendant

Urban Luminaire

Dimensions

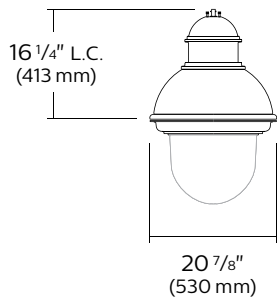

AT50

EPA: 1.35 sq.ft.
Weight: 35.5 lbs. (16.1 kg)

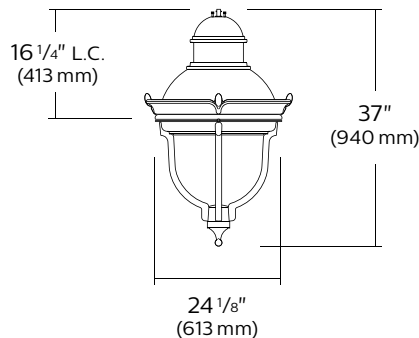

AT50

(shown w/CR30 & GRD)

EPA: 1.58 sq.ft.
Weight: 51.5 lbs. (23.3 kg)

LED Wattage and Lumen Values: for AT50

3000K

Ordering Code: Flat lens (3000K)	Total LEDs	LED current (mA)	Average System Wattage (W)	Type 1			Type 2			Type 3		
				Lumen Output	Efficacy (LPW)	BUG Rating	Lumen Output	Efficacy (LPW)	BUG Rating	Lumen Output	Efficacy (LPW)	BUG Rating
140L450WW-G1	140	450	21	1916	91	B1-U0-G1	1930	92	B1-U0-G1	2029	97	B1-U0-G1
140L650WW-G1	140	650	30	2680	89	B2-U0-G2	2520	84	B1-U0-G1	2649	88	B1-U0-G1
140L1150WW-G1	140	1150	52	4562	88	B2-U0-G2	4288	82	B2-U0-G2	4508	87	B2-U0-G2
140L1675WW-G1	140	1675	75	6265	84	B3-U0-G3	5889	79	B3-U0-G3	6191	83	B2-U0-G2
140L2100WW-G1	140	2100	94	7602	81	B3-U0-G3	7146	76	B3-U0-G3	7512	80	B3-U0-G3

Ordering Code: Flat lens (3000K)	Total LEDs	LED current (mA)	Average System Wattage (W)	Type 4			Type 5		
				Lumen Output	Efficacy (LPW)	BUG Rating	Lumen Output	Efficacy (LPW)	BUG Rating
140L450WW-G1	140	450	21	2110	100	B1-U0-G1	1976	94	B1-U0-G1
140L650WW-G1	140	650	30	2755	92	B1-U0-G1	2764	92	B2-U0-G1
140L1150WW-G1	140	1150	52	4688	90	B2-U0-G2	4705	90	B3-U0-G2
140L1675WW-G1	140	1675	75	6438	86	B2-U0-G2	6461	86	B3-U0-G2
140L2100WW-G1	140	2100	94	7812	83	B3-U0-G3	7840	83	B3-U0-G2

Actual performance may vary due to installation variables including optics, mounting/ceiling height, dirt depreciation, light loss factor, etc.; highly recommended to confirm performance with a layout - contact Applications at signify.com/outdoorluminares.

Note: Some data may be scaled based on tests of similar. But not identical luminaires.

AT50-C Ancestra LED Pendant

Urban Luminaire

LED Wattage and Lumen Values: for AT50

4000K

Ordering Code: Flat lens (3000K)	Total LEDs	LED current (mA)	Average System Wattage (W)	Type 1			Type 2			Type 3		
				Lumen Output	Efficacy (LPW)	BUG Rating	Lumen Output	Efficacy (LPW)	BUG Rating	Lumen Output	Efficacy (LPW)	BUG Rating
140L450NW-G1	140	450	21	1916	91	B1-U0-G1	1930	92	B1-U0-G1	2029	97	B1-U0-G1
140L650NW-G1	140	650	30	2680	89	B2-U0-G2	2520	84	B1-U0-G1	2649	88	B1-U0-G1
140L1150NW-G1	140	1150	52	4562	88	B2-U0-G2	4288	82	B2-U0-G2	4508	87	B2-U0-G2
140L1675NW-G1	140	1675	75	6265	84	B3-U0-G3	5889	79	B3-U0-G3	6191	83	B2-U0-G2
140L2100NW-G1	140	2100	94	7602	81	B3-U0-G3	7146	76	B3-U0-G3	7512	80	B3-U0-G3

Ordering Code: Flat lens (3000K)	Total LEDs	LED current (mA)	Average System Wattage (W)	Type 4			Type 5		
				Lumen Output	Efficacy (LPW)	BUG Rating	Lumen Output	Efficacy (LPW)	BUG Rating
140L450WW-G1	140	450	21	2110	100	B1-U0-G1	1976	94	B1-U0-G1
140L650WW-G1	140	650	30	2755	92	B1-U0-G1	2764	92	B2-U0-G1
140L1150WW-G1	140	1150	52	4688	90	B2-U0-G2	4705	90	B3-U0-G2
140L1675WW-G1	140	1675	75	6438	86	B2-U0-G2	6461	86	B3-U0-G2
140L2100WW-G1	140	2100	94	7812	83	B3-U0-G3	7840	83	B3-U0-G2

Actual performance may vary due to installation variables including optics, mounting/ceiling height, dirt depreciation, light loss factor, etc.; highly recommended to confirm performance with a layout - contact Applications at signify.com/outdoorluminaire.

Note: Some data may be scaled based on tests of similar. But not identical luminaires.

AT50-C Ancestra LED Pendant

Urban Luminaire

Specifications

Housing

Hood: Spun aluminum 1100 O dome, mechanically assembled on the luminaire.

Housing: In a round shape, this housing is made of cast 356 aluminum, c/w a watertight grommet, mechanically assembled to the bracket with four bolts 3/8 16 UNC. This suspension system permits for a full rotation of the luminaire in 90° increments.

Access-mechanism

A die cast A360 aluminum technical ring with latch, hinge and a cast in decorative skirt. The mechanism shall offer tool free access to the inside of the luminaire. An embedded memory retentive gasket shall ensure weatherproofing.

Light engine

LEDgine composed of 5 main components: Heat Sink / Lens / LED lamp / Driver / Optical System. Electrical components are RoHS compliant.

Optical System

The advanced LED comfort optical system provides Types 1, 2, 3, 4 and 5. Composed of high performance UV-stabilized optical grade lens with molded micro-optics to achieve desired distribution optimized to get a exceptional lighting uniformity. Performance tested per LM-79 and TM-15 (IESNA) certifying its photometric performance. Street side indicated luminaire designed with 0% uplight (UO per IESNA TM-15).

LED Performance

Predicted lumen depreciation data ¹				
Ambient Temperature (°C)	Driver mA	Calculated L ₇₀ hours ^{1,2}	L ₇₀ per TM-21 ^{2,3}	Lumen Maintenance % @ 60,000 hours
25°C	up to 2100 mA	>100,000	>60,000	83%

1. Predicted performance derived from LED manufacturer's data and engineering design estimates, based on IESNA LM-80 methodology. Actual experience may vary due to field application conditions.
2. L₇₀ is the predicted time when LED performance depreciates to 70% of initial lumen output.
3. Calculated per IESNA TM21-11. Published L₇₀ hours limited to 6 times actual LED test hours.

Driver

High power factor of 95%. Electronic driver, operating range 50/60 Hz. Auto adjusting universal voltage input from 120 to 277 and 347 to 480 VAC rated or both application line to line or line to neutral, Class 2, THD of 20% max. Maximum ambient operating temperature from 40°F (40°C) to 130°F (50°C). Certified in compliance to UL1310 cULus requirement. Dry and damp location. Assembled on a unitized removable tray with Tyco quick disconnect plug resisting to 221°F (105°C). Dimmable driver 0-10V. The current supplying the LEDs will be reduced by the driver if the driver experiences internal overheating as a protection to the LEDs and the electrical components. Output is protected from short circuits, voltage overload and current overload. Automatic recovery after correction. Standard built in driver surge protection of 2.5kV (min) with CDMG, driver is class 1.

Surge Protection

Surge protector tested in accordance with ANSI/IEEE C62.45 per ANSI/IEEE C62.41.2 Scenario I Category C High Exposure 0kV/10kA waveforms for Line Ground, Line Neutral and Neutral Ground, and in accordance with U.S. DOE (Department of Energy) MSSLC (Municipal Solid State Street Lighting Consortium) model specification for LED roadway luminaires electrical immunity requirements for High Test Level 10kV / 10kA. SP2 20kV/10kA optional.

Driver options

DMG: Dimmable driver 0-10V.

CDMG: Dynadimmer standard dimming functionalities including pre-programmed scenarios to suit many applications and needs from safety to maximum energy savings.

Order Code	Dimming		
	Scenario	Duration	Level
CDMGS25	Safety	4 hours	25%
CDMGS50	Safety	4 hours	50%
CDMGS75	Safety	4 hours	75%
CDMGM25	Median	6 hours	25%
CDMGM50	Median	6 hours	50%
CDMGM75	Median	6 hours	75%
CDMGE25	Economy	8 hours	25%
CDMGE50	Economy	8 hours	50%
CDMGE75	Economy	8 hours	75%

SRD: Sensor Ready Driver including SR communication (used for dimming and other functionalities), 24V auxiliary supply and a logical signal input (LSI) connected to the top NEMA twist lock receptacle.

SRD1: Sensor Ready Driver including SR communication (used for dimming and other functionalities) but with 24V auxiliary supply and a logical signal input (LSI) not connected to the top NEMA twist lock.

AT50-C Ancestra LED Pendant

Urban Luminaire

Specifications (continued)

Luminaire adaptor



MA1: The luminaire is suspended by means of a mounting adaptor with a 1" (32mm) NPT threaded hole accepting a threaded tube from the mounting. Retrofit adaptor for existing mounting.



MA2: MA2: 1." (38mm) NPT threaded hole accepting threaded tube from the mounting. Retrofit adaptor for existing mounting.



SMB: The luminaire is suspended by means of a decorative side-mounted cast aluminum adaptor. This adaptor accepts tubes from 1⁵/₈" to 2³/₈" (41 to 60 mm) and is adjustable to more or less 5°.

Luminaire options

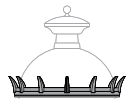

CR20
Decorative Crown

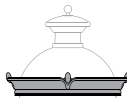

CR30
Decorative Crown



CR40
Decorative Crown



DA
Decorative arches



DC
Decorative cap



GRD
Decorative guard

PH7
Photoelectric cell, bottom type

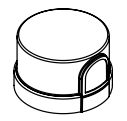

PH8
Photoelectric cell, twist-lock type. Allows 90° rotation

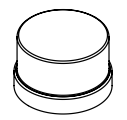

PH9
Shorting cap, twist-lock type

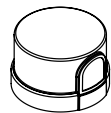

PHXL
Extended life Photoelectric cell, twist-lock type
Allows 90° rotation



RCD
Receptacle
5-pins



RCD7
Receptacle
7-pins

SP2
20kV/10kA integral surge protector (optional)

Fitter

Cast 356 aluminum c/w 4 set screws 3/8 16 UNC. This fitter holds 2 arms made of cast aluminum 356 mechanically assembled. Slip fits on a 4" (102mm) outside diameter X 4" (102mm) long tenon.

Finish

In accordance with the AAMA 2603 standard. Application of polyester powder coat paint (4 mils/100 microns) with +/- 1 mils/24 microns of tolerance. The Thermosetting resins provides a discoloration resistant finish in accordance with the ASTM D2244 standard, as well as luster retention in keeping with the ASTM D523 standard and humidity proof in accordance with the ASTM D2247 standard. The surface treatment achieves a minimum of 2000 hours for salt spray resistant finish in accordance with testing performed and per ASTM B117 standard.

Textured Finish Options:

BE2TX: Textured Midnight Blue
BE6TX: Textured Ocean Blue
BE8TX: Textured Royal Blue
BG2TX: Textured Sandstone
BKTX: Textured Black
BRTX: Textured Bronze
GN4TX: Textured Blue Green
GN6TX: Textured Forest Green
GN8TX: Textured Dark Forest Green
GNTX: Textured Green
GY3TX: Textured Medium Grey
RD2TX: Textured Burgundy
RD4TX: Textured Scarlet
WHTX: Textured White

Non-Textured Finish Options:

GR: Gray Sandtex
NP: Natural Aluminum
TG: Hammer-tone Gold

Wiring

Gauge (#14) TEW/AWM 1015 or 1230 wires, 6" (152mm) minimum exceeding from luminaire.

Hardware

All exposed screws shall be complete with Ceramic primer-seal base coat to reduce seizing of the parts and offers a high resistance to corrosion. All seals and sealing devices are made and/or lined with EPDM and/or silicone and/or rubber.

Quality control

Manufactured to ISO 9001 2008 standards and ISO 14001-2004 International Quality Standards Certification.

LED products (manufacturing standard)

The electronic components sensitive to electrostatic discharge (ESD) such as light emitting diodes (LEDs) are assembled in compliance with IEC61340 5 1 and ANSI/ESD S20.20 standards so as to eliminate ESD events that could decrease the useful life of the product.

Quality control

Manufactured to ISO 9001 2008 standards and ISO 14001-2004 International Quality Standards Certification.

Certifications and Compliance

CSA, cULus Listed for Canada and USA. Luminaires are DesignLights Consortium qualified.

AT50-C Ancestra LED Pendant

Urban Luminaire

Poles

