

Spot Dim to Warm ULTRA 12



PROJECT:

TYPE:

SOURCE:

NOTES:

SPECIFICATIONS



LED Chip	Bridgelux field replaceable LED board
Luminaire Output	1000 Lumens minimum 1800-3000K @ 350mA (12 watts), delivered from the Luminaire with unobstructed beam
Lumens Per Watt	83 Lumens minimum @ 12 watts, delivered from Luminaire with unobstructed beam
CRI (3000K)	90 Standard
Colour Temperatures	1800K - 3000K dim to warm
Beam Angles	18, 24, 46, 60
Ingress Protection	IP67
Inverse Kinematics Rating	IK10
Warranty	Electronics = 5 years Body Aluminium = 5 years
Standards	BS/EN 60598.2.2 cUL 1598, 2108, 1838 PENDING CE

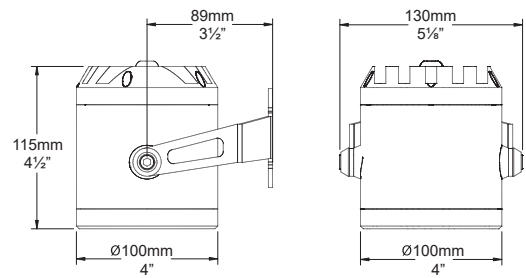

The Ultra 12 Spot must be specified with a mounting accessory.

PRODUCT CONFIGURATION

Please fill in appropriate codes into boxes provided

Cat. No. SDW/U12

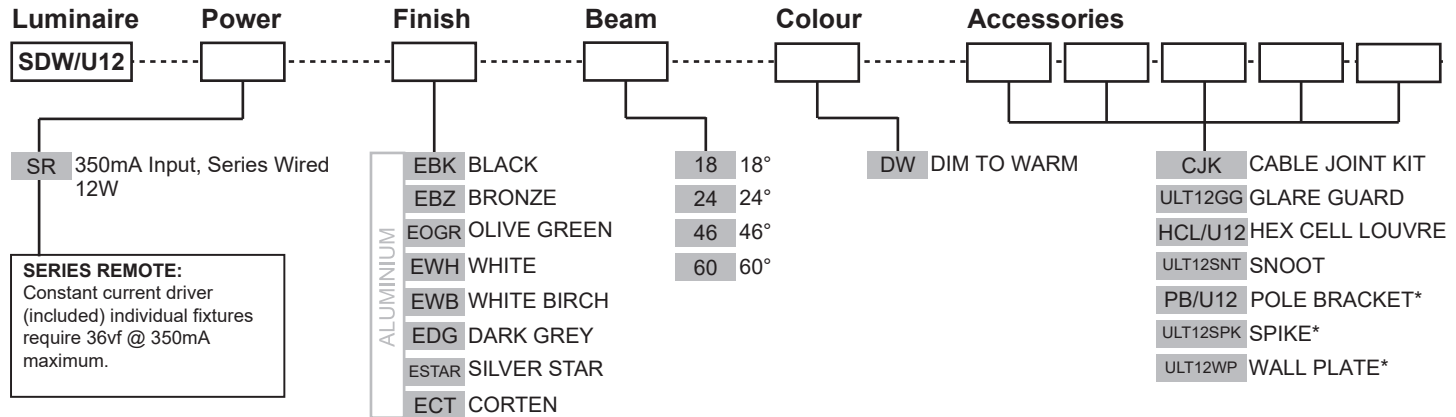

*Must be specified with a mounting accessory

ADDITIONAL COMMENTS:

LUMINAIRE CONSTRUCTION

CNC machined from one of the following metals:

Aluminium:

Body: 101mm (4") high corrosion resistant aluminium rod with chromate substrate and high UV resistant polyester powder coat.
Colours: Black, Bronze, Silver Star, White, White Birch, Olive Green, Dark Grey, Corten.

316 Stainless Steel:

Bracket: laser cut and folded 316 stainless steel.

Adjustability:

The fully adjustable head allows 120 degree rotation and 0-120 degree elevation.

Cable:

Water resistant rubber.

Gaskets:

Silicone, iron impregnated 220°C (428°F).

Step Lens:

12mm (1/2") extra clear, low iron, shatter resistant glass.
Lifetime warranty.

Mounting:

The mounting bracket is fixed to the surface using two stainless steel screws.
Pole Bracket - mount to pre-installed poles.
Spike - mount into the earth/soft ground.
Wall Plate - mount over junction boxes.

Luminaire Weight:

2kg (4lb 6.5oz)

ACCESSORIES

*Must be specified with a mounting accessory

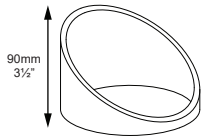

Glare Guard

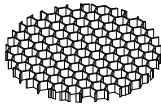

Hex Cell Louvre

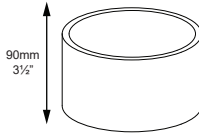

Snoot

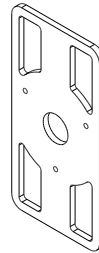

Pole Bracket*



Spike*

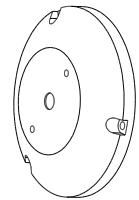

Wall Plate*
126mm (5")

BEAM ANGLES

High efficiency Reflectors. Field replaceable

IES files available for download: <http://www.hunzalighting.com/download.php>

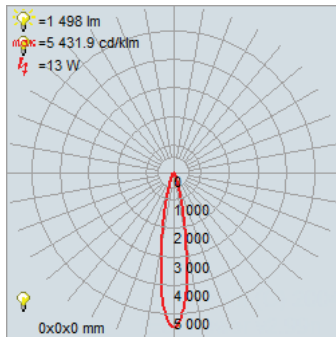

18° FWHM
TIR

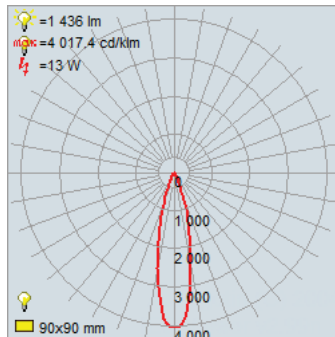

24° FWHM
TIR

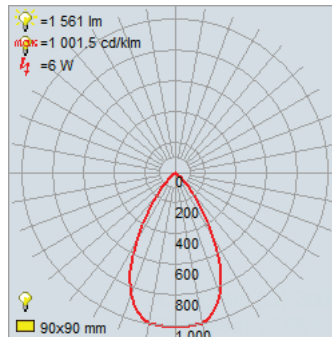

46° FWHM
TIR

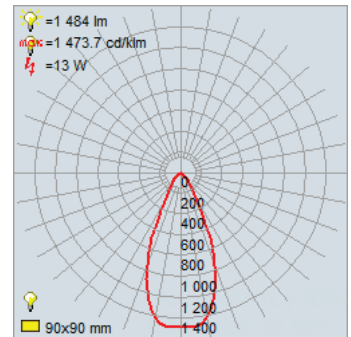

60° FWHM
TIR

WIRING GUIDE

Available for download: www.hunzalighting.com/download.php

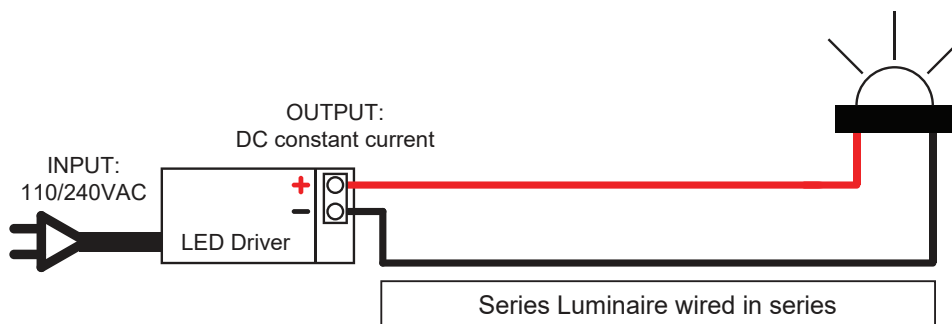

Diagrams are a guide only, wire colours and polarity may change depending on fixture and country

Specifications may change without notification

Nov 2020