

EPTRONICS

Retro Constant Current Driver

Cat. No. LD25W-12-C2080-R



The EPTRONICS LD25W-12-C2080-R is a 25 Watt electronic, constant current, Retro driver supplied with HUNZA High Power PURE LED fixtures. It is 0-10V dimmable.

Warranty: the manufacturer warrants that these drivers will be free from defects in material and workmanship, for a period of Five (5) years from the date of shipment. This warranty includes repair or replacement but does not cover installation costs. This warranty does cover product which has been subjected to misuse, neglect, accident, improper installation or used in violation of instructions.



Electrical Specification

- Input voltage range: 90 to 305VAC
- Frequency: 47~ 63HZ
- Power Factor: > .94 at full load 115Vac/230Vac 50/60Hz
- Inrush current: <15A at 25C, 230V, cold start, Max. Load
- Input current: 0.25A at 120Vac, 60Hz, Maximum Load
- Efficiency: 83% typical at 115Vac 60Hz, 230Vac 50Hz
- Maximum output power: 25W
- Constant Current output: 2080mA
- Output voltage range: 4-12 VDC

Safety and Compliance

- UL8750, EN61347, CSA 22.2 safety compliant
- FCC, 47CFR Part 15 Class B compliant
- Water resistant and Dust Proof Design: IP66, NEMA4, for Dry, Damp, Wet Locations
- Safety Isolation between Primary and Secondary
- Meets EN61000-3-2 & EN61000-3-3 Class C
- Protection: output over-voltage, output over-current, output short circuit, reset by power cycling.
- Transient protection built in.

Environmental

- Operating temperature: Tc 90°C Maximum. Reference -30 to +60°C ambient
- Storage temperature range: -40 to +85°C
- Humidity (non-condensing): 5% - 95%RH
- Cooling: Convection
- Vibration Frequency: 5-55Hz/2g, 30 minutes
- Impact resistance: 1g/s
- MTBF@ 40°C: 482,000 hours @ Full Load per MIL-217F Notice 2.

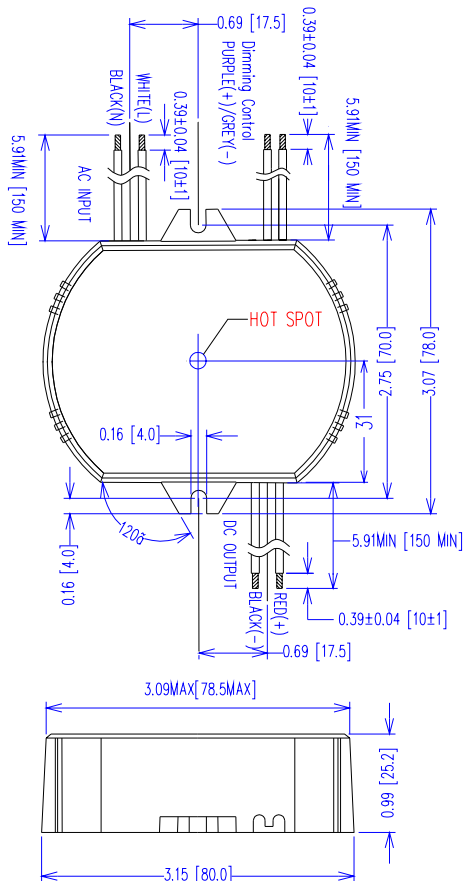

IP66



HUNZA™ PURE OUTDOOR LIGHTING

HUNZA FACTORY
130 Felton Mathew Ave
Glen Innes
Auckland 1072
New Zealand

Ph: 64-9-528 9471
Fax: 64-9-528 9361
hunza@hunza.co.nz
www.hunzalighting.com

INTERNATIONAL CONTACTS:
www.hunzalighting.com/contact.php
Specifications may change without notice.
Manufactured in New Zealand.
2016 Hunza Productions Ltd.