

**GARDCO**

by **Signify**

Wall Mount

Wall Sconces 100 line



**Traditional styles meet  
advanced performance**







# Architectural appeal

Gardco LED wall sconces 100 line feature compact designs that provide wide flexibility in high performance illumination, while providing new opportunities to make a sustainable architectural statement. By incorporating cutoff performance, usable illumination patterns, and powerful wattages into architecturally pleasing designs, 100 line provides a much-needed alternative to glare-inducing wall packs.



## **Now available with enhanced performance, and energy saving control options.**

- Multiple lumen packages with output ranging from 1,358 to 12,045 lumens
- Energy saving LEDs provide up to 136 LPW efficacy
- Three distribution patterns available in Type 2, 3, 4
- Emergency Battery Back Up available to provide path-of-egress illumination
- Energy saving control options, such as motion response and wireless controls

# Multiple styles for your application

The broad choice in housing styles, optics and lumen packages offers numerous options in balancing the illumination and aesthetic requirements of a project. Whether they are used over building entrances, to light facades, or on loading docks, there is no need to compromise appearance for performance. Available with 4 different low-profile forms to choose from, LED wall sconces 100 line have you covered.



# Product offering

---



## 101L Trapezoidal Wedge

With its tapered rectilinear form, this family immediately impresses with styling that integrates comfortably with a wide range of architectural elements.



## 102L Rounded Wedge

The distinctive contoured wedge of the 102L establishes styling cues that prevail throughout the series – crisp, simple design and efficient scale.



## 104L Half Cylinder

This half-round shape integrates naturally with architecture that features soft, rounded corners and forms. The 104L is the perfect companion for Gardco's Round Form Ten cylindrical site lighting products.



## 106L Quarter Sphere

The classic shape of the 106L can add subtle styling to a variety of architectures. The 106L can also be used in tandem with the domed styles of the Gardco Round Form Ten family.



# Enhanced features, energy savings and controls

Instilling a sense of security for a building perimeter is critical in a site lighting application, but energy and maintenance cost savings are also important.

Gardco LED wall sconces 100 line feature the latest in LED technology, which consumes less energy for lower utility bills compared to traditional lighting technologies, even during constant operation. In addition, LED technology lasts longer than traditional lighting technologies, for reduced maintenance time and expenses. Add flexibility and further enhance savings through optional controls, including 0-10V dimming, Dynadimmer, dual circuit control and motion response.

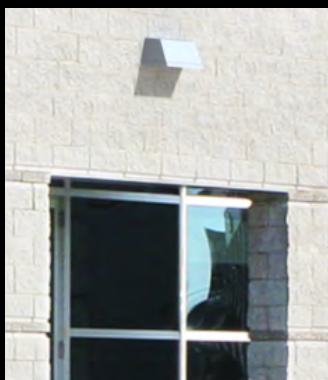

## Emergency battery backup

LED wall sconces 100 line now feature emergency battery back up. The egress lighting zones are areas requiring emergency backup systems providing code-required path-of-egress illumination.

## This is an ROI example you can achieve by retrofitting 30 HID luminaires with 100 Line LED



63%

Annual energy  
over HID



70%

Annual **total cost**  
of ownership savings



Reduce lighting costs and  
increase energy savings  
by combining 100L with  
connected lighting solutions

## You are saving energy and money with LED wall sconces 100 line!

\* Based on comparison between 250W PSMH luminaires (at 291W) and 101L-32L-1000-NW (at 107W) with an energy rate of \$0.1045/KWh. National average energy rates and other assumptions apply.

# Controls



## Luminaire solutions

### **Basic. Autonomous. Affordable.**

Simple, individual outdoor lighting dimming and management without the need for remote access.

- **0-10V Dimming**
- **Dual Circuit Control**
- **Dynadimmer Stand-alone Dimming Profile**
- **Programmable Motion Response**



### **Programmable motion response**

Programmable Motion Response maximizes your outdoor lighting energy savings while supporting security efforts. Upon easy installation, Programmable Motion Response dims 100L luminaires to 25% light output, increases to 100% light output only when motion is detected, and returns to the original low output after five minutes. Settings are easily changed at the luminaire with an optional wireless handheld programmer.

### **Dynadimmer**

Dynadimmer reduces the luminaire's light output according to pre-programmed or customized dimming schedules to reduce light pollution and energy consumption without compromise.

---

### **For more information**

Visit us at [signify.com/prolighting.com](http://signify.com/prolighting.com) for more on stand-alone and connected outdoor lighting solutions, and select Controls Outdoor, or request our outdoor lighting solutions brochure.

# Intelligent design, rugged construction



While the architectural appeal of Gardco LED wall sconces is self-evident, equal attention has been devoted to the construction and long term performance of the luminaires. It is a quality that never goes out of style.

At every level, simple details make these sconces the very best available. It is an attention to detail that encompasses not only innovative design, but every aspect of luminaire integrity and performance. In every luminaire, one finds seamless material transitions, true performance optics and thoughtful engineering considerate of installation, service and long term operation.

All Gardco 100 Line LED housings, door frames and back plates are precision die cast aluminum. The single-piece die cast door frame fits flush to the housing. Precision, high quality gaskets seal the optic plate to the LED board. The door is secured to the housing with two captive stainless steel fasteners that provide easy access for servicing. Every Gardco sconce must pass a comprehensive battery of electrical tests prior to shipment.

## Easy Mounting

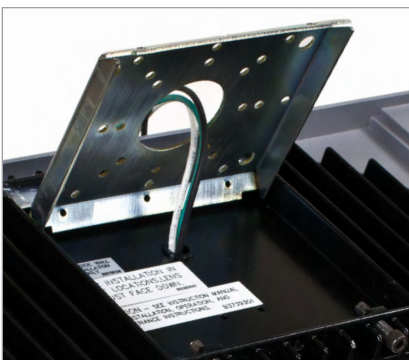

The luminaire installs easily. The mounting plate is affixed to the wall, splices are made and the luminaire is secured to the plate.

## Die Cast Ribbed Backplate



The die cast ribbed back plate dissipates heat from the electrical components, which are mounted to the plate within the housing. Proper thermal management is crucial to maintaining long LED life.

## Ease of Maintenance



The die cast door frame is secured with two captive stainless steel fasteners and hinges open for easy access.



# Performance that meets your needs

---

Gardco sconces are available in a Type II (2) wide throw with maximized lateral spacing; a Type III (3) optimized wide throw that adds excellent forward contribution; and a Type IV (4) with maximized forward throw distribution for small parking areas.

Optics are IP66 rated. Luminaires are wet location rated for downlighting applications and are suitable for damp location uplighting in covered ceiling lobbies, atriums and beneath canopies. Optical systems feature advanced Class 1 LED arrays designed to efficiently direct light into very wide or forward projecting light patterns.

## Control of Glare & Light Trespass

The factor most destructive to quality lighting is glare. The traditional refractor wall pack generates light at excessively high angles – creating glare within a driver’s or pedestrian’s field of view. In addition, light above 90° may result in distracting brightness into neighboring spaces. Gardco performance sconces utilize precision LED optical systems. Light above 80° is minimized and light above 90° is eliminated – resulting in exceptional control of luminaire brightness and undesired illumination beyond the property line.

### Type 2 at 20'

When economy rules and wide spacings are required, Type 2 optics offer 6:1 spacing to mounting height ratios. Sconces may be spaced as far as 90' apart at a 15' mounting height.



### Type 3 at 20'

For the best of both worlds, the Type 3 offers excellent lateral spacings and forward projection in a very usable rectangular pattern.



### Type 4 at 20'

If critical light levels are required at the property line, Type 4 optics uptilt project light in a more forward direction.

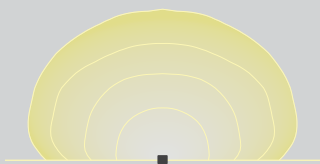

# Dimensions

## 101L

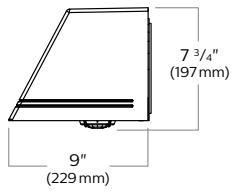
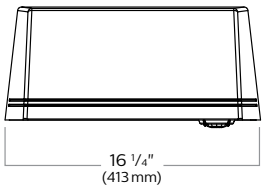
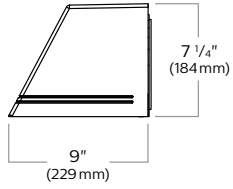
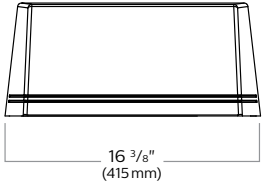

Programmable motion response

## 106L

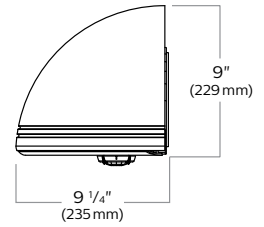
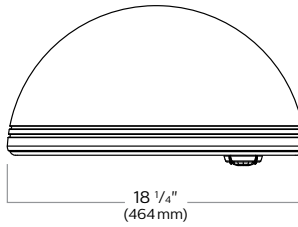
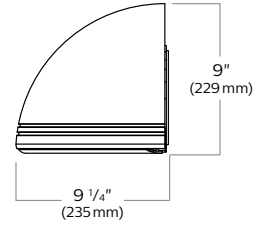
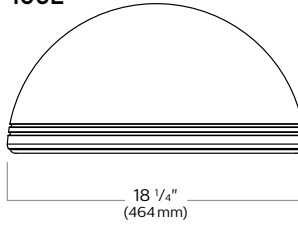

Programmable motion response

## 102L

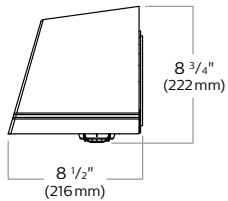
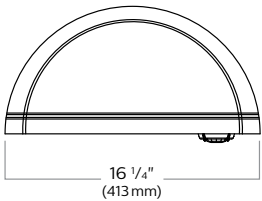
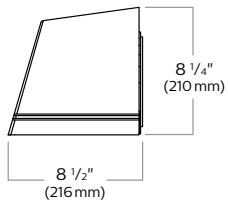
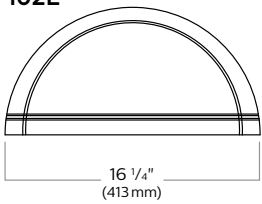

Programmable motion response

## 104L

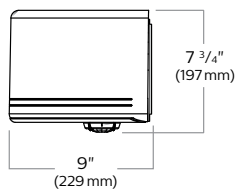
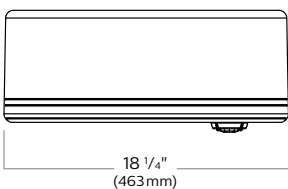
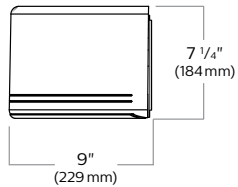

Programmable motion response



# Features and performance

## Finish

Five standard finish options available in black, white, dark grey, and medium grey. Optional and special finishes also available.

## Die cast housing

Rugged, die-cast aluminum housing for maximum durability.



## Integral controls

Optional Emergency Battery Backup and Programmable Motion Response are integral to the luminaire, and do not require any external components.

## Optical Distributions

Type 2, 3, and 4 distributions available

## IP66 Rated

IP66-rated optics.

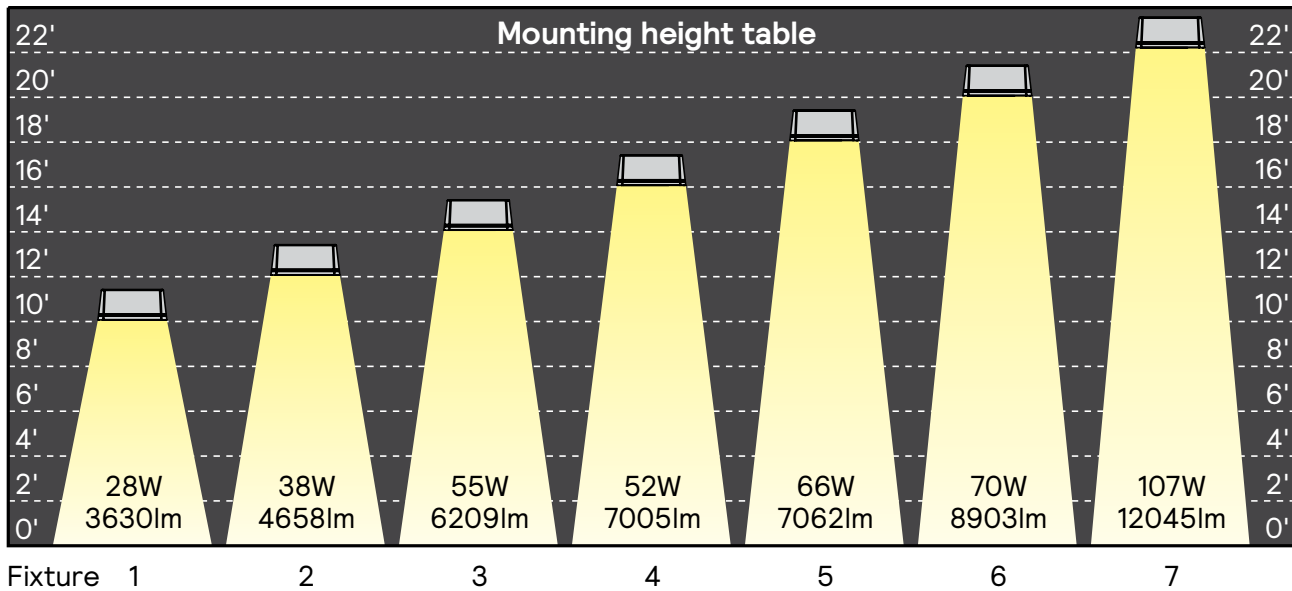

## Mounted fixtures

1. 101L-16L-530-NW-G2
2. 101L-16L-700-NW-G2
3. 101L-16L-1000-NW-G2
4. 101L-32L-530-NW-G2
5. 101L-16L-1200-NW-G2
6. 101L-32L-700-NW-G2
7. 101L-32L-1000-NW-G2

