



Classic Styles with the benefits of LED

Gardco Form Ten LED round area luminaires are a natural complement to their rectilinear counterparts. Architecturally, the series lends itself to an extensive variety of building motifs, permitting the designer to choose to draw attention to the luminaire or to have it gracefully fade into the surroundings. By incorporating state-of-the-art, high performance LEDs, these luminaires provide the classic shapes desired today together with the energy saving advantages of LED.



Construction: The housing is a one-piece spun aluminum design with a rolled reveal that improves structural and aesthetic integrity. Architectural Class 1 anodizing or polyester powdercoat finishes are available.



Clean Material Transitions: The yoke of the post top models echo the shape of the luminaire and seamlessly transitions into the housing. All hardware is recessed and hidden from normal viewing angles.



Rotatable Optics: The LED optic pan is fully field rotatable, enabling distribution and pole orientation to be completely independent of one another. It also allows for reorientation of the optical system should site requirements change.

CAL / MAL Form Ten LED

Round series



Classic forms embrace a contemporary source

Available in both the 17" and 22" sizes, the Form Ten Round LED luminaires are offered in two styles - the domed top "M" series and the cylindrical "C" series. Both models preserve the features and benefits that make them industry leaders in site illumination. A one-piece, die cast aluminum door frame contains a heat and impact resistant glass lens and is fully gasketed with memory-retentive, hollow core silicone rubber. The lens and optical pan hinges down by loosening a captive stainless steel screw. The driver assembly is prewired with quick disconnects and simply dismounts for service or replacement.

Form Ten Round LED revolves around high performance

Where Gardco luminaires ultimately stand out is in optical performance. The Form Ten Round luminaires make use of an advanced high output Class 1 LED array system providing one of four distinctive distribution patterns. This system presents improved light output and a longer lifespan than standard HID sources while consuming a small percentage of the energy. Enhanced visibility and greater efficiency means that fewer luminaires are required to light areas to preferred levels, producing considerable savings and reducing the environmental impact both in the short and long term.

These LED systems use up to 50% less energy than traditional outdoor lighting systems and generally lower energy expenses by up to 40% in comparison to most systems being used today.

Gardco's Applications Engineering Department is ready to assist you with site lighting examination and development.

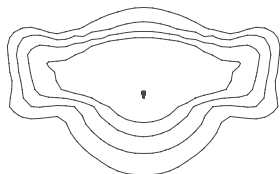

Type II Distribution

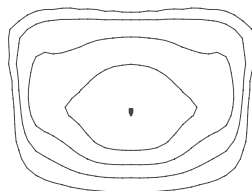

Type III Distribution

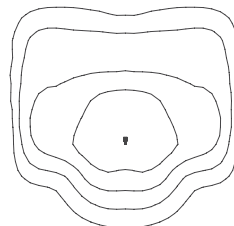

Type IV Distribution

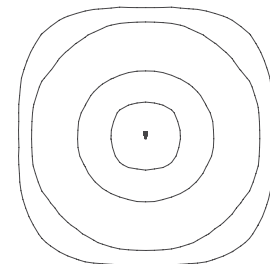

Type V Distribution

Retrofit Kits

Do you currently have Form Ten Round luminaires on your site? Retrofit Kits are an easy way to supply your existing luminaires with high performance LED arrays. These kits permit a simple and efficient changeout, saving time, cost and energy.

The kits include everything required to completely convert the standard Form Ten Round to any of the offered LED wattages and distributions. This includes a new reflector pan outfitted with LED arrays and integral driver(s).

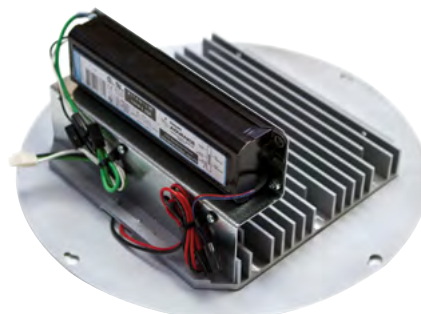

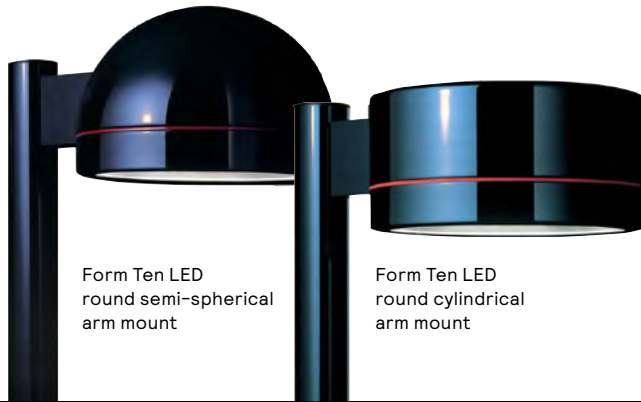

Form Ten LED round semi-spherical arm mount

Form Ten LED round cylindrical arm mount

Form Ten LED round arm mount

- Available in both the 17" and 22" sizes.
- Offered in domed top "M" series and cylindrical "C" series.
- Provides up to 40% energy savings over HID.
- Maintains uniform illumination for improved visibility.
- LED retrofit kits available for existing Form 10 installs.
- Toolless access to driver compartment and optical chamber.

Ordering guide

example: CA17L-32L-450-NW-G2-AR1-2-120-DD-F1-HIS-BK

Prefix	Number of LEDs	Drive Current	LED Color - Generation	Mounting	Distr.	Voltage	Controls	Electrical	Luminaire	Finish
CA17L 17" Cylindrical Luminaire LED	32L 32 LEDs	450 450mA	NW-G2 Neutral White 4000K, 70CRI Generation 2	Arm mounts AR1 for 3"-4.5" round pole	2 Type 2	120 120V	DD 0-10V Dimming Driver	Fusing F1 Single (120, 277, 347VAC)	HIS Internal House Side Shield	BRA Bronze Anodized
MA17L 17" Semi-Spherical Luminaire LED	48L 48 LEDs	700 700mA	WW-G2 Warm White 3000K, 70CRI Generation 2	AR2 for 4.5"+ round pole	3 Type 3	208 208V	Photoelectric/ Receptacle Systems (Twist Lock Receptacle)	F2 Double (208, 240, 480VAC)		BLA Black Anodized
CA22L 22" Cylindrical Luminaire LED	48L 48 LEDs	900 900mA	CW-G2 Cool White 5700K, 70CRI Generation 2	AR3 for square pole	4 Type 4	240 240V	TLRD5 Twist Lock Receptacle 5 Pin	F3 Canadian Double Pull (208, 240, 480VAC)		NA Natural Anodized
MA22L 22" Semi-Spherical Luminaire LED	96L 96 LEDs	560 560mA		Wall mount WM1 with arm	5 Type 5	277 277V	TLRPC Twist Lock Receptacle with Photocell	Pole Mount Fusing FP1 Single (120, 277, 347VAC)		BK Black paint
	650 650mA			WM2 without arm		347 347V		FP2 Double (208, 240, 480VAC)		BZ Bronze paint
				Mast Arm Fitter MA Mounts to a 2-3/8" O.D. mast arm		480 480V		FP3 Canadian Double Pull (208, 240, 480VAC)		WH White paint
						UNV 120-277V 50hz/60hz		Surge Protection SP1 Standard 10KVA SP2 Increased 20KVA		MGY Medium Gray paint
						HVU 347-480V 50hz/60hz				Customer specified RAL (ex: RAL7024) Specify optional color
										CC Custom color (Must supply color chip for required factory quote)

Dimensions and EPA

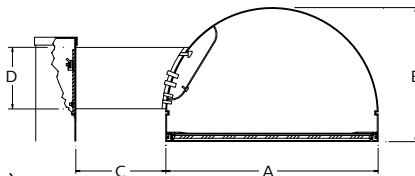

MA style (above)

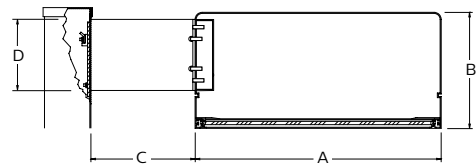

CA style (above)

Size	A	B	C	D	EPA			Weight Single
					Single	Twin	Quad	
MA17	17" 43.2cm	11" 27.9cm	5" 12.7cm	5" 12.7cm	.8ft ² .07m ²	1.6ft ² .15m ²	2.3ft ² .21m ²	27lbs. 12.25kg
MA22	22" 55.9cm	14" 35.6cm	7" 17.8cm	5" 12.7cm	1.3ft ² .12m ²	2.7ft ² .25m ²	3.7ft ² .34m ²	40lbs. 18.14kg

Size	A	B	C	D	EPA			Weight Single
					Single	Twin	Quad	
CA17	17" 43.2cm	8" 20.3cm	5" 12.7cm	5" 12.7cm	.7ft ² .07m ²	1.5ft ² .14m ²	2.1ft ² .20m ²	27lbs. 12.25kg
CA22	22" 55.9cm	11" 27.9cm	7" 17.8cm	5" 12.7cm	1.2ft ² .11m ²	2.3ft ² .21m ²	3.3ft ² .31m ²	42lbs. 19.05kg

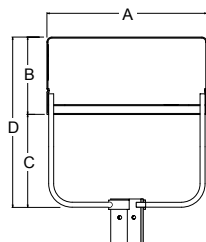

CP style (next page)

Size	A	B	C	D	EPA Single	Weight Single
CP22	22" 55.9cm	11" 27.9cm	11" 27.9cm	22" 55.9cm	1.0ft ² .09m ²	50 lbs. 22.68 kg

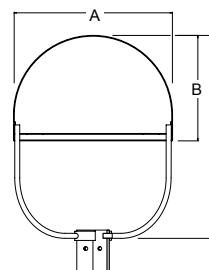

MP style (next page)

Size	A	B	C	D	EPA Single	Weight Single
MP22	22" 55.9cm	14" 35.6cm	11" 27.9cm	25" 63.5cm	1.0ft ² .09m ²	50 lbs. 22.68 kg



Form Ten LED round post top

Form Ten LED Round Semi-Spherical and Cylindrical post top

- Available in both the 17" and 22" sizes.
- Offered in domed top "M" series and cylindrical "C" series.
- Provides up to 40% energy savings over HID.
- Maintains uniform illumination for improved visibility.
- LED retrofit kits available for existing Form 10 installs.
- Toolless access to driver compartment and optical chamber.

Ordering guide

example: CP17L-32L-450-NW-G2-P11-2-120-DD-F1-HIS-BK

Prefix	Number of LEDs	Drive Current	LED Color - Generation	Mounting	Distr.	Voltage	Controls	Electrical	Luminaire	Finish
CP17L 17" Cylindrical Luminaire LED	32L 32 LEDs	450 450mA	NW-G2 Neutral White 4000K, 70CRI Generation 2	P11 P12 P21 P22 P31 P32 P33 P41 P42 P43 T14 T15 T16 T24 T25 T26 T34 T35 T36 T37 T44 T45 T46 T47	2 Type 2	120 120V	DD 0-10V Dimming Driver	Fusing F1 Single (120, 277, 347VAC)	HIS Internal House Side Shield	BRA Bronze Anodized
MP17L 17" Semi-Spherical Luminaire LED	48L 48 LEDs	700 900mA	WW-G2 Warm White 3000K, 70CRI Generation 2		3 Type 3	208 208V	Photoelectric/ Receptacle Systems (Twist Lock Receptacle)	F2 Double (208, 240, 480VAC)		BLA Black Anodized
CP22L 22" Cylindrical Luminaire LED	48L 48 LEDs	900 900mA	CW-G2 Cool White 5700K, 70CRI Generation 2		4 Type 4	240 240V	TLRD5 Twist Lock Receptacle 5 Pin	F3 Canadian Double Pull (208, 240, 480VAC)		NA Natural Anodized
MP22L 22" Semi-Spherical Luminaire LED	96L 96 LEDs	560 650mA			5 Type 5	277 277V	TLRPC Twist Lock Receptacle with Photocell	Pole Mount Fusing FP1 Single (120, 277, 347VAC)		BK Black paint
								FP2 Double (208, 240, 480VAC)		BZ Bronze paint
								FP3 Canadian Double Pull (208, 240, 480VAC)		WH White paint
								Surge Protection SP1 Standard 10KVA SP2 Increased 20KVA		MGY Medium Gray paint
										Customer specified
										RAL (ex: RAL7024) Specify optional color
										CC Custom color (Must supply color chip for required factory quote)

Retrofit kit ordering guide

Prefix	Number of LEDs	Drive Current	LED Color - Generation	Distr.	Voltage	Controls	Electrical
CA/MA17L-RK or CP/MP17L-RK 17" Cylindrical or Semi-Spherical Retrofit Kits	32L 32 LEDs	450 450mA	NW-G2 Neutral White 4000K, 70CRI Generation 2	2 Type 2	120 347 120V 347V	DD 0-10V Dimming Driver	Surge Protection SP1 Standard 10KVA SP2 Increased 20KVA
CA/MA22L-RK or CP/MP22L-RK 22" Cylindrical or Semi-Spherical Retrofit Kit	48L 48 LEDs	900 900mA	WW-G2 Warm White 3000K, 70CRI Generation 2	4 Type 4	240 120-277V 240V 120-277V		
	96L 96 LEDs	560 560mA	CW-G2 Cool White 5700K, 70CRI Generation 2	5 Type 5	277 50hz/60hz 277V HVU 347-480V 50hz/60hz		



Prior to ordering, consult specification sheets on gardcolighting.com for the most current information, notes, and exclusions.

The information presented in this document is not intended as any commercial offer and does not form part of any quotation or contract.



© 2019 Signify Holding. All rights reserved. This document contains information relating to the product portfolio of Signify which information may be subject to change. No representation or warranty as to the accuracy or completeness of the information included herein is given and any liability for any action in reliance thereon is disclaimed. All trademarks are owned by Signify Holding or their respective owners.

Signify North America Corporation
200 Franklin Square Drive,
Somerset, NJ 08873
Telephone 855-486-2216

Signify Canada Ltd.
281 Hillmount Road,
Markham, ON, Canada L6C 2S3
Telephone 800-668-9008