

Invue ClearCurve Wall

Features and Benefits

Simple in Form. Rich in Features.

Distinctive yet compatible with varied architectural styles, the ClearCurve Collection presents a clean, uncluttered dayform and visual comfort for near-building pedestrian spaces, campuses, and parks. ClearCurve Wall accents and illuminates the buildings it is paired with, illuminating the landscapes and sidewalks near exterior walls. It can be used to light indoor pool deck areas with the Natatorium finish option. The Uplight configuration delivers eye-catching wall wash lighting, and Back Box accessories facilitate surface conduit installations.

PRODUCT FEATURES

- Outputs from 2,700 to over 11,000 lumens
- Efficacies up to 149 lms/W
- DLC and DLC Premium configurations
- Available CCTs:
 - 70 CRI – 2700K, 3000K, 3500K, 4000K, 5000K, 6000K
 - 80 CRI – 2700K, 3000K, 3500K, 4000K, 5000K
- Amber 590nm
- Photometric options:
 - LightSquares – T1, T2, T3, T4FT, T4W, SL2, SL3, SL4, SLL, SLR
 - WaveStream – T2, T3, T4FT, T4W
- Full range of control and sensor options
- 3-Pin, 7-Pin or Zhaga 4-Pin receptacle options
- Uplight configuration for wall wash/wall graze applications
- Natatorium and Coastal options
- Surface mount Back Box accessory option
- Cold weather battery pack option with back box
- Can be converted to pole mount with Pole Mount Kit accessory
- Fuse options

PRODUCT BENEFITS

- Accent and illuminate building exteriors
- Illuminate landscapes and sidewalks
- Back box accessories enable retrofit installations
- Can be paired with ClearCurve Pedestrian for a complete building and site solution

PRODUCT DIMENSIONS

Front View

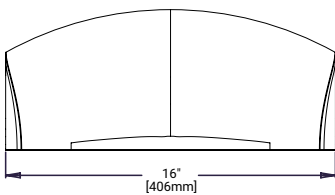

Side View

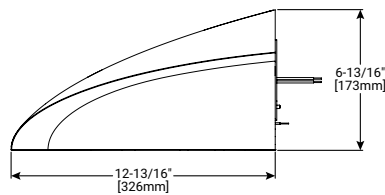

Back View

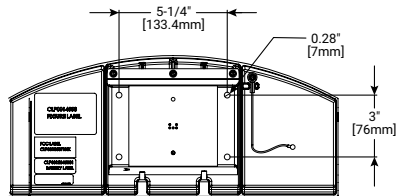

QUICK FACTS

- 0-10V dimming driver standard
- 10kV surge standard
- Five-year warranty



Cooper Lighting Solutions
1121 Highway 74 South
Peachtree City, GA 30269
P: 770-486-4800
www.cooperlighting.com

© 2021 Cooper Lighting Solutions
All Rights Reserved
Publication No. SA516123EN
February 22, 2023 9:36 AM

Cooper Lighting Solutions is a registered trademark.

All other trademarks are property of their respective owners.

Product availability, specifications, and compliances are subject to change without notice.