

DESCRIPTION

The Arbor Wall Sconce shares the same architectural appearance as the Arbor post top and Bollard luminaires to provide a unique coordinated look enhancing any architectural or pedestrian setting. WaveStream™ LED optics eliminates the LED pixelated image and reduces visible glare providing high levels of visibility.

Catalog #		Type	
Project			
Comments		Date	
Prepared by			

SPECIFICATION FEATURES

Construction

External hardware and casting seams are minimized to enhance appearance. IP66 rated, low copper, cast aluminum housing maintains strength and precision providing for: rapid heat dissipation, vandal resistance and superior dayform.

Optics

General purpose symmetric distribution is available using WaveStream LED optical technology. The optical waveguide is manufactured using precision injection molded acrylic for the ultimate level of glare control and visual comfort. Offered standard in 4000K (+/- 275K) CCT, optional 3000K minimum 80 CRI.

Electrical

LED driver(s) are mounted to electrical tray for easy installation and maintenance for 120-277V 50/60Hz operation. Offered standard with 0-10V dimming driver and Cooper Lighting Solutions' proprietary circuit module designed to withstand 10kV of transient line surge. Luminaire is suitable for ambient

temperature applications from -40°C (-40°F) to 40°C (104°F) and IP66 rated against the ingress of dust and water.

Controls

The Arbor Wall Sconce options are designed to be simple and cost-effective ASHRAE and California Title 24 compliant solutions. An integrated dimming and occupancy sensor is a standalone control option available in bi-level dimming (MSP/DIM) operation. An optional handheld remote allows custom programming to suit all needs.

Mounting

Standard cast aluminum secure-mount plate that mounts to the wall directly over a 4" J-Box. Fixture hinges onto mounting plate and is secured with single stainless steel fastener. Mounting plate features a one piece EPDM gasket on back side of plate to firmly seal fixture to wall surface, forbidding entry of moisture and particulates.

Finish

Cooper Lighting Solutions utilizes premium ultra-weatherable TGIC based polyester powder coatings that are specifically formulated to withstand extended outdoor exposure. The powders are formulated exclusively for Cooper Lighting Solutions to serve functionally as well as decorative. Good film appearance combined with excellent mechanical exterior exposure qualities display greater than twice as much gloss retention. RAL and custom color matches available. Finish is compliant with ASTM B117 3000hr salt spray standard. Options to meet Buy American Act requirements

Warranty

Five-year warranty.



ABW ARBOR WALL SCONCE

WALL MOUNT LUMINAIRE

DIMENSIONS

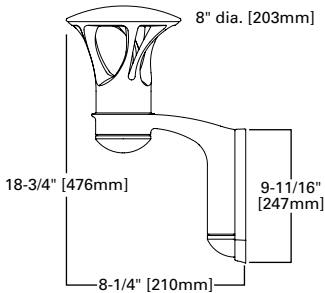

WALL SCONCE DRILL PATTERN

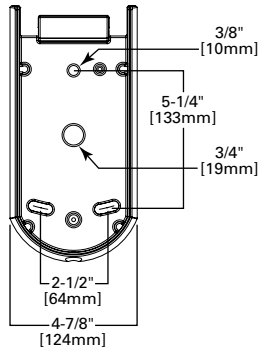

CERTIFICATION DATA

UL/cUL Listed
ISO 9001
RoHS
IEC 60529 IP66 Housing
ANSI C136.31 3G Vibration
ASTM A356.0 Low Copper Alloy
ASTM B117 Salt Spray Tested

ENERGY DATA

Electronic LED Driver
>0.9 Power Factor
<20% Total Harmonic Distortion
120-277V 50/60Hz
-40°C Minimum Temperature
40°C Ambient Temperature Rating

SHIPPING DATA

Approximate Net Weight:
11.7 lbs. [5.3 kgs.]

POWER AND LUMENS

Lumen/Distribution	B1 Asymmetric	B2 Asymmetric
Drive Current		
Power Wattage (Watts)	11W	23W
Input Current (mA) @ 120V	100	200
Input Current (mA) @ 208V	60	120
Input Current (mA) @ 240V	50	100
Input Current (mA) @ 277V	40	90
Optics		
Lumens	499	882
BUG Rating	B0-U1-G1	B0-U2-G1

LUMEN MAINTENANCE

Ambient Temperature	TM-21 Lumen Maintenance (60,000 Hours)	Calculated L70 (Hours)
25°C	>94%	>350,000
40°C	>93%	>250,000
50°C	>90%	>170,000

NOTE: Maintenance data applies to the highest drive current and represents the worst case at the highest wattage.

LUMEN MULTIPLIER

Ambient Temperature	Lumen Multiplier
0°C	1.02
10°C	1.01
25°C	1.00
50°C	0.97

COLOR TEMPERATURE

Color Temperature (CCT)	CRI (Nominal)	Multiplier (Hours)
4000	70	1.00
3000	80	0.87

ORDERING INFORMATION

Sample Number: ABW-B2-LED-D1-A-GM

Product Family	Lumens ¹	CRI / CCT	Source	Voltage	Distribution	Color
ABW=Arbor Wall Mount BAA-ABW=Arbor Wall Mount Buy American Act Compliant ⁷	B1=Mid Lumen Output B2=High Lumen Output	727=70 CRI / 2700K 8030=80 CRI / 3000K CCT ⁴	LED	D1=Dimming Driver (120-277V) ²	A=Asymmetric	AP=Grey BZ=Bronze BK=Black DP=Dark Platinum GM=Graphite Metallic WH=White CC=Custom Color ³
Options (Add as Suffix)				Accessories (Order Separately) ⁸		
HA=50° High Ambient ⁵ MS/DIM-L8=Motion Sensor for Dimming or Bi-Level Operation ⁶ DIM=0-10V Dimming Driver Leads Brought Out from Fixture				ISHH=Wireless Configuration Tool for Integrated Sensor (Occupancy Sensor Settings) ⁶		

- NOTES:**
- Standard 4000K CCT nominal 70 CRI.
 - Dimming driver standard.
 - RAL and custom color matching available. Consult your lighting representative at Cooper Lighting Solutions for more information.
 - Extended lead times apply. Use dedicated IES files when performing layouts.
 - HA option limited to B1 lumen package.
 - The ISHH configuration tool is required to adjust parameters including high and low dimming, sensitivity, time delay, cutoff and more. Consult your lighting representative at Cooper Lighting Solution for more information.
 - Only product configurations with this designated prefix are built to be compliant with the Buy American Act of 1933 (BAA). Please refer to [DOMESTIC PREFERENCES](#) website for more information. Components shipped separately may be separately analyzed under domestic preference requirements.
 - Accessories sold separately will be separately analyzed under domestic preference requirements. Consult factory for further information.