

LED Lighting Fixture

SAVE THESE INSTRUCTIONS



BEFORE YOU BEGIN

Read and follow all safety instructions



WARNING

RISK OF FIRE, EXPLOSION AND ELECTRIC SHOCK

- This product should be installed, inspected, and maintained by a qualified electrician only, in accordance with the NEC (National Electric Code) and all local codes.
- Turn off electrical power before inspection, installation or removal.
- Use only UL (or other NRTL) approved wire for input/output connections.
- Minimum size 18 AWG or 14 AWG for continuous runs.
- Make sure LEDs and drivers are cool to touch when performing maintenance.
- Make sure the supply voltage is the same as the rated voltage of the luminaire.
- Do not install in a hazardous atmosphere, except where the ambient temperature does not exceed the rated operating temperature of the fixture.
- Keep tightly closed when in operation



Prepare Electrical Wiring



Electrical Requirements

- The LEDdriver must be supplied with 120 to 277V, 50/60 Hz and connected to an individual, properly grounded branch circuit protected by a 20 Ampere circuit breaker. Use min. 75°C supply.



Grounding Instructions

- The grounding and bonding of the overall system shall be done in accordance with NEC Article 600 and local codes

LED Security Light w/ Motion Sensor ORMS Series

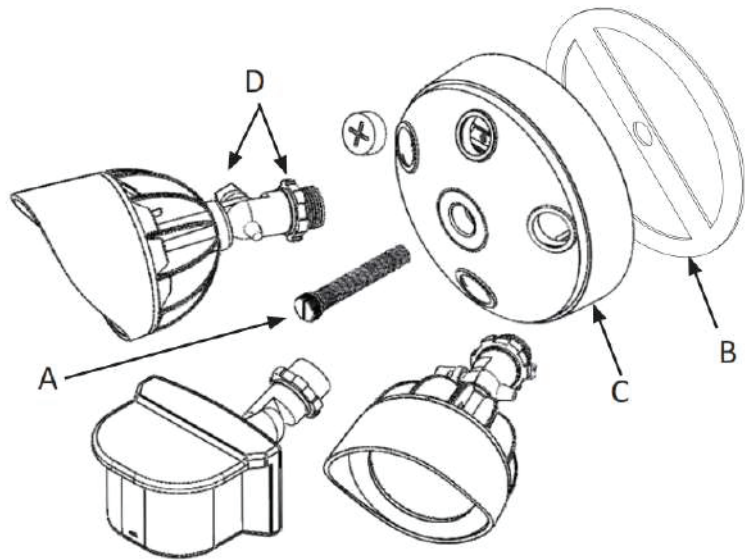

Tools Required:

1/8" Allen Key
Wire Strippers
Wire Cutters
Phillips Screw Driver

- Remove all parts from packaging along with hardware bag.
- Install mounting strap to junction box.
- Connect leads from back of fixture to the power supply leads:Green to green (ground), black to black (hot), white to white (neutral).
- Mount fixture onto electrical box using the screw[A] provided. Be sure gasket[B] is placed securely between mounting plate[C] and electrical box. Care must be taken to avoid pinching wires.
- Tighten the fixture down securely. Point the LED heads and motion sensor to the desired direction, then tighten the lock nut[D]. (To prevent twisting of wires, do not rotate the fixture past the limits specified on the fixture.)
- Apply silicone caulk around all sides of the mounting plate where it meets the mounting surface.

Standard Wiring Diagram



LED Security Light w/ Motion Sensor ORMS Series

The motion sensor on this fixture has a built in Dusk-to-Dawn sensor that automatically disables the motion sensor during daylight hours regardless of motion detection.

1. The motion sensor must be tested before setting the time and sensitivity levels. The TEST option is located on the TIMER control knob on the underside of the sensor head. To test the fixture, switch the wall switch that controls power to the fixture to the ON position and turn the rotary knob to the "TEST" area. During test mode, the lights will come on for 20 seconds, regardless of motion detection or the time of day. The light will shut off automatically after 20 seconds. Leave the rotary knob in the "TEST" area and test the sensitivity by crossing in the path of the sensor. The light will come on only if it senses movement. Once movement stops, it will turn off in 5 seconds. The test is now complete.

2. Once the fixture has been tested for proper operation and sensitivity, rotate the TIMER control knob at the "1 Min" or "5 Min" or "10 Min" position into the timer settings. The timer settings indicate how long the light stays on after the PIR senses motion. Rotating this knob clockwise raises the stay on time of the motion sensor for up to 10 minutes. Rotating the knob counter clockwise shortens the stay on time to as close as 60 seconds (Cannot go past "1 Min" position). It may be necessary to adjust the TIMER knob several times until the desired ON time is achieved.

3. The control knob located on the opposite side is Marked SENSITIVITY, which determines the degree of Motion detection. Rotating this knob counterclockwise raises the sensitivity of the motion sensor for up to 60 ft. of distance. Rotating the knob clockwise lowers the sensitivity down to as close as 10 ft. It may be necessary to adjust the "SENSITIVITY" knob several times until the desired setting is achieved.

NOTE: The higher sensitivity level increases the Likelihood of a false activation being triggered. For maximum range performance, allow the fixture to operate in any setting (with power) for at least 48 hours.

4. The 240 degree coverage of the motion sensor is measured side to side; therefore, the sensor will detect motion across the field of view (Side-to-side), rather than motion coming straight at the sensor (In-and-out). Adjust the motion sensor head so that it detects motion moving across the coverage area. The position of the sensor head should not exceed 45 degrees from horizontal. Do not aim the Motion sensor at a body of water, bushes or plants that may move in the wind or pedestrian traffic, moving cars, etc., as this will trigger the motion sensor. NOTE: If the Sensor arm becomes loose, it will not hold the sensor head at the joint screw on the sensor arm.

5. When the TIMER control knob is set at the Timer area (between "Auto" and "10"), to control the light from inside the home, activate manual override mode by toggling the wall light switch OFF and ON within 2 seconds. The security light will turn on and stay on for approximately 8 hours, or until the Dusk-to-Dawn sensor detects light in the morning. Once the Dusk-to-Dawn sensor detects light, the manual override mode will automatically go back to its original settings of the AUTO motion sensor.

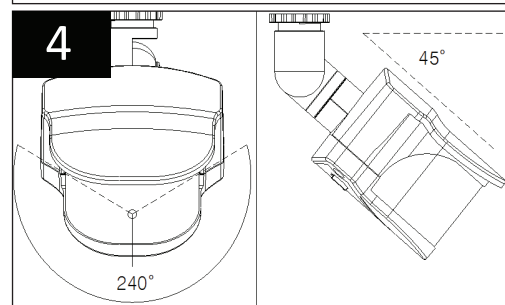
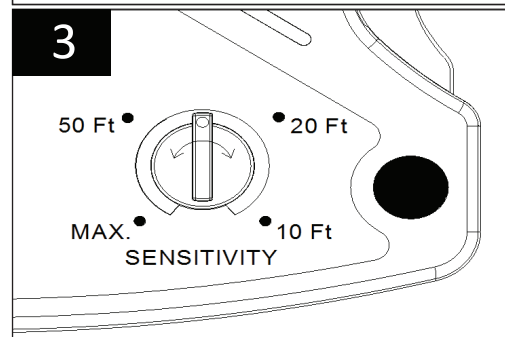
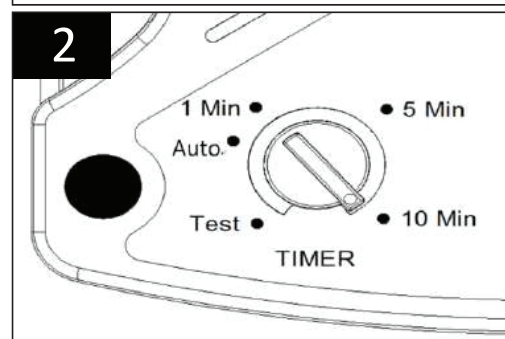
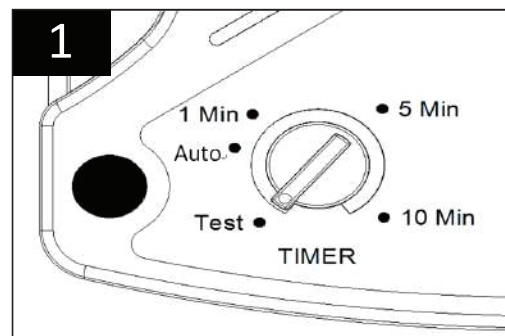

Fig.2 Manual Override Operating Diagram

