



N/A



BASE MOUNT

WALL MOUNT

CANTILEVER MOUNT

CEILING MOUNT

These installation instructions are valid with the above Arrowlinear mounting options.

## ARROWLINEAR INDOOR

RC3: BASE, WALL, CEILING

**Warning:** Before starting any work ensure that all sources of power are turned off. All work must meet local/national codes and be performed by a certified electrician. **Do not** mount fixtures vertically. Indoor fixtures cannot be used for outdoor applications.

### Complete Fixture Assembly

(Fixture lengths vary depending on lamp type; see lamp chart on page 2)

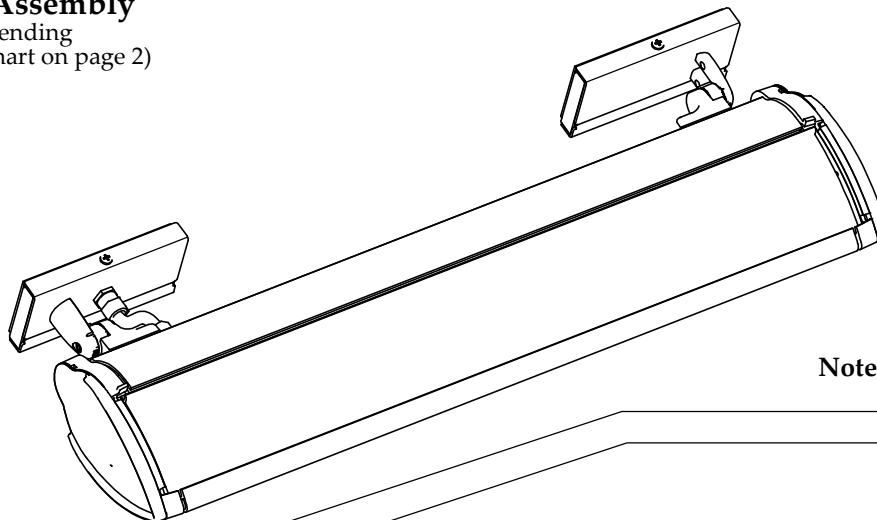

**Note:** RC3 mounting is fully adjustable.

### Exploded View

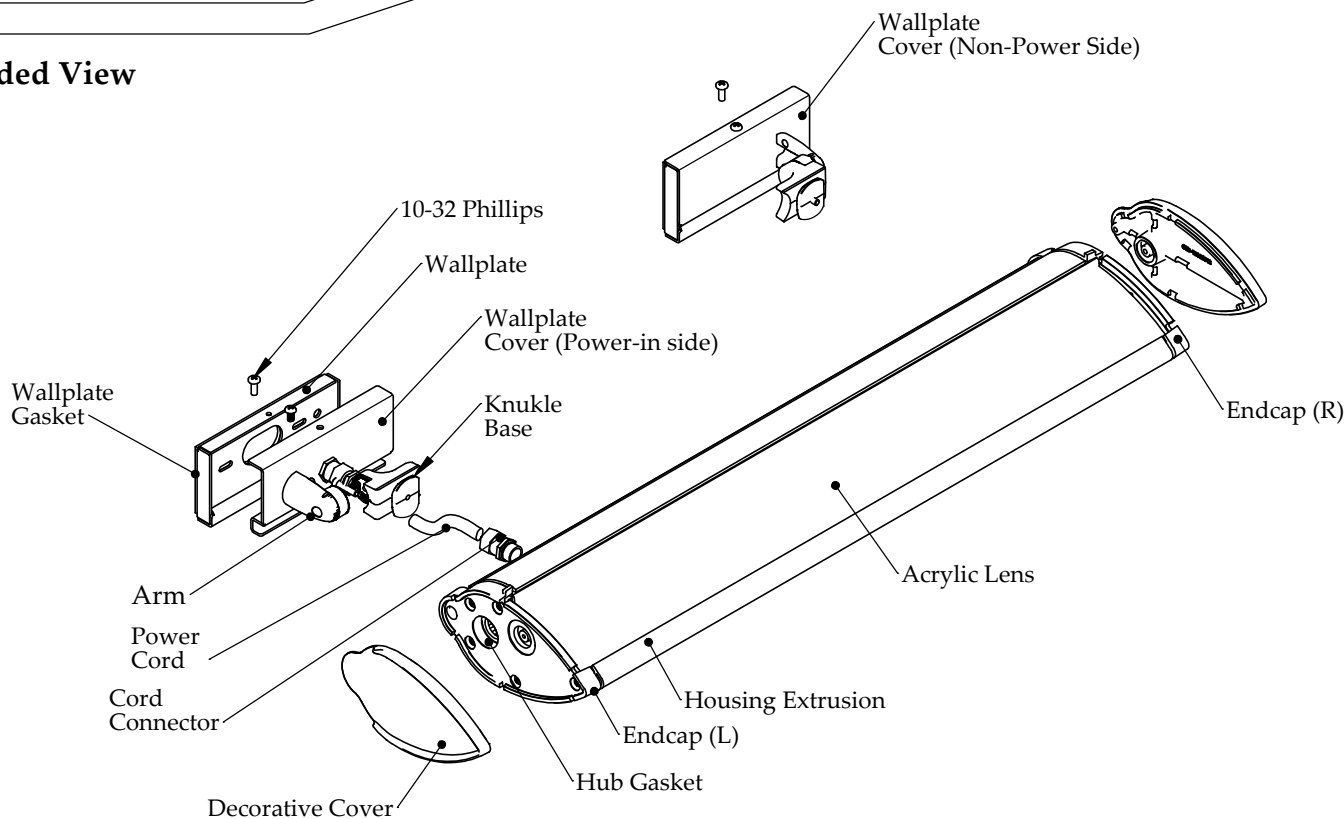



BASE MOUNT



WALL MOUNT

N/A

CANTILEVER MOUNT



CEILING MOUNT

These installation instructions are valid with the above Arrowlinear mounting options.

## ARROWLINEAR INDOOR RC3: BASE, WALL, CEILING

**Warning:** Before starting any work ensure that all sources of power are turned off. All work must meet local/national codes and be performed by a certified electrician. **Do not** mount fixtures vertically. Indoor fixtures cannot be used for outdoor applications.

### Lamp Chart

Available Lengths	Available Wattages	Available Lamp Types	Mounting plate centers in (mm)
1FT	12W	(LED)	Single Mount
2FT	14W	(T5)	22 - 13/16IN (580mm)
2FT	17W	(T8)	
2FT	24W	(T5 HO)	
2FT	22W	(LED)	
3FT	21W	(T5)	34 - 5/8IN (880mm)
3FT	25W	(T8)	
3FT	39W	(T5 HO)	
3FT	33W	(LED)	
4FT	28W	(T5)	46 - 7/16IN (1180mm)
4FT	32W	(T8)	
4FT	54W	(T5 HO)	
4FT	44W	(LED)	
6FT	2 X 21W	(T5)	72 - 29/32IN (1852mm)
6FT	2 X 25W	(T8)	
6FT	2 X 39W	(T5 HO)	
6FT	3 X 33W	(LED)	
8FT	2 X 28W	(T5)	96 - 17/32IN (2452mm)
8FT	2 X 32W	(T8)	
8FT	2 X 54W	(T5 HO)	
8FT	2 X 44W	(LED)	
12FT	3 X 28W	(T5)	146 - 27/64IN (3719mm) MIDDLE ARM 73 - 7/32IN (1860mm)
12FT	3 X 32W	(T8)	
12FT	3 X 54W	(T5 HO)	
12FT	3 X 44W	(LED)	

Note: 12FT fixtures do require a middle arm. (See lamp chart)

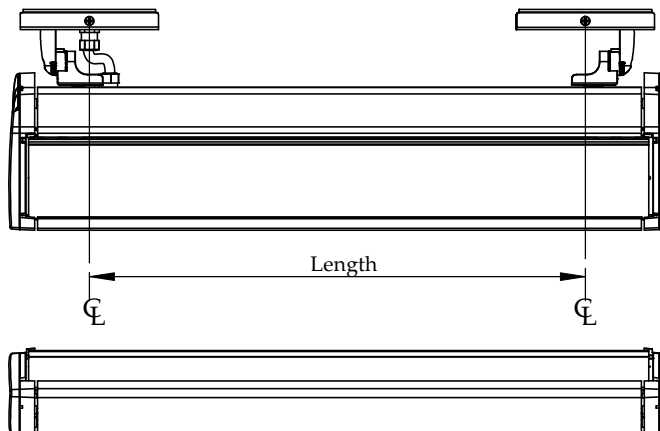

### Prior to Roughing in J-Boxes:

1. Determine the location of fixture mounting and verify structure will support the weight of the fixtures. If necessary, use additional bracing to support Fixture.
2. Using mounting plate centers provided in lamp chart, attach mounting arms to fixture assembly (ref. figure 1).
3. Install Indoor rated J-Boxes (by others) (ref. figure 2).

### 1. Mounting Arm to Fixture Assembly

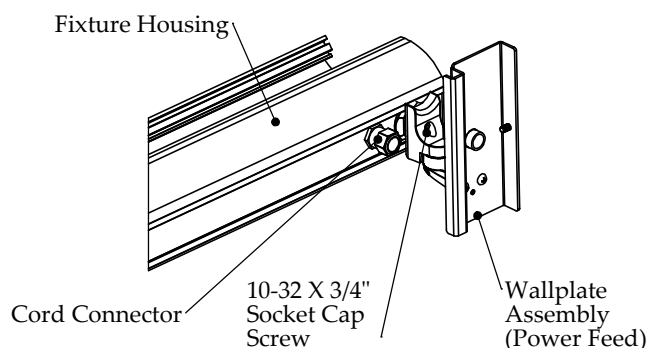

1. Assemble wallplate power feed and knuckle together.
2. Once the wallplate assembly (Power Feed or Non Power) is assembled, place the Knuckle base horizontally into extrusion track located on back of the fixture (shown above).
3. Rotate the complete wallplate arm Power Feed assembly counter-clockwise 90°; and the Non-Power assembly clockwise 90°.
4. Adjust Mounting Arms horizontally to match the desired mounting location and tighten the 10-32 X 3/4" Socket Cap screw; use lamp chart for recommended standard spacing.

### 2. Mounting Power-side Assembly

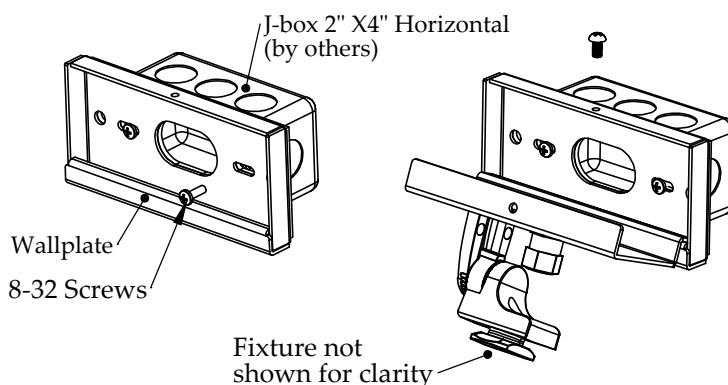

1. Once the RC3 mounting arms have been completely assembled, secure Wallplate over the Horizontal J-box. If necessary, use additional bracing to support. Using 8-32 screws for alignment purpose only, use appropriate 1/4" fasteners (by others), to mount to structure.
2. Use the hinge wallplate feature to hang the fixture while you wire the fixture power to the main power inside the J-box, making sure to rotate the fixture back up and secure using the provided hardware.



N/A



BASE MOUNT

WALL MOUNT

CANTILEVER MOUNT

CEILING MOUNT

These installation instructions are valid with the above Arrowlinear mounting options.

## ARROWLINEAR INDOOR RC3: BASE, WALL, CEILING,

**Warning:** Before starting any work ensure that all sources of power are turned off. All work must meet local/national codes and be performed by a certified electrician. **Do not** mount fixtures vertically. Indoor fixtures cannot be used for outdoor applications.

### Power Feed

1. Wire the power cord (supplied) to the inside of the fixture by running the power cord through the endcap and out the back through the cord connector (If needed remove reflector).
2. Attach all wires and ensure all connections are properly matched. Hide wires inside the fixture and attach Decorative Cover using 10-32 X 1/2" Socket Cap screw.

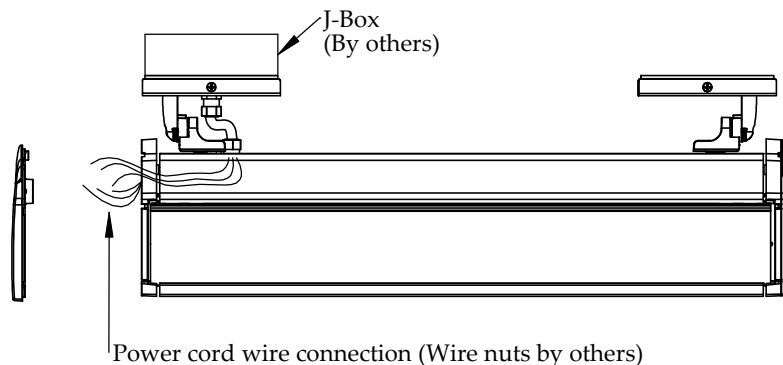

### Mounting Plate Dimensions: in [mm]

#### (Front View)

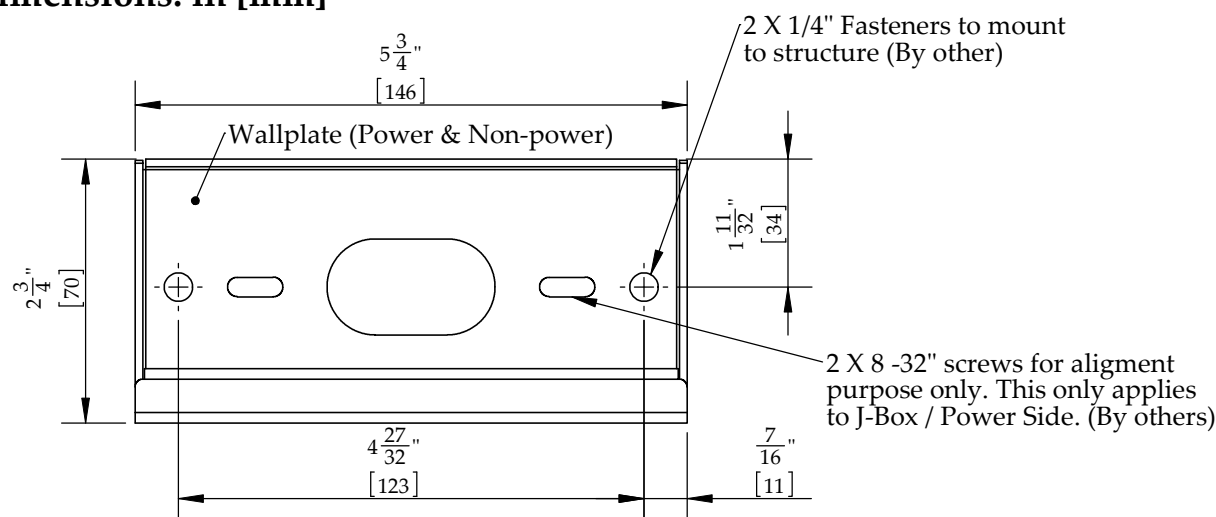

#### (Side View)

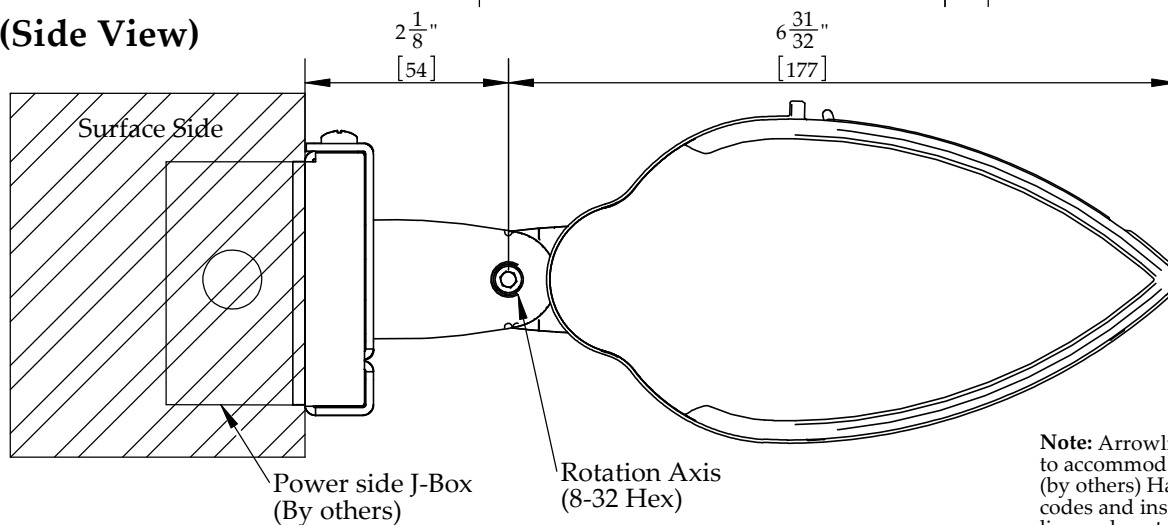

**Note:** Arrowlinear Wallplates are designed to accommodate 1/4" mounting hardware. (by others) Hardware must meet Local / National codes and installation must be provided by a licensed contractor.