

FK44

Flange Kit for 4x4 LLI Troffer

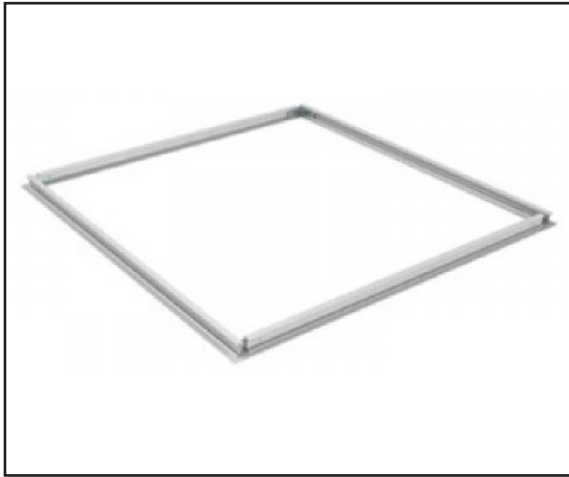

PRODUCT SPECIFICATIONS

DESCRIPTION

The FK44 is a flange kit for the LLI 4X4 recessed lay-in troffer. The kits act as T-Bar frames to support a recessed troffer in wood, drywall, or plaster ceilings. From the room side flange kits mimic the appearance of T-Bars in a baked white enamel finish.

CONSTRUCTION

Made from 20 gauge steel with white finish. All kits include the following hardware: (2) side flanges, (2) end flanges and short 8/32 hex screws.

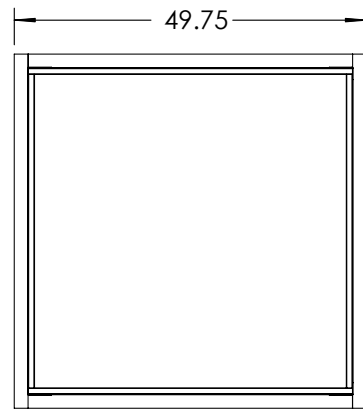

4' X 4'
47.75 x 47.75"

SUGGESTED ROUGH-IN: 48.25 x 48.25

INSTALLATION

STEP 1

Install screws provided as shown in the figure below.

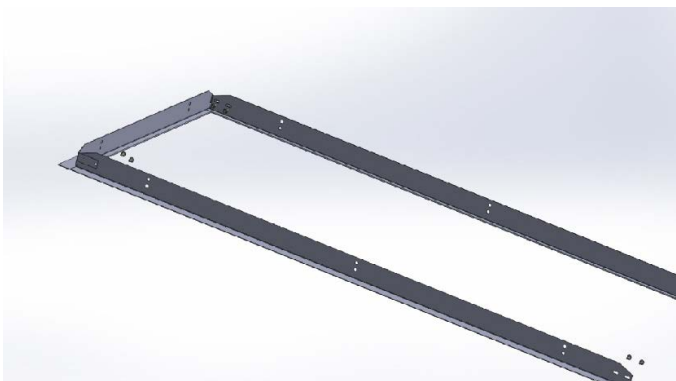

STEP 2

Install kit into the ceiling using contractor supplied screws or nails.

