

# AE62

## LED Vanity

### Features

#### Housing

Aluminum Extrusion with Die-Form Cold-Rolled Steel Ends  
 Finish Option: Satin Nickel and Oil Rubbed Bronze

#### Optical

Shade: High Transmission Acrylic Create Excellent Light Distribution and Uniformity  
 LED: High Efficiency, High CRI, Binned and Mixed to Reach Uniform Light.

#### Electrical

High Power Factor, Low THD

#### Lamp

LED Type: Built-in (Color Temperature Option – 3000K, 3500K, 4000K, 5000K)

#### Certification

ETL/cETL Listed for Damp Locations, Energy Star

#### Warranty

5 Years Warranty on Driver and LED Module

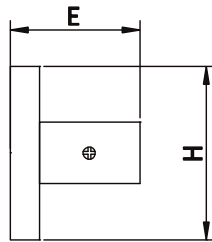

### LED Type

Model	Input Voltage	Input Wattage	LED CT / CRI	Lumen (TYP)	Finish	Dimension (L x H x E)	Energy Star
AE62-11-xxxxK-SN	120V ~ 277V	11W	3000K / >80	935	Satin Nickel	22.0" x 4.8" x 3.8"	Yes
AE62-18-xxxxK-SN	120V ~ 277V	18W	3000K / >80	1530	Satin Nickel	34.0" x 4.8" x 3.8"	Yes
AE62-23-xxxxK-SN	120V ~ 277V	23W	3000K / >80	1950	Satin Nickel	46.0" x 4.8" x 3.8"	Yes
AE62-11-xxxxK-BRZ	120V ~ 277V	11W	3000K / >80	935	Oil Rubbed Bronze	22.0" x 4.8" x 3.8"	Yes
AE62-18-xxxxK-BRZ	120V ~ 277V	18W	3000K / >80	1530	Oil Rubbed Bronze	34.0" x 4.8" x 3.8"	Yes
AE62-23-xxxxK-BRZ	120V ~ 277V	23W	3000K / >80	1950	Oil Rubbed Bronze	46.0" x 4.8" x 3.8"	Yes

\*CCT Options: 3000K, 3500K, 4000K, 5000K\*

Replace xxxxK in part number with desired CCT