

- Available in LED
- Powder Coated Cast Aluminum
- Wall or Ceiling Mount
- Enclosed & Gasketed
- ETL Listed for Wet Locations (IP65)
- Bug Proof



EXAMPLE # AE50-LE1800-C-W-W

STYLE # LIGHT SOURCE

AE50 EOS LED 120V AC, 50/60 Hz, HPF, 50,000 HRS L70*, AMBIENT OP TEMP
AE51 -40°C TO +40°C, 5 YEAR WARRANTY, DIMMABLE, ENERGY STAR***

LE1200 - 14W, 80 CRI **W**-1430lm 3000K
 >102 Lumens Per Watt** **C**-1500lm 4000K

LE1800 - 22W, 80 CRI **W**-1950lm 3000K
 >88 Lumens Per Watt** **C**-2130lm 4000K

LE2600 - 32W, 80 CRI **W**-2700lm 3000K
 >84 Lumens Per Watt** **C**-2750lm 4000K

**MULTI-VOLT LED 120-277V, 50/60 Hz, CONSTANT CURRENT AT 700mA,
 DRIVER UL CLASS 2, HPF, THERMALLY PROTECTED ARRAY, 50,000 HRS L70*
 AMBIENT OP TEMP -40°C TO +40°C, 3 YEAR WARRANTY, ENERGY STAR*****

L1800 - 22W Power Input **W**-1704lm 3000K
 CRI 74 (TYP) **C**-1824lm 4000K
 >82 Lumens Per Watt**

BODY DIFFUSER OPTIONS

W-White **POLYCARBONATE** **M**-Motion Sensor
B- Black **W**-White **EB**-Emergency Backup

**options not available with LE2600*

W-White **POLYCARBONATE** **M**-Motion Sensor
B- Black **W**-White

Advantage Environmental Lighting

Address: 301 E Risinger Rd, Bldg. 109
 Fort Worth, TX 76140
 Phone: 817-468-3591
 Email: info@aelnow.com

Specifications are subject to change without notice.

EMERGENCY BACKUP LED LIGHT



- o 135 Min. of Emergency Backup LED
- o Test Switch/LED Charge Indicator
- o 4W LED Backup Array
- o NiCd, 3.6 VDC Battery
- o 24hr Recharge Time
- o Ambient Temp: 0 °C to +40 °C
- o 5yr Warranty



RoHS compliant



FIXTURES WITH EMERGENCY BACKUP LED LIGHT OPTION



AE51

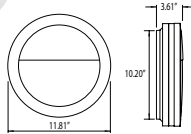

- o IP65 Rated & ADA Compliant
- o Enclosed & Gasketed
- o Wall or Ceiling Mount
- o ETL Listed for Wet Locations



AE50

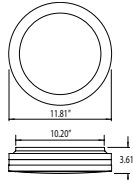

AE01

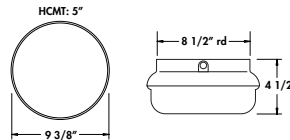

- o Vandal Resistant
- o Knockouts for Conduit Wall or Ceiling Mount
- o UL Listed for Wet Locations



AE02

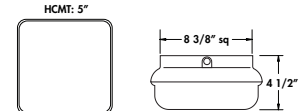

EXAMPLE: AE50-LE1200-W-B-W-EB

STYLE # LIGHT SOURCE

AE50	EOS LED 120V AC, 50/60 Hz, HPF, 50,000 HRS L70*, AMBIENT OP TEMP -40°C TO +40°C, 5 YEAR WARRANTY, DIMMABLE	BODY	DIFFUSER	OPTIONS
AE51	LE800 - 13W Power Input CRI 80 (TYP) >88 Lumens Per Watt**	W -White B - Black	POLYCARBONATE F -Frosted Prismatic W -White*	M -Motion Sensor EB -Emergency Backup
AE01	LE1200 - 14W Power Input CRI 80 (TYP) >102 Lumens Per Watt**	W -1140lm 3000K C -1280lm 4000K		
AE02	LE1800 - 23W Power Input CRI 80 (TYP) >88 Lumens Per Watt**	W -1430lm 3000K C -1500lm 4000K W -1950lm 3000K C -2130lm 4000K		

MULTI-VOLT LED 120-277V, 50/60 Hz, CONSTANT CURRENT AT 700mA, DRIVER UL CLASS 2, HPF, THERMALLY PROTECTED, 50,000 HRS L70*, AMBIENT OP TEMP -40°C TO +40°C, 3 YEAR WARRANTY

L1800	- 22W Power Input CRI 74 (TYP) >82 Lumens Per Watt**	C -1824lm 4000K
--------------	--	------------------------

W -White B - Black	POLYCARBONATE F -Frosted Prismatic W -White*	M -Motion Sensor EB -Emergency Backup
-------------------------------------	--	--

*AE50 & AE51 ARE ONLY AVAILABLE WITH WHITE POLYCARBONATE DIFFUSER **ESTIMATED FROM LED SOURCE