

# leef Ultra Thin Case

## Quick Start Guide

for iPhone®

### COMPATIBILITY:

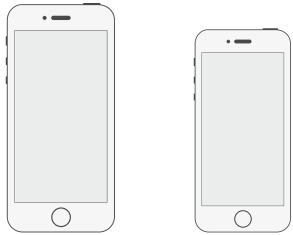

iPhone 7 Plus    iPhone 7

### COLORS:

Semi-transparent



Black

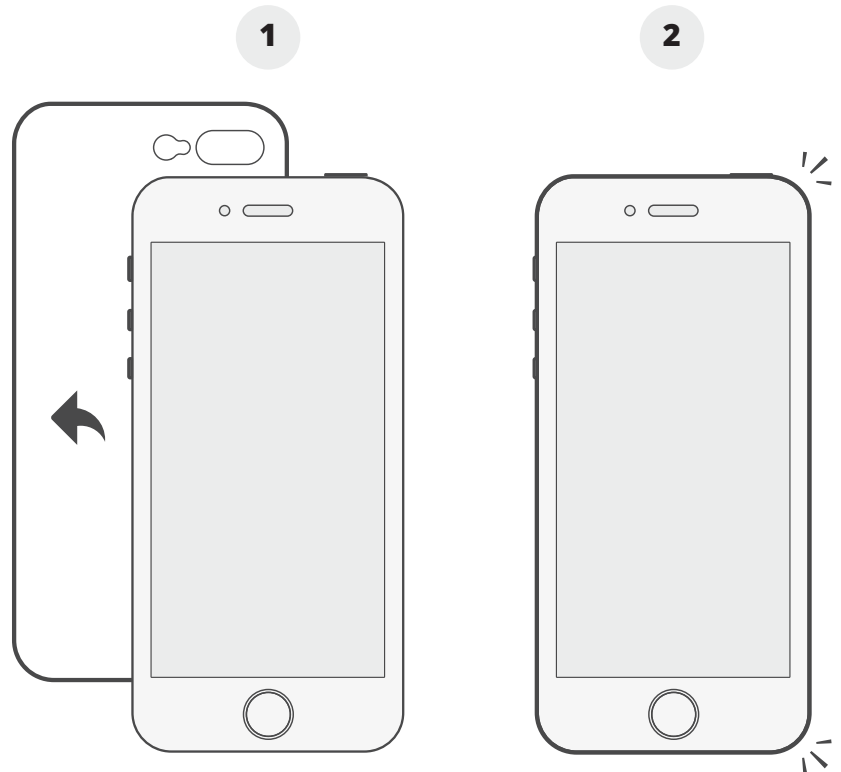

Slide the iPhone into the left side of your Leef Case

Carefully snap all edges for a perfect fit

# LEEF ULTRA THIN iPhone® CASE

SLIM DOWN YOUR CASE



Need More Help? No problemo! If you're not satisfied or need more help, please don't hesitate to contact us: [services@leefco.com](mailto:services@leefco.com)