

NUC Fanless Embedded System



Specification:

■ Dimension (W*D*H)	■ 116 * 110 * 49 mm
■ Construction	■ Top cover & I/O plate –Aluminum; Base- Metal
■ Colors	■ HBJC313U591(W)-3160-B
■ MB model	■ JNU591-3160
■ CPU	■ Intel® Braswell N3160 SoC Processor 1.6GHz (up to 2.24GHz)
■ BIOS	■ AMI UEFI 64 Mb
■ Memory	■ 1 * DDR3L SO-DIMM slot (Max. to 8GB)
■ Front I/O Port	<ul style="list-style-type: none"> ■ 2 * USB 3.0 (type A) ■ 1 * COM ■ 1 * Power Knob
■ Rear I/O Port	<ul style="list-style-type: none"> ■ 2 * USB 3.0 (type A) ■ 2 * HDMI (1.4b) ■ 1 * DP (1.1a) ■ 2 * RJ45 (Giga LAN) ■ Wi-Fi (option) ■ 1 * Line out/MIC Combo ■ 1 * DC-in jack
■ Expansion Slot	<ul style="list-style-type: none"> ■ 1 * half size Mini PCIe slot ■ 1 * full size Mini PCIe slot for Mini PCIe /mSATA Device ■ 1 * SIM card holder
■ Power Source	■ Adapter : AC_90~240V / DC_12V / 40W
■ Certification	<ul style="list-style-type: none"> ■ EMC : CE, FCC ■ Safety : RoHS, ErP
■ Environment	<ul style="list-style-type: none"> ■ Operating Temperature : -10°C~60°C with air flow (mSATA) ■ Storage Temperature : -20°C~80°C ■ Vibration During Operation : N/A ■ Shock During Operation : N/A
■ Mounting Bracket	■ Wall/VESA/DIN Rail Multi purpose mounting Kit

■ Packing

- Net Weight : 0.9KG
- Gross Weight : 1.3KG
- Color Box Dimension : 158(W) x 167(D) x 123.6(H) mm

External I/O :

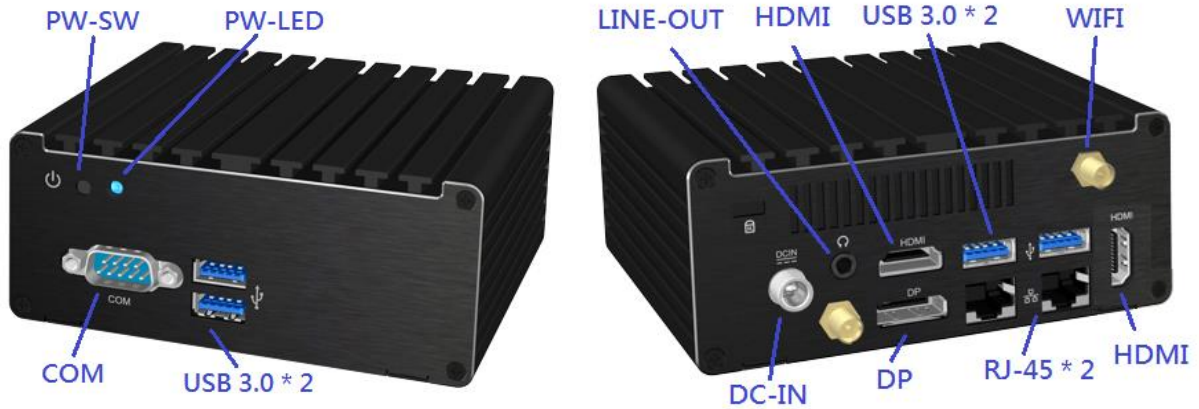

Packing List :

Parts Number	Description	Set
-----	JBC313U591(W)-3160-B	1
G03-JC313QIG01-F	313 Series Quick Installation Guide	1
G02-DVD20-A12-WF	Intel Braswell DVD Driver	1
HLMAP-FSP040-F	Adapter 12V/40W/3.3A FSP040-RHAN2	1
-----	Power cord (Depends on area/country)	1
HCS310MWM01B-1F	JC310/410 Wall+VESA mount bracket	1
LCSCBJC3XX-F	Screw Pack	1
HCS3XXDINRAILPS-F	Din Rail Clip	1

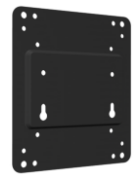

WALL Mount + VESA

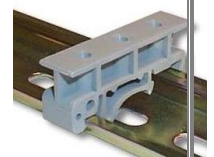

Din Rail Clip



QIG



Adapter



DVD Driver