

# BOXER-6841M-A5

Vision System Fanless Embedded Box PC with 6th/ 7th Generation Intel® Core™ Desktop / Xeon® server-grade Processor and 2 PCIe(x8) + PCIe (x1)

Front View

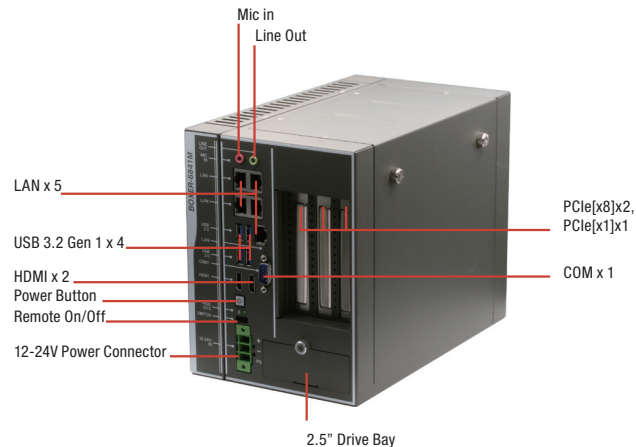

Rear View



## Features

- Support 6th / 7th Core-i desktop and Xeon® server-grade processor, Max 73W.
- Intel® C236 PCH
- Easy Installation design for expand slot
- Support PCIe[x8] x2, PCIe[x1] x1
- Support frame grabber card
- Fanless system



## Specifications

System	
CPU	6th / 7th Generation Intel® Core™-i desktop and Xeon® server grade processor -Intel® Core™ i7-6700TE, 2.4 GHz -Intel® Core™ i5-6500TE, 2.3 GHz -Intel® Core™ i3-6100TE, 2.7 GHz -Intel® Core™ i7-7700, 3.6 GHz -Intel® Core™ i7-7700T, 2.9 GHz -Intel® Core™ i3-7101TE, 3.4 GHz -Intel® Xeon® E3-1268L v5, 2.40 GHz -Intel® Xeon® E3-1275 v6, 3.80 GHz
Chipset	Intel® C236 PCH
System Memory	DDR4 ECC or Non-ECC SODIMM, up to 32GB
Display Interface	HDMI type A x 2 for HDMI v1.4b
Storage Device	2.5" Drive Bay x 2
Ethernet	RJ-45 x 5 for GbE (Intel i211AT x 4, i219LM x 1)
I/O	2 pin Remote Power on/off connector Power ON/OFF Switch x 1 HDMI 1.4b x 2 Audio x 2 (MIC-in, Line-out) USB 3.2 Gen 1 x 4 DB-9 x 1 for RS-232/422/485 3 pin DC Power input x 1 (+, -, GND)
Expansion	Full-size Mini card x 2 (USB, w/ 1 SIM slot) PCIe [x8] x 2 Extension card size limit: 114.55mm(H) x 192mm (L) PCIe [x1] x 1
Indicator	Power LED x 1, HDD active LED x 1
OS Support	Skylake S Windows® 10, Windows® 10 IoT, Windows® 8.1, Windows® Embedded Standard 8, Windows® 7, Windows® Embedded Standard 7, Ubuntu 16.04.2 Kabylake Windows® 10, Windows® 10 IoT, Ubuntu 16.04.2
<b>Power Supply</b>	
Power Requirement	DC-In 12-24V - CPU = 35W: 120W Adapter - 35W < CPU ≤ 73W: 240W Adapter
<b>Mechanical</b>	
Mounting	Wallmount
Dimensions (W x H x D)	6.10" x 7.87" x 10.24" (155mm x 200mm x 260mm)
Gross Weight	12.75 lb (5.8 kg)
Net Weight	9.9 lb (4.5 Kg)
<b>Environmental</b>	
Operating Temperature	-4°F ~131°F (-20°C ~ 55°C) according to IEC60068-2 with 0.5m/s airflow (TDP 35W Processor) -4°F ~113°F (-20°C ~ 45°C) according to IEC60068-2 with 0.5m/s airflow (TDP 73W Processor)
Storage Temperature	-4°F ~ 176°F (-40°C ~ 80°C)
Storage Humidity	5 ~ 95% @ 40°C, non-condensing
Anti-Vibration	Random, 1Grm, 5~500Hz, Anti-vibration design
Anti - Shock	—
Certification	CE/FCC class A

## Dimension

Unit: mm

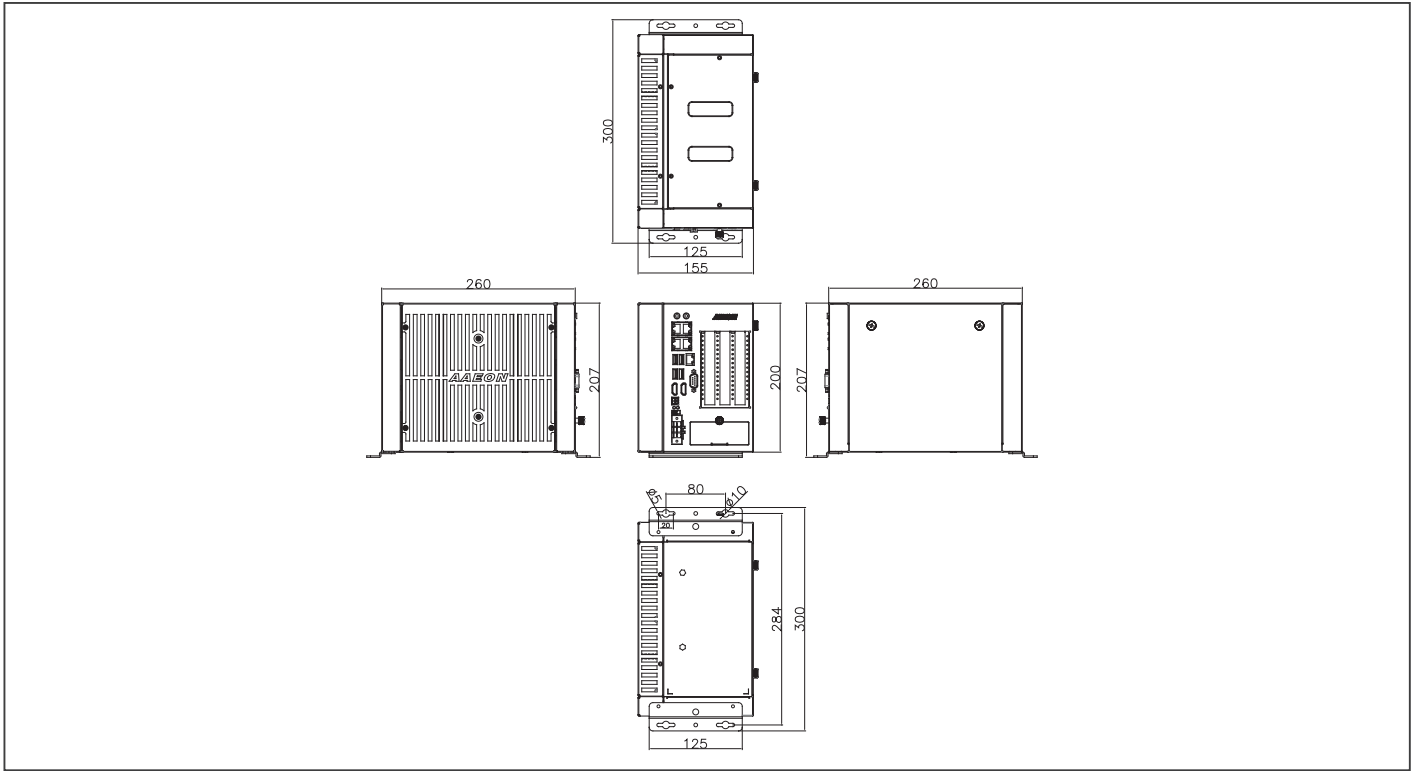

## Ordering Information

Part Number	CPU	PCH	LAN	USB 3.2 Gen 1	RS-232/422/485	RS-232	Digital I/O	Audio	Storage	Display	Expansion	Mounting	Power	Operation temp.
BOXER-6841M-A5-1010	—	C236	5	4	1	—	—	MIC-in, Line-out	2.5" Drive Bay x 2	HDMI x2	Full-size Minitcard x2, PCIe[x8] x2, PCIe[x1]x1	Wallmount	DC-In 12-24V - CPU = 35W: 120W Adapter - 35W < CPU ≤ 73W: 240W Adapter	-20°C ~ 55°C with 0.5m/s airflow (TDP 35W Processor) -20°C ~ 45°C with 0.5m/s airflow (TDP 73W Processor)

## Packing List

- Wallmount Bracket x 2
- 3 Pin DC-in Power Connector x 1
- Screw Package x 1
- Thermal Pad Package x 1
- BOXER-6841M-A5

## Optional Accessories

- **1255901209**  
120W Power Adapter
- **1255902400**  
240W Power Adapter
- **1702031802**  
Power Cord (US type)
- **1702031803**  
Power Cord (European Type)
- **170203180E**  
Power Cord (Japanese Type)
- **9741238H00**  
WiFi Module & Antenna
- **9741EG25G0**  
4G Module & Antenna (for global)
- **9741EC25A0**  
4G Module & Antenna (for USA-AT&T)
- **9741EC25V0**  
4G Module & Antenna (for USA-Verizon)
- **M046841140**  
Main heatsink cover