

Audi 8V (A3, S3, RS3) installation manual

1. Preparation before installation

It is recommended to mask interior trims for protection. Make sure to leave the car system completely off. It may be required to disconnect battery to prevent accidental deployment of airbags.

2. Disassembly steps and precautions



1. Before installation



2. Using prying tool remove the center air vents.



3. Unscrew the screen mechanism holding screws (one at each hole).



4. Pry up the screen cover trim and remove the trim.

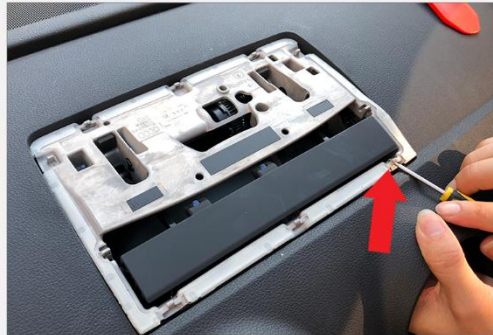

5. Using a hook, carefully lift up the screen mechanism assembly.



6. Remove the screen mechanism by removing LVDS connector and motor mechanism connector.



7. Remove the passenger side fuse panel cover.



8. Remove the MMI headunit inside the glove box using VAG Radio removal keys.



9. After unplugging every connector behind MMI unit, there is one 8mm hex screw to be removed. Unscrew it for further installation.



10. Remove the right side screw as well.



11. Unscrew every 8mm HEX screws that is holding the glove box compartment.



12. Remove the bottom screws for the glove box.



13. Install the provided main harness by routing the white main connector to the LCD screen area.



14. Plug in LVDS, GPS, Mobile Antenna, and main connector to the new screen. Two original connectors for original screen power and motor mechanism control are no longer used.

Installing Centre Speaker Bypass and routing USB Cable port



Remove the center dash speaker trim using a trim removal wedge, and unscrew the center speaker holding screws. Install the speaker bypass stemming from the main harness.



Route USB port into the glove box compartment by opening a hole using a drill or let out the USB port on the passenger side left side foot wall by probing into trim gaps.

Installing GPS and Cellular antennas

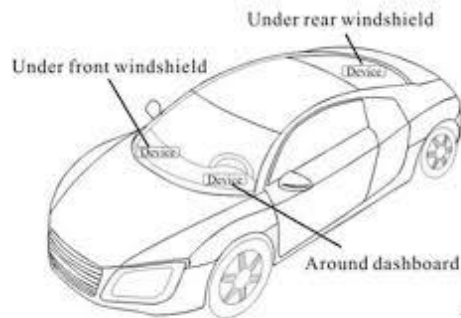
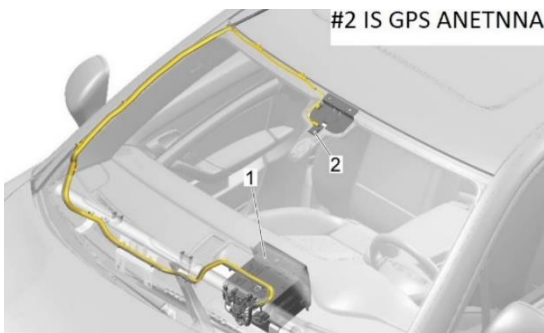

- Under the dash board below the front windshield;

- Preferred location of both antenna is near the rear-view mirror. However, signal reception may vary as each vehicle has different rate of signal penetration.
- Using GPS test plus app as well as mobile signal checking tools available from Google Play Store to determine the best location and angle of the antennas.

Removing A-pillar trim to pass the antenna wires to windshield.



WARNING

There is a curtain airbag behind this trim, and it may ignite if not be careful.

- Switch on ignition.
With ignition switched on, disconnect battery earth wire.
- Before handling pyrotechnic components and restraint systems (e.g. unplugging electrical connector) the mechanic must discharge static electricity by briefly touching the door striker plate, or similar.



WARNING

Observe safety regulations for pyrotechnic components

- Use a screwdriver to carefully unclip cap -1- with "airbag" symbol from A-pillar trim (top).
- Remove bolt -2-.
- Starting at top, carefully unclip A-pillar trim (top) -3- with removal wedge -3409--arrow A-.
- Pull A-pillar trim (top) out of dash panel -arrow B- and detach.

Installing



WARNING

Observe safety regulations for pyrotechnic components

Take care not to trap curtain airbag when fitting A-pillar trim (top).

Installation is carried out in the reverse order; note the following:



Note

If there are still trim clips in the body mounting points, they must be removed and inserted in the trim when installing. Check the clips for damage or deformation and renew them if necessary.

- Use a thread tap to remove any residual locking fluid from threaded hole for bolt for A-pillar trim (top).



Note

If the threaded hole is not cleaned, there is a danger of the new bolt seizing when being screwed in and then shearing off the next time you try to remove it.

- Insert A-pillar trim (top) -1- in mounting -2- of dash panel and sill panel trim (front) in direction of -arrow-.
- Clip in A-pillar trim (top) and fold over lip of door seal.

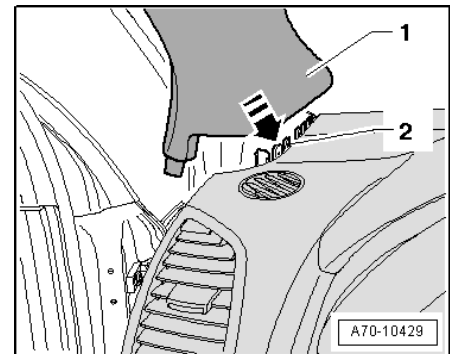
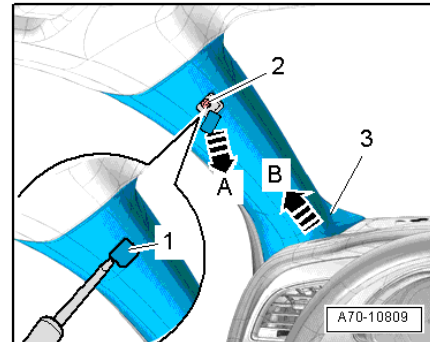

It is not necessary to remove roof lining to pass a wire. Pull down lining by a bit of force and squeeze in the antenna wires.