

Additional notes for Installer regarding sound line planning

Please read following diagrams carefully. MIB radios without AMI port, but has two USB and Aux port, you do not required to connect, code or modify anything, but choose External Audio Source in the Media section of Audi MMI system. **If you have C7, C7.5 car with 'BOSE audio system'(not Standard or B&O)**, then you need to cut the three pins mentioned later.

3G MMI/MIB with AMI

a AND b ARE NOT USED FOR FACTORY AUDIO. DO NOT CONNECT ANYTHING UNLESS YOU NEED THEM FOR AFTERMARKET RADIO. (3G MMI only)



a is for aftermarket radio with digital inputs

b is for aftermarket radio with analog stereo input

Never connect b and c together, that will be redundant connection and it will degrade sound quality a lot without bass at all.

d requires to be connected to AMI port. c is not required to be connected at all

Do not connect AMI to AUX adaptor's audio plug to the the audio output of RSNV S4.

That makes **redundant** loop of audio circuit and sound quality will be worsened and bass is gone.

Concert/Symphony Radio

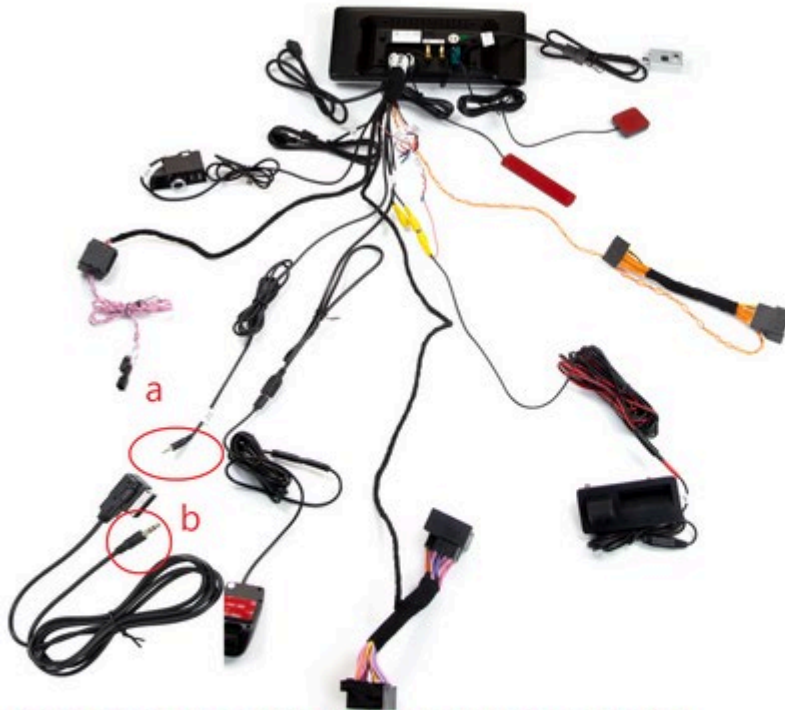

Only for concert/symphony radio a and b need to be connected. use double female 3.5mm audio aux adaptor. No coding for these radio.

Use the male audio plug to connect AMI to Aux adaptor unlike 3G MMI. Without this, you will have no sound at all. Remember, if S4 sounds bad like old AM radio, that means there is loop connection that affecting frequencies. If sound balance isn't right, then there is poor pin connection. It could be RSNV S4 main connector or the quad lock plug.

FAQ: Sound imbalanced or losing 1 channel only? Check PINs!

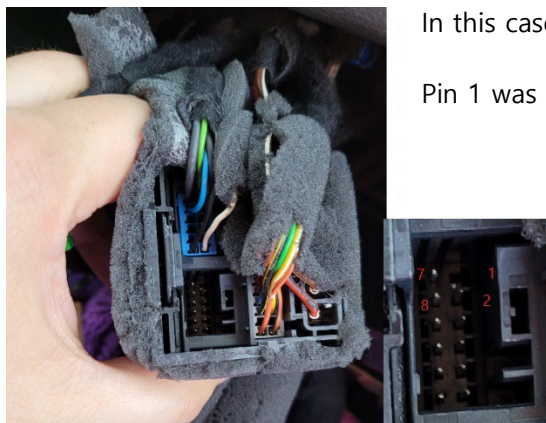

In this case,

Pin 1 was crushed

- 1. Audio ground
- 2. Audio Right Channel
- 7. Audio left channel
- 8. Audio shielding

Follow if and only if the sound quality is really low like AM radio, the maximum volume is low and no bass frequencies from the speakers. (e.g Bose audio system)

For A6, A7, S6, S7 vehicles with BOSE sound system
and extremely rare 3G MMI High Plus without AMI
Following modification is required before installation

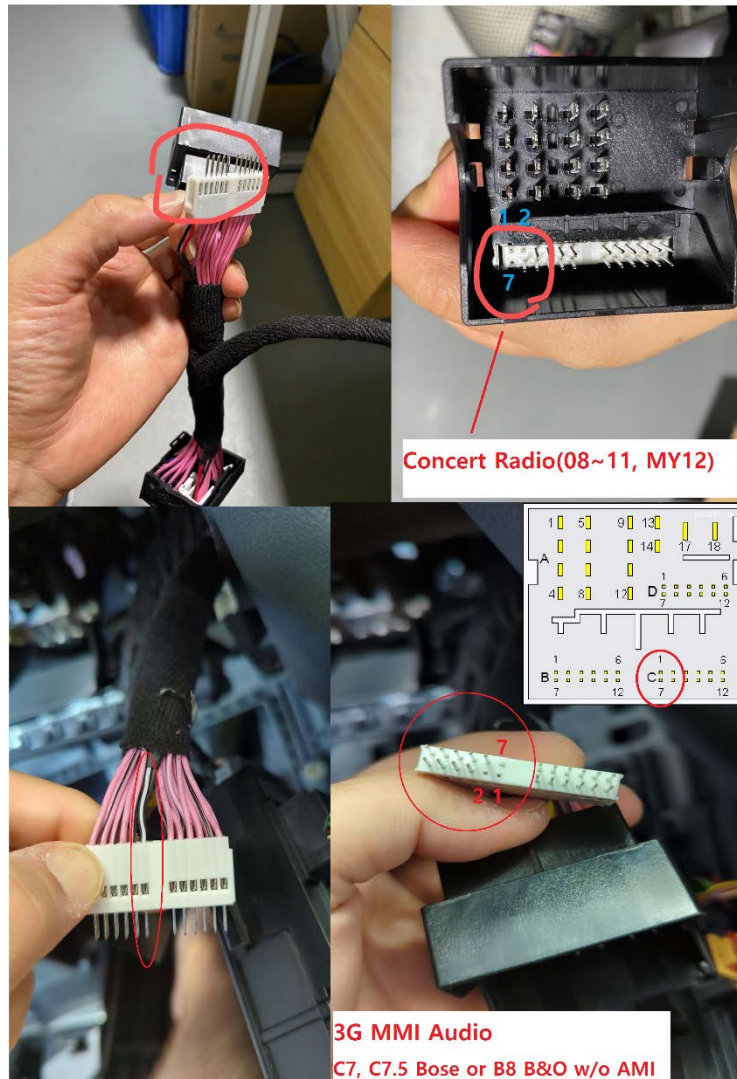

****Note that block C pin 1,2,7 positions are different across radio type.
You must cut the pins that is connected to white, black, and red line
Not pink lines**

On the RSNAV S4's main harness,
the female receptacle of the quadlock plug has a detachable white block. Detach the block and cut Block C pin 1,2,7, and insert back. Block C is where the red circle is at on the above right picture.

This is required for certain Audi radios that does not ground loop filter. If not sound volume will be low, and bass will be gone.

Following cars does not have ground loop filter:

2008~11(up to MY12) manufactured Concert/Symphony Radio without AMI
2010~2018 manufactured Audi A6, A7, S6, S7 with BOSE sound system
Some B8 platform vehicles with 3G MMI High, High Plus without AMI but with aux port under the arm rest

Optional: Using S4 TOSLINK out put with Toslink to AUX DAC for aftermarket installation or factory equipment eliminating any change to ground interference.

Recommended DAC: 192Khz DAC with Volume Control Knob (<\$30 USD)

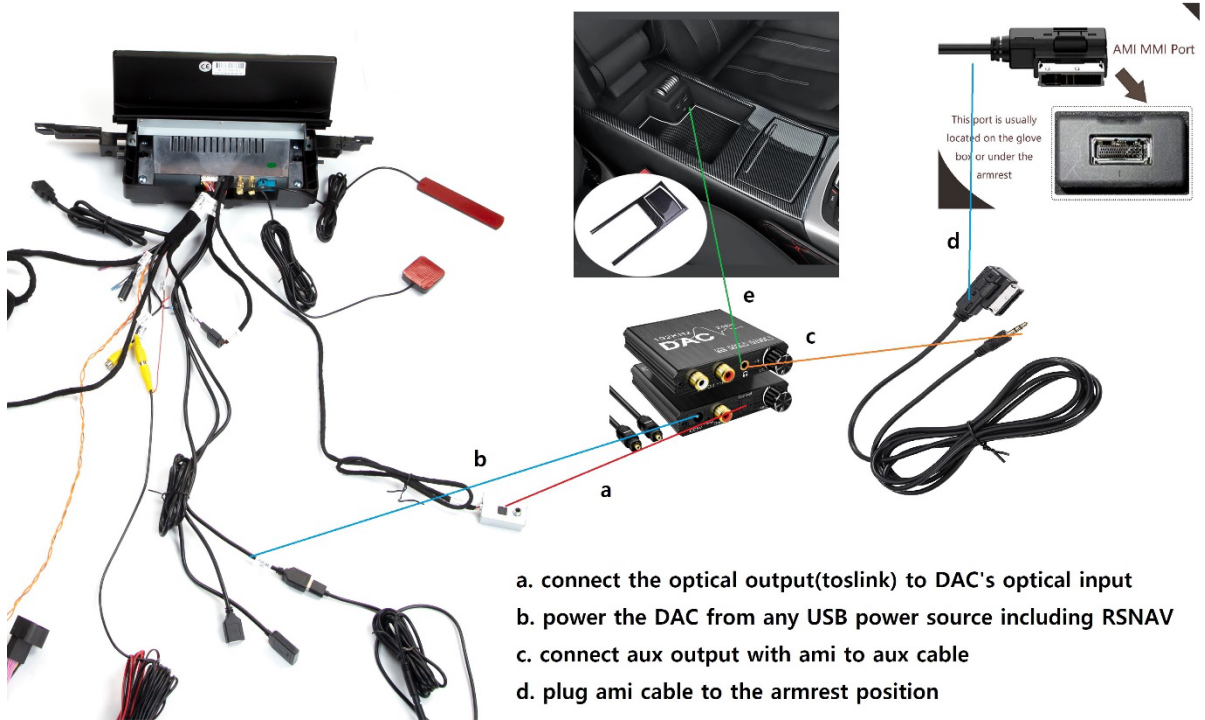

- a. connect the optical output(toslink) to DAC's optical input
 - b. power the DAC from any USB power source including RSNNAV
 - c. connect aux output with ami to aux cable
 - d. plug ami cable to the armrest position
- or
- e. plug aux output of DAC to the aux input under the armrest using male to male audio cable

Following modification of T harness is required for the above optional sound routing.

