

PRODUCT DRAWING&INDICATION

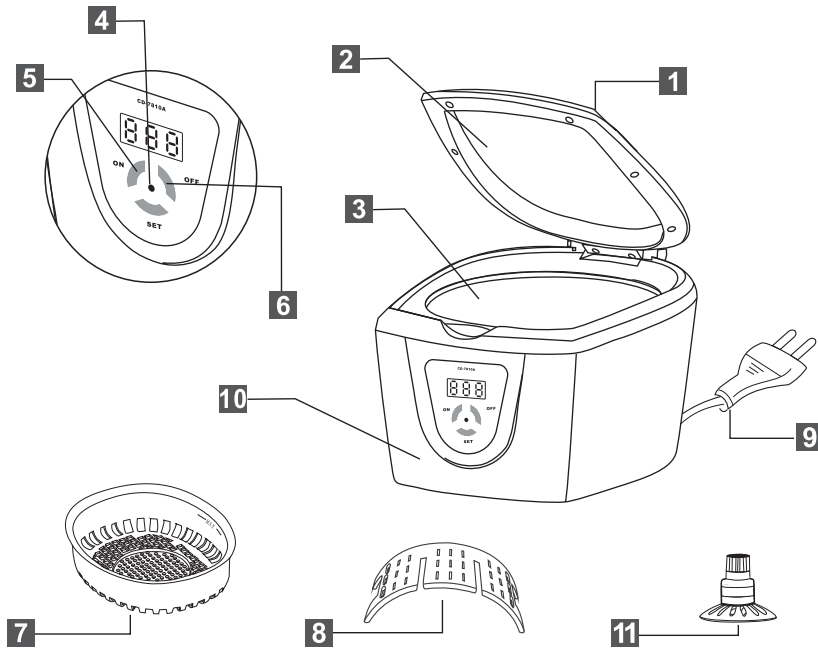

- 1 LID 2 VIEW WINDOW 3 STAINLESS STEEL TANK 4 INDICATION LIGHT
5 ON BUTTON 6 OFF BUTTON 7 PLASTIC BASKET 8 PLASTIC WATCH STAND
9 PLUG AND CORD 10 HOUSING 11 CD RACK

SPECIFICATIONS:

NAME	DIGITAL ULTRASONIC CLEANER	POWER SUPPLY	AC 100V 50/60Hz 26 W AC 100~120V 60Hz 35 W AC 220~240V 50Hz 50 W
ITEM NUMBER	CD-7810 (A)		
DIMENSIONS	210X158X125mm	TIMER SETTING	5CYCLES: 180s, 280s, 380s, 480s, 90s
TANK SIZE	750ml	WEIGHT	1.00 kg

IMPORTANT SAFETY INSTRUCTIONS

⚠ WARNING-To reduce the risk of burns, fire or injury to persons

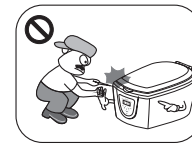

Do not disassemble the unit except for the authorized technician.

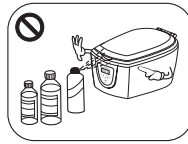

Do not fill the tank with abrasives or corrosive chemicals.



Unplug the unit before filling. Do not exceed the "MAX" mark.



Do not immerse the unit into water to avoid electric shock.

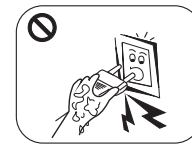

Do not touch the socket with wet hand to avoid electric shock.



Repeating cleaning cycles can enhance the cleaning effect. 3-minute cleaning interval is recommended.

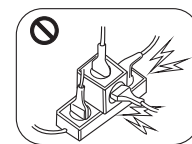

Use the unit properly as per its instruction manual. Do not use attachments not recommended by the manufacturer.

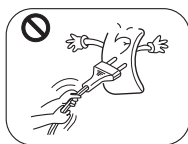

Do not use this unit when sleeping or drowsy.

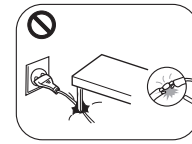

Never operate this unit if cord or plug is damaged. If it is not working properly, damaged or has been dropped into water, return the damaged unit to a service center for examination and repair.



Any unfirm inlaid item may to become loose. Items that is easy to be discolored are not recommended for ultrasonic cleaning. For example: textiles, leather products, woodware, etc.

Do not put mobile phone or watch which is not waterproof into the tank for cleaning. Do not put any spectacles frame or art ware which is made from shell or hawksbill into the tank for cleaning.

Don't use the product there isn't water in the cleaning tank.

SAFETY INSTRUCTION: READ ALL INSTRUCTIONS BEFORE USING

⚠ DANGER- To reduce the risk of electrocution:



Unplug this unit immediately after using.



Keep the unit and the cord away heated surfaces, and place it on the dry and level surface.



Keep the unit in a safe place to avoid falling into water or other liquid.



The unit should never be left unattended when plugged in.



Do not use while bathing.



Do not immerse the unit into water or other liquid.



Do not reach for the unit that has fallen into water. Unplug it immediately.

DIRT ELIMINATION PROCESS THROUGH ULTRASONIC TECHNOLOGY

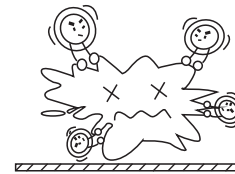

Many tiny bubbles are generated under the action of ultrasonic.

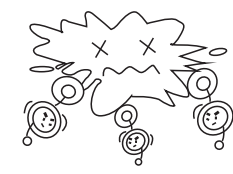

Bubbles are imploded constantly under the action of ultrasonic to impact the surface of the item.

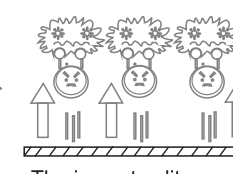

The impact splits up the dirt into many granules and separates them from the surface of the item, the granules then come into water.

APPLICATION:

Jewellery	Glasses and Timepieces	Commodities
Necklaces, Rings, Earrings, Bracelets etc.	Glasses, Sun Glasses, Watch Chains, Waterproof watches etc.	Electric shaver heads, Razor blades, Dentures, Combs, Toothbrushes etc.

CD-Rack	Metal Articles	Metal dishware
CD VCD DVD etc.	Pen-heads, printer-heads, seals etc.	Metal dishware, Watch Parts, Ancient coins, Badges, Valves, Machine nozzles etc.

OPERATION INSTRUCTIONS



Open the lid, and fill the stainless steel tank with water.

⚠ Running without water may damage the unit!

OPERATION INSTRUCTIONS



The item should be immersed well into the water. However, do not exceed the "MAX" mark.



Close the lid, and plug in.

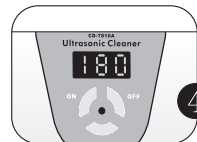

Press "SET" button, the 5 optional working cycles from It is the most common-used working cycle. Every time when the unit is electrified, 180s is displayed automatically, Press "SET" button to choose working cycle freely. 180s → 280s → 380s → 480s → 90s will be displayed on the screen. Users can choose working cycle freely according to the quantity and situation of the item. The unit adopts digital program to control working cycles.

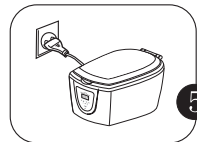

Press "ON" button to start cleaning and the red indication light is on. The time left will be displayed on the screen.

During cleaning, you can hear the "ZIZI" voice, it means the unit is working normally.

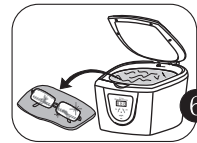

When reach the time of 000 the unit will auto stop, the red light will turn off. If another cleaning is needed, just repeat the above steps. During cleaning, if you want to stop, just press "OFF" button. Press "ON" button again, the unit will implement the remainder program to continue the cleaning. Furthermore, you can press "SET" button to renew working cycle.



When cleaning finished, unplug it and open the lid, then take out the item. At last, pour water from stainless steel tank and wipe it up.

FOUR WAYS OF CLEANING



GENERAL CLEANING
Use only plain water for general cleaning. The water should merge the item but not exceed the ruling mark.

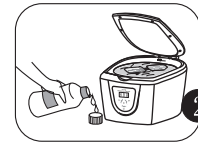

ENHANCED CLEANING
When the item is smeary or extraordinary dirty, add about 5-10 ml of detergent into water to enhance the cleaning result.



CLEANING BY PARTS
For large items, place the item as shown.



EXTENSIVE CLEANING
When item to be cleaned needs extensive cleaning or sterilizing, use "Enhanced Cleaning" first, then replace with clean water and add about 5-10 ml of liquid soap (used for washing hands) into the tank, and start the unit with the working cycle as 90S. After this working cycle finished, the item can be cleaned extensively.

USER MAINTENANCE

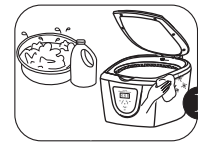

After use, pour the water and wipe up the tank and its surface.

Do not wash the unit with water to avoid electric shock.

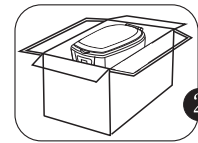

Keep it at a cool and dry place.

OPERATION GUIDANCE FOR DISK CLEANING

When using cloth to clean the dirty disk, it may scratch its surface. While using ultrasonic technology can throw off the dirt effectively (within 2 minutes), and the disk can be protected from scratching.

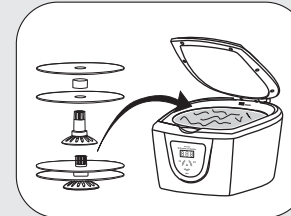

Put the disk (CD, VCD, DVD) onto the disk holder as shown in the picture (two disks can be cleaned at one time). Then put the holder into cleaning tank which is filled with normal water. Caution:
1. Don't use warm or hot water, as the print mark on the surface is easily got rid of.
2. The disk can be cleaned whenever it is dirty, but please don't clean the disk for more than two times continuously, otherwise the print mark of the disk is easily got rid of. Generally, 90 seconds for once clean is enough.
3. Ultrasonic can only clean the dirty on the surface of the disk, please note that the disk which is scratched can't resume.

USAGE OF OPTIONAL ACCESSORIES

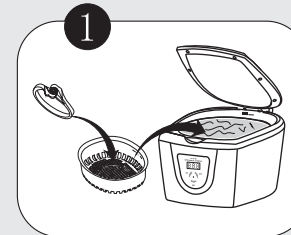

PLASTIC BASKET
When small item is to be cleaned, put the item into plastic basket, then put the basket into the tank. In this way, frictions between the item and the tank can be reduced.
Please pay attention, the plastic basket is only used for cleaning small items, because it absorbs about 30% of ultrasonic energy, and reduces the cleaning result. In this case, when using the plastic basket, please refer to the instruction of "Enhanced Cleaning" in this manual.

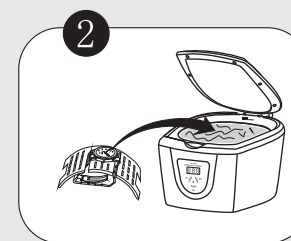

WATCH STAND
The permeability of ultrasonic is very strong, do not put watch (of water proofing capability less than 30 metres) into the tank directly, or water may penetrate into the watch and cause severe damages. It is recommended to use the watch stand for watchband cleaning by simply immersing the watchband into the water while keeping the watch itself on top of water.
Similar to plastic basket, the watch stand also absorbs ultrasonic energy. When the watch stand is used, refer to "Enhanced Cleaning" for effective cleaning result.

DIGITAL ULTRASONIC CLEANER CD-7810(A) USER INSTRUCTION MANUAL

High frequency vibration stimulates the transducer and generates 42,000Hz of ultrasonic wave. Fill-in with plain water submerge the item to be cleaned, then press "ON" button. You will see the dirt separates off into the water.

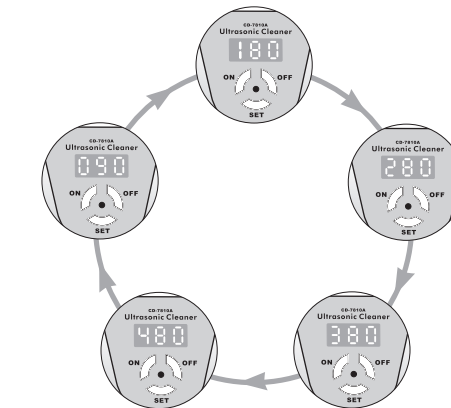
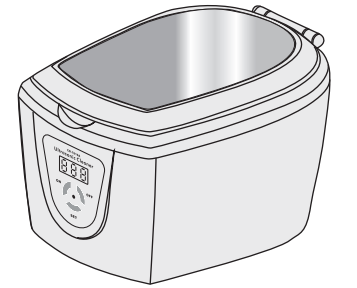

- SPECIFICATIONS:**
1. Digital program; 5 working cycles; choose freely.
 2. Stainless steel tank.
 3. Tank capacity: 750ml --- 1.3pint
 4. Ultrasonic frequency: 42,000Hz
 5. Quiet, solid state circuitry.

- READ ALL INSTRUCTIONS BEFORE USING
- KEEP THIS MANUAL